

31604 DODGE RAM PICKUP FRONT HITCH

GROSS LOAD CAPACITY WHEN USED AS A WEIGHT CARRYING HITCH: 5,000 LBS. TRAILER WEIGHT & 500 LBS. TONGUE WEIGHT.

GROSS LOAD CAPACITY WHEN USED AS A STRAIGHT LINE PULL: 9,000 LBS. MAX. LINE PULL.

DO NOT EXCEED VEHICLE MANUFACTURER'S RECOMMENDED TOWING CAPACITY.

Parts List				
ITEM	QTY	PART NUMBER	DESCRIPTION	
1	1	1/2"	FISHWIRE TOOL	
2	8	1/2-13 x 1 1/2	CARRIAGE BOLT	
3	6	CM-SP12	.250 x 1.00 x 2.00" SQUARE HOLE SPACER	
4	2	CM-SP6	.250 x 1.00 x 3.00" SQUARE HOLE SPACER	
5	8	HFN 1213	HEX FLANGE NUT	

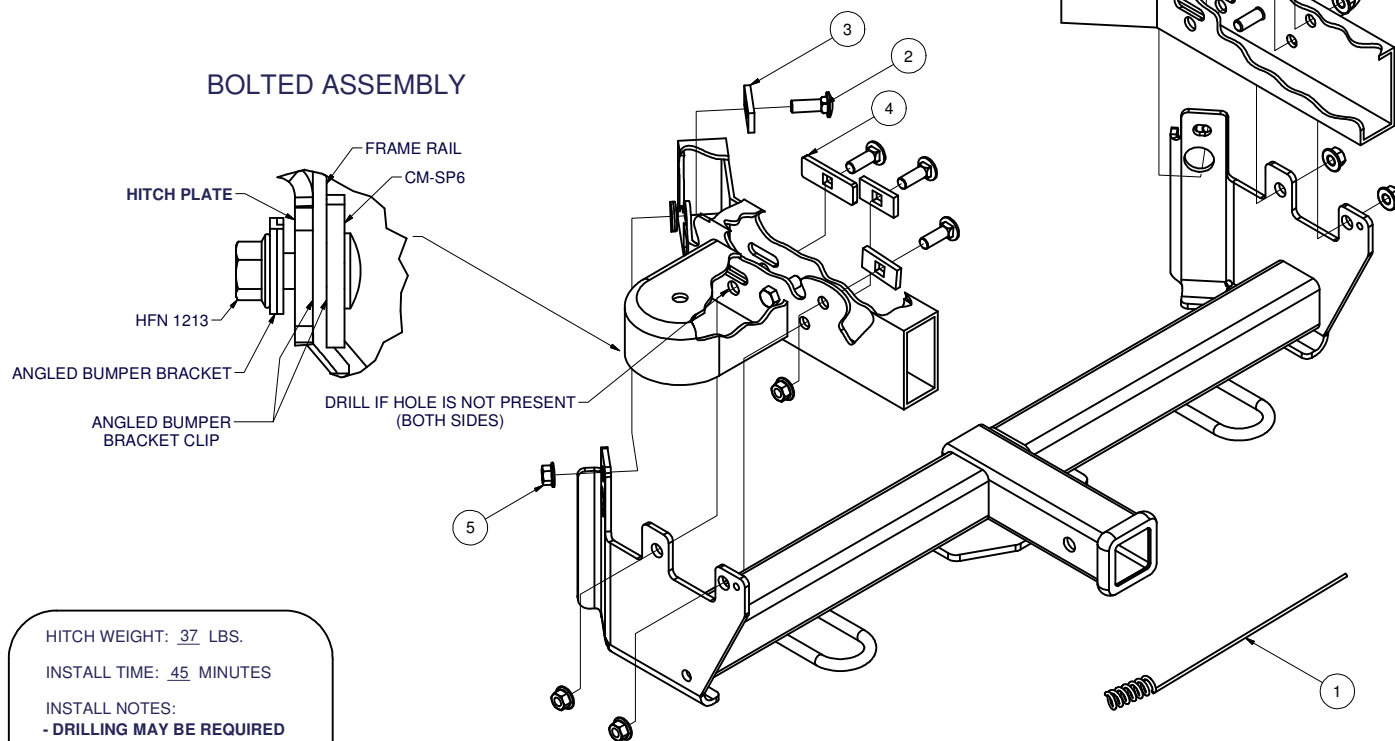

HITCH WEIGHT: 37 LBS.

INSTALL TIME: 45 MINUTES

INSTALL NOTES:

- DRILLING MAY BE REQUIRED
- MAY REQUIRE CUTTING OR REMOVAL OF AIR DAM

INSTALLATION STEPS

Note: If vehicle has front air dam, a 2" x 2" piece will have to be trimmed, or remove the air dam completely.

- 1) Remove bumper bolts or bolt plate at the end of the frame as well as the bolt and U-nut holding the bumper support to the angled section of the frame.
- 2) Place receiver into position and loosely fasten at the front holes with the hardware provided.
- 3) If middle hole of hitch is not present on the frame, use hitch as a template and drill a 17/32" hole in both frame rails.
- 4) Fishwire remaining hardware into the specified locations.
- 5) Torque 3/8" fasteners to 45 lb-ft.
Torque 7/16" fasteners to 70 lb-ft.
Torque 1/2" fasteners to 110 lb-ft.
Torque 5/8" fasteners to 210 lb-ft.

PERIODICALLY CHECK THIS RECEIVER HITCH TO ENSURE THAT ALL FASTENERS ARE TIGHT AND THAT ALL STRUCTURAL COMPONENTS ARE SOUND.