



Installation Instructions

C-RES (*Cargo Restraint System*)

07-10 Jeep Wrangler (2-Door)

Part #571035

Please read instructions entirely before installing this part

NOTE: You will need to have the following to install this part correctly.

1. Tailgate retaining bar and brackets.
2. OEM Door-Surrounds

Step 1: *It is recommended to remove your soft top and bow assembly completely to install this product.* Remove your existing soft top and bow assembly (if equipped)

Step 2: Unfold the C-RES top and lay it out over the rear of the vehicle. (Fig A)

Step 3: Starting on the driver side attach the plastic channel in the top into the back channel of your door surround. (Fig B)



(Fig A)

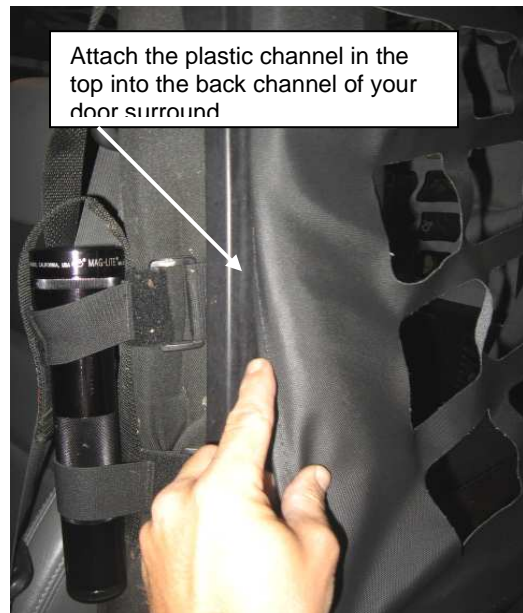

(Fig B)

Step 4: Begin sliding the side channel on the top into the side channel on your vehicle and continue around the corners.(Fig C) Repeat step 3 and 4 on passenger side.



Installation Instructions

C-RES (Cargo Restraint System)

07-10 Jeep Wrangler (2-Door)

Part #571035

Step 5: Now insert the plastic channel on the top into the top horizontal part of your door surrounds. (Fig D) Repeat step 4 and 5 on the passenger side now.



(Fig C)



(Fig D)

Step 6: Loosely attach the two top straps around the sport bar into the factory holes in the sound pods. (Fig D) (Do not pull tight at this time.)

Step 7: Slide your tail-gate retaining bar into the sewn in extrusion on the back of your top (Fig F) Once all the way on lock the bar into the brackets (Fig G)



(Fig E)

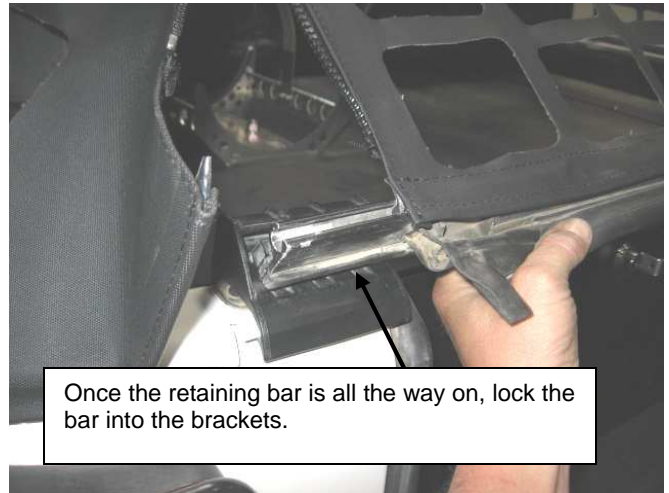

(Fig F)



Installation Instructions

C-RES (Cargo Restraint System)

07-10 Jeep Wrangler (2-Door)

Part #571035

Step 8: Now pull the straps around the sport bar securely. Installation is now complete. The C-RES can be used in conjunction with briefs and extended tops. Simply maneuver the straps on the briefs through the holes on the C-RES in the best location, on some models you may not be able to use all of the straps, in this case simply tuck strap under in the best location.

