



## Installation Instructions

Part # 612800-04  
Light Kit for 76858 and 76614  
[Rear Bumpers](#)

**Read and follow wiring diagram carefully.**

- Control Box must be used when wiring up lights
- Do not hook up lights directly to a 12v source (this will damage lights)
- Make sure all connections are secure
- Make sure wires do not contact sharp objects or extreme heat area

### **PARTS**



**NOTE:** *The wire is connected with the lamp when it leaves the factory.*

- Please follow the wiring diagram to connect the circuit. According to the wiring diagram to connect the circuit, LED light will be open automatically when the engine is started.
- Please follow the ECE R97/28 and ECE R48 standard to install.



## Installation Instructions

Part # 612800-04  
Light Kit for 76858 and 76614  
Rear Bumpers

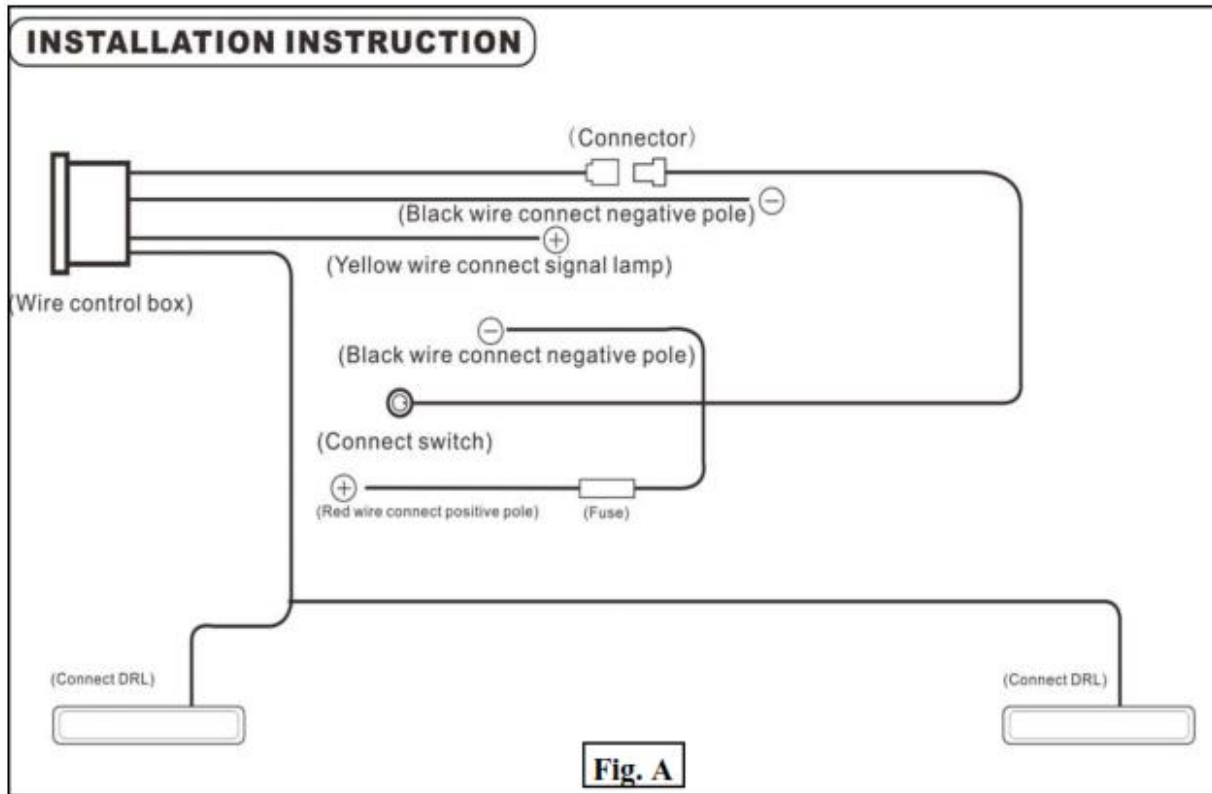

There are 4 power wires; a minimum of 3 wires must be connected for the lights to function.

A. Red wire to + positive on battery or power source.

B. Black wires(2) to – ground ( one Ground wire will be the short black wire coming out of the power control box, The other will be the long black wire on the main wire loom. )

**OPTIONAL:** Yellow wire to + of backup light or other + switched accessory power wire. Only use yellow if you want an auxiliary on/off switch such as a reverse light. This wire can be used in conjunction with Smittybilts JK towing wire harness (Part# 2912) which has extra lead wires.

You do not have to hook up the yellow wire, if you choose not to hook up yellow wire, then the on/off switch will power the lights. If yellow wire is not used, insulate the exposed wire.

**NOTE:** When powering the lights using yellow AUX wire, light output will be 35%. ( this is intentional as when used as backup light , many states have regulation on how bright the backup aux light may be.) For 100% light power use on/off switch.

Amp draw.

\* Max 0.6 amp 9 when powered via on/off switch.

\* 0.45 amps when powered via yellow AUX power wire.



## Installation Instructions

Part # 612800-04  
Light Kit for 76858 and 76614  
Rear Bumpers

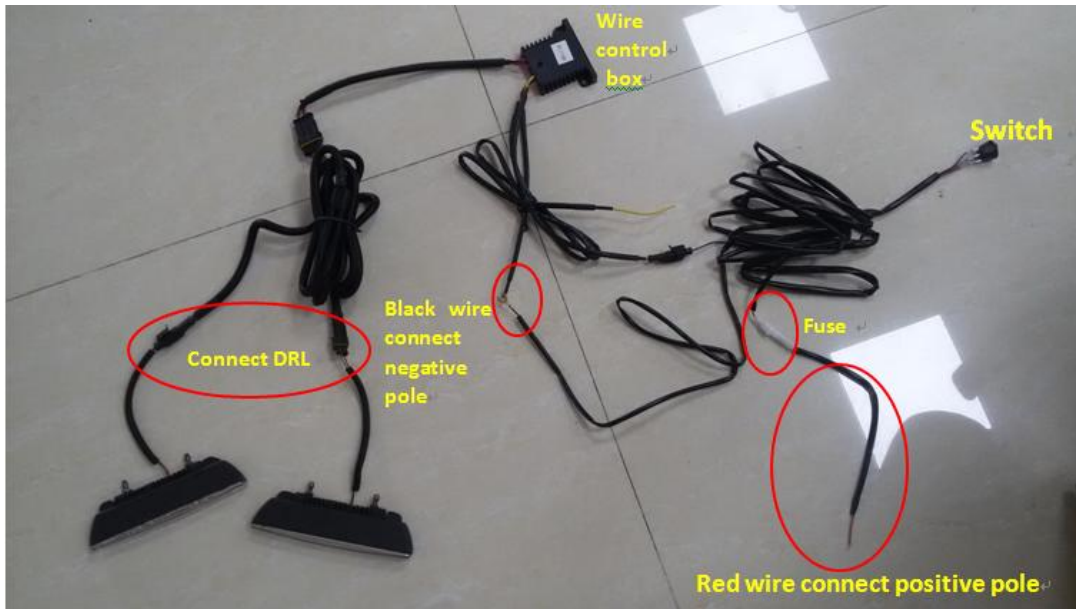

(Complete Wiring Set up)

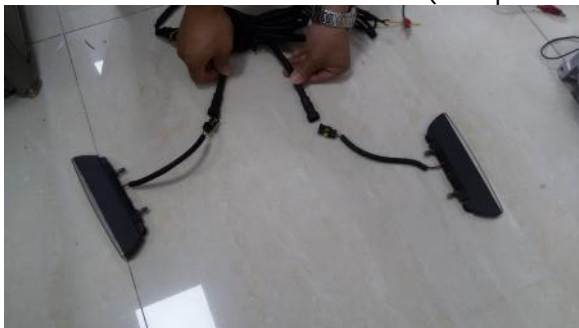

(Plug wire loom into light plugs)

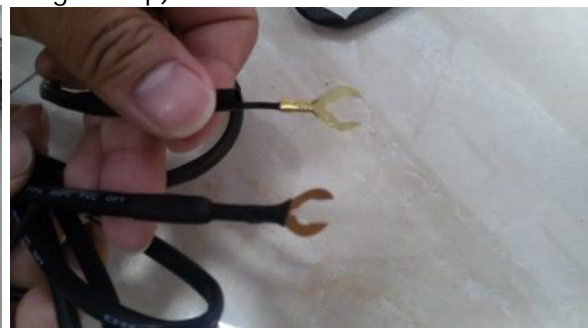

(Ground both black negative wires)



(Connect Red wire to positive terminal on battery)



(Optional- Connect yellow wire to auxiliary power-like back up lighting)