



INSTALLATION INSTRUCTIONS



SLiPLO®
UNIVERSAL SKID PLATE

THANK YOU

- Thank you for purchasing SLIPLO universal skid plate, providing your bumper's front lip with durable scrape protection that will last for years to come. SLIPLO's universal design allows for each piece to mold around your bumper and attaches to automotive surfaces using 3M super strength double sided adhesive tape. That means no holes to drill, no riveting, no liquid adhesives to cure, no weld distortion, no clean up.

RECOMMENDED TOOLS

- 70% Isopropyl alcohol (IPA) - Optionally this kit might contain an applicator pack only if allowed by country & shipping regulations.
- 3M Adhesion promotor - Optionally this kit might contain an applicator pack only if allowed by country & shipping regulations. If not within box, please find a comparable adhesive promotor to 3M adhesion promotor 4298 or 3M 06393. Priming a surface can significantly enhance initial and ultimate adhesion to many materials such as plastics and paints
- Towel
- Scissors
- Marker
- Measuring Tape

SURFACE CLEANING

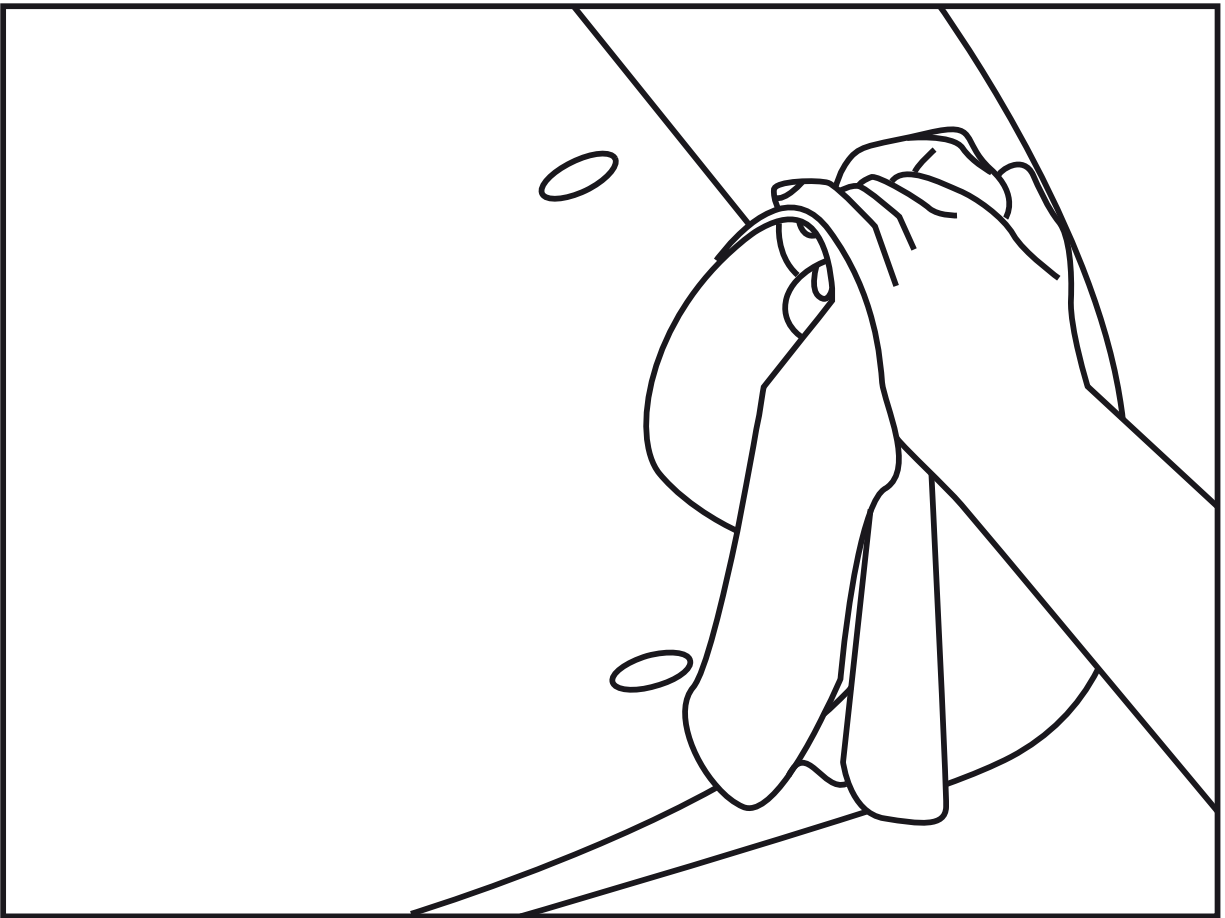

Use the 70% Isopropyl alcohol (IPA) and a towel to clean the surface of any oily layer or contamination on your car. Where heavy oil, grease or a ceramic coating is present, a “degreasing” solvent such as gasoline can be used to remove any contaminants. However, take extreme care not to damage the paint.

When cleaning with solvent, always follow with an IPA clean to remove any remaining residue. Make sure to let the surface sit until fully dry before moving onto the next step.

ADHESION PROMOTER

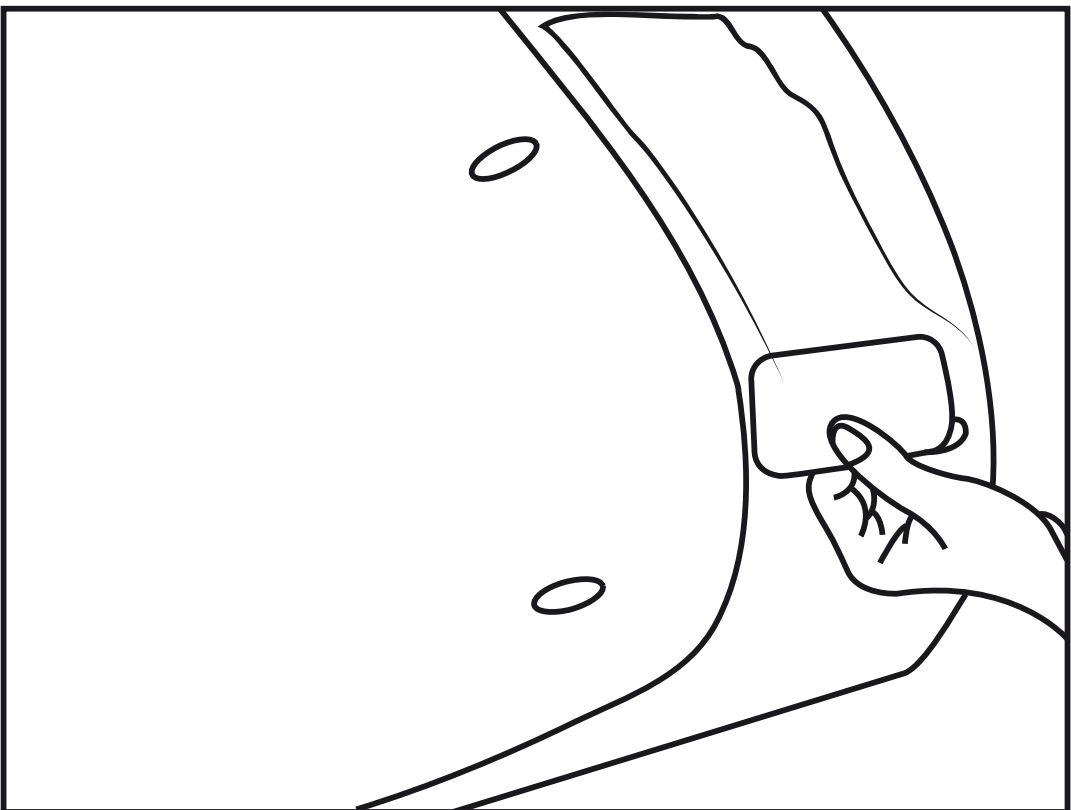
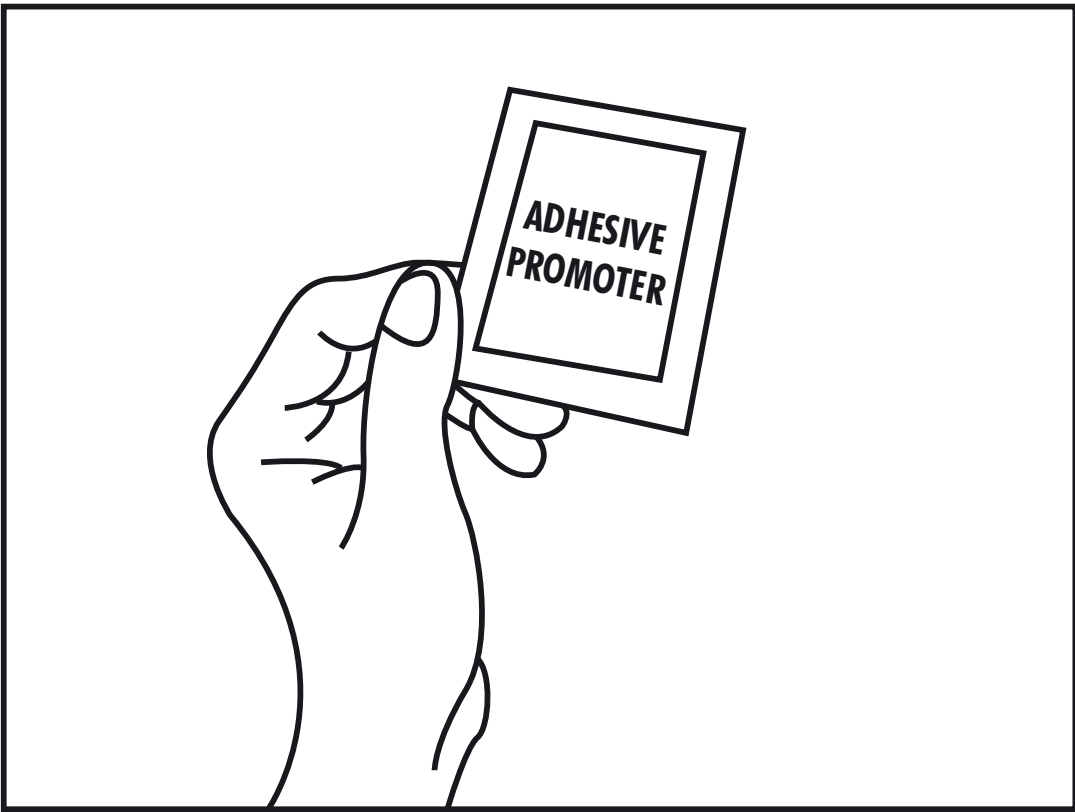

Make sure to use a glove when handling any type of adhesive promoter. Quickly apply a single thin layer of the adhesive promoter to the surface area using the applicator sponge. Make sure to let the surface sit until fully dry before moving onto the next step.

If the surface has pre-existing damage, make sure you focus on these areas with the application of extra promoter.

FITMENT TEST

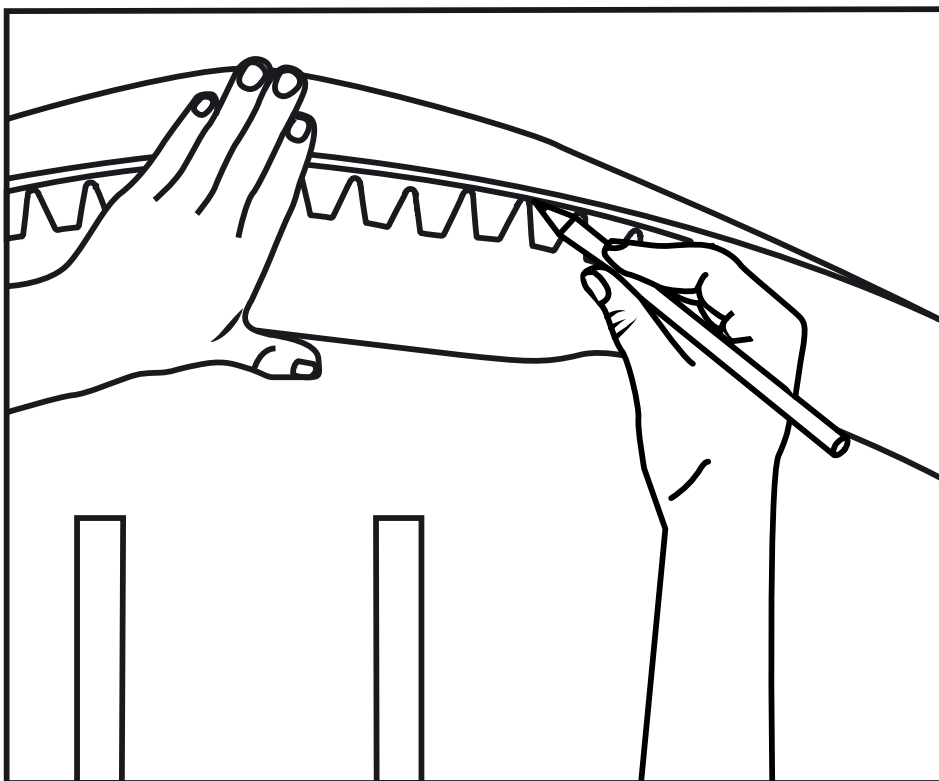
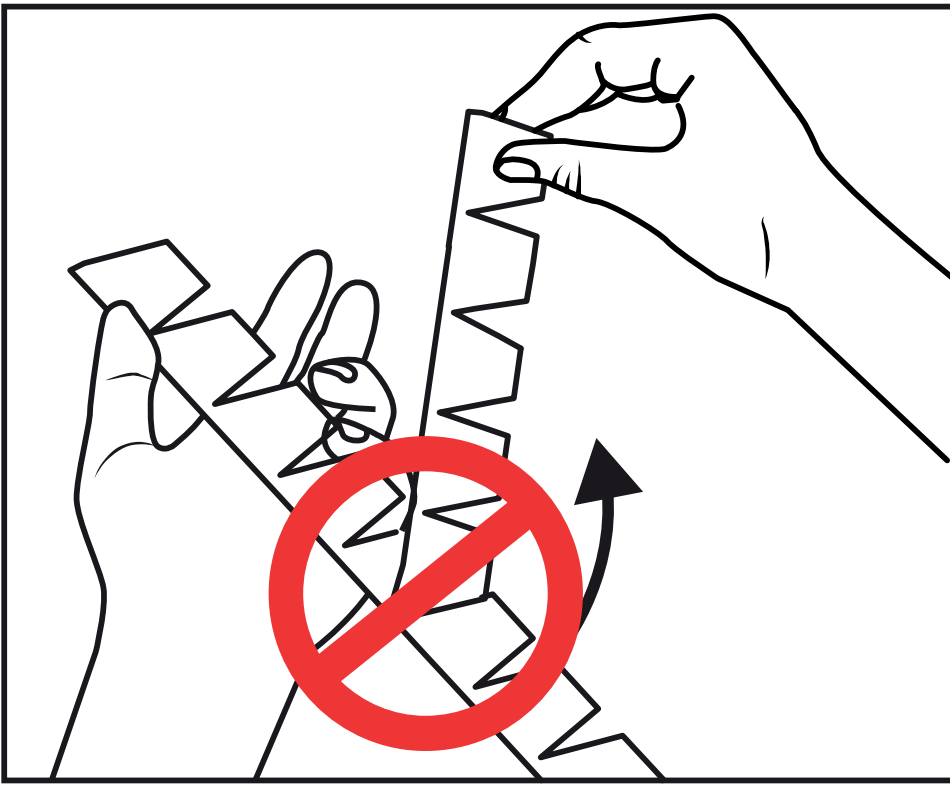

Do not remove any of the red adhesive liner during this testing segment. Place your first piece of SLIPLO up against the surface area you want to protect. Generally, a good rule of thumb is to start from the center of the bumper and test each consecutive piece, moving towards the driver side of the car. Use your pen to mark any overlaps, screws, and holes on the SLIPLO piece which require any type of cutting. Once satisfied, move onto the next piece and repeat.

FINAL ADJUSTMENTS

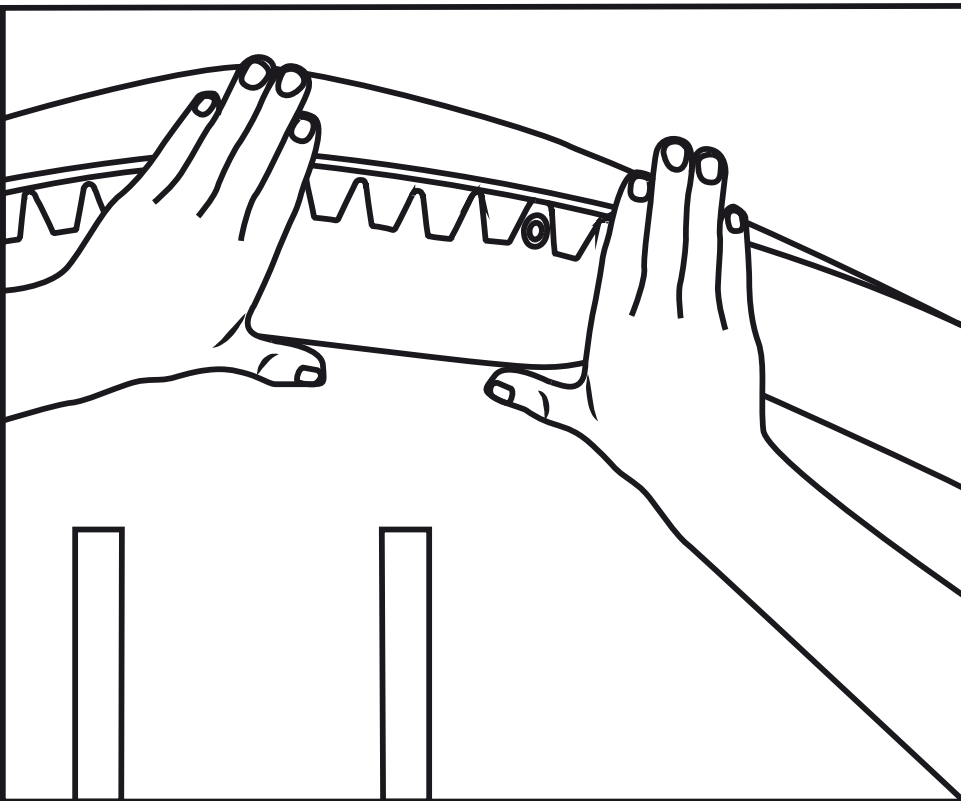
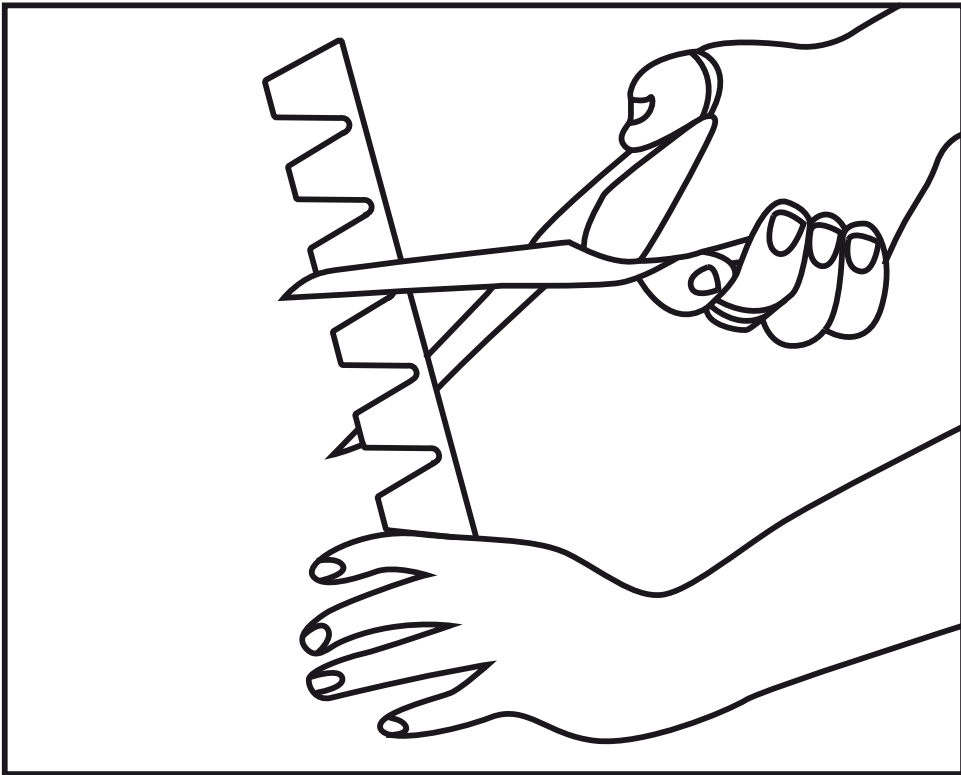

Using your sharp scissors, cut any marked SLIPLO pieces from the previous step. Double check the fitment of each cut piece against the surface. Remember to cut only as much excess material as necessary, ensuring maximum bond integrity of each individual piece.

FINAL APPLICATION

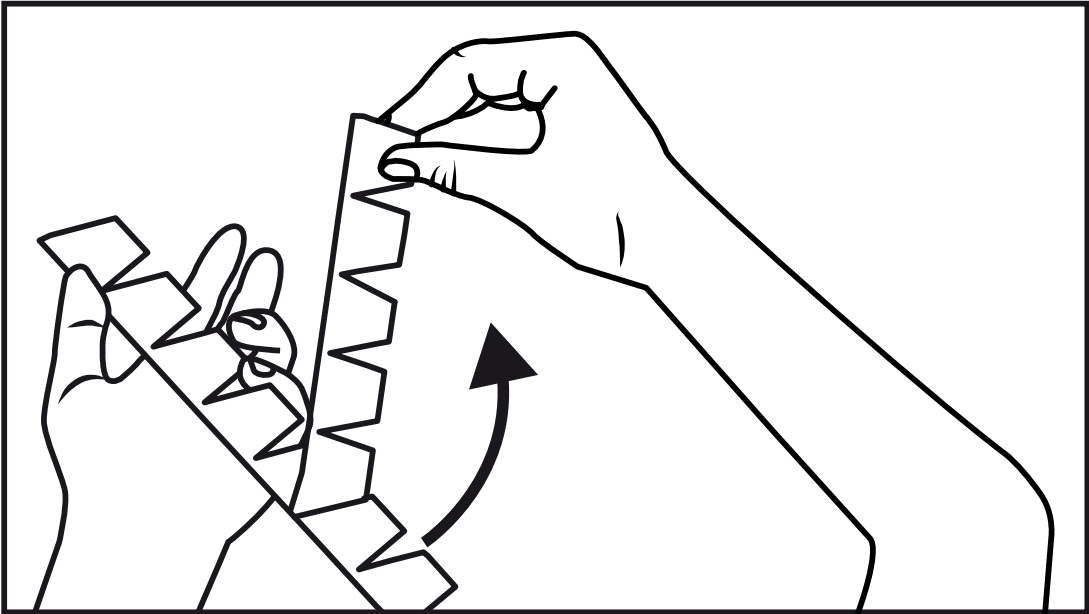

Remove the adhesive red liner from the back of the SLIPLO piece.

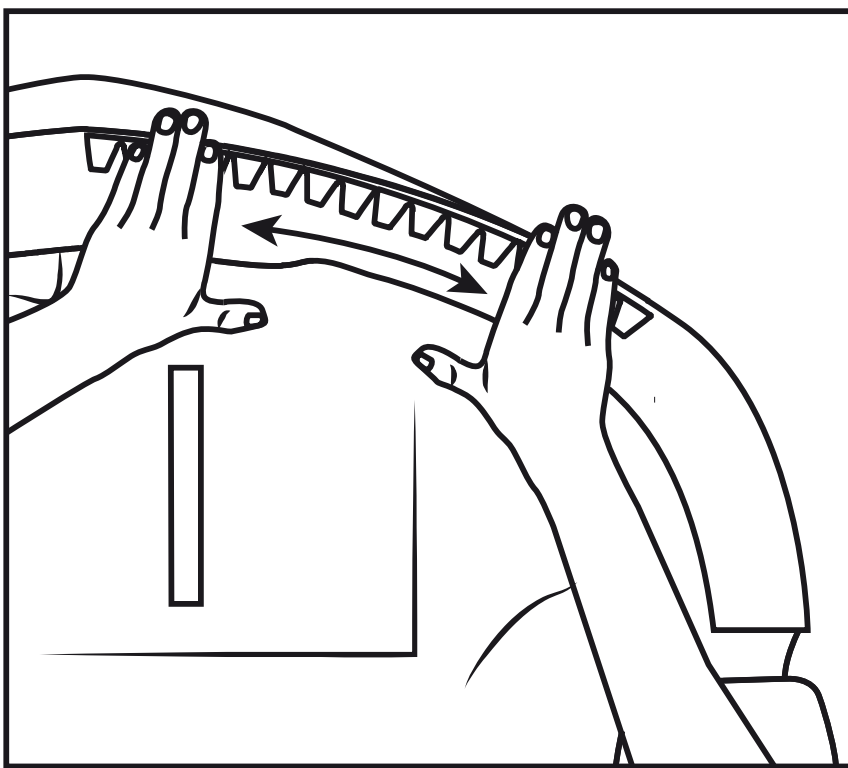

Starting from the center, lightly apply your first piece. By pressing lightly, you will be able to easily pull off the Sliplo for repositioning.

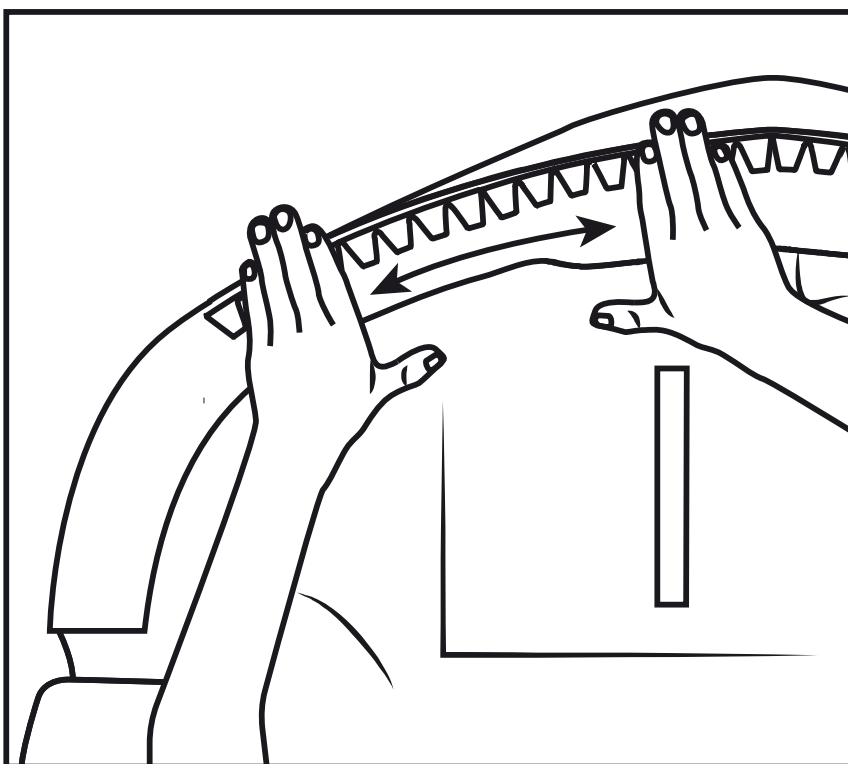

You should only press hard on the Sliplo when you are completely happy that it is in the correct position.

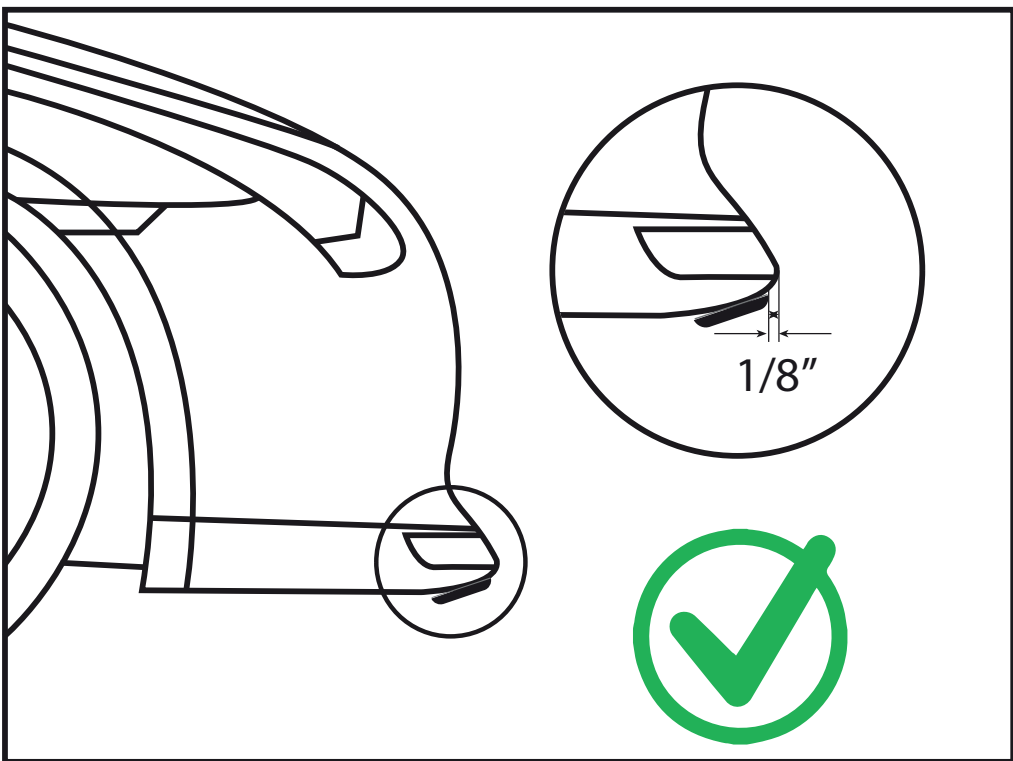
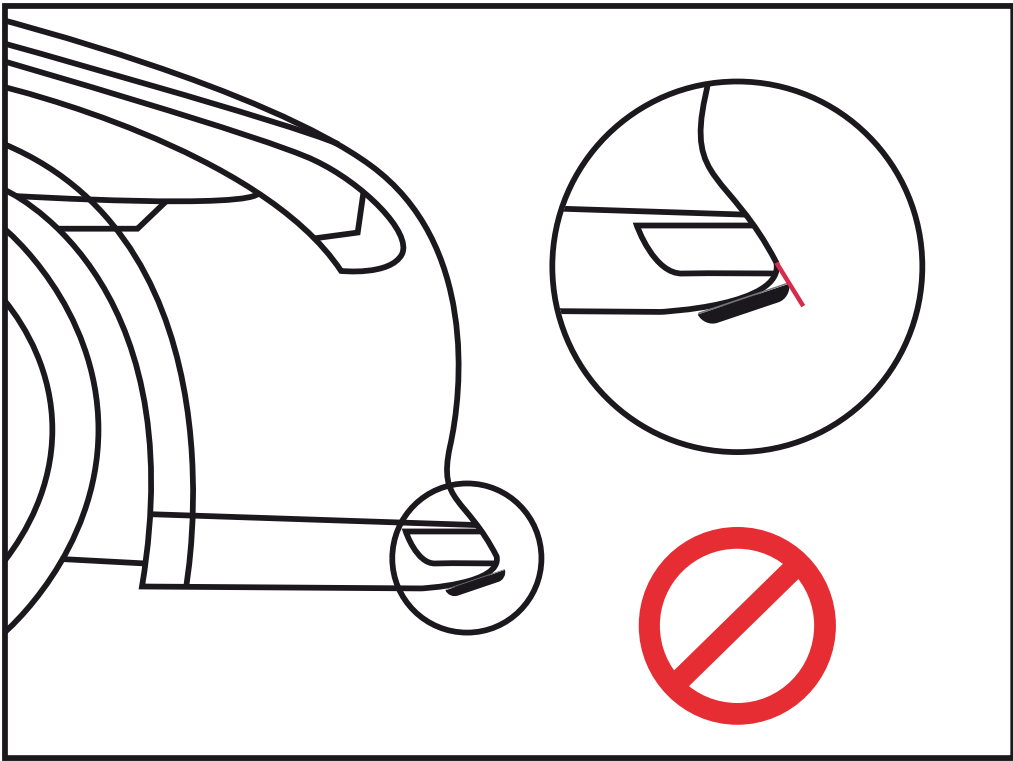

A good rule of thumb is to always leave about 1/8" of spacing from the beveled edge of the bumper to the front protective section of SLIPLO. This will prevent rocks or contaminants from getting stuck in between the SLIPLO and the surface area.

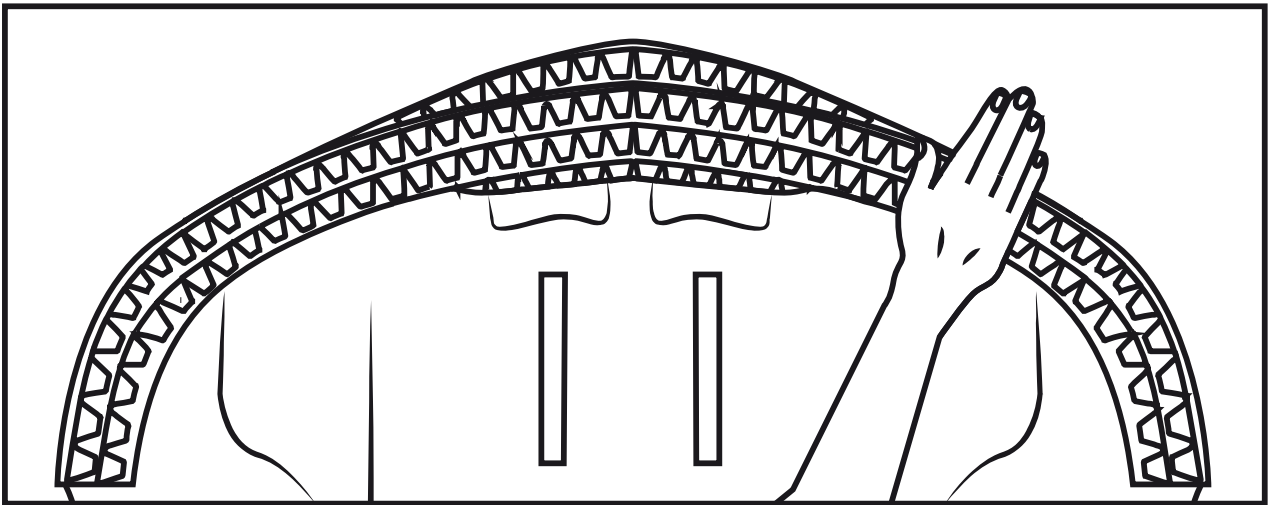

Always take extra care to install the adhesive section of SLIPLO on a flat surface, ensuring that there won't be any pop ups in the future. Install all of the remaining pieces of SLIPLO, ensuring the protection of the front lip impact area of your bumper. Go over and firmly press each piece down using the palm of your hand insuring that adhesive is fully activated.

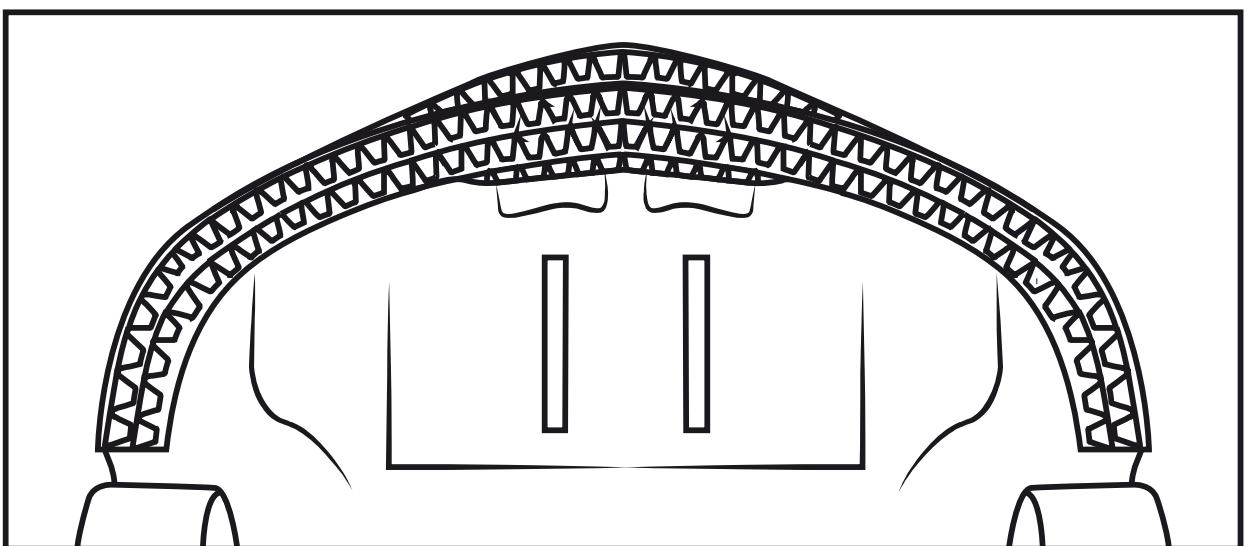



WARNING



Do not wash the car for up to 48 hours after the adhesive is applied to ensure that it fully dries and cures.



Avoid placing SLIPLO on screws, bolts, on top of vinyl wraps, paint protection film, sealants, and waxes. Incorrect installation could lead to adhesive failure.



Keep all items of this kit away from young children. Dispose of the adhesive promoter immediately after use. Please refer to 3M adhesive promoter safety data sheet for further safety and handling instructions.



Our #1 priority here at SLIPLO is your happiness. Which means we stand by our product 100%, no matter what, no questions asked, no holds barred, no ifs ands or buts. If you have a problem, we will solve it. Just reach out to our Customer Happiness Team. We are here for you.

Happiness Guaranteed

☺



SLIPLO warrants that installed SLIPLO Universal Skid Plates will be free of defects in materials and workmanship for ten (10) years from the date of purchase. Covered defects include peeling, lifting, cracking and delamination. This warranty does not extend coverage to damage caused by normal wear and tear, road debris impact, accidents, collisions, incorrect installation or intentional damage of any kind.

Installation Instructions

Recommended Tools

- 70% Isopropyl alcohol (IPA) – Optionally, this kit might contain an applicator pack (only if allowed by country & shipping regulations).
- 3M Adhesion promoter – Optionally, this kit might contain an applicator pack (only if allowed by country & shipping regulations). If not within box, please find a comparable adhesive promoter to 3M adhesion promoter 4298 or 3M 06393.
- White Towel
- Sharp Scissors or a shear
- Marker
- Measuring Tape

For best results, we recommend placing the front of the car on a ramp or a lift where the surface is visible to the naked eye.

SURFACE CLEANING

Use the 70% Isopropyl alcohol (IPA) and a towel to clean the surface of any oily layer or contamination on your car. Where heavy oil, grease or a ceramic coating is present, a “degreasing” solvent such as gasoline can be used to remove any contaminants. However, take extreme care not to damage the paint. When cleaning with solvent, always follow with an IPA clean to remove any remaining residue. Make sure to let the surface sit until fully dry before moving onto the next step.



ADHESION PROMOTER

Make sure to use a glove when handling any type of adhesive promoter. Quickly apply a single thin layer of the adhesive promoter to the surface area using the applicator sponge. Make sure to let the surface sit until fully dry before moving onto the next step. If the surface has preexisting damage, make sure you focus on these areas with the application of extra promoter.

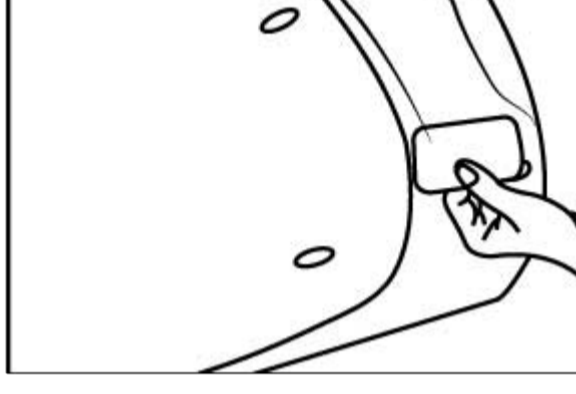
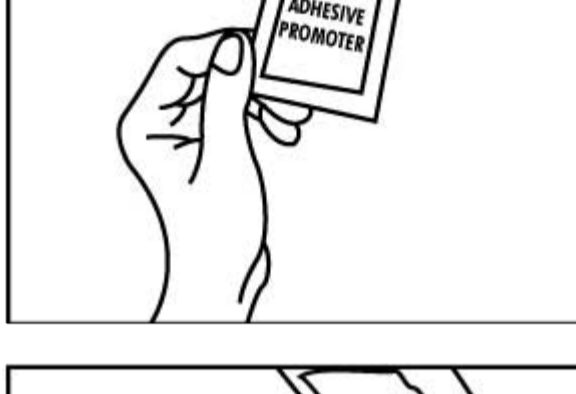

FITMENT TEST

Do not remove any of the red adhesive liner during this testing segment. Place your first piece of SLIPLO up against the surface area you want to protect. Generally, a good rule of thumb is to start from the center of the bumper and test each consecutive piece, moving towards the driver side of the car. Use your pen to mark any overlaps, screws, and holes on the SLIPLO piece which require any type of cutting. Once satisfied, move onto the next piece and repeat.

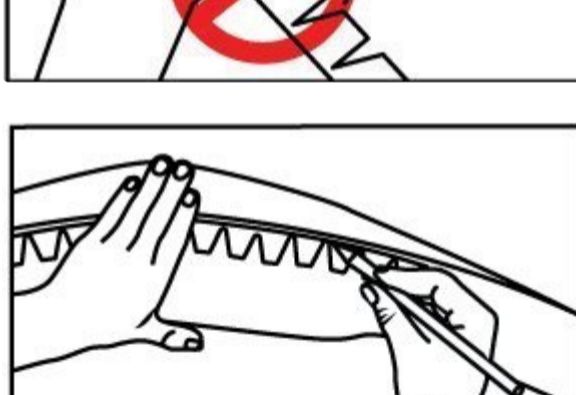
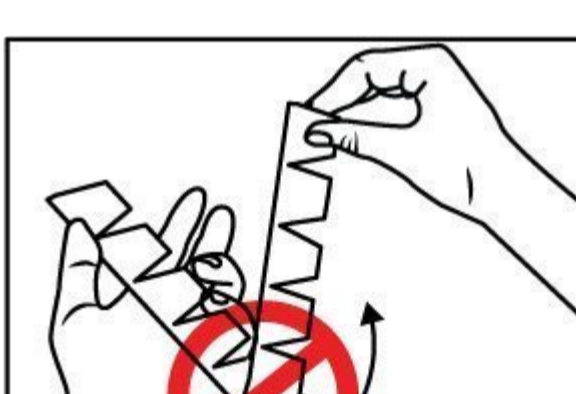

FINAL ADJUSTMENTS

Using your sharp scissors, cut any marked SLIPLO pieces from the previous step. Double check the fitment of each cut piece against the surface. Remember to cut only as much excess material as necessary, ensuring maximum bond integrity of each individual piece.

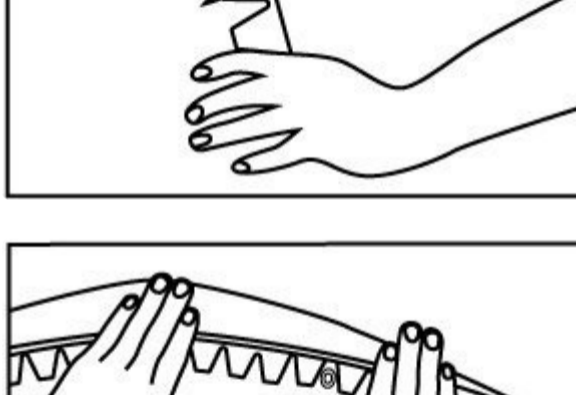
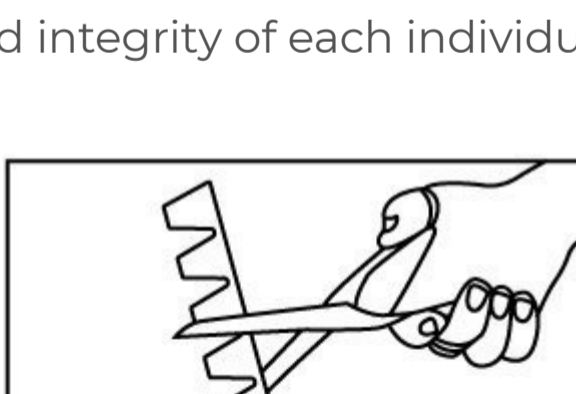

FINAL APPLICATION



Remove the adhesive red liner from the back of the SLIPLO piece.

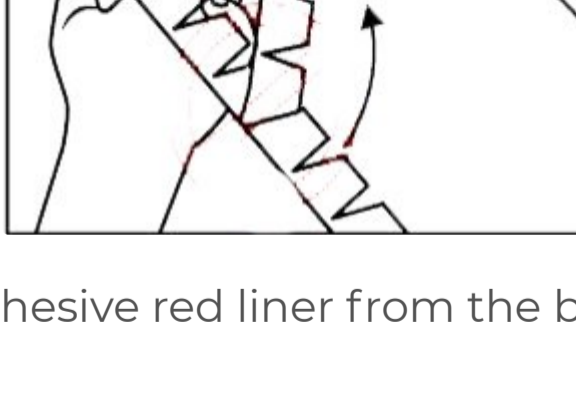

Starting from the center, lightly apply your first piece.

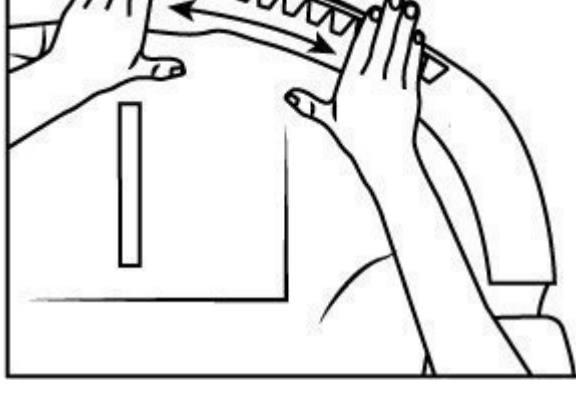

By pressing lightly, you will be able to easily pull off the Sliplo for re-positioning.