

#DS390 Dual Shock Kit for DODGE RAM Pickups INSTALLATION INSTRUCTIONS



NOTE: IF INSTALLING THIS FRONT DUAL SHOCK KIT IN CONJUNCTION WITH A SKYJACKER® SUSPENSION LIFT KIT, SKIP TO STEP #3.

NOTE: ON 2001/2002 MODELS WITH CUMMINS DIESEL, THE DRIVERS SIDE BRAKE LINE, (HARD LINE), WILL NEED TO BE SLIGHTLY BENT OUT AND AWAY FOR NEEDED CLEARANCE OF THE ADDITIONAL SHOCK AND SHOCK BRACKET.

1. Secure and properly block the tires of vehicle on a level concrete or asphalt surface. Open hood, remove the upper shock nuts and retainers, remove the 3 nuts on the upper shock tower brackets and remove brackets.
2. Jack up front of vehicle and install jack stands under frame behind the lower link rear brackets. Remove tires. Lower front axle down until coil springs become loose. Remove coils, rubber insulator and 3-bolt tower ring.
3. Locate the upper link axle mount behind each coil spring. Take a furnished 12mm bolt and check hole below upper link bolt on outboard side of each upper link axle mount to be sure holes are large enough to accept bolt. (In most cases they are, but if not, you must drill out holes to 1/2", see picture #1.) Remove original upper link bolt and reinstall*, with a large 1/2" washer, going through the slotted hole of new lower dual shock bracket (there is a left and a right bracket - install with the slotted hole up, and the brackets should slope forward at bottom end to align with bottom hole). Using a large 1/2" flat washer and 12mm self locking nut furnished, tighten upper link bolts.

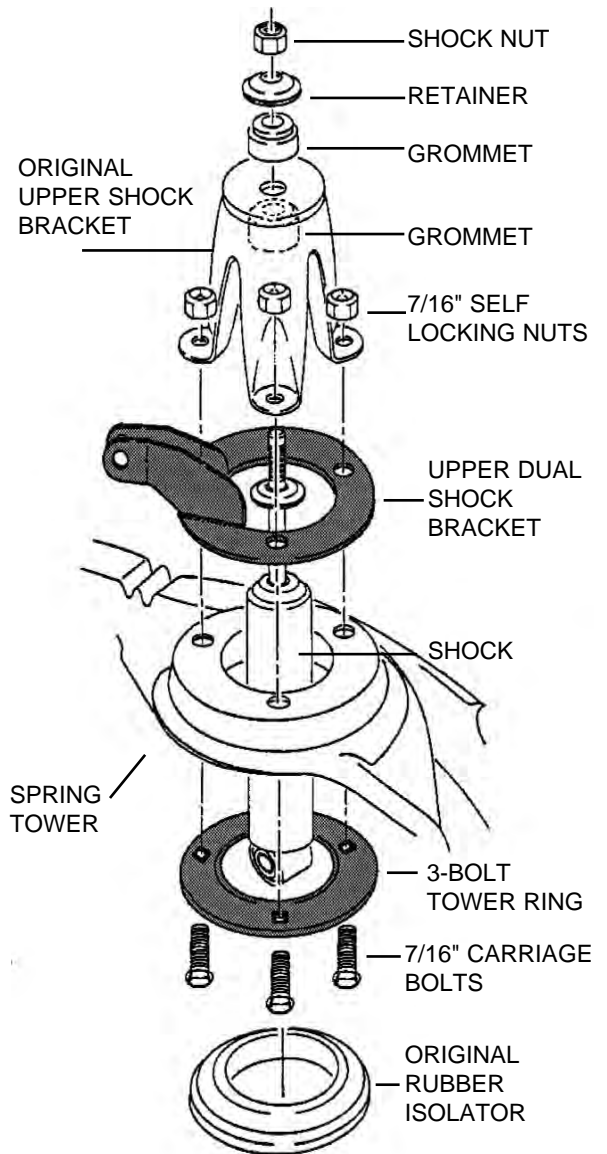

***NOTE:** If installing this dual shock kit in conjunction with a Skyjacker® "D45" or D50" lift, use 12 x 110mm (4 1/2" long) upper link bolt (furnished in lift kit) with a large 1/2" washer each side and a 2.375" long steel sleeve inside the original axle mount to maintain original spacing. Also the dual shock bracket goes on after the upper link relocating bracket as you can see in picture #8 of the lift kit instructions.



Picture #1



Picture #2

NOTE: The bottom bracket must sit flush against the upper control arm mount. If you are not installing this dual shock kit on a 4-5" Skyjacker lift. You must place "2" 1/2" washers (provided) under each bolt between lower bracket and control arm mount.

- Now install the new lower bolts with the bolt heads facing outward (nuts to the inside) with a small 1/2" washer under each bolt head. Now tighten all bolts. **NOTE:** If installing this dual shock kit in conjunction with a Skyjacker® lift kit, return to lift kit instructions at this time and when referred back to dual shock kit instructions, continue with step below.

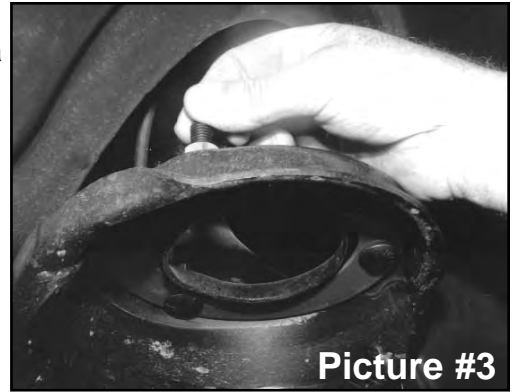

- Start new 3-bolt tower ring (with square holes using 7/16" carriage head bolts supplied) up into position. Start bolts one at a time (you **must** be sure the bolt heads are aligned in the square holes) using 7/16 "standard" nuts to hold in place (do not use self locking nuts, they will be used later). Tighten nuts and repeat step on other side. (See picture #3).



- Start coil springs at bottom first, place rubber isolator on top of coil and then start coil into position in the upper tower, on both sides (see picture #4). Align coil springs so that the bottom end of the coils are turned to the inside - center of the axle. Lift up on jack under differential until coil springs are securely in place, and keep a load on them to hold in place.



- If installing new shocks in original factory location in center of coil spring (included in lift kit - not the new "dual" shock on outside of coil), install shock down through center of coil spring tower and tighten lower shock bolt. **NOTE:** If installing this dual shock kit in conjunction with a Skyjacker® lift kit, return to lift kit instructions at this time and when referred back to dual shock kit instructions, continue with step below.

- Now remove 7/16" standard nuts that were installed on 3-bolt tower ring in step 7. Install new upper dual shock bracket over 3 bolts of tower ring (see picture #6), then the original upper shock bracket (there is a left and a right bracket - the attached shock mounts should curve rearward on each side). Install the 7/16" self locking nuts and tighten. Install shock grommets, retainer washers, nuts and tighten.

- Using new 1/2 x 2 1/2" bolts provided, install new shocks onto new upper and lower dual shock brackets. **NOTE:** If installing this dual shock kit in conjunction with a Skyjacker® lift kit, return to lift kit instructions at this time (you are through with these instructions).

- Install tires, remove jack stands, and lower vehicle to the ground.

