



# 1979 - 1985 Toyota Pick Up Single Steering Stabilizer Installation Instructions

## REQUIRED TOOL LIST:

- Safety Glasses
- Metric / Standard Wrenches & Sockets
- Tape Measure
- Torque Wrench

---

## Component Box Breakdown:

### Part #: 7070 / 9070 / 7175 / 9175

Item #	Description	Qty	Item #	Description	Qty
7900WS	WHITE STEERING DAMPER (Included With 7070 / 7175)	1	BTIE-K	BLACK BOOT TIE (Included With 9070 / 9175)	1
9900WS	SILVER STEERING DAMPER (Included With 9070 / 9175)	1	HSS	HYDRO SHOCK DECAL (Included With 7070 / 7175)	1
B10RS	RED BOOT (Included With 7070 / 7175)	1	SSD	SILVER STABILIZER DECAL (Included With 9070 / 9175)	1
B10KS	BLACK BOOT (Included With 9070 / 9175)	1	HB-7070	HDWR BAG: 7070/7175/9070/9175	1
BTIE	RED BOOT TIE (Included With 7070 / 7175)	1	I-7070/7175	INST SHEET: 7055 / 9055	1

## Hardware Bag Breakdown:

### Part # HB-7070

Item #	Description	Qty	Item #	Description	Qty
83161	TIE ROD BRACKET	1	38FTN	3/8 FINE THRD LOCK NUT	1
516X1X134U	5/16 X 1 X 1 3/4 U-BOLT	1	38SAEW	3/8 SAE WASHER	1
38X112FTB	3/8 X 1 1/2 FINE THREAD BOLT	1	STEM BUSH-SST	STEM BUSHING	4
516CTN	5/16 COARSE THRD LOCK NUT	2	142120	STAB WASH PKG	2
516SAEW	5/16 SAE WASHER	2			

## **Installation:**

1. Park the vehicle on a level concrete or asphalt surface with the front tires / wheels pointing straight forward.
2. Set the emergency brake & block the rear tires / wheels.
3. Install the body end of the new Skyjacker steering stabilizer onto bracket "A".
4. Extend the new Skyjacker steering stabilizer shaft out 4" (exactly half way) & attach bracket "B" to the tie rod using the supplied u-bolt & 3/8" bolt. The supplied 3/8" bolt will be attached to the lower forward hole on bracket "B". The supplied u-bolt will be attached around the tie rod & through bracket "B".

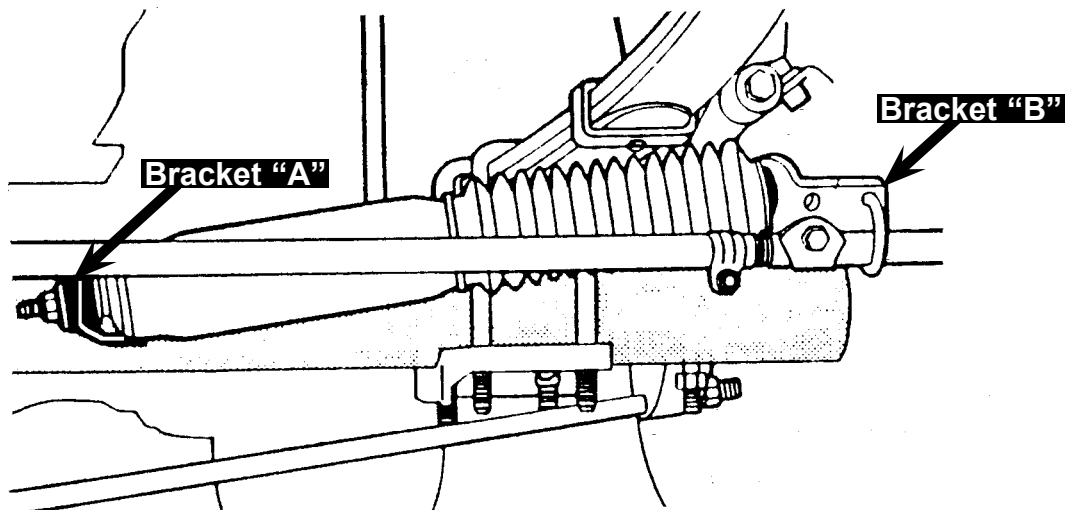
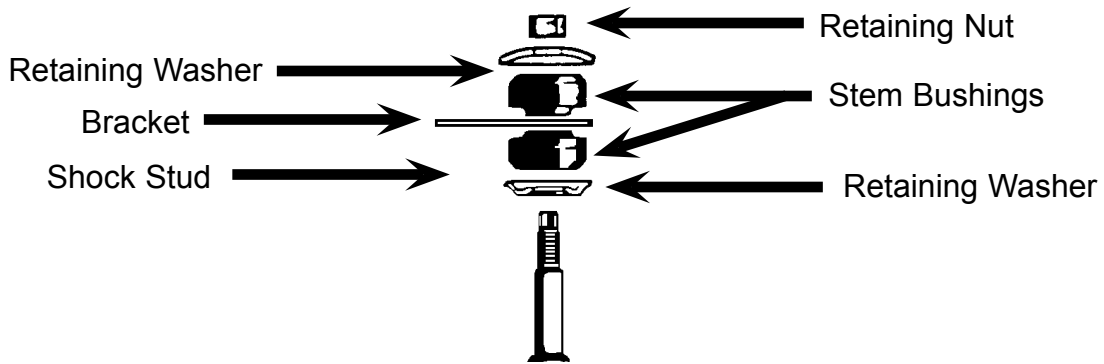

## **Final Notes:**

- After the installation is complete, double check that all nuts & bolts are tight. Refer to the following chart for the proper torque specifications. (Do not retighten the nuts & bolts where thread lock compound was used.)
- Cycle the steering of the vehicle left to right & check all parts for adequate clearance.
- After the first 100 miles, check all of the hardware for the proper torque & periodically thereafter.

<b><u>TORQUE SPECIFICATIONS</u></b>					
<b><u>INCH SYSTEM</u></b>			<b><u>METRIC SYSTEM</u></b>		
<b>Bolt Size</b>	<b>Grade 5</b>	<b>Grade 8</b>	<b>Bolt Size</b>	<b>Class 8.8</b>	<b>Class 10.9</b>
5/16	15 FT LB	20 FT LB	6MM	5 FT LB	9 FT LB
3/8	30 FT LB	35 FT LB	8MM	18 FT LB	23 FT LB
7/16	45 FT LB	60 FT LB	10MM	32 FT LB	45 FT LB
1/2	65 FT LB	90 FT LB	12MM	55 FT LB	75 FT LB
9/16	95 FT LB	130 FT LB	14MM	85 FT LB	120 FT LB
5/8	135 FT LB	175 FT LB	16MM	130 FT LB	165 FT LB
3/4	185 FT LB	280 FT LB	18MM	170 FT LB	240 FT LB

- The above specifications are not to be used when the bolt is being installed with a bushing.

**Seat Belts Save Lives, Please Wear Your Seat Belt.**