



1979-1985 Toyota Pick-Up Dual Steering Stabilizers Part # 7275 & 7276

Part # 7275

Part #	Description	Qty.
7900	WHITE STEERING DAMPER	2
83092	MAIN BRK FOR 7275	1
83100	TIE ROD BRKT FOR 7275, 7276	1
716SAEW	7/16 SAE WASHER	2
STEM BUSH-SST	STEM BUSHING-STEERING STAB.	8
142120	STAB WASH PKG - P889/145098	4
38X418X4U	3/8 X 4 1/8 X 4 U-BOLT SQ	1
516X1X134U	5/16 X 1 X 1 3/4 U-BOLT RD	2
516SAEW	5/16 SAE WASHER	4
38SAEW	3/8 SAE WASHER	2
38CTN	3/8-16 COARSE N/I LOCK NUT	2
516CTN	516-18 COARSE N/I LOCK NUT	4
716X112FTB	7/16 X 1 1/2 FINE THRD BOLT	1
716FTN	7/16-20 FINE N/I LOCK NUT	1
B10RS	RED BOOT	2
BTIE	RED BOOT TIE	2
HSS	HYDRO SHOCK DECAL	2

Part # 7276

Part #	Description	Qty.
7900	WHITE STEERING DAMPER	2
83101	MAIN BRKT FOR 7276	1
83100	TIE ROD BRKT FOR 7275, 7276	1
716SAEW	7/16 SAE WASHER	2
STEM BUSH-SST	STEM BUSHING-STEERING STAB.	8
142120	STAB WASH PKG - P889/145098	4
38X418X4U	3/8 X 4 1/8 X 4 U-BOLT SQ	1
516X1X134U	5/16 X 1 X 1 3/4 U-BOLT RD	2
516SAEW	5/16 SAE WASHER	4
38SAEW	3/8 SAE WASHER	2
38CTN	3/8-16 COARSE N/I LOCK NUT	2
516CTN	516-18 COARSE N/I LOCK NUT	4
716X112FTB	7/16 X 1 1/2 FINE THRD BOLT	1
716FTN	7/16-20 FINE N/I LOCK NUT	1
B10RS	RED BOOT	2
BTIE	RED BOOT TIE	2
HSS	HYDRO SHOCK DECAL	2

1. Park the vehicle on level ground & place the tires / wheels in a straight forward position. Set the emergency brake & block the rear tires.
2. Place main bracket "A" around the front face of the axle as shown. Install the square u-bolts & secure with washers & nuts. DO NOT TIGHTEN AT THIS TIME.
3. Attach the tie rod bracket "B" on the tie rod as shown. Install the 7/16" bolt through the bracket using the nuts & washers supplied. BE SURE THE FLAT WASHERS GO BETWEEN THE BRACKET & THE TIE ROD. Secure loosely with the washer & lock nut.
4. Attach the body end of the stabilizers to the main bracket & connect the other end. Extend the stabilizer shafts out exactly 4.08" & install onto both brackets using the stem bushings & washer pack supplied. Adjust the brackets so that full clearance is obtained.
5. Cycle the tires / wheels left to right & check for adequate clearance. Re-tighten all hardware after the first 100 miles & periodically there after.

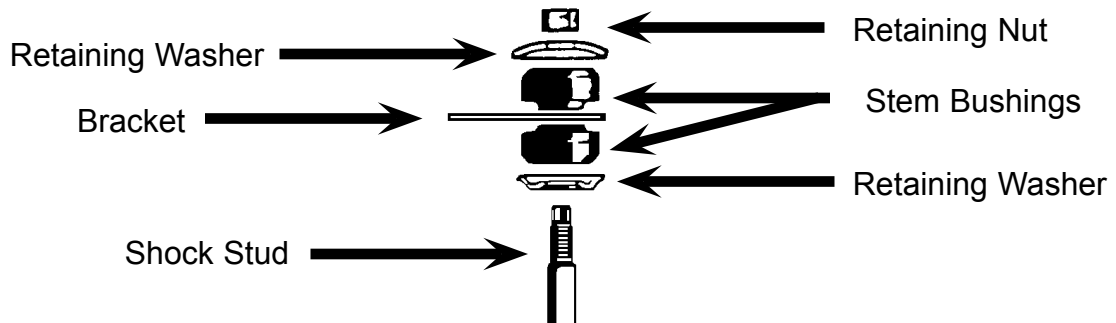

Note: Photo shows 79-83 models. The main bracket will look slightly different on 84-85 models.

