



Ford Ranger / Broncoll /  
Explorer  
Single Steering Stabilizer  
Part # 7150

Part #	Description	Qty.
7900	WHITE STEERING DAMPER	1
83032	BACKING BRKT FOR 7150,7250	1
83031	MAIN BRKT - 7109,7150,KS150	1
83037	UNIVERSAL TIE ROD BRACKET	1
516X1X134U	5/16 X 1 X 1 3/4 U-BOLT RD	2
516CTN	516-18 COARSE N/I LOCK NUT	4
516SAEW	5/16 SAE WASHER	4
38X112FTB	3/8 X 1 1/2 FINE THRD BOLT	2

Part #	Description	Qty.
38FTN	3/8-24 FINE N/I LOCK NUT	2
38SAEW	3/8 SAE WASHER	2
STEM BUSH-SST	STEM BUSHING-STEERING STAB.	4
142120	STAB WASH PKG - P889/145098	2
B10RS	RED BOOT	1
BTIE	RED BOOT TIE	1
HSS	HYDRO SHOCK DECAL	1

**Installation:**

1. Park the vehicle on level ground & place the tires / wheels in a straight forward position. Set the emergency brake & block the rear tires.
2. Place the main bracket "A" against the outside of the frame & backing plate on the inside of the frame & install the bolts provided through the backing plate, through the slotted holes in the frame & main bracket. **(See Note Below)**
3. Loosely install the tie rod bracket using the u-bolts, nuts, & washers provided. (Bracket "B")
4. Attach the body end of the stabilizer to the main bracket & other end to the tie rod bracket.
5. Extend the stabilizer shaft out 4"(exactly half way) & mount in place. Rotate the tie rod bracket as needed to obtain the best position. Tighten all hardware securely on the bolts & u-bolts at this time.
6. Cycle the tires / wheels left to right & check all hardware for clearance. Re-tighten after the first 100 miles & periodically there after.

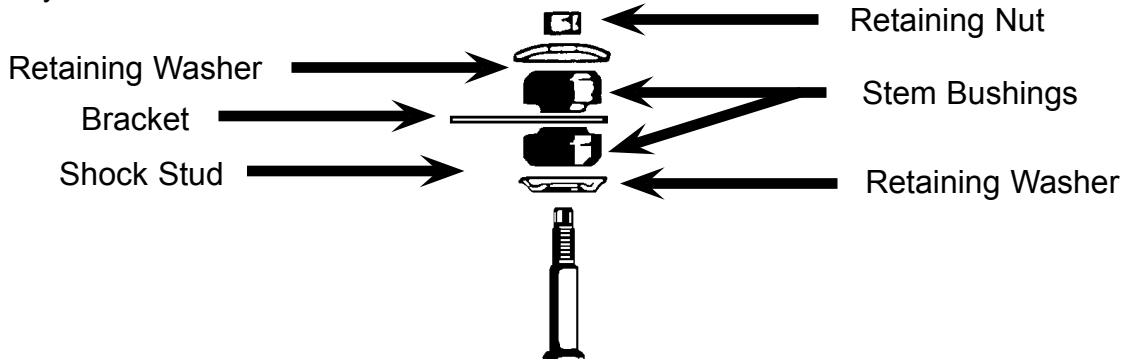

**Note:** Models with a front sway bar will need to move bracket "A" back (away from the sway bar) until clearance of the sway bar is obtained.

