

# 99353

## Dimensions

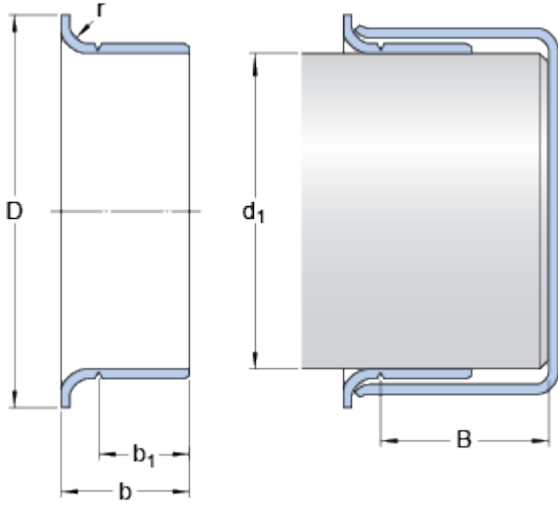

### Shaft diameter range

$d_1$	min.	89.916	mm
$d_1$	max.	90.094	mm

### Nominal dimensions

$d_1$		90	mm
$D$		101.6	mm
	$\pm$	1.6	mm
$b$		16.942	mm
	$\pm$	0.8	mm
$b_1$		13.36	mm
	$\pm$	0.8	mm
$B$	max.	44.45	mm
$r$	max.	3.18	mm