

99241

Dimensions

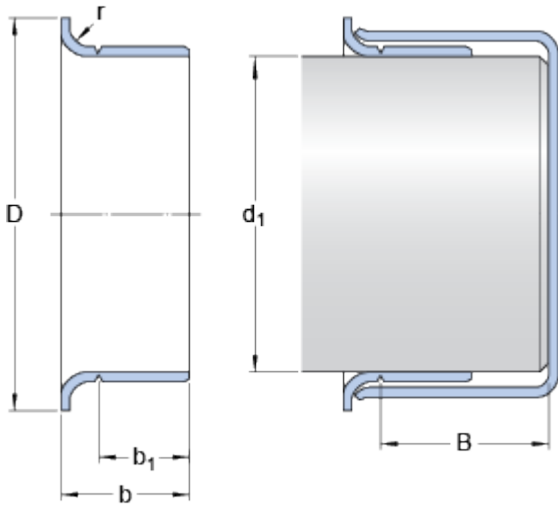

Shaft diameter range

d_1 min. 59.919 mm

d_1 max. 60.071 mm

Nominal dimensions

d_1 60 mm

D 70.739 mm

\pm 1.6 mm

b 11.43 mm

\pm 0.8 mm

b_1 9.398 mm

\pm 0.8 mm

B max. 37.363 mm

r max. 3.18 mm