

99220

Dimensions

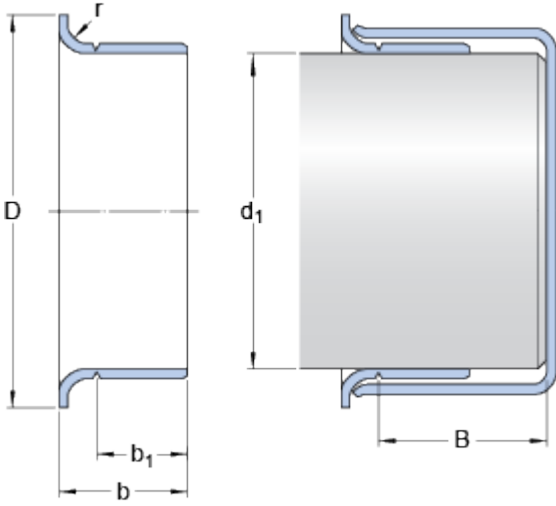

Shaft diameter range

d_1 min. 55.829 mm

d_1 max. 55.982 mm

Nominal dimensions

d_1 56 mm

D 64.287 mm

\pm 1.6 mm

b 15.875 mm

\pm 0.8 mm

b_1 12.7 mm

\pm 0.8 mm

B max. 33.35 mm

r max. 3.18 mm