

99196

Dimensions

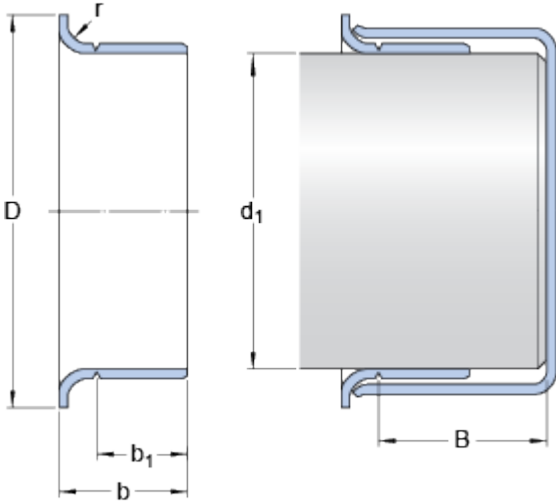

Shaft diameter range

d_1 min. 49.911 mm

d_1 max. 50.063 mm

Nominal dimensions

d_1 50 mm

D 56.998 mm

± 1.6 mm

b 16.967 mm

± 0.8 mm

b_1 13.995 mm

± 0.8 mm

B max. 24.994 mm

r max. 3.18 mm