

# 99189

## Dimensions

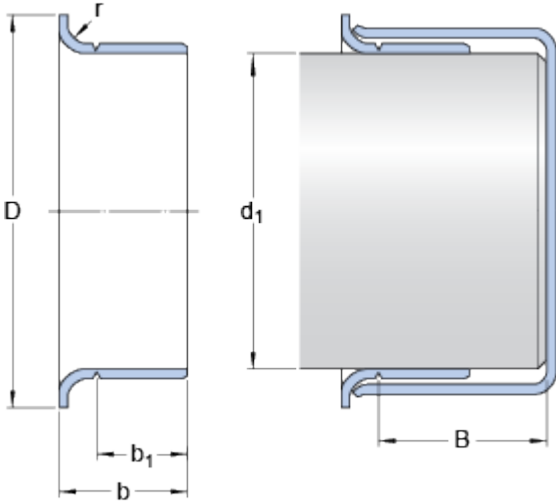

### Shaft diameter range

$d_1$  min. 47.93 mm

$d_1$  max. 48.082 mm

### Nominal dimensions

$d_1$  48 mm

$D$  56.007 mm

$\pm$  1.6 mm

$b$  16.967 mm

$\pm$  0.8 mm

$b_1$  13.995 mm

$\pm$  0.8 mm

$B$  max. 24.994 mm

$r$  max. 3.18 mm