

# 99087

## Dimensions

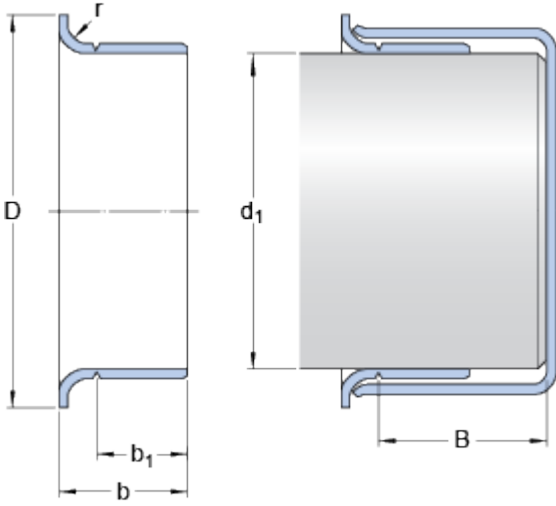

### Shaft diameter range

$d_1$	min.	22.174	mm
$d_1$	max.	22.276	mm

### Nominal dimensions

$d_1$		22.225	mm
D		27.788	mm
	±	1.6	mm
b		11.125	mm
	±	0.8	mm
$b_1$		7.95	mm
	±	0.8	mm
B	max.	50.8	mm
r	max.	3.18	mm