

# 99062

## Dimensions

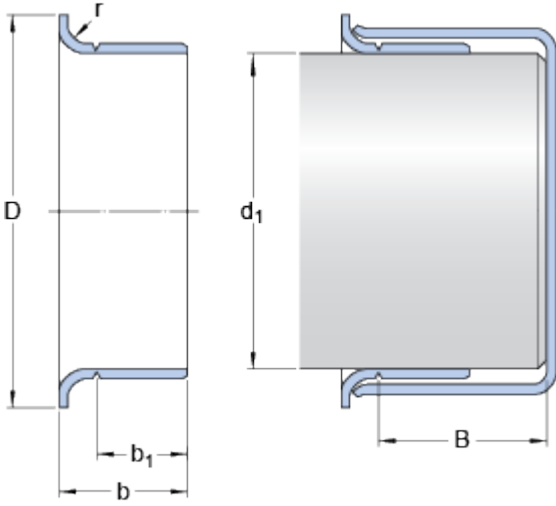

### Shaft diameter range

$d_1$	min.	15.824	mm
$d_1$	max.	15.926	mm

### Nominal dimensions

$d_1$		15.875	mm
D		19.05	mm
	±	1.6	mm
b		10.312	mm
	±	0.8	mm
$b_1$		7.95	mm
	±	0.8	mm
B	max.	50.8	mm
r	max.	3.18	mm