



# HIGH BUILD CUSTOM FILL<sup>+</sup>

## THE **NEW** CUSTOM FILL FOR **HIGHER BUILD & QUICKER COVERAGE**

### FEATURES

- One SKU for all major solvent paint systems
- Superior basecoat and single stage hiding
- Shop floor (NESHAP 6H) compliance
- Utilize your preferred primer, basecoat, or clear with your activator to ensure proper mix
- Professional spray pattern
- Consistent sprayout
- Comfort tip that eases finger fatigue
- No clean up, waste, or hazardous material generation
- 1K & 2K compliant

**PART | 62013**



### COMPATIBLE COATINGS

- 1K solvent primers
- 2K primers
- Urethane and enamel single stage paints
- Solvent basecoats
- 1K & 2K clearcoats
- Rust Trap<sup>™</sup>



**LOOK FOR OUR OTHER GREAT  
CUSTOM FILL AEROSOLS**



# HOW TO FILL A CUSTOM FILL AEROSOL BLANK

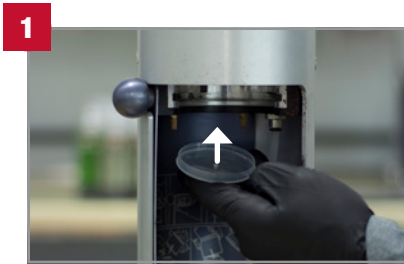

## PLACE DISC IN MACHINE

! Air pressure must be at least 120 PSI at the pneumatic machine for proper function.

Remove disc from cap and cover piston inside the fill machine.

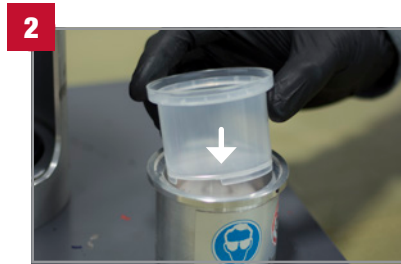

## PLACE CAP INTO CYLINDER

Place clear plastic cap cup into the **Fill Cylinder**. Press down and rotate cap until it drops into place.

! Do not fill cap prior to inserting in **Fill Cylinder**.

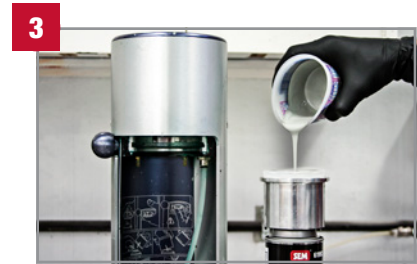

## FILL WITH COMPATIBLE PAINT

Remove the tip from the aerosol.

Press the cylinder/cap assembly on top of aerosol blank.

Fill the clear plastic cap with paint to the fill line.

! Make sure the **Custom Fill Aerosol Blank** is compatible with coating type.



## LOCK ASSEMBLY IN PLACE

Place assembly into machine.

Hold cylinder and can assembly in place and tighten pedestal on bottom.



## FILL THE AEROSOL

Close door on **Custom Fill Machine**.

**MANUAL MACHINE:** Rotate crank until it stops and then rotate in the opposite direction until it stops.

**PNEUMATIC MACHINE:** After closing the door, the machine will fill the aerosol. Wait until the machine is silent. Open the door and loosen pedestal to remove assembly from the machine.



## REMOVE CAP & REPLACE TIP

Remove cylinder/cap assembly from aerosol blank. Hold cylinder and press down on a hard surface to remove clear cap.

Replace tip.

! Purge valve by test spraying for a few seconds until spray is uniform.

## RELATED PRODUCTS

Part	Product Name	Case	Size
61983	Custom Fill Color Coat™ Aerosol Blank	6	16 oz. Aerosol
61993	Custom Fill Aerosol Blank	6	16 oz. Aerosol
62003	Custom Fill Waterborne Aerosol Blank	6	16 oz. Aerosol
70701	Custom Fill Pneumatic Machine	1	Each

Part	Product Name	Case	Size
70704	Custom Fill Wall Bracket	1	Each
70706	Custom Fill Cylinder	1	Each
70801	Custom Fill Manual Machine	1	Each



# FILLING A CUSTOM FILL™ AEROSOL BLANK

## STANDARD OPERATING PROCEDURE

### 1 PREP



Remove disc from cap and insert over piston inside the fill machine. Place clear plastic cap into the **Fill Cylinder**. Press down and rotate cap until it drops into place.

⚠ Do not fill cap prior to inserting in **Fill Cylinder** and onto **Custom Fill Aerosol Blank**.

### 2 FILL THE CUP



Remove the tip from the aerosol. Press the cylinder/cap assembly on top of aerosol blank. Fill the clear plastic cap with paint to the fill line.

⚠ Solvent blanks can be filled with single stage urethane, enamel and lacquers as well as 2K primers, sealers and clear coats. The waterborne blank can be filled with most waterborne basecoats and top coats. Always check for compatibility prior to filling.

### 3 LOCK ASSEMBLY IN PLACE



Place assembly into machine. Hold cylinder and can assembly in place and tighten pedestal on bottom. Close door on **Custom Fill Machine**.

### 4 FILL THE AEROSOL



**FOR MANUAL MACHINE:** Rotate crank until it stops and then rotate in the opposite direction until it stops.

**FOR PNEUMATIC MACHINE:** After closing the door, the machine will fill the aerosol. Wait until the machine is silent. Open the door and loosen pedestal to remove assembly from the machine.

### 5 REMOVE CAP & REPLACE TIP



Remove cylinder/cap assembly from machine. Twist gently to remove cylinder from can. Hold cylinder and press down on a hard surface to remove cap. Replace tip.

⚠ Purge valve by test spraying for a few seconds until spray is uniform.

ⓘ Mark filled aerosol with coating type, color name

## PRODUCT LIST



## CUSTOM FILL AEROSOL BLANKS

Part	Product	Size
61983	Custom Fill for Color Coat™	16 oz. Aerosol
61993	Custom Fill (Solvent)	16 oz. Aerosol
62003	Custom Fill Waterborne	16 oz. Aerosol
62013	Custom Fill + High Build	16 oz. Aerosol



## MACHINES

Part	Product
70701	Custom Fill Pneumatic Machine
70704	Wall Bracket
70706	Fill Cylinder
70801	Custom Fill Manual Machine