

MOUNTING THE RADIO

DIN-ISO MOUNT / DOUBLE-DIN MOUNT

1. Snap the 5919L and the 5918R brackets to the 5916 kit panel.
2. Align, position and bolt the (2) aftermarket ISO-DIN or (1) DBL-DIN head unit to the 5919L/5918R brackets. Use hardware supplied with radio to secure the mounting brackets.

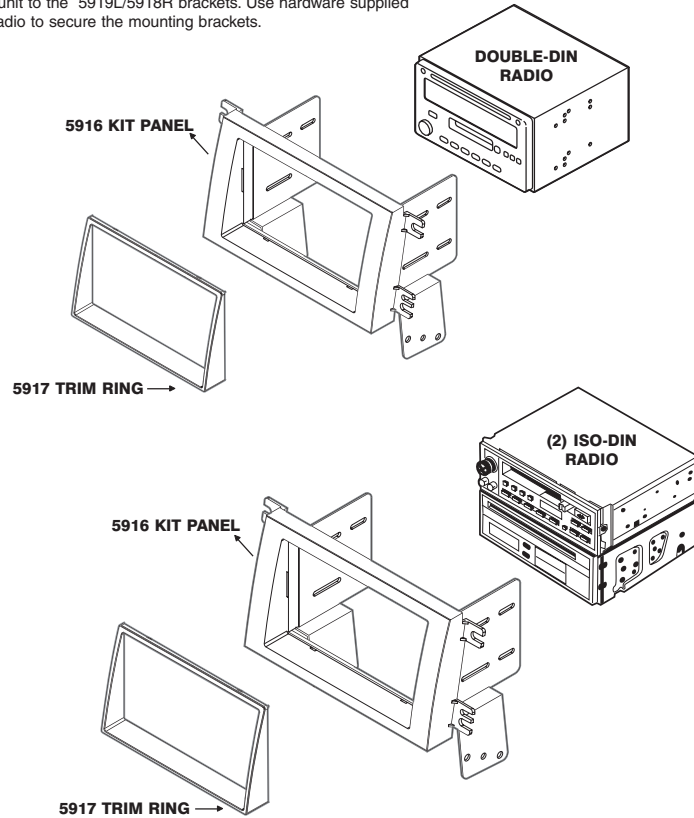

DASH DISASSEMBLY

RADIO REMOVAL AND IN-DASH INSTALLATION:

NOTE: The factory radio provision is for a Double-DIN.

1. Apply parking brake, and lower shifter all the way down to 1st gear.
2. Using panel removal tool, unsnap dash bezel surrounding radio, lift away, disconnect, and remove.
3. Extract (5) Philips head screws securing radio, lift away, disconnect, and remove.

SCOSCHE®

HA1579

DOUBLE DIN IN-DASH INSTALLATION KIT FOR 2006-UP HONDA RIDGELINE

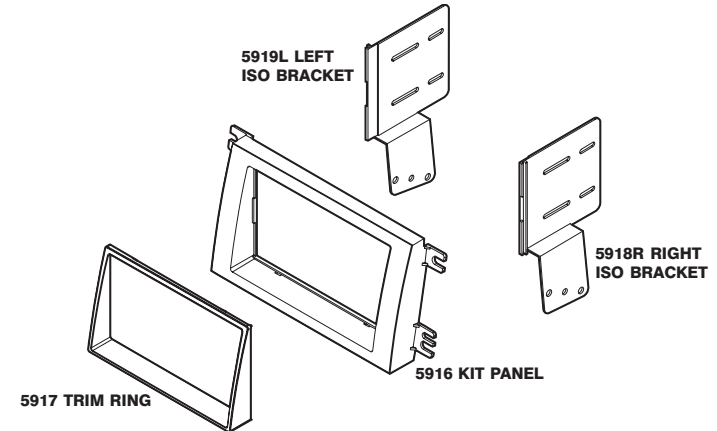

INTRODUCTION / PRELIMINARY

Thank you for purchasing the Scosche HA1579 Kit. This kit was manufactured with the highest of quality standards.

CAUTION:

DISCONNECT YOUR VEHICLE'S NEGATIVE BATTERY TERMINAL BEFORE THE INSTALLATION TO HELP PREVENT ELECTRICAL DAMAGE. WE RECOMMEND THE USE OF A VOLT/OHM METER OVER A TEST LIGHT TO CHECK WIRING. A TEST LIGHT OR GROUNDED WIRE PROBE CAN CAUSE DAMAGE TO THE VEHICLE'S COMPUTER AND/OR DIAGNOSTIC SYSTEMS. AVOID ALL FACTORY AIR BAG WIRING - AIR BAGS CAN ACCIDENTALLY DEPLOY CAUSING SERIOUS INJURY OR DEATH.

NOTES:

- See your vehicle's instructions for any special tools your installation might require.
- Read all instructions accompanying your car stereo/cassette player for proper wiring and mounting instructions.

CAR STEREO CONNECTORS

PROVIDE EASY CONNECTION OF YOUR CAR STEREO TO FACTORY WIRING HARNESS.

HA08
1998-UP Honda



LIABILITY DISCLAIMER

This instruction booklet is based on carefully documented data and research of automobile dash disassembly, wire harness/codes and information pertaining to installation of this kit (HA1579) in 2006 Honda Ridgeline. Scosche Industries, Inc. can not be held responsible for discrepancies/inconsistencies that may occur due to the automobile manufacturing changes or options, or damage that may occur in the automobile during the installation of components while using this booklet.