

Convert Model LT Single Pull Cable to Dual Pull Cable Head

DO NOT remove the looped safety pin in the extinguisher head until the pull cable is installed. The extinguisher will discharge if the pin is removed prior to inserting the activation cable.

The following instructions will help you convert the Model LT single pull cable head to a Dual Pull Cable head.

INSURE THAT THE SAFETY PIN IS INSTALLED IN THE MODEL LT SINGLE PULL CABLE HEAD OR PUSH KNOB SHAFT PRIOR TO BEGINNING

Remove the single pull cable activating head from the extinguisher (See pictures on next page):

Using a 1/8 inch punch, tap out the roll pin on the discharge head. It is located to upper left of the pressure gauge. **Drive it out from the gauge side of the head. Keep the pin.** Loosen set screw # 1 – almost all the way out - on the side on the discharge head. Twist and pull the top off of the discharge head.

Note: You may have to lubricate the “O” ring on the dual cable activation head. Any general purpose grease will do.

Twist and push the new dual pull cable head top onto the valve body, it will snap into place on the discharge head.

Tap in the roll pin from the gauge side of the head – otherwise the head may loosen on the cylinder and cause a leak..

Install the extinguisher in the vehicle.

Pull Cables

Mount the pull cable handles in the desired locations. We suggest a minimum of a 12 inch bend radius for the cable.

Remove the inner wire from each pull cable and cut the outer conduit to the length required, including the amount necessary to insert the conduit into the fitting. Install the pull cable ferrule into the hole that has Insert the end of the cable conduit in the conduit fitting on the side of the discharge head.

Insert the inner cable wire through the conduit until it passes out the back side of the head. Tighten the setscrew on the top of the black slide to secure the inner wire.

Clip off excess wire flush with back of the dual pull cable head.

Ensure that the set screws, that secure the inner wire on the black slide are secure.

Snap the plastic dust cap on the top of the discharge head to prevent dirt from getting into the head.



Model LT Single Pull Cable



Model LT Dual Pull Cable



Model LT10

SAFECRAFT
SAFETY EQUIPMENT

Convert Model LT Single Pull Cable to Dual Pull Cable Head

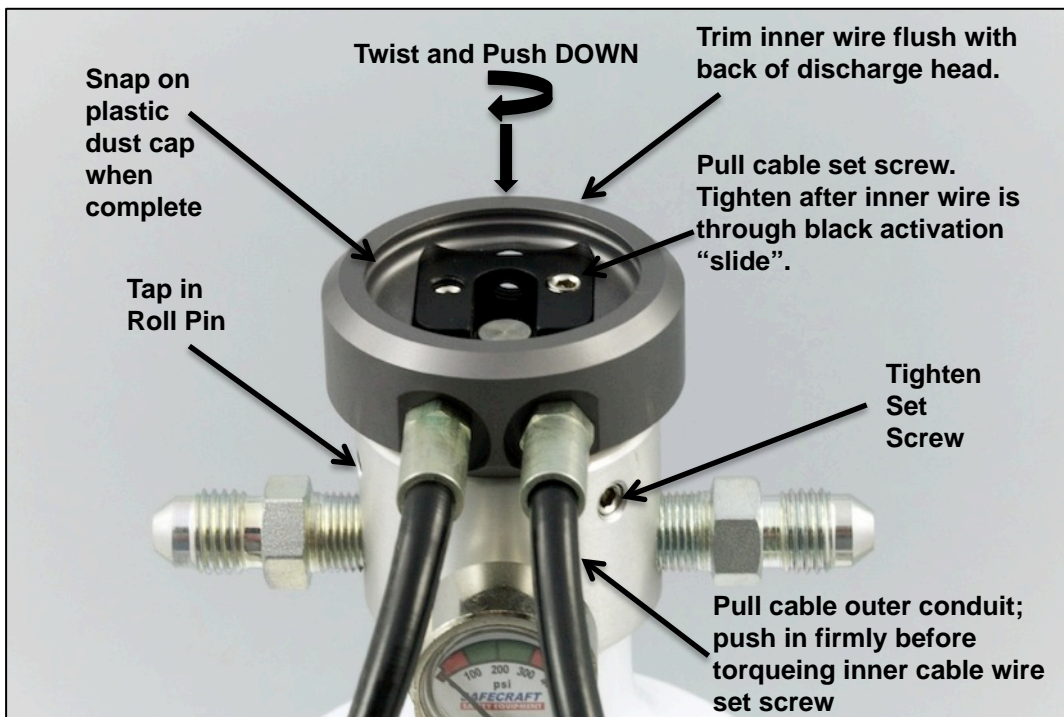
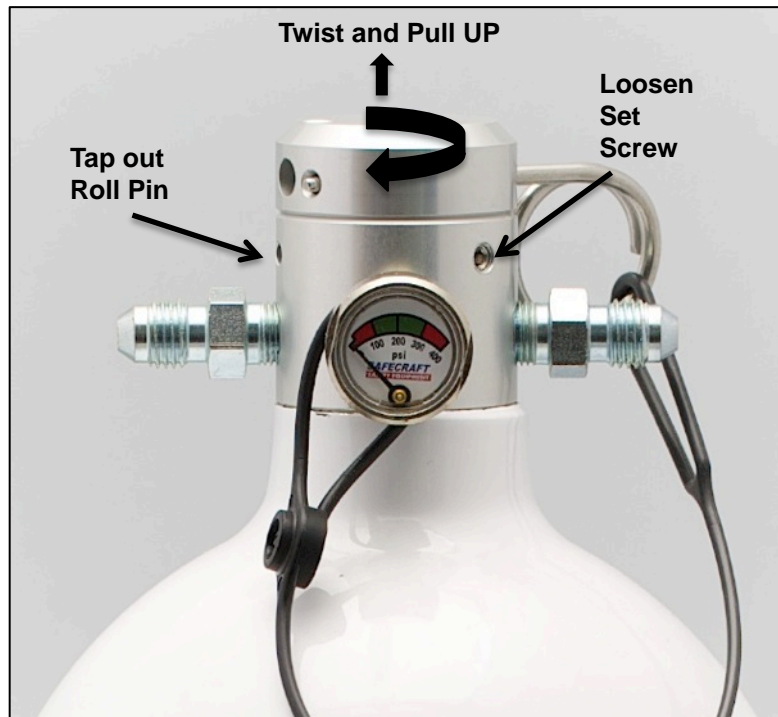

Convert Model LT Pull Cable Head to Pneumatic Head

ENSURE THAT THE SAFETY PIN IS INSTALLED IN THE EXISTING PULL CABLE HEAD PRIOR TO BEGINNING

Remove the Model LT pull cable head

Using a 1/8 inch punch, tap out the roll pin on the discharge head. It is located to the upper left of the pressure gauge. Drive it out from the gauge side of the head. Keep the pin.

Loosen set screw – almost all the way out - on the side on the discharge head.

Take the lanyard off from around the pressure gauge.

Twist and pull the top off of the discharge head.

Install the Model LT pneumatic head

Note: You may have to lubricate the “O” ring on the discharge head for the following step. Any general purpose lubricant will do.

Twist and push the new pneumatic activation head onto the extinguisher discharge valve. It will snap into place.

Tap in the roll pin from the gauge side of the head – otherwise the head may loosen on the cylinder and cause a leak.

Tighten set screw.

Install the extinguisher in the vehicle.

For suggested plumbing hookup, See Model LT Pneumatic System Hookup.



Model LT10



Model LT Pneumatic Head

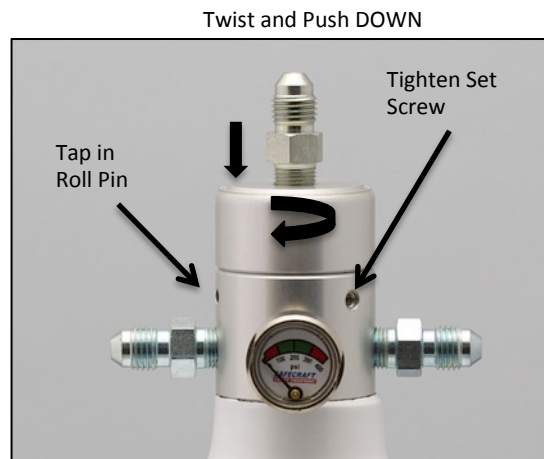
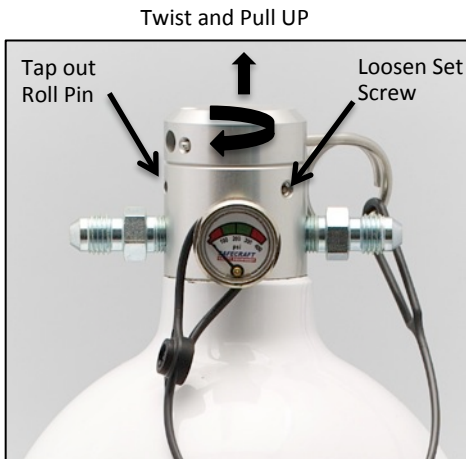

Model LT Family

SAFECRAFT
SAFETY EQUIPMENT

Model LT Push Cable Assembly

1. MOUNT BULKHEAD FITTING

Starting at the knob end, disassemble the cable end fittings by removing the safety pin with blue flag and unthreading the finger tight fasteners. Insert Bulkhead Fitting through bracket mounting hole. Slide on washer followed by 2 jam nuts

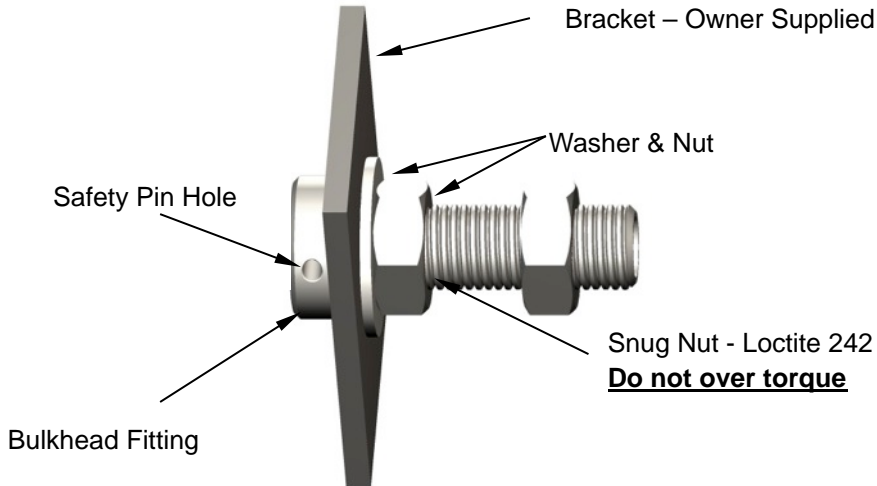

2. CABLE INSTALL AND ADJUSTMENT

Insert push cable shaft in from back of the bulkhead fitting and thread cable receptacle until the shaft protrudes about 1 inch. Adjustment is correct when safety pin/flag easily slips through the cross hole in the bulkhead fitting and engages the machined groove in the shaft.

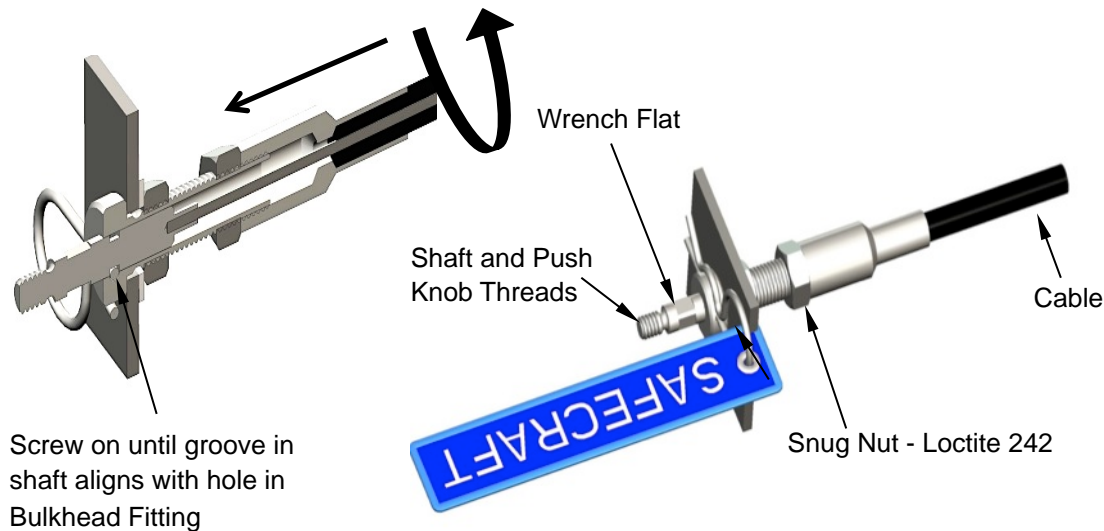

Model LT Push Cable



Model LT Push Cable

Model LT Push Cable Assembly

3. PUSH KNOB INSTALL

Thread on the push knob and hold the shaft with an open-end wrench on the machined flats. We recommend a thread locker like Loctite 242 on the threads. Position the word FIRE on the knob so it is horizontal.



4. CABLE AND CYLINDER ATTACHMENT

Ensure that the safety pin with the "Remove Before Flight" streamer is installed in cable head. Lubricate the O Ring on push cable head and push the cable head into extinguisher valve.

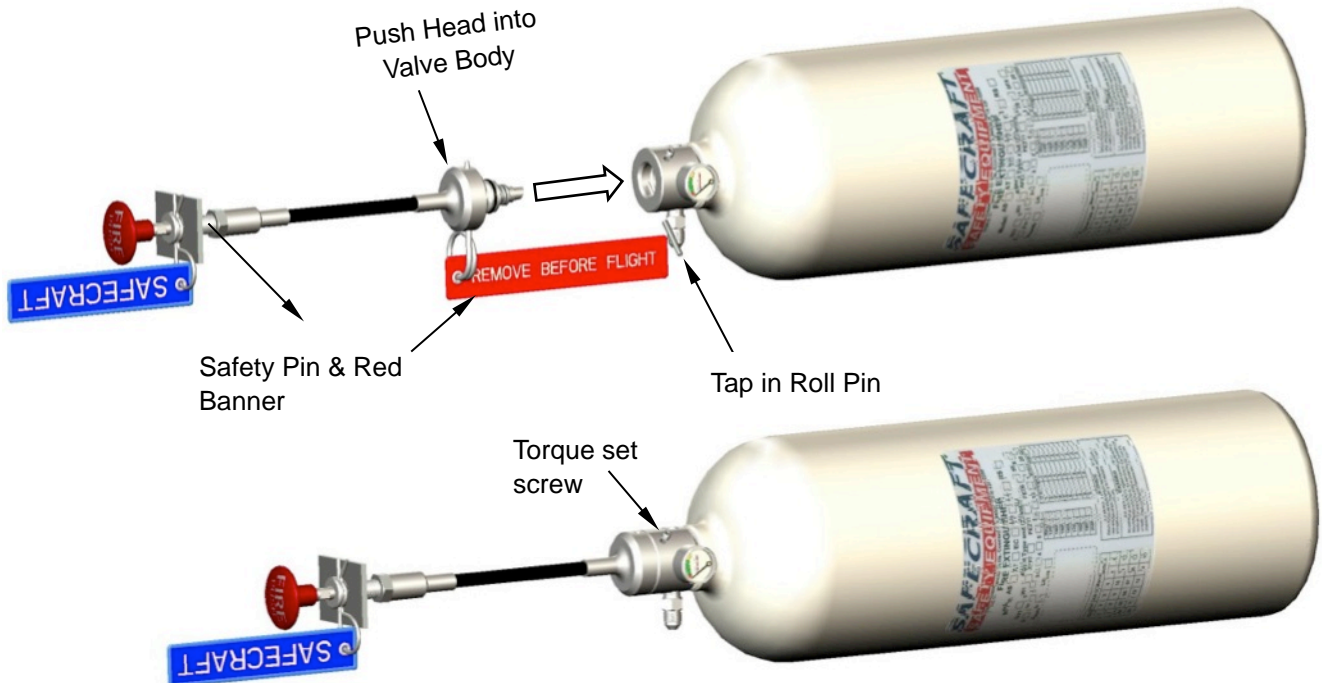

WARNING
TAKE OUT "REMOVE BEFORE FLIGHT" SAFETY PIN.
EXTINGUISHER WILL NOT FUNCTION WITH THIS PIN INSTALLED.

Model LT Pneumatic System Operation and Set-up

The Diagram below shows how to set up a Model LT pull cable extinguisher to a 2nd pneumatically activated extinguisher.

The pneumatic activation line can be either a hard line or flexible # 4 AN style hose.

DO NOT "T" the pneumatic activation line off a discharge line.

Install the pull cable for the manual discharge extinguisher as shown in the Model LT Install Guidelines.

Blue nozzle to driver.
1 required, run this nozzle
off of pull cable bottle

Pneumatic activation line to top of
pneumatic head
DEDICATED LINE – DO NOT "T"
OFF ANOTHER LINE

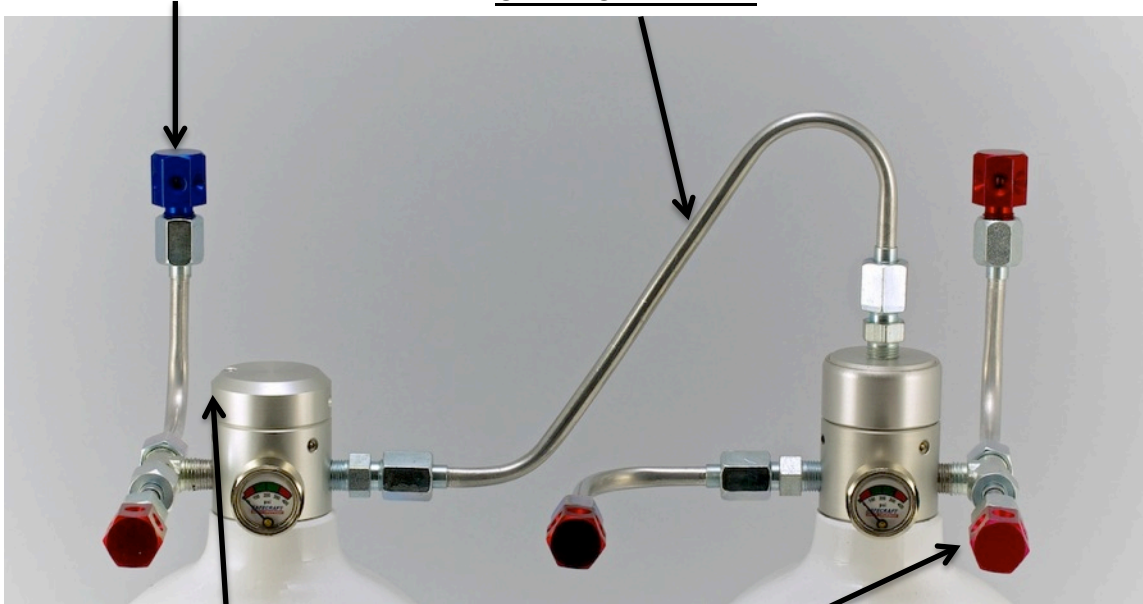

Pull cable receptacle.
See Model LT Install
instructions

Red Nozzles, run 4 to
engine compartment



Model LT10



Model LT Pneumatic Head



Model LT Family

SAFECRAFT
SAFETY EQUIPMENT