

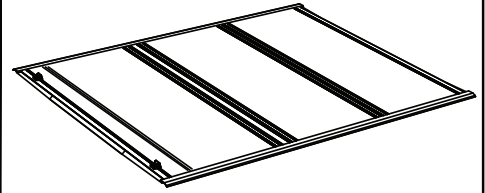

# Armis Folding Cover



Fits: 13550.24- ARMIS Hard Trifold With LINE-X Bed Cover, 2020- Current Jeep Gladiator JT



THE ARMIS TONNEAU COMES FULLY ASSEMBLED.



REMOVE CONTENTS FROM BOX. VERIFY ALL PARTS ARE PRESENT.



READ INSTRUCTIONS CAREFULLY BEFORE STARTING INSTALLATION.

# RR-G1

## PARTS LIST OF COMPONENTS

PN	Part Description / Qty	PN	Part Description / Qty
1	Hard Folding Cover (1)		
2	Left Mounting Rail (1)		
3	Right Mounting Rail (1)		
4	Mounting Bolts- ( 2- M8 & 4- M6 Flange Head Bolts )		
5	Bulkhead Seal (1)		
6	Pre-Staked Cover Retainer Assemblies (2)		
7	Drain Tubes (2)		

## Components

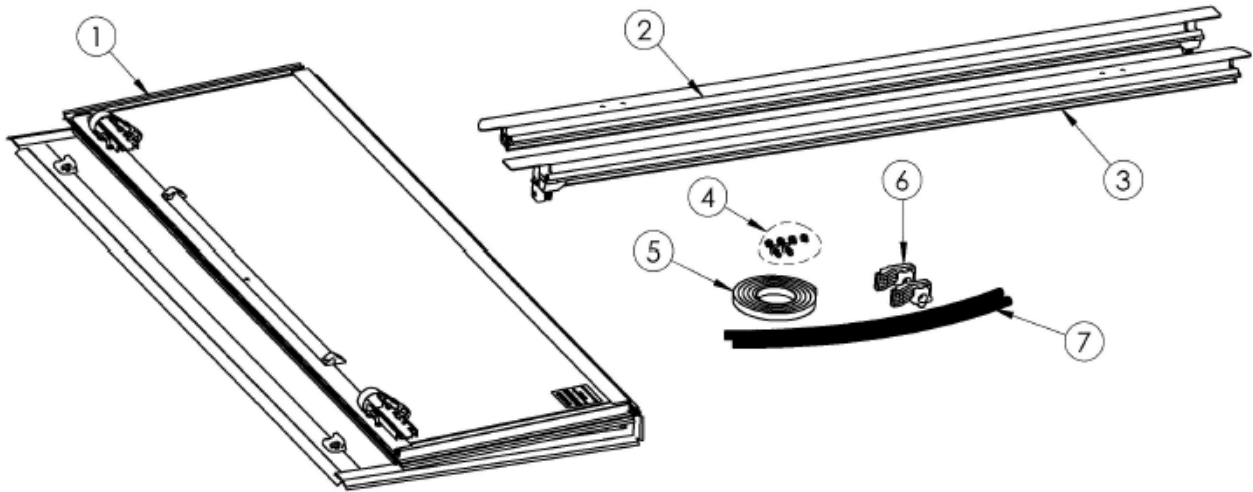

## Tools Required

Ratchet & 1/2" or 13MM Socket & 10MM Wrench

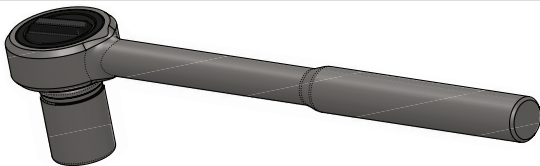

INSTALLATION PROCEDURE

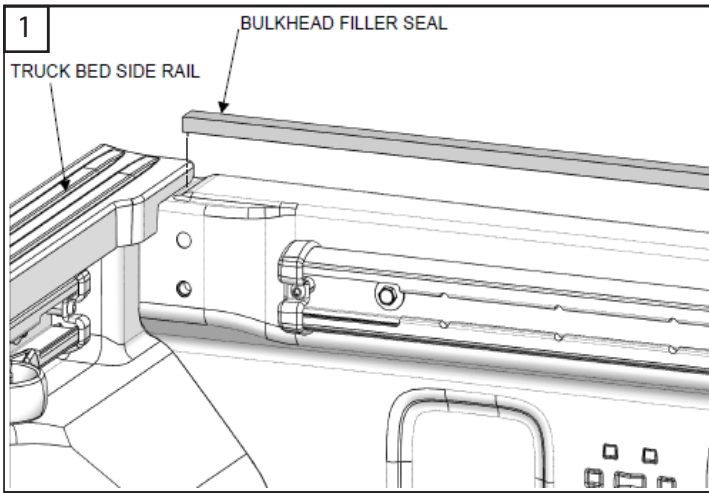

1. Install the bulkhead seal on top of the front bulkhead of the bed, centering the bulkhead seal front to back. Make sure to place the bulkhead seal, so that both ends set flush against the inside edge of the plastic bed rail caps, ( driver to passenger side ). Trim to fit.

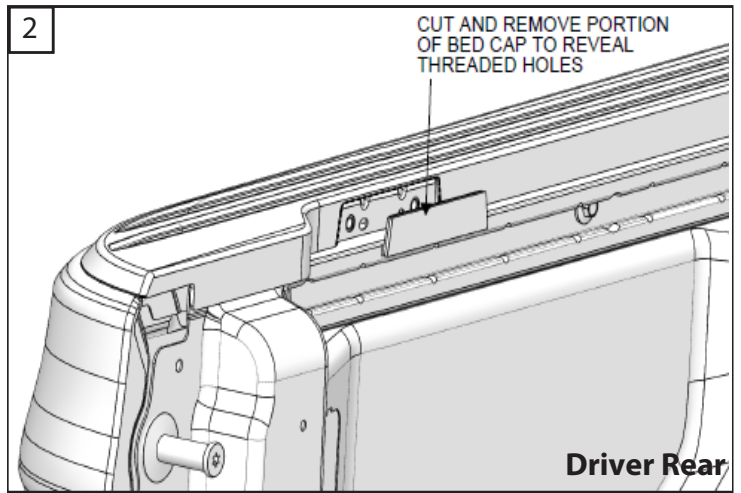

2. Locate the outlined section on the inside of the bed cap towards the tail light well at the rear of the bed. Cut and remove the outlined section of bed cap to reveal threaded holes. Repeat process for both Driver and Passenger side.

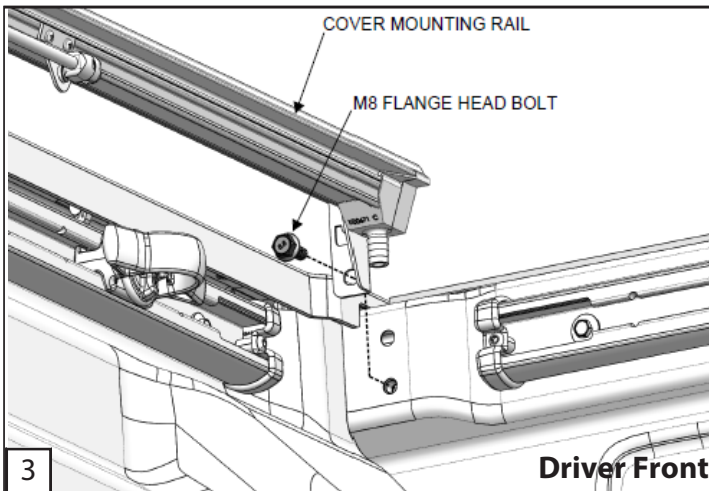

3. Using one of the M8 Flange head bolts, install the driver side mounting rail to the front bulkhead with using the lower hole in the flange on the front of the mounting rail and lower threaded hole on the bulkhead. Leave loose until rear mounting bolts are installed. Repeat process for passenger side.

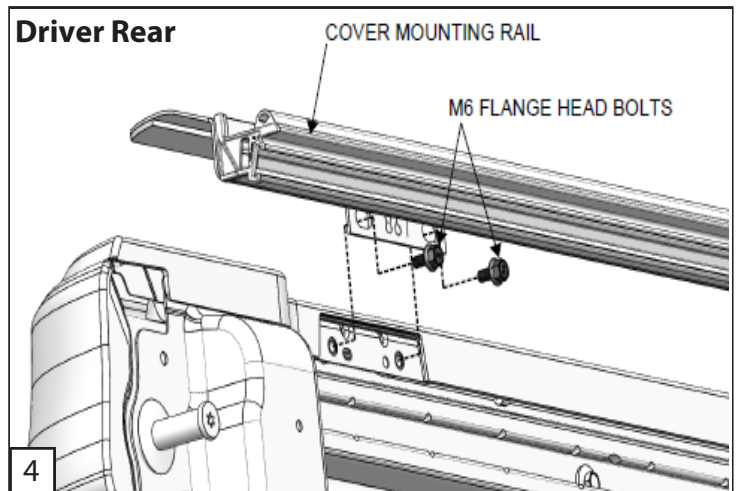

4. Install the rear portion of each mounting rail, using the M6 Flange head bolts and thread them into the pre- threaded holes located previously from the removed portion of the bed cap. Repeat process for opposite side. Leave bolts loose and proceed to step 5.

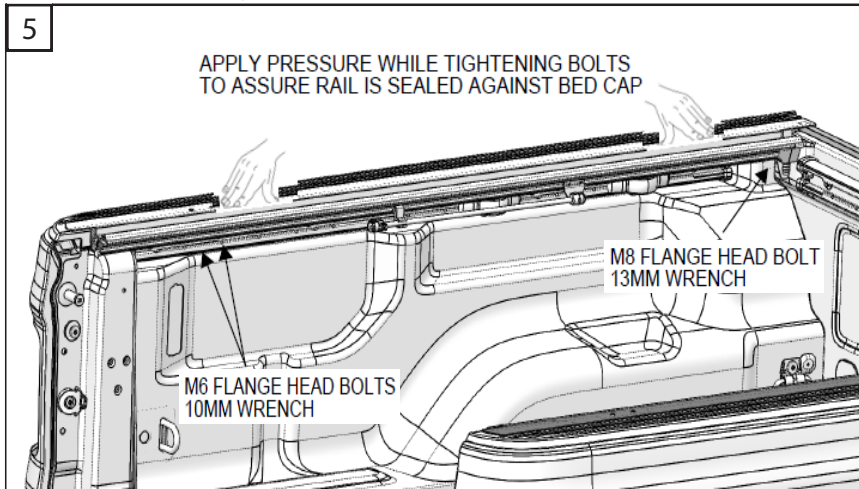

5. Once the mounting rails are in place, apply pressure while tightening the bolts to assure rails are sealed against the bed cap. ( The use of a ratchet, 1/2" or 13MM socket or wrench for the front bolts and 10MM wrench for the rear bolts is recommended ). The assistance of another person may be needed for this step to get the proper seal.

6 & 7

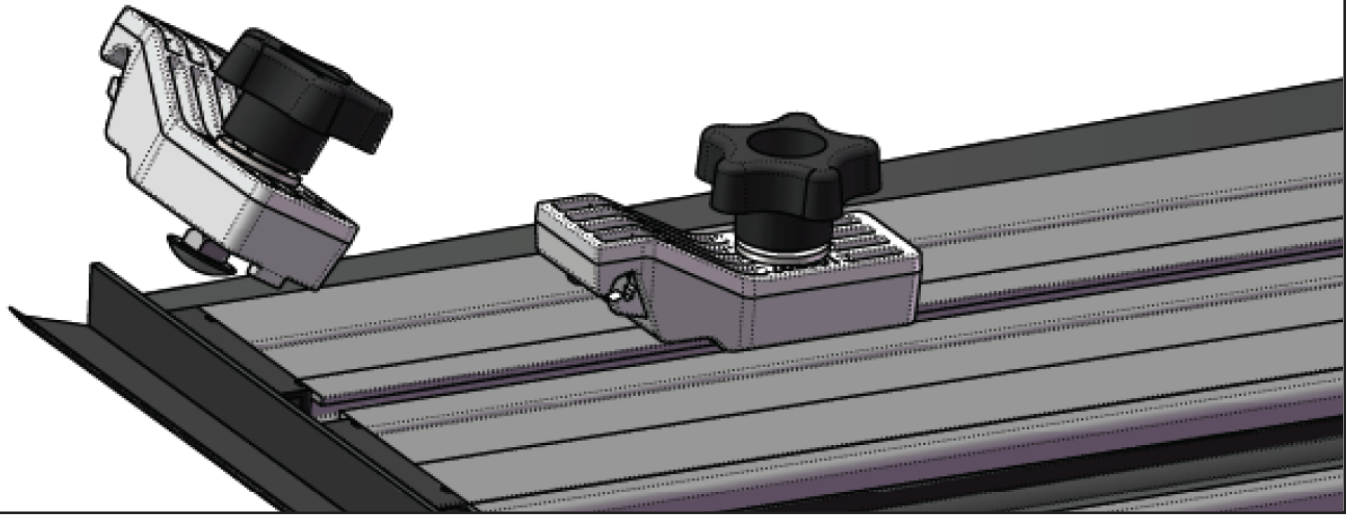

6 & 7. Slide the two front pre-staked cover retainer assemblies into the track on the underside of the tonneau cover, do not remove bolt from assembly.

8



8. Place the tonneau onto the mounting rails with the smallest panel towards the cab of the truck and with the front flap covering the bulkhead.

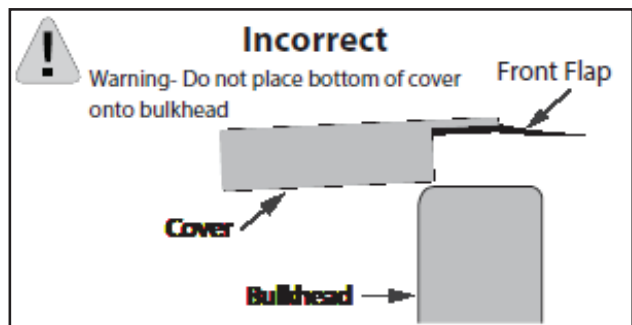
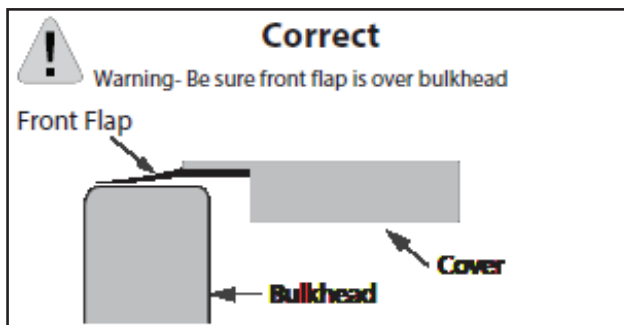



9. Carefully unfold the cover. Position the cover so it is centered side to side and front to back on the truck bed.

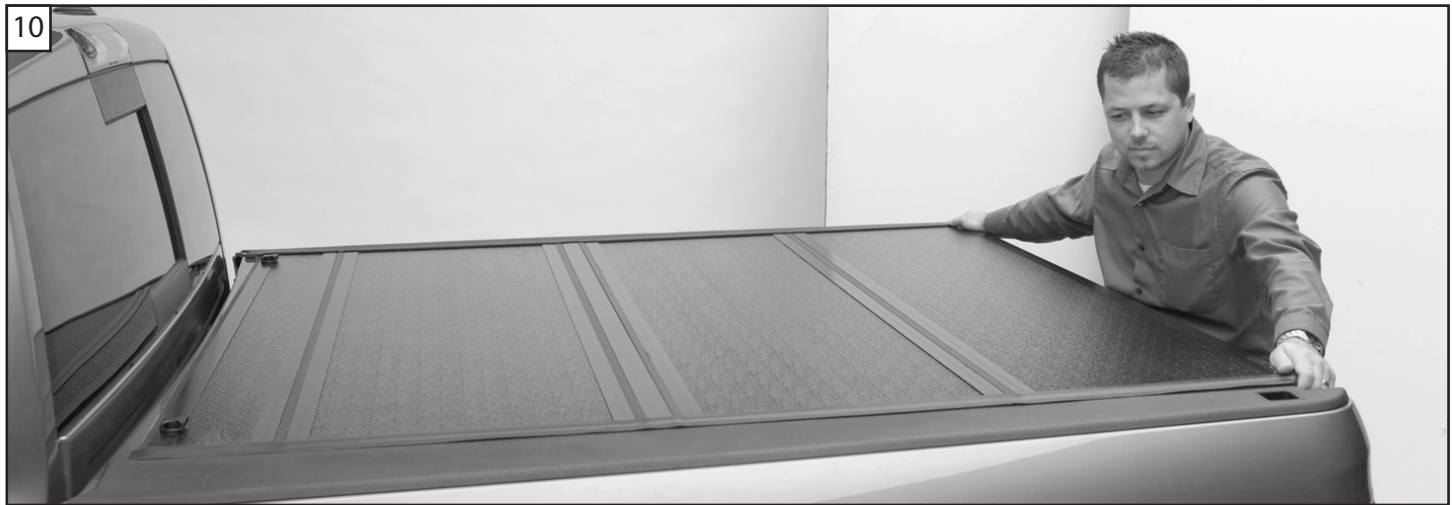

10. Test the rear latching assembly for smooth operation as this is the best indicator of the cover being positioned correctly. Be sure the latches on both sides are engaging with the cover mounting rail.



11 & 12. Once the cover is located correctly, fold the cover to the open position. Pull the release cables on the rear panel to release it from the side rail. Take care to fold it gently so the position of the cover is not disturbed.

**WARNING: DO NOT TRY TO SECURE THE COVER WITH THE RETAINER CLAMPS ONTO THE FRONT CARGO RAIL. (IMAGE A)**



**INCORRECT**

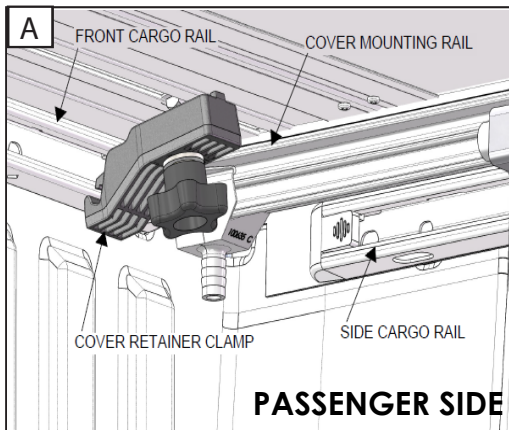

**CORRECT**

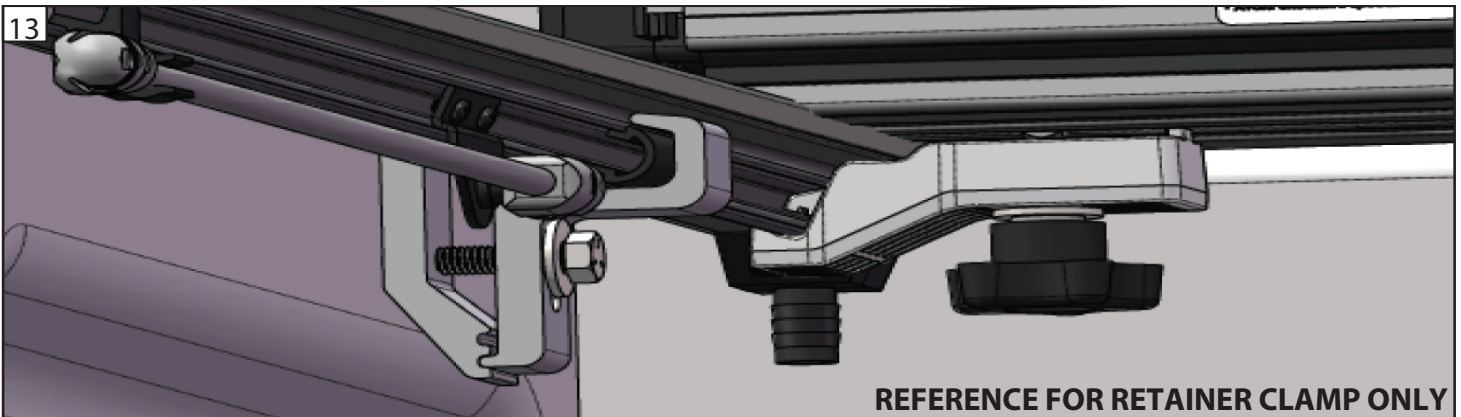
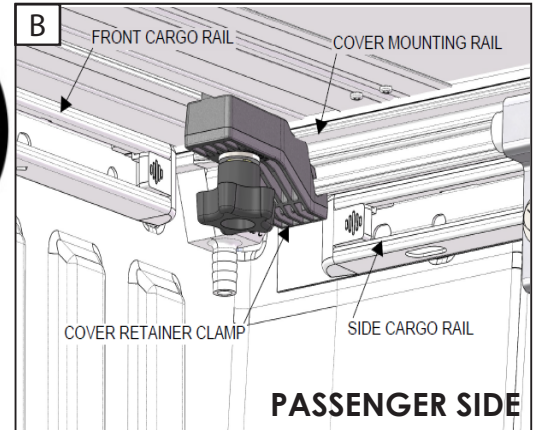

13. Once in the open position place the front pre-staked cover retainer assemblies, ( retainer clamp, flat washer, lock washer, star knob and mounting bolt ), underneath the cover in the slotted groove so that the retainer clamp engages into the mounting rail and hand tighten. **Note: Engage the retainer clamps onto the cover mounting rail as shown ( IMAGE B & 13).** Be sure the front retainer clamp is clamping to the side rail correctly. Test the cover again for proper operation, adjust as needed, then tighten the star knobs.



14. Attach the prop rod to the side rail.

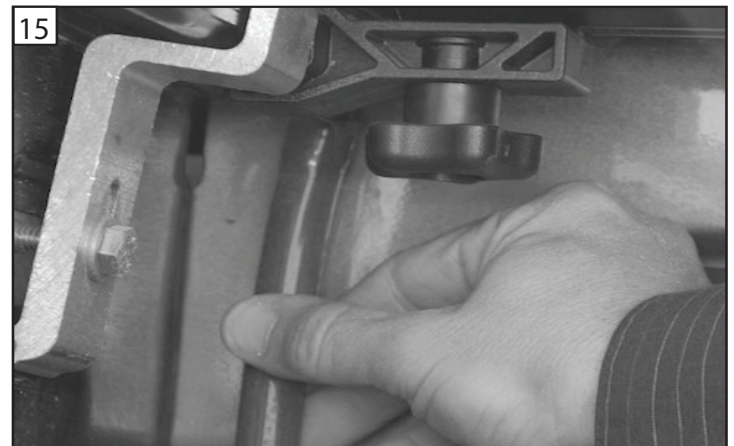

15. Attach the drain tubes to the fittings at the front of the bed rail and position the tubes to divert water out of the truck bed. This can be done by placing the tube behind a bed liner, through an existing hole in the bed, or by drilling a 5/8" hole in the bulkhead.

**Note:** If you choose to place the tube behind your bed liner, be sure your drain holes in the bed are not clogged.

**Note:** If you choose to drill holes, check to make sure the area is free and clear of any obstructions behind the bed. Be sure to clean up any shavings.

## OPERATION INSTRUCTIONS



1 & 2. To open the cover: Lower the tailgate and pull the cable. While pulling on the cable lift the panel up and towards the cab, repeat for the next panel.

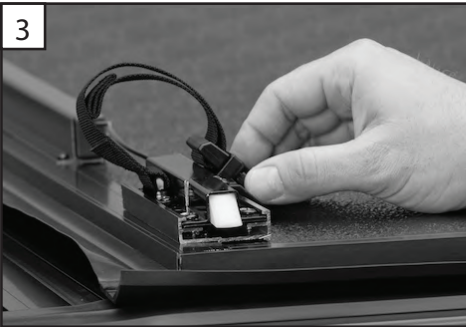

3, 4 & 5. If this is as far as you would like to open the cover, you can secure it in this position. Release the strap from the stowed position by squeezing the tabs. Attach the buckle at the bulkhead, pull the strap to take up the slack and secure the cover. Repeat this for the opposite side.



*Warning! Do not lean the cover against cab or damage to the truck and/or cover can occur.*

6 & 7. Pull the cable on the third panel and fold the cover up towards the cab.



8 & 9. Snap the prop to the mount on the cover, repeat for the other side. To close simply reverse this process.

1. How difficult is it to install the tonneau cover?

***Installing of tonneau cover is easy, please follow the steps in installation manual carefully.***

2. How do I clean my tonneau cover?

***Wash the tonneau same as your truck. We recommend using soap and water.***

3. Will the tonneau cover scratch my paint?

***No. Please follow the installation instruction manual carefully to avoid scratching paint.***

4. Will the tonneau cover obstruct the opening and closing of my tailgate?

***No. The cover is designed to allow you to open and close your tailgate freely with the cover in the closed position.***

5. Missing or Excess Hardware?

***Re-check hardware count as per the part list.***

6. Why is my tonneau cover not installing properly?

***Ensure year, make, model, cab length and bed size of your vehicle is listed in the application and installation steps are followed correctly.***