

Rugged Ridge OE Replacement Soft Top, TJ

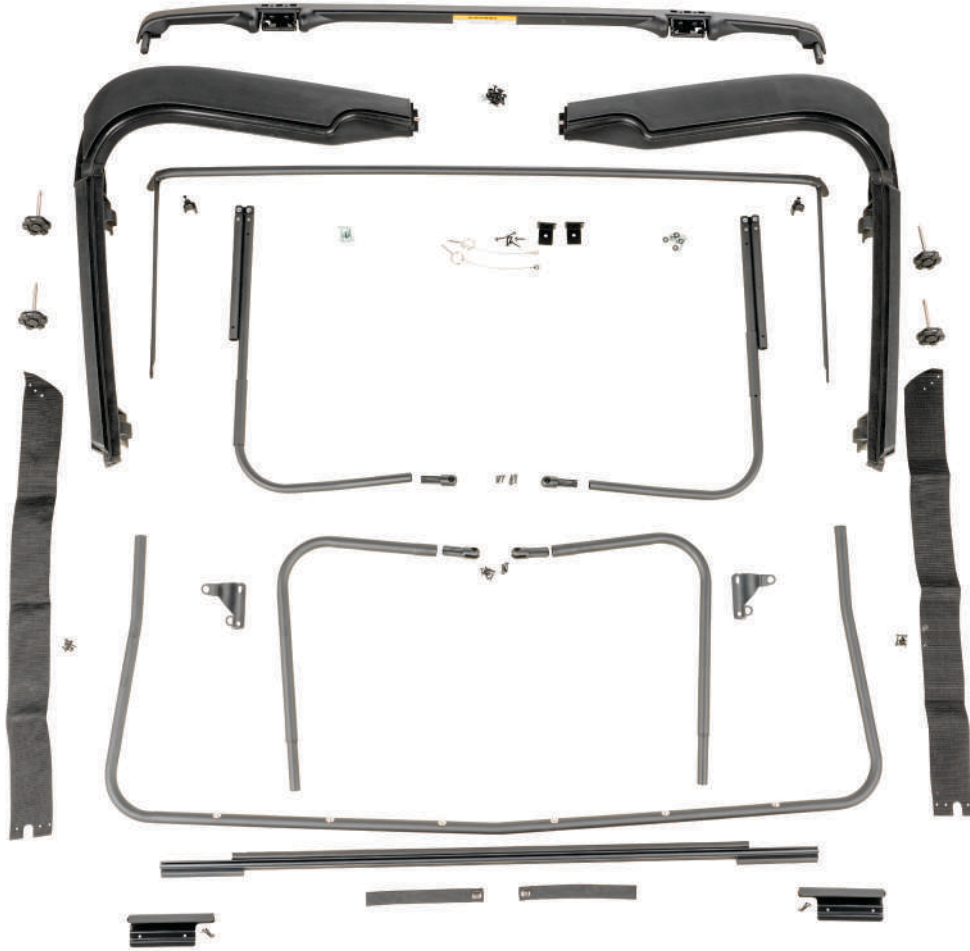

Components

13510.20	Door Surround, Right.....	1	13510.24W01	End Knuckles, Rear Bows.....	1
13510.21	Door Surround, Left	1	13510.24W02	Bow, Rear, Lower, Left or Right.....	2
13510.28	Knob, Door Surround	4	13510.29	Strap, Front Bow to Rear Bow, Pair.....	1
13510.22	Header With Latch.....	1	13510.30	Bracket, Tail Gate Bar, Right.....	1
13510.37	Hardware, Header.....	1	13510.31	Bracket, Tail Gate Bar, Left	1
13510.25	Bow, Front	1	13510.32	Tail Gate Bar	1
13510.25W01	Front Bow Support Landing Bumpers.....	1	13510.33	Strap, Rear Window, Pair.....	1
13510.25W02	Front Bow Hardware	1	13516.12	Cage Bracket, Soft Top Bow, Right	1
13510.26	Bow, Door, Right	1	13516.13	Cage Bracket, Soft Top Bow, Left	1
13510.27	Bow, Door, Left.....	1	11811.95	Tapping Screw M6-1.0x25mm.....	4
13510.26W01	End Knuckles, Front Door Bows.....	1	13510.36	Brackets with pin & screws, Door surround	1
13510.24	Bow, Rear	1			

Rugged Ridge OE Replacement Soft Top, TJ

1. Start with the soft top and attaching the header panel. Place the top out flat with the interior facing out. Now place the header panel into position. When installed correctly the attaching screws should not be visible. At this time take the attaching strip fold and place along the header just as it would hide the attaching screws.



2. Now with the material holding into place take the header and flip it holding the material to the header. With this method it assure the attaching strip is in the appropriate position.



3. Now starting from the center and working your way out screw the top to the header panel. Do not fully tighten until you have all the screws into the header. Pull and adjust as needed to assure the top is center to the header then fully tighten all the screws.



Rugged Ridge OE Replacement Soft Top, TJ

4. Now rotate the header back into position, tucking the header into the material. This now hides the screws you just installed and creates a stronger bind of the material to the header.



5. At the ends of the header there is a material flap that folds over and attaches to the header with two screws, one at each end.



6. Next assembly the inner frame. It's best to take all the components and lay them out as they go together. At this time you can determine if there were any items missing or damaged in shipping. It also helps to mentally see the orientation of all the components before attaching them.

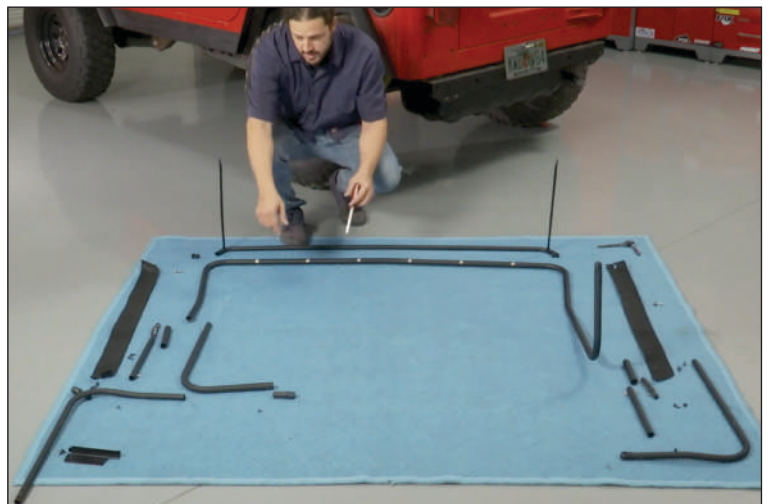

Rugged Ridge OE Replacement Soft Top, TJ

7. Find the pair of smaller "Dog Leg" bent frame tubing. These have a 90 degree bend without the additional bend towards the inside. Take the plastic knuckle and insert it at the one end with the drilled pilot hole. Rotate the knuckle so the pilot hole and predrilled hole of the knuckle align and fasten with screw.

Apply to both sides.



8. Insert the smaller "Dog Leg" Tube Frame piece into the main bow. Rotate to align the predrilled holes and fasten the two pieces with a screw.

Apply to both sides.



9. Now with the larger "Dog Leg" pieces, they also have plastic knuckles that attach in the same method as the smaller pieces. There is a left and a right side to these items. Notice in the photo how the second slight bend to the tube frame points the tube inwards. This how you determine left to right side. When installing the knuckle the brass insert will be towards the inside. Align the pilot and predrilled holes and attach knuckle with screw.

Apply to both sides.



Rugged Ridge OE Replacement Soft Top, TJ

10. Next we will assemble the hinge mechanism to the large "Dog Leg" pieces you just assembled. Notice the pieces picture here. There is a piece of straight tube with predrilled holes, another smaller tube with no holes and the hinge.



11. Now slide the smaller in length tube over the other predrilled tube. This tube "Locking Bar" is used to slide over the hinge when the top is fully covering the cab to lock out the hinge. To allow for the "Open Air" option of this top you'll slide this tube "Locking Bar" exposing the hinge allowing it to fold the top back.

Also note in the photo you can hand tighten the hardware that will attach the item to the header temporarily. With this hardware in place it will assist in keeping the "Locking Bar" from sliding off during assembly.

Apply to both sides.



12. Now insert the hinge into the tube and fasten items with a screw. Slide the other end of the hinge into the larger "Dog Leg" tube frame piece. Align the predrilled holes and fasten with screw.

Apply to both sides.



Rugged Ridge OE Replacement Soft Top, TJ

13. Now return to the soft top with the header attached. We are now going to attach the side bow assemblies with the folding hinge to the header. Note the "Dog Leg" piece of this assembly is pointing out. Slide the side bow assembly into the stems of the header panel.

If you loosely installed the hardware in step 11 to keep the "Locking Bar" from sliding off this is the time you'll need to remove to attach to the header.

Apply to both sides.



14. Align the predrilled holes and insert the bolt with washer. It's a tight fit and will need to be threaded in. Once bolt is threaded in now place another washer and nylock nut and tighten.

Apply to both sides.



15. Now attach the center support bow to the side bows. This attaches just behind the hinge of the side bow. It requires a bolt and plastic washers. The plastic washers are used because this area will hinge when folding the top back. So when you tighten the bolt do not completely tighten it all the way allow for some play for the item to hinge. Just snug and test if the item can freely move.

Apply to both sides.



Rugged Ridge OE Replacement Soft Top, TJ

16. Drop in plastic support piece into center bow as shown here. Have the shorter edge face the inside of the top.

Apply to both sides.



17. Attach the center bow strap to the center bow. The first screw will go through the strap into the center bow and into the plastic support piece. There are an additional two screws that go through the strap to the center bow.

Apply to both sides.



18. With both bows attached to the header and the center bow attached to the side bows, fold a portion of the touch fasteners and attach to the center bow. Do not attach the entire touch fasteners just a small portion in the middle to assist in installation. This will allow you the freedom to pull and adjust the top as needed. Once installed and adjusted you'll seal the entire touch fasteners strip.



Rugged Ridge OE Replacement Soft Top, TJ

19. Now attach to tailgate bar bracket to the tub of the Jeep. It attaches with two screws into the body of the Jeep.

Apply to both sides.



20. Now attach the roll bar bracket to the Jeep. You'll first need to unzip the roll bar pad to expose the attaching location. There are two threaded inserts on the roll bar.

Apply to both sides.



21. Each bracket should be stamped L (drivers side) and R (passenger side). The shallow pivot point is towards the top and the larger pivot point towards the bottom. Attach to the threaded inserts of the roll bar with two T-30 torque screws.

Once tighten to the roll bar pull pad over and have the pivot points exit the slits in the pad. Zip pad up.

Apply to both sides.



Rugged Ridge OE Replacement Soft Top, TJ

22. Place the rear bow on the top of the Jeep. This is not its final location. It's only placed here to support the piece as you attach it.



23. Attach the rear bow to the lower pivot point on the roll bar. Attach with shoulder bolt.

Apply to both sides.



24. Now rotate the rear bow to the back of the Jeep tub for now.



Rugged Ridge OE Replacement Soft Top, TJ

25. Now position the soft top into the Jeep. Each of the side rails should be on the outside of the roll bar.



26. Attach the side bow to the upper pivot point on the roll bar and attach with shoulder bolt.

Apply to both sides.



27. Grab the rear bow that sitting in the Jeep tub. Bring it up into position and then grab the center bow straps. This strap attaches to the rear bow with three screws through the strap into the rear bow tube.

Apply to both sides.



Rugged Ridge OE Replacement Soft Top, TJ

28. Pull the soft top back into position. In the soft top you'll see a wrap with snaps. This snaps into the rear bow.



29. At the door surrounds you need to add the lanyard L bracket. This bracket holds the side bows in place while you have the "Open Air" feature flipped back. So align this bracket with the hole in the side bow. Once aligned mark holes, drill and install bracket to door surround. Also install the lanyard with cable.

Apply to both sides.

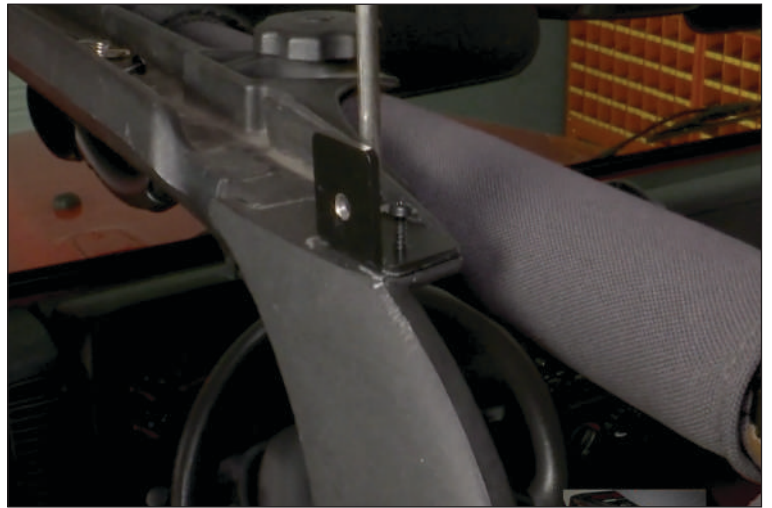

30. Bring the top forward and install the lanyard into the side bow to secure. Make sure lanyard is pushed all the through to avoid it rubbing with the top material.

Apply to both sides.



Rugged Ridge OE Replacement Soft Top, TJ

31. Enter the cab and attach the entire length of the touch fasteners to the center bow.



32. Now clamp your header panel to the windshield frame.

Apply to both sides.



33. Move to the back of the Jeep and pull the sail panels down and flip the plastic guides into the body of the Jeep.

Apply to both sides.



Rugged Ridge OE Replacement Soft Top, TJ

34. Zip in the rear side windows. Be sure not to pull just on the zipper but to assist it by stretching the material towards the zipper to relieve some tension.

Apply to both sides.



35. Insert front plastic guide into the door surround.

Apply to both sides.



36. Insert lower plastic guide into the Jeep tub rail. Then meet touch fasteners surface of the window to the top.

Apply to both sides.



Rugged Ridge OE Replacement Soft Top, TJ

37. Insert plastic guides into door surrounds.

Apply to both sides.



38. Slide rear window into rear tailgate bar. You'll notice a roll that slides into the channel of the tailgate bar.



39. Give the sail panels a final tug towards the rear window area. Next zipper rear window into the soft top. Make sure your not just pulling the zipper around but assisting it by pulling the surround material towards the zipper to relieve some tension.



Rugged Ridge OE Replacement Soft Top, TJ

40. Lastly install your door windows. The door windows require the OE wire frame. You will need to cut the wire frame out of the OE soft window. To install your new soft window is far easier, simply open the touch fasteners pockets and inset the OE wire frame. Install the side windows in the same manner you removed them.

Apply to both sides.

