

## Rugged Ridge Rear Steel Tube Fenders, JL

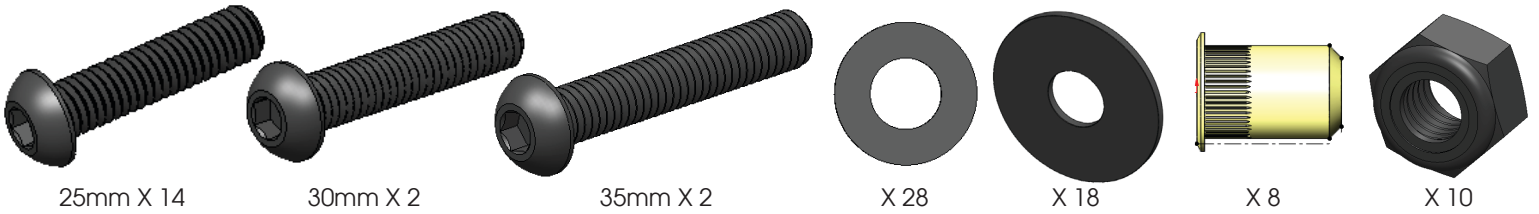
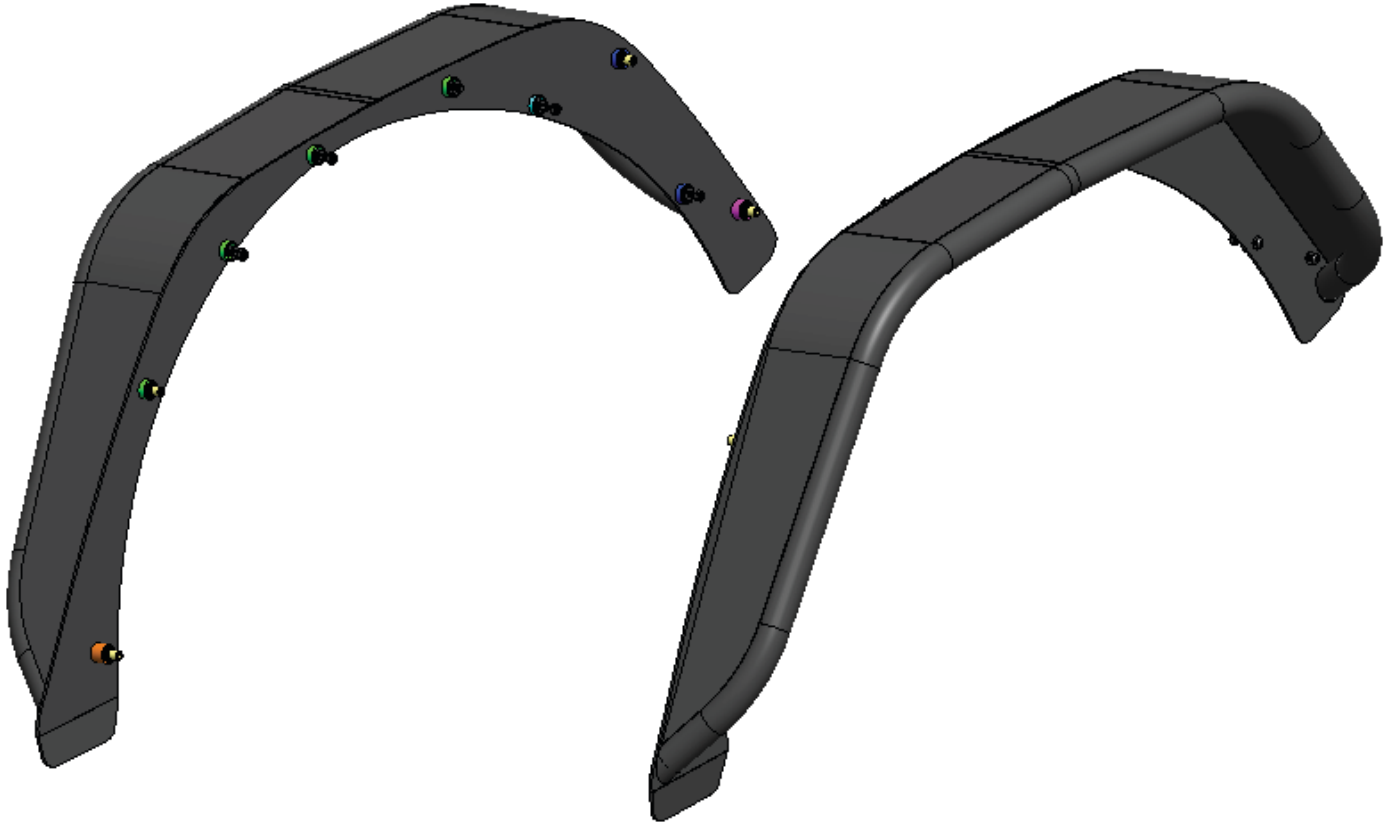

### Components

1.	Steel Tube Fender, Driver Side .....	1	6.	M6 Steel Washer .....	28
2.	Steel Tube Fender, Passenger Side .....	1	7.	M6 Plastic Washer.....	18
3.	M6 x 25mm Button Head Bolt .....	14	8.	M6 Nutsert .....	8
4.	M6 x 30mm Button Head Bolt .....	2	9.	M6 Ny-Lock Nut .....	10
5.	M6 x 35mm Button Head Bolt .....	2			

## Rugged Ridge Rear Steel Tube Fenders, JL

1. Start by releasing inner fender liner retainers. This will require prying all the plastic trees that join the liner to the Jeep body. Try to pry the trees out but in many cases it is easier to cut the head of the retainer off with snips.



2. With the inner liner loose now you can remove the entire fender. Grab the fender and pull the fender away from the body. It's attached with clips. When pulling it away the clips will probably break but its okay your not reusing them. Start pulling from one corner and work your way to the other side of the fender.



3. With the OE fender and liner removed clean the body of the Jeep in this area. This area retains mud and dust. If you see any scratches or paint is rubbed away, prep and paint areas to assist in rust prevention.





## Rugged Ridge Rear Steel Tube Fenders, JL

4. Remove the lower rear splash shield. It requires removing the three M8 bolts attaching it.



5. Remove the plastic shield from the bumper. It also has three M8 bolts attaching it.



6. Now remove the inner splash shield brace. There are two bolts at the bumper and two bolts at the frame to remove.





## Rugged Ridge Rear Steel Tube Fenders, JL

7. Place fender into position to see which holes you will be using in the body of the Jeep. In most cases the holes are accessible and will require a bolt washers and nut. There are four holes that require a nutsert, mark the holes that require the nutsert.



8. There is NO drilling necessary for this install. The nutserts will fit into the factory holes you marked in the previous step. To properly install we highly recommend using a nutsert tool. Insert nutserts into the Jeep body using the tool to crush the nutsert to the body. Take your time and assure each nutsert is crimped fully to avoid it from spinning or from being crooked.



9. Before installing the fender pre install the plastic washers to the fender. The plastic washers are used to protect the paint and body of the Jeep. To hold the washers in place we used small pieces of electrical tape.



## Rugged Ridge Rear Steel Tube Fenders, JL

10. Place fender into position. It is best to have a assistant to lift and hold the fender in place as you install the hardware. Start with the top two button head bolts with washers and Ny-Lock nuts. There are three lengths of button head bolts used. Follow diagram here for correct bolt placement.

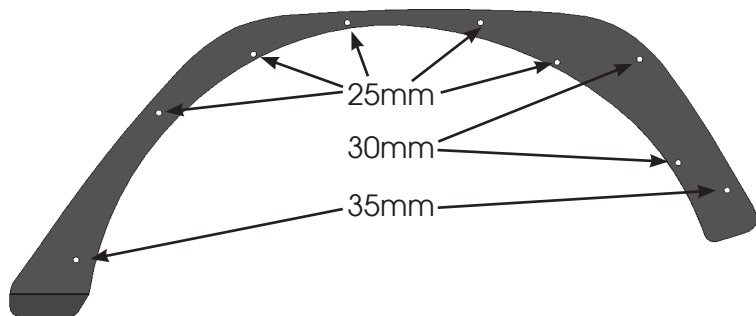

11. Now fully tighten hardware in a alternating pattern. Avoid using power or air tools. The last button head towards the rear of the fender is tight to the tube, it requires a short Allen head key to hold and tighten. This completes the install.

