

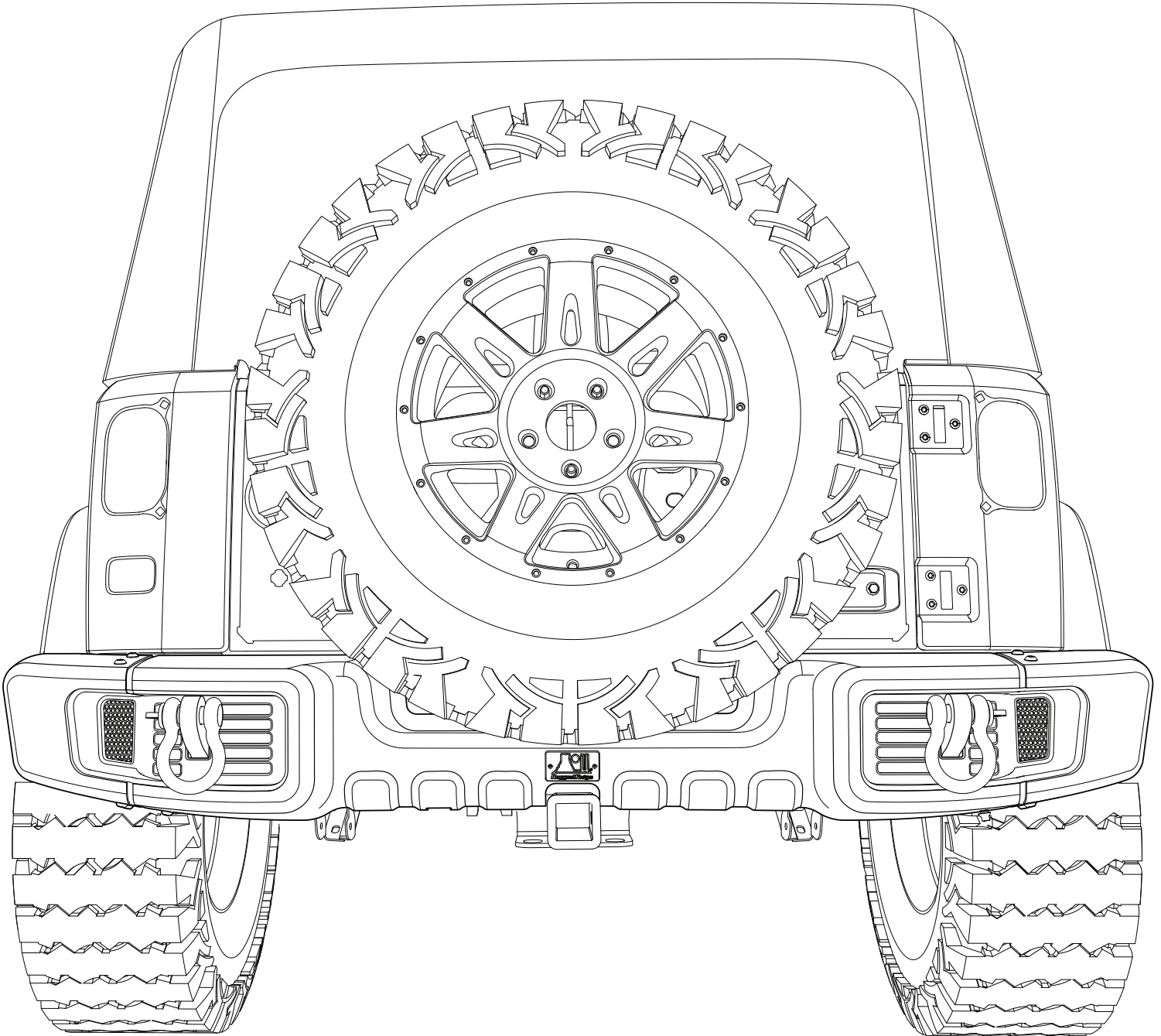

OMIX-ADA, Inc.

Part 11544.51

JK Spartacus Stamped Rear Bumper



WARNING

To avoid serious injury: Never exceed 6.5 ton work load straight line pull on D-Rings. Use only to assist in vehicle self-recovery; never use D-Rings as towing point. Inspect before use. Replace if damaged or distorted.

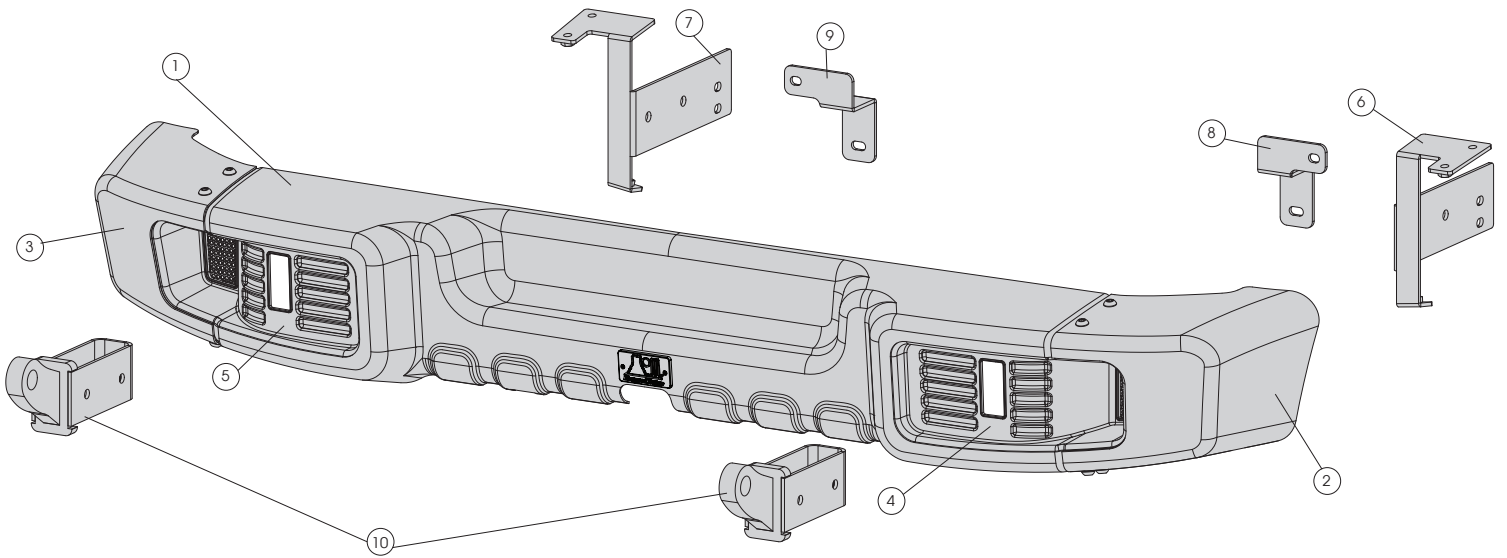

Components

- | | |
|-----------------------|-----|
| 1. Bumper Shell | (1) |
| 2. Bumper End, RH | (1) |
| 3. Bumper End, LH | (1) |
| 4. Plastic Cover, RH | (1) |
| 5. Plastic Cover, LH | (1) |
| 6. Side Bracket, RH | (1) |
| 7. Side Bracket, LH | (1) |
| 8. Center Bracket, RH | (1) |
| 9. Center Bracket, LH | (1) |
| 10. D-ring Bracket | (2) |



M12 Long
Hex Bolt (2)

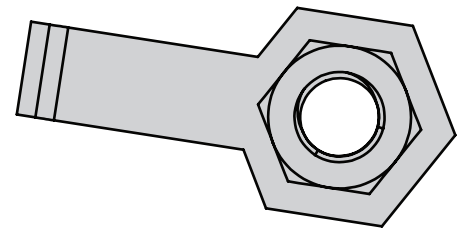

M12 Nutplate (2)

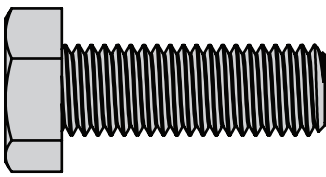

M12 Short
Hex Bolt (4)

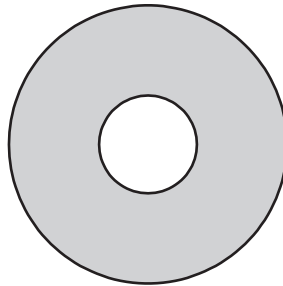

M12 Large
Washer (2)

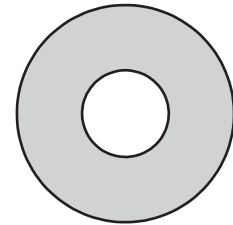

M10 Plastic Flat
Washer (10)

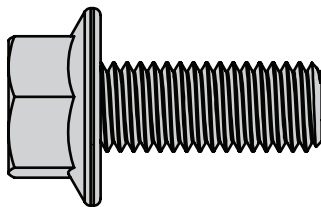

M12 Flange
Bolt (2)

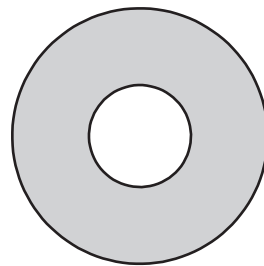

M12 Flat
Washer (4)

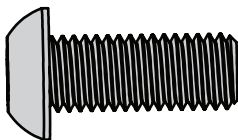

M10 Button
Head Bolt (10)



M4 Flat
Washer (8)



M4 Lock
Nut (8)



JK Spartacus Stamped Rear Bumper

1. Remove spare tire and Factory bumper from frame. Retain bumper hardware for later use.
2. If using hitch, remove hitch wire plug.
3. Insert D-ring Brackets into frame horns.

NOTICE Interior of frame horns may need extra clearancing on some vehicles for D-ring brackets to be inserted.

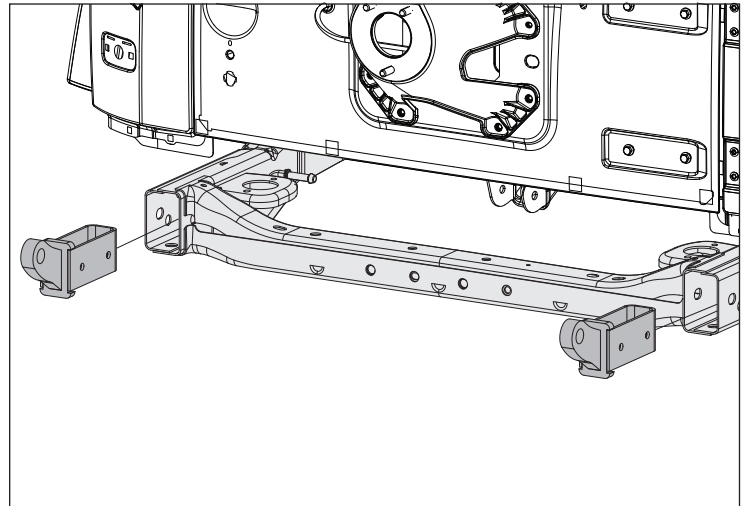

4. Install Side Brackets using Factory M10 bolts in 2 slotted hole locations. Do not fully tighten bolts. Repeat for both sides.

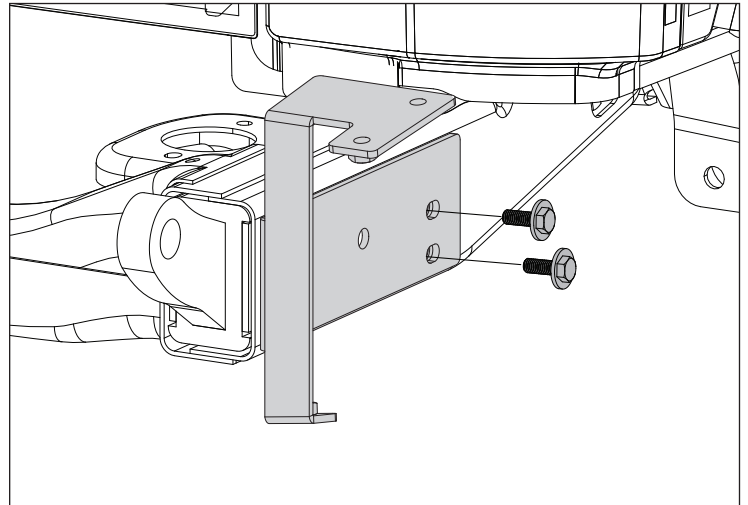

5. Insert M12 Short Hex Bolt and M12 Small Washer to center hole of Side Bracket. Do not fully tighten bolts. Repeat for both sides.

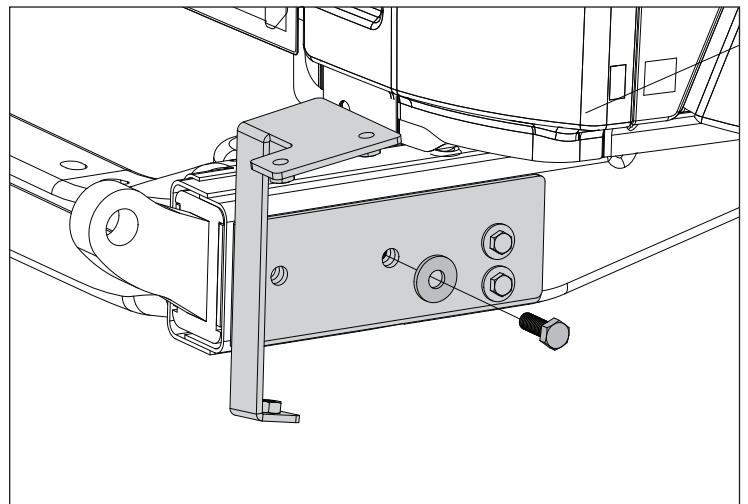



6. Insert M12 Hex Bolt and M12 Large Washer to rear inside hole of D-ring Bracket. Do not fully tighten bolt. Repeat for both sides.

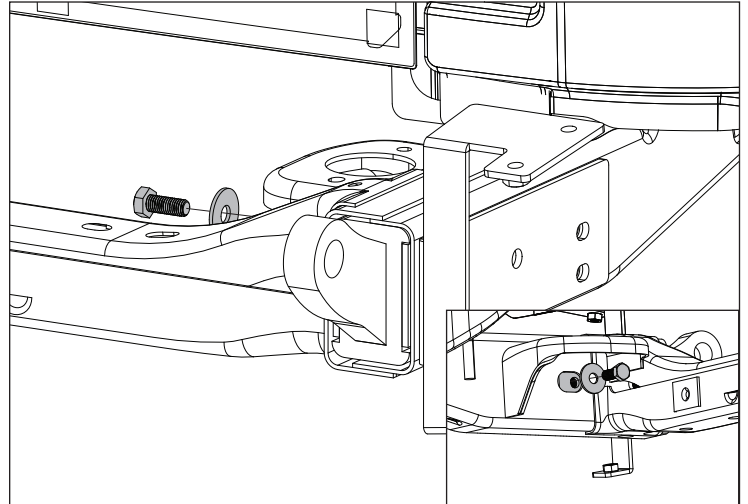

7. Secure M12 Long Hex Bolt in remaining holes of Side Bracket with M12 Nutplate and M12 Small Washer. Repeat for both sides.

NOTICE Opening in crossmember may need clearancing/enlarging on some vehicles

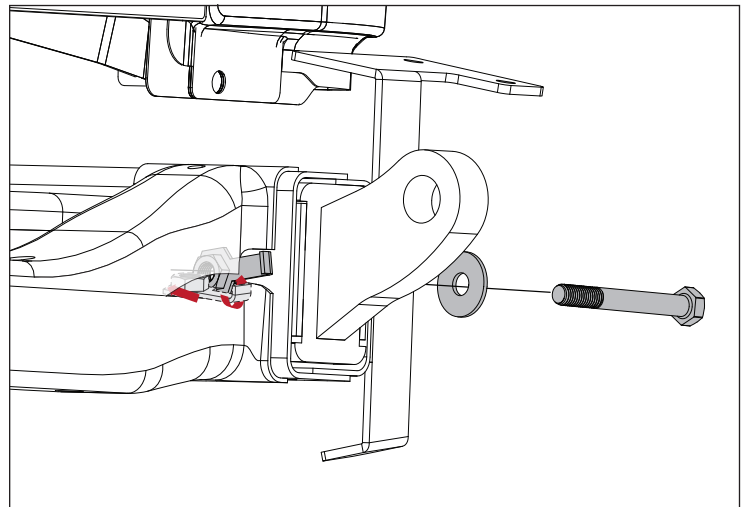

8. Install Plastic Covers using M4 Locknuts and Washers. Repeat for both sides.

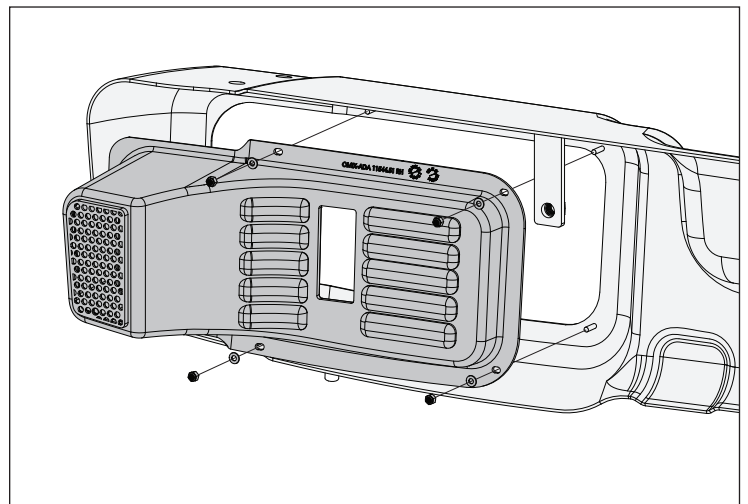



9. If using Bumper Ends, attach using lower M10 Button Head Bolts and M10 Plastic Flat Washer.

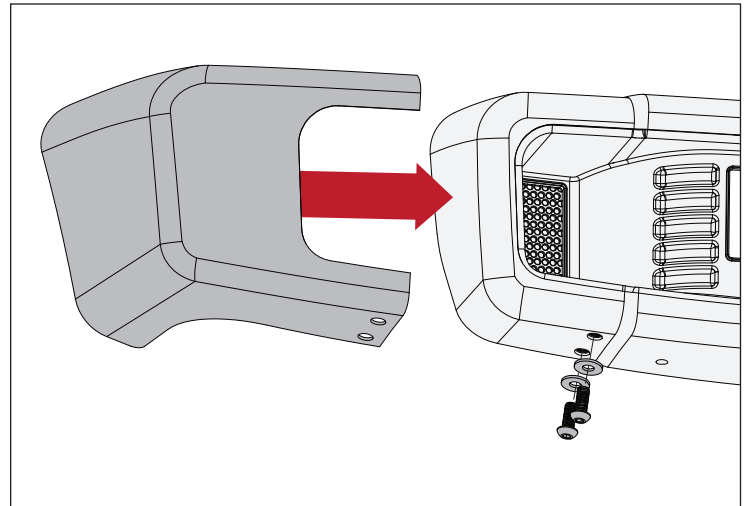

10. Place Spartacus Bumper Shell on rear frame of vehicle, aligning holes of Side Brackets with top Bumper End mounting points.

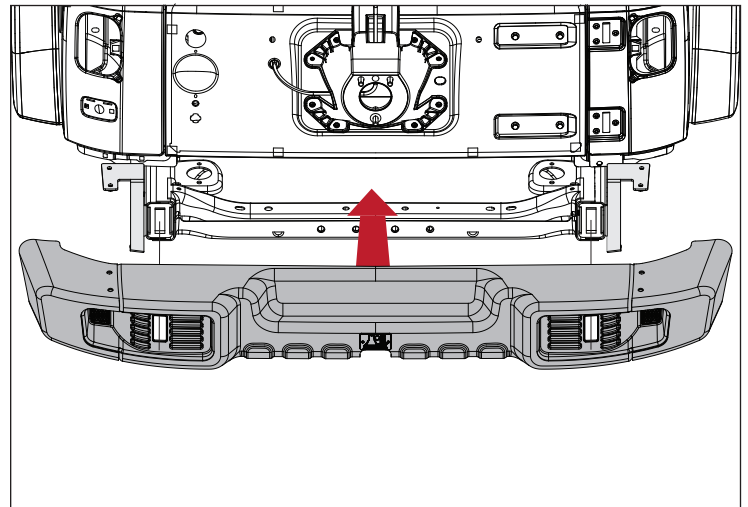

11. Secure top two mounting points on top of bumper/ends and lower hole in bumper to Side Brackets with remaining M10 Button Head Bolts and M10 Plastic Flat Washers. Do not fully tighten.

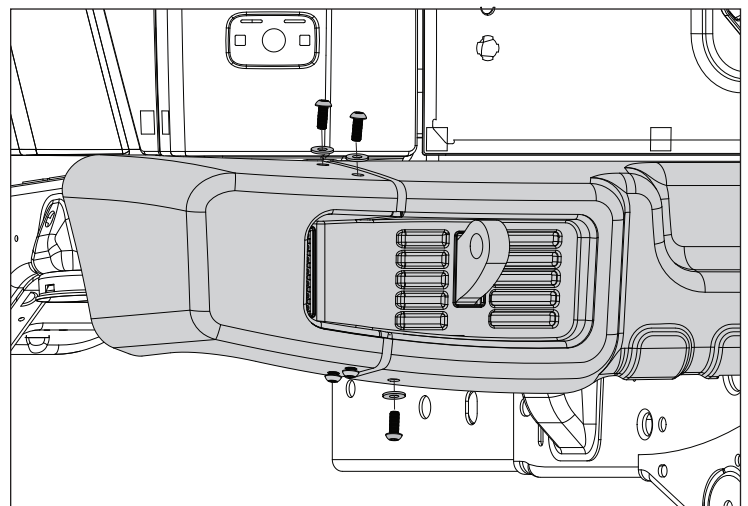



12. Install Center Bracket to flange inside of bumper shell with provided M12 Flange Bolts in top hole and Factory M10 bolts in bottom.

NOTICE For easier install, loosely thread top bolt first

13. Adjust and tighten all bolts.

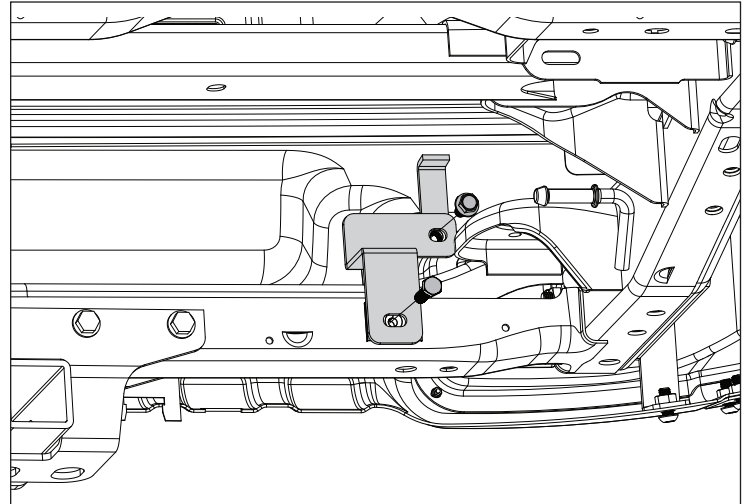

14. Install shackles (not included) and spare tire.

15. If using hitch, reinstall hitch wire plug. Smaller groove in plug will connect to open space in bumper.

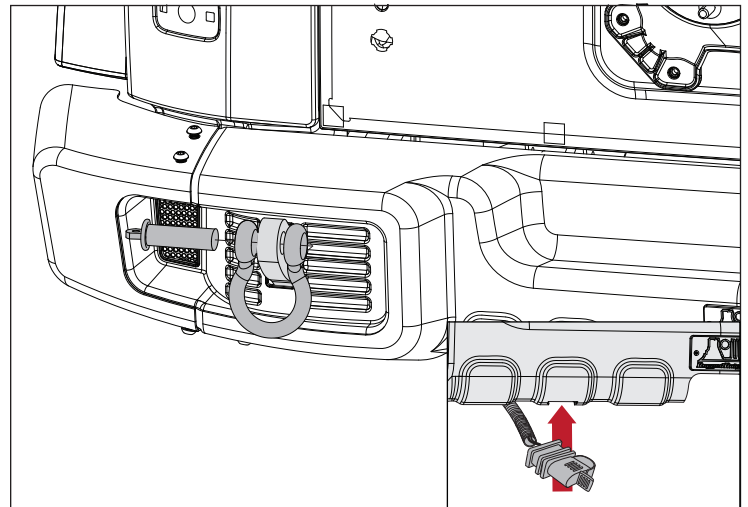

16. If desired, ends may be removed from bumper by removing M10 Button Head Bolts, removing ends, and reinstalling M10 Button Head Bolts.

