

# ROUGH COUNTRY

## SUSPENSION SYSTEMS®

### JEEP 2018 JLU 4-Door Step

#### Thank you for choosing Rough Country

Please read instructions before beginning installation. Check the kit hardware against the parts list and product layout. Be sure you have all needed parts and know where they go. Also please review tools needed list and make sure you have needed tools. If question exist we will be happy to answer any questions concerning the design, function, and correct use of this product.

#### Kit Contents:

- 1- Dr Main Step Rail
- 1- Pass Main Step Rail
- 2- Front Step Mounting Brackets
- 2- Center Step Mounting Brackets
- 2- Rear Step Mounting Brackets
- 6 - Steps Shims
- 1- 90768Bag including:
  - 6- 8mm x 35mm Bolts
  - 42- 8mm Flat Washers
  - 12- 8mm x 20mm Bolts
  - 18- 8mm Lock Washers
  - 12- 8mm 25mm Bolts
  - 12- 8mm Flange Lock nuts

#### Tools Needed:

- 13mm Socket/Wrench
- Ratchet
- Torque Wrench



#### INSTALLATION INSTRUCTIONS

1. Place vehicle on a flat surface and set emergency brake.
2. The center and rear brackets are notched, the number of notches on the bracket determines the position in which it should be mounted. One notch is the front, two notches is the center and three notches is the rear bracket. **See Photo 1.**
3. On a flat surface, attach the mounting brackets to the main rail using the supplied 8mm x 20mm bolts, flat washers and lock washers. **See Photo 2.** Tighten using a 13mm wrench. Torque to 18 ft-lbs.

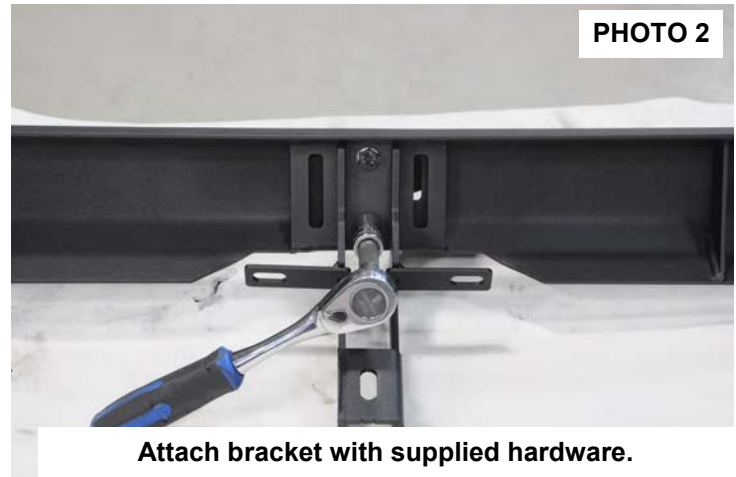
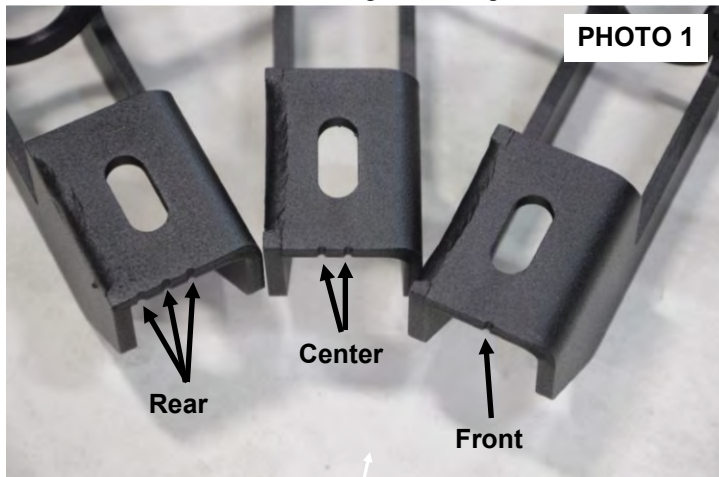

4. If the vehicle is equipped with factory steps, they will have to be removed. Retain the stock hardware for reuse.
5. Position the steps with mounting brackets on the Jeep. Line up the factory holes in the body and install the supplied qty 3 - 8mm x 35mm bolts, lock washer and flat washer or factory hardware to attach. **See Photo 3.** Do not tighten at this time.
6. Install the supplied 8mm x 25mm bolts in each bracket using factory holes in the body seam as shown with the supplied lock washers, flat washers and locking nut. **See Photo 4.** Do not tighten at this time.



7. Tighten the 8MM x 35mm bolts and then tighten the 8mm x 25mm bolts using a 13mm wrench.
8. Inspect the steps and using the shims provided, shim the steps to even the gap to body area. Loosen mount to be shimmed and insert shim between the mount the body lip. **See Photo 5.**
9. After shims are installed. Retighten mounting brackets.



**Torque Specs:**

Size	Grade 5	Grade 8	Class 8.8	Class 10.9
5/16"	15 ft/lbs	20 ft/lbs	6MM 5 ft/lbs	9 ft/lbs
3/8"	30 ft/lbs	35 ft/lbs	8MM 18ft/lbs	23 ft/lbs
7/16"	45 ft/lbs	60 ft/lbs	10MM 32ft/lbs	45ft/lbs
1/2"	65 ft/lbs	90 ft/lbs	12MM 55ft/lbs	75ft/lbs
9/16"	95 ft/lbs	130 ft/lbs	14MM 85ft/lbs	120ft/lbs
5/8"	135 ft/lbs	175 ft/lbs	16MM 130ft/lbs	165ft/lbs
3/4"	185 ft/lbs	280 ft/lbs	18MM 170ft/lbs	240ft/lbs

**THANK YOU FOR CHOOSING ROUGH COUNTRY FOR YOUR OFF ROAD NEEDS.**

By purchasing any item sold by Rough Country, LLC, the buyer expressly warrants that he/she is in compliance with all applicable, State, and Local laws and regulations regarding the purchase, ownership, and use of the item. It shall be the buyers responsibility to comply with all Federal, State and Local laws governing the sales of any items listed, illustrated or sold. The buyer expressly agrees to indemnify and hold harmless Rough Country, LLC for all claims resulting directly or indirectly from the purchase, ownership, or use of the items.



Learn more about running boards and step bars we have.