



2149 Ford F-150 2015 - Present

2149 Ford Super Duty 2017-Present

**Installation Instructions**



**50 Min.**

**FRONT** ←

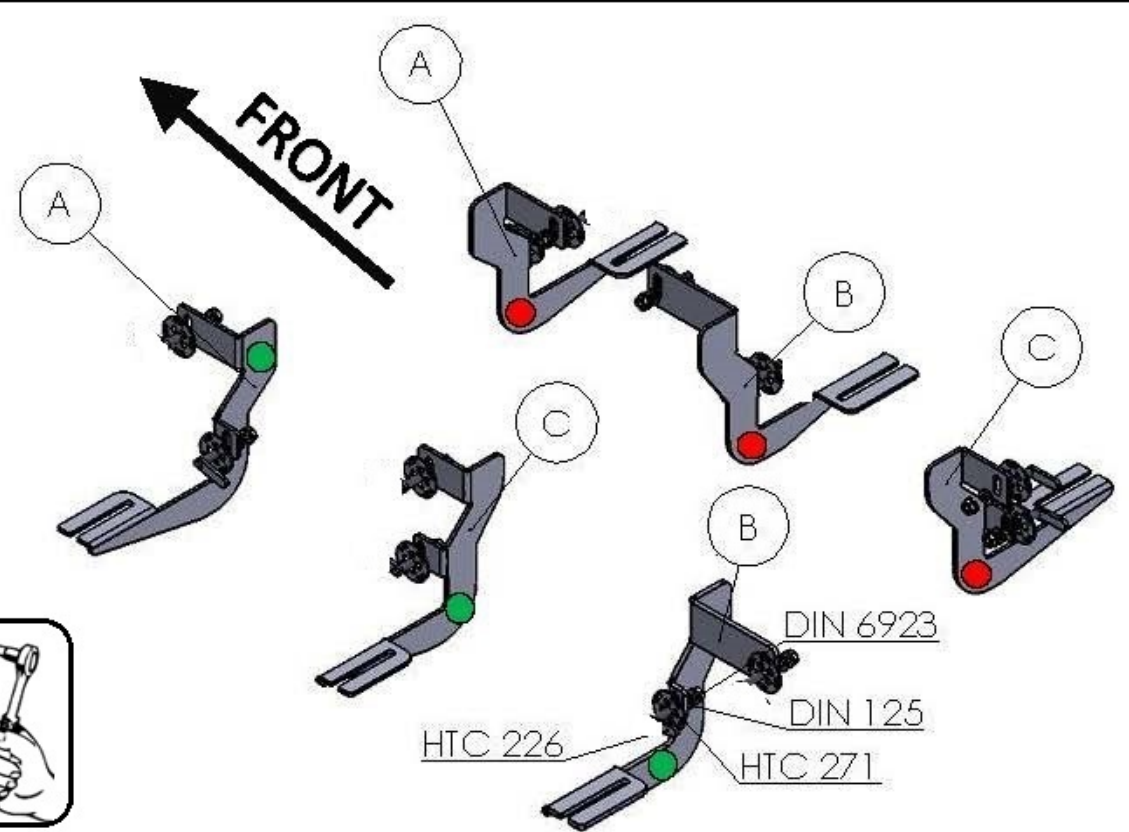

M6 = 8 Ft.Lb  
 M8 = 18 Ft.Lb  
 M10 = 35 Ft.Lb

**SUPER CREW BRACKET DIRECTION**

**HARDWARE**

12		M8 DIN 6923	12		HTC 271 K_LIPS (M8)	12		M8 WASHER DIN 125
----	--	-------------	----	--	---------------------	----	--	-------------------

**WARNING: Use of powertools will void warranty**

**BRACKETS**

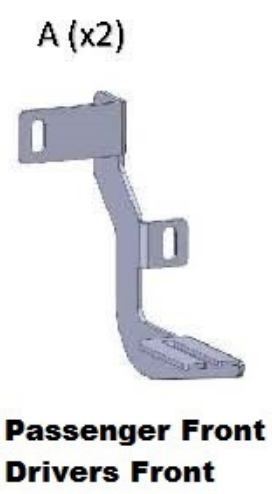

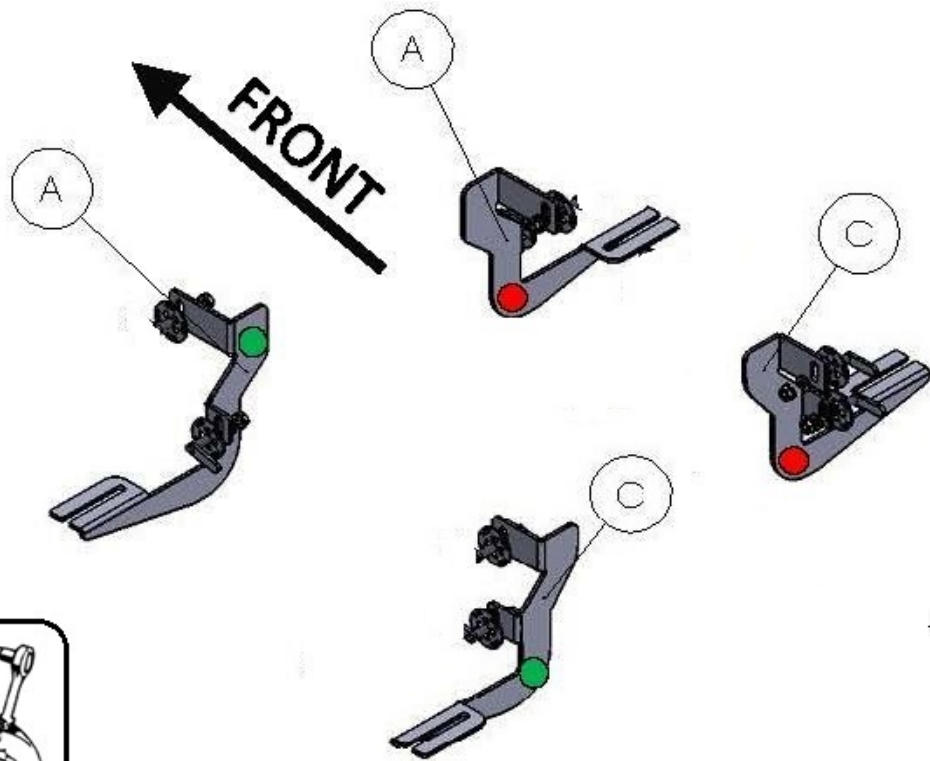

M6 = 8 Ft.Lb  
 M8 = 18 Ft.Lb  
 M10 = 35 ft.Lb

**SUPER CAB BRACKET DIRECTION**

**HARDWARE**

12		M8 DIN 6923	12		HTC 271 K_LIPS (M8)	12		M8 WASHER DIN 125
----	--	-------------	----	--	---------------------	----	--	-------------------

**WARNING: Use of powertools will void warranty**

**BRACKETS**

A (x2)

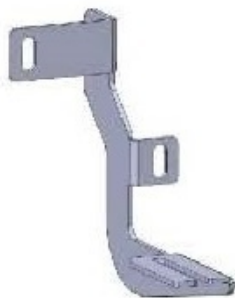

**Passenger Front  
Drivers Front**

C (x2)

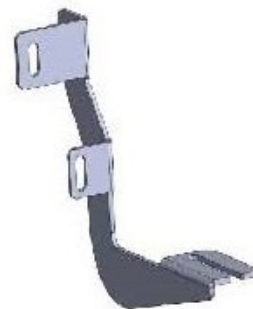

**Passenger Rear  
Drivers Rear**

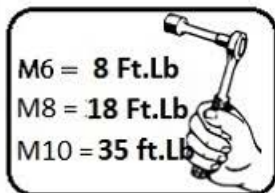

## 2149 Ford F-150 2015+ 2149 Ford Super Duty 2017+

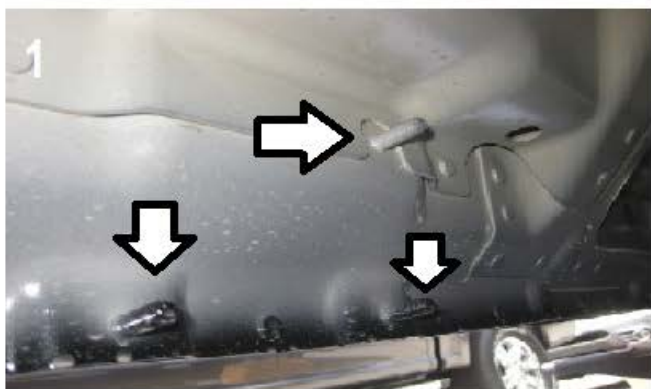

- 1) Locate mounting points for your particular vehicle. If necessary clean threads on factory studs.
- 2) Install HTC 271 plastic round washers on factory studs. Please use the bracket direction guide to determine wich combination you need to perform Image #2 and Image #3
- 3) Install mounting brackets with supplied M8 hardware do not tighten
- 4) Perform this procedure six (6) times in total making sure to follow the bracket directions listed on page #2 or page #3
- 5) Loosen M8 hardware on back of steps
- 6) Install steps on brackets hand tight only
- 7) Proceed to tighten bracket hardware M8 to 18 ft lbs
- 8) Proceed to tighten step hardware M8 to 18 ft lbs

On our website you'll find a wide variety of high-quality [Running Boards & Step Bars](#) from [Romik](#).

**WARNING: Use of powertools will void warranty**