



Installation Instructions

Part No. **2015**

Product: Running Boards

Application: **Crew Cab**

Dodge Ram 1500 2009-2018

Dodge Ram HD 2019+

Level of Difficulty: **1 2 3 4 5**

Installation Time: **60 Min**

REV 3 02/24/20

Hardware	Torque Specifications
M6 Bolt	3 ft-lbs.
M8 Bolt	7 ft-lbs.
M10 Bolt	16 ft-lbs.
M12 Bolt	28 ft-lbs.

ATTENTION: Use correct torque settings to avoid damaging the running boards and or mounting brackets. Failure to do so will void your warranty.

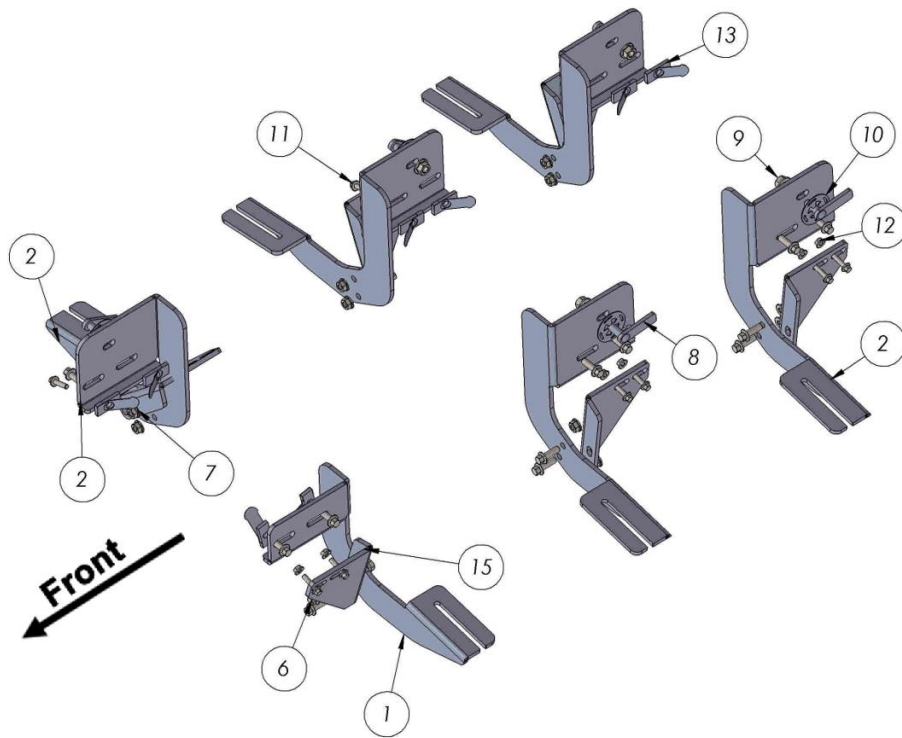

ITEM	PART NAME	QTY
1	2016850F0 DRIVER	1
2	2016850C0B0 DRIVER	3
3	2016850F0C0B0 PASSENGER	2
4	2016850FCB1 DRIVER	3
5	2016850FCB1 PASSENGER	2
6	DIN 6921 FLANGE BOLT M8 x 25	24
7	DIN 6923 FLANGE NUT M8	12
8	HTC 262 - M10x30(5x15x60)	5
9	DIN 6923 FLANGE NUT M10	4
10	HTC 269 CLIPS (M10)	5
11	DIN 6921 FLANGE BOLT M6 x 25	12
12	DIN 6923 FLANGE NUT M6	12
13	HTC 295 M8 SPECIAL NUT	12
15	2016850FCB1 DRIVER B	1





Installation Instructions

Part No. **2015**

Product: Running Boards

Application: **Quad Cab**

Dodge Ram 1500 2009-2018

Dodge Ram HD 2019+

Level of Difficulty: **1** 2 3 4 5

Installation Time: 60 Min

REV 3 02/24/20

Hardware	Torque Specifications
M6 Bolt	3 ft-lbs.
M8 Bolt	7 ft-lbs.
M10 Bolt	16 ft-lbs.
M12 Bolt	28 ft-lbs.

ATTENTION: Use correct torque settings to avoid damaging the running boards and or mounting brackets. Failure to do so will void your warranty.

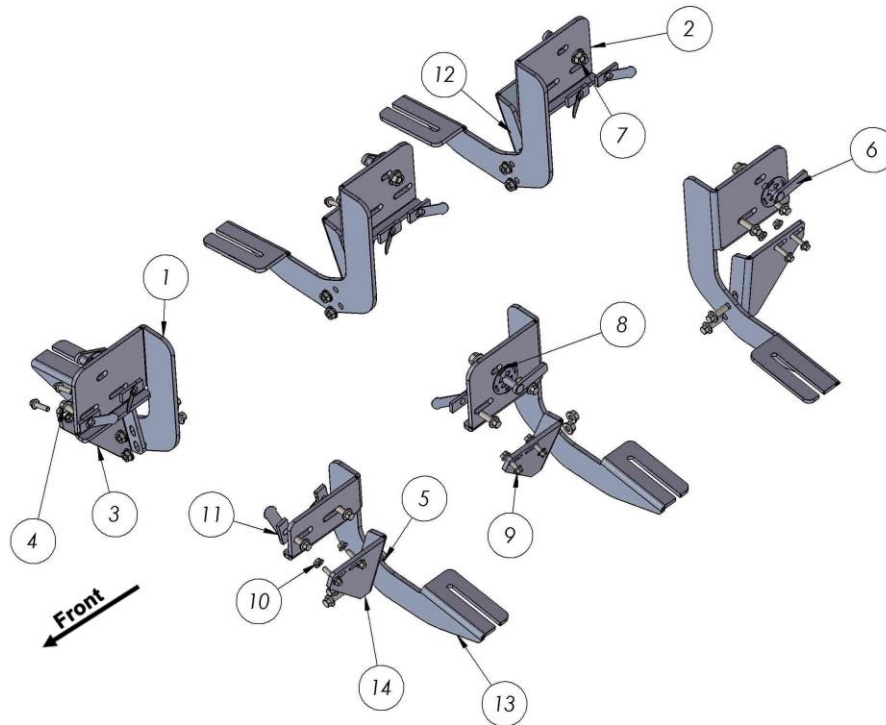

ITEM	PART NAME	QTY
1	2015850C0B0	2
2	2015850F0C0B0	3
3	2015850FCB1	2
4	DIN 6921 FLANGE BOLT M8 x 25	24
5	DIN 6923 FLANGE NUT M8	12
6	HTC 262 - M10x30(5x15x60)	5
7	DIN 6923 FLANGE NUT M10	4
8	HTC 269 CLIPS (M10)	5
9	DIN 6921 FLANGE BOLT M6 x 25	12
10	DIN 6923 FLANGE NUT M6	12
11	HTC 295 M8 SPECIAL NUT	12
12	2015850FCB1	3
13	2015850F0	1
14	2015850FCB1 A	1



Installation Instructions 2015 Bracket Kit

Step 1: Locate front mounting locations and hardware as per 1st page of this installation manual for Crew Cab use page one, for Quad Cab use page 2.

Step 2: Remove factory tape from all 3 locations, Insert HTC 295 on all 3 locations as shown Figure 2. Note some models come equipped with threaded inserts and this step may not be necessary.

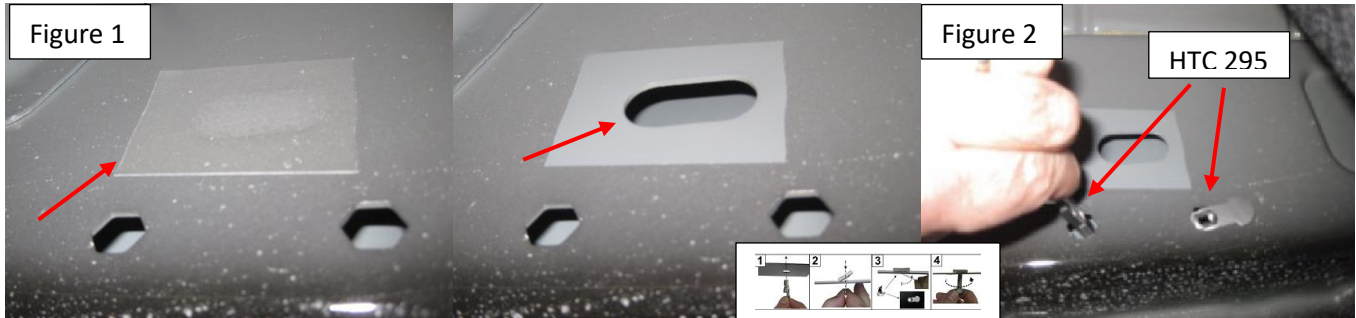

Step 3: Install provided HTC 262 as shown on Figure 3, install main bracket as shown on Figure 4. Do not tighten

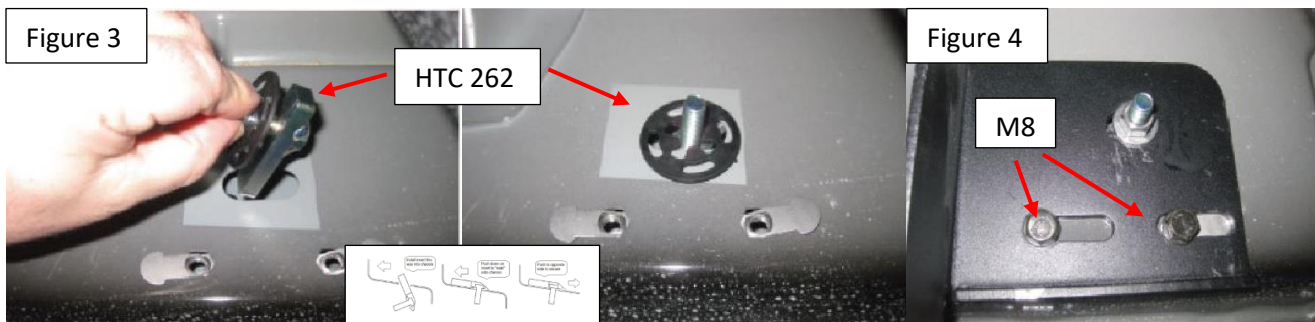

Step 4: Install extra support bracket with supplied M6 hardware on all 3 locations Figure 5, attach using supplied M6 hardware Figure 6. Attach main bracket to extra support using supplied M8 hardware Figure 7.



Step 5: Proceed to last page of this manual for running board install instructions and torque values.

Thank you for choosing Romik.

Running Board Installation Instructions

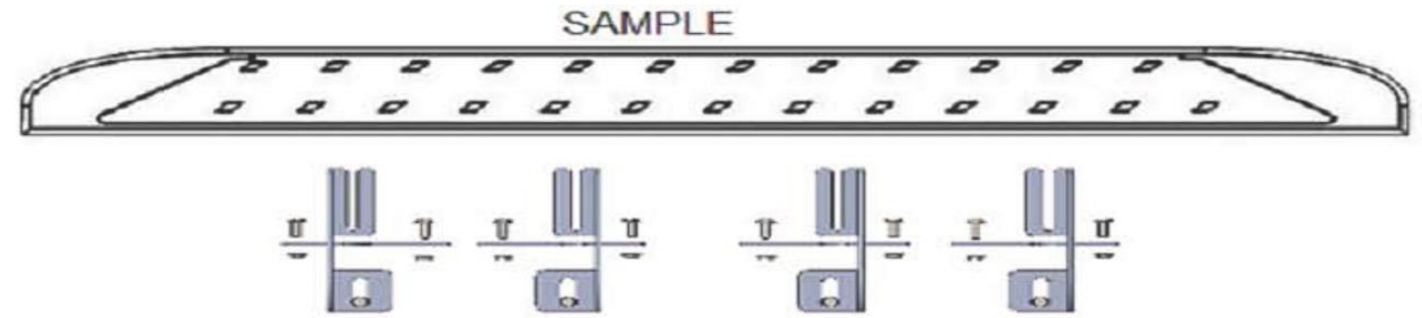

RAL / RB2 / REC / RCV / RZR



ROB / ROF / RPD

- 1) Flip your Romik running boards onto a flat surface, make sure to place the running boards on a towel or cardboard in order to protect the surface Figure 1.
- 2) Loosen the M8 bolts on back of your running boards Figure 2. Depending on your model there will be either 6 or 8 bolts installed per side.
- 3) Once your brackets have been installed, place the running board onto the brackets as shown on Figure 3.
- 4) Adjust running boards, centering on vehicle. Hand tight M8 hardware on running boards.
- 5) Follow the torque procedures, torque M8 hardware to **7 ft-lbs** using a torque wrench.
- 6) Cleaning and maintaining your running boards is important, apply a light coat of a quality carnauba wax at least 2X per year. Wash often with mild soap and make sure to remove all soap residue. Many car automatic carwashes use a strong soap, make sure to use enough water to remove all residue.
- 7) Register your products at Romik/contact/productregistration
- 8) Warranty information at Romik/warranty