

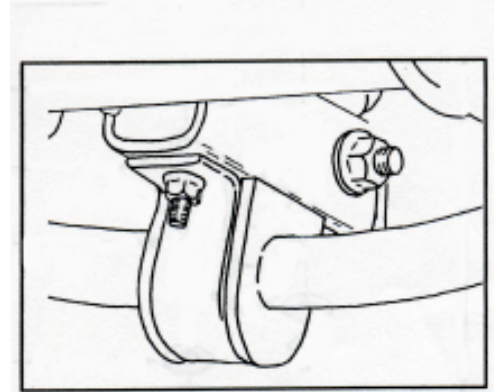

# Installation Instructions

## Urethane Bushings for 1-3/4" Rear Sway Bar Chevrolet P30 Chassis

part # 4109-106



### INTRODUCTION

Thank you for purchasing our urethane bushings. This kit is designed to improve the handling characteristics of your Chevy P30 by reducing the body roll and balancing the weight transfer during cornering.

All the hardware needed for installation is included in this kit. Refer to the PARTS LIST in these instructions to identify the parts.

### SUGGESTED TOOLS

The following tools are suggested to complete the installation procedures:

- 9/16" open/box wrench
- Floor or bottle jack
- Knife or razor blades
- Rags or paper towels

### **WARNING**

- If raising the vehicle to install the anti-sway bar, always support the vehicle with jack stands at both frame rails or at the rear axle before working underneath. Ensure that the jack stands are securely positioned, and are rated at or above the weight of the vehicle.
- The installer must read the instructions and use all bolts and parts supplied. Use only the parts supplied by ROADMASTER to install this kit.
- Minor modifications are sometimes necessary due to slight vehicle variations, even for the same year, make and model.
- If running changes were made by the manufacturer after this kit was designed, there may be weldments, braces, gussets, or other structural items which interfere with the installation. It is the installer's responsibility to allow for these running changes without sacrificing the structural integrity of the anti-sway bar. Failure to securely fasten the anti-sway bar could result in property damage, personal injury or even death.
- ROADMASTER will not be responsible for any damage or injury resulting from any modification or alteration.
- Check ALL the fasteners for tightness before and after road testing the vehicle.
- Do not use this document for custom fabrication, as it may not show all parts or structural components.
- Do not use an air impact wrench when re-installing bolts, as stripped threads may result.
- This anti-sway bar is only warranted for the original installation. Installing a used anti-sway bar on another vehicle is not recommended and will void the warranty.

### **WARNING**

**Failure to follow these instructions can result in property damage, personal injury or even death.**

# PARTS LIST

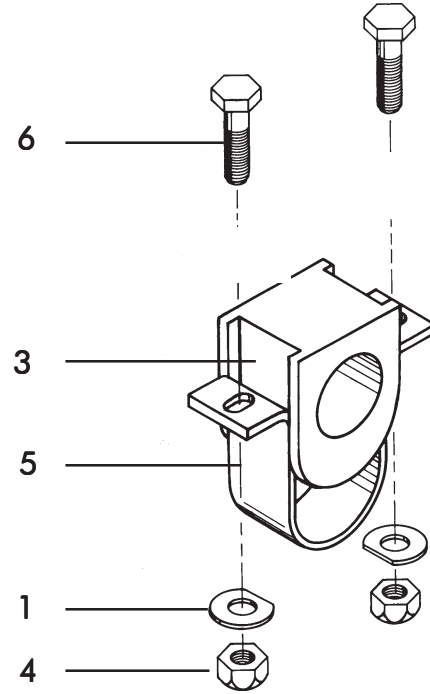
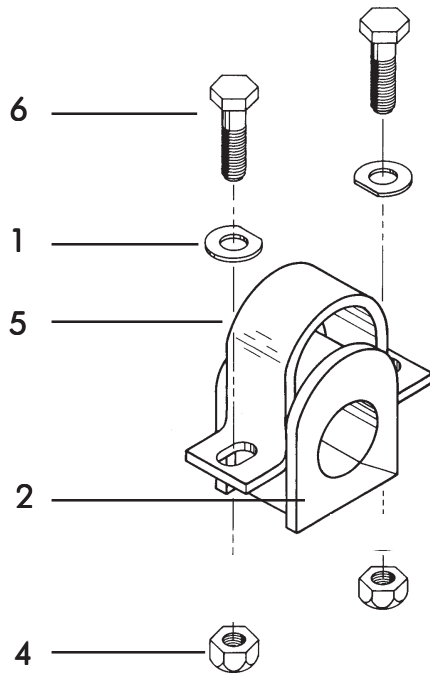

## Part #4106-106

Part #	Description	Qty
1. 350304-30	Washer, D shaped	8
2. 205220-00	Urethane bushing	2
3. 205220-10	Urethane bushing,split	2
4. 350272-00	Locknut, 3/8"	8
5. B140	Saddle bracket	4
6. 350058-80	Bolt, 3/8" x 1-3/4"	8
7. *400011-30	AQUALUBE Grease	1

\*not pictured

### Free Extended Warranty

You must accurately and completely fill out and mail the product registration card within thirty (30) days from the date of purchase to qualify for your warranty. **If we receive your card, completely and accurately filled out, within twenty (20) days from the date of purchase, we will extend the coverage to a total of two (2) years at no extra charge.**

Your product registration is an important record for ROADMASTER to keep in touch with you. It also enables us to expedite any future claim, update or recall that may arise concerning our products.

# INSTALLATION

*The following instructions must be followed in the order listed to ensure a proper installation and to preserve the ROADMASTER warranty.*

1. Lubricate the solid urethane bushing (Figure 1) and push over the end of the anti-sway bar and slide it into place. Now, push the new saddle bracket over the solid bushing (2 above). This may require tapping with a hammer. Bolt the bushing and bracket into place, leaving the bolts loose. Repeat steps 1 and 2 on the other end of the anti-sway bar.
2. Move to the inner bushings. Place a jack under the center of the anti-sway bar so it can be lowered and raised easily.
3. Remove the 3/8" bolts and saddle brackets. Now, make a cut through the factory rubber bushing, using a knife or razor blade. Remove the factory bushing.
4. Lubricate the urethane bushing and slide them over the anti-sway bar and into place (# 1, above). Push the bracket over the bushing and tap into place, if necessary. Start the bolts, making certain that the D washers (350304-30) fit against the new brackets.
5. Once you have all the bushings and brackets in place, tighten all bolts to 25-30 ft.-lbs.
6. Remove the jack and all factory parts and pieces from under the coach or truck.
7. Test drive and listen for noise.



## WARNING

After road testing, re-check all fasteners for proper tightness — if a fastener has worked loose or fallen off, re-tighten or replace it. Without all kit components properly tightened or in place, the anti-sway bar will not stabilize the vehicle at full capacity, which may cause reduced cornering ability or other reductions in vehicle handling or performance.

Failure to follow these instructions may result in property damage, personal injury or even death.

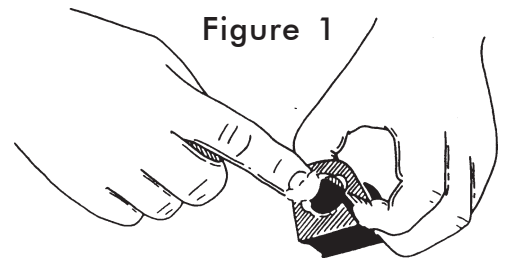

Figure 1