



MOUNTING BRACKET KIT INSTALLATION INSTRUCTIONS

KIT# 3148-3

12/10/12

Important

Note: this bracket will not accommodate the Guardian rock shield, some models of the Tow Defender, Stowaway or the StowMaster and StowMaster All Terrain tow bars.

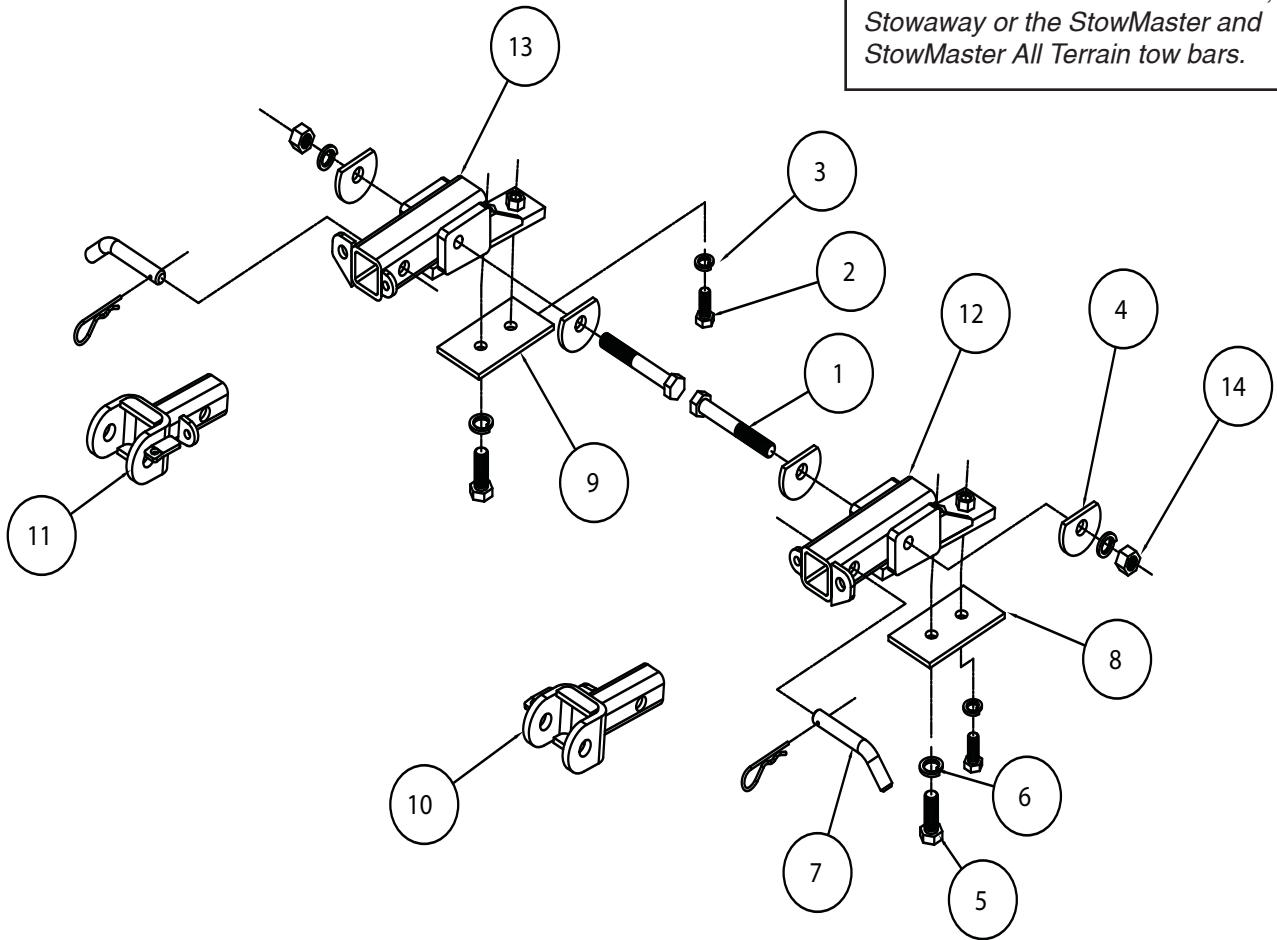

ITEM	QTY	NAME	MATERIAL
1.....2.....	2.....	5/8" x 5" BOLT	350160-00
2.....2.....	2.....	1/2" x 1 3/4" BOLT	350096-00
3.....2.....	2.....	1/2" LOCK WASHER.....	350309-00
4.....4.....	4.....	5/8" PLATE WASHER	350352-00
5.....2.....	2.....	5/8" x 1 3/4" BOLT	350149-00
6.....4.....	4.....	5/8" LOCK WASHER.....	350313-00
7.....2.....	2.....	DRAW PIN W/ CLIP	357035-00
8.....1.....	1.....	1/4" x 2 3/4" x 5" BACKING PLATE.....	A-001995
9.....1.....	1.....	1/4" x 2 3/4" x 5" BACKING PLATE W/ OFFSET HOLES	A-002409
10.....1.....	1.....	DRIVER SIDE ARM	C-001476
11.....1.....	1.....	PASSENGER SIDE ARM.....	C-001477
12.....1.....	1.....	DRIVER SIDE RECEIVER.....	C-001523
13.....1.....	1.....	PASSENGER SIDE RECEIVER	C-001524
14.....2.....	2.....	5/8" HEX NUT.....	350262-00



MOUNTING BRACKET KIT INSTALLATION INSTRUCTIONS

KIT# 3148-3

12/10/12

This is one of our MX series brackets, which allows the visible front portion of the bracket to be easily removed from the front of the vehicle (Fig.A and Fig.B). The bracket kit consists of a passenger and driver side main receiver brace, two removable front braces and a hardware pack. The main receiver braces mount to the sway bar mounts and the bumper core; the removable front braces install in the main receiver braces.

Before starting the installation, lay out the kit components in order, as they will be used. This will give you a visual idea of how the components work, and will also confirm that everything is present and accounted for.



IMPORTANT: All brackets **must** be assembled with all the bolts left loose for final adjustment and positioning (before tightening) unless otherwise instructed. All bolts **must** be torqued for proper strength. If more than one bolt is used per fastening point, the diagram may only show one.

- Use flat washers over all slotted holes
- Use lock washers on all fasteners

ROADMASTER Limited Warranty, including One-Year Conditional Warranty Text and Product Registration Card, in Carton.

WARNING

Failure to follow these instructions can result in property damage, personal injury or even death.

- Installation of most mounting brackets requires moderate mechanical aptitude and skills. We strongly recommend professional installation by an experienced installer.
- The installer must read the instructions and use all bolts and parts supplied. Failure to do so could result in loss of the towed vehicle.
- Use Loctite® Red on all bolts used for mounting this bracket.
- Every 3,000 miles, the owner must inspect the fasteners for proper torque, according to the bolt torque requirements chart on the last page of these instructions. The owner must also inspect all mounts and brackets for cracks or other signs of fatigue every 3,000 miles. Failure to do so could result in loss of the towed vehicle.
- The owner must check the vehicle manufacturer's instructions for the proper procedure(s) to prepare the vehicle for towing. Some vehicles must be equipped with a transmission lube pump, an axle disconnect, driveline disconnect or free-wheeling hubs before they can be towed. Failure to properly equip the vehicle will cause severe damage to the transmission.
- If running changes were made by the vehicle manufacturer after this bracket was designed, some bolts or other fasteners in the hardware pack may no longer be the correct size. It is the installer's responsibility to verify that the bracket is securely fastened to the vehicle and fitted with the correct hardware to account for these changes. Failure to securely fasten the bracket could result in loss of the towed vehicle.
- If the towed vehicle has been in an accident, it must be properly repaired before attaching the bracket. Do not install the bracket if any structural frame damage is found. Failure to repair the damage could result in the loss of the towed vehicle.
- Roadmaster manufactures many styles of brackets. If your bracket has removable arms, they must be removed before driving the vehicle, unless the arms can be pinned or padlocked in place. If not secured, the arms could vibrate out, resulting in non-warranty damage or personal injury.
- Some motorhome chassis have such a tight turning radius that you can damage your motorhome, towed vehicle, tow bar or bracket while turning sharply. Before getting on the road, test your turning radius in an empty parking lot. Turning too sharply could result in non-warranty damage to towing system, motorhome and/or towed vehicle.
- Do not back up with the towed vehicle attached or non-warranty damage will occur to your towing system, motorhome and/or towed vehicle.
- The safety cables must connect the towing vehicle to the towed vehicle frame to frame, with the cables crossed, with enough slack for sharp turns. Refer to the cable instructions for proper routing. Failure to leave enough slack in the safety cables, or failure to connect the safety cables frame to frame, will result in the loss of the towed vehicle.
- This bracket is designed for use with ROADMASTER tow bars and ROADMASTER adaptors only. Using this bracket with other brands, without an approved ROADMASTER adaptor, may result in non-warranty damage or injury.
- Do not use this document for custom fabrication, as it may not show all parts or structural components. Custom fabrication or an attempt to copy this bracket design could result in loss of the towed vehicle.
- Upon final installation, the installer must inspect the bracket to ensure adequate clearance, particularly around hoses, air conditioner lines, radiators, etc., or non-warranty damage to the towed vehicle will result.
- This bracket is only warranted for the original installation. Installing a used bracket on another vehicle is not recommended and will void the warranty.



MOUNTING BRACKET KIT INSTALLATION INSTRUCTIONS

KIT# 3148-3

12/10/12

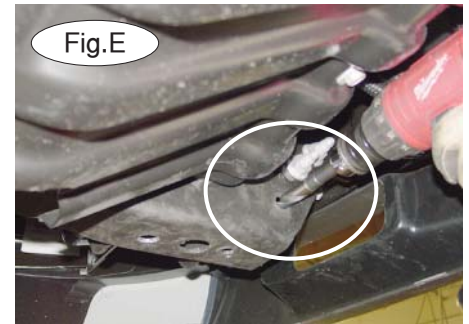
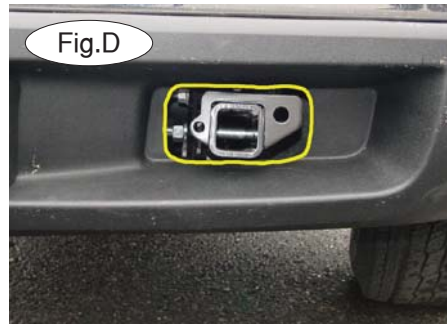

1. **Important:** please use all supplied bolts and parts and read all instructions carefully before beginning this installation. The majority of questions you may have can be answered within the text, and proper installation will ensure safe and secure travel. Now, begin the installation. First remove both tow hooks by removing the two 18mm (head) bolts attaching the tow hooks to the frame rails (Fig.C).

2. On both sides, trim the fascia around the tow hooks, to allow clearance for the main receiver braces. Use the yellow marker line in Figure D as a reference.

3. On both sides, use a 5/8" drill bit to enlarge the front tow hook mounting holes. Drill through both the front and back sides of the frame rails (Fig.E).

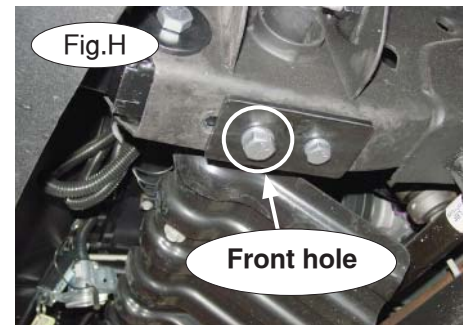

4. Insert the driver side main receiver brace through the tow hook opening and into the front of the frame rail (Fig.F).

5. Using the two supplied 5/8" x 5" bolts, 5/8" clipped plate washers, lock washers and nuts, bolt through the side of the frame rail, into the main receiver brace and through the other side of the frame rail. Finish with the lock washers and nuts (Fig.G). *Note:* place the clipped plate washers on the outside of the frame rail.

6. Now, place the supplied 1/4" x 2 3/4" x 5" backing plate over the bottom of the frame rail and bolt it into place using a 5/8" x 1 3/4" bolt and lock washer in the front hole, and a 1/2" x 1 3/4" bolt and lock washer in the rear hole (Fig.H). *Note:* due to manufacturing variances the holes may need to be enlarged.

7. Tighten all the bolts, starting with the lowest ones to the torque specification listed at the end of these instructions.

8. Repeat steps 4 through 7 for the passenger side.

9. Fit the removable front braces into the main receiver braces, and secure them in place with the supplied 5/8" draw pins and spring pins (Fig.I).

10. Install the tow bar to the mounting bracket according to the manufacturer's instructions.

11. Attach the safety cables to the main receiver brace.





MOUNTING BRACKET KIT INSTALLATION INSTRUCTIONS

KIT# 3148-3

12/10/12

BOLT TORQUE REQUIREMENTS

Note: The torque values represented below are intended as general guidelines. Torque requirements for specific applications may vary. Roadmaster does not warrant this information to be accurate for all applications and disclaims all liability for any claims or damages which may result from its use.

STANDARD BOLTS

<i>Thread Size</i>	<i>Grade</i>	<i>Torque</i>
5/16.....	5.....	13 ft./lb.
3/8.....	5.....	23 ft./lb.
7/16.....	5.....	37 ft./lb.
1/2.....	5.....	56 ft./lb.
5/8.....	5.....	150 ft./lb.

METRIC BOLTS

<i>Thread Size</i>	<i>Grade</i>	<i>Plated / Unplated</i>
8mm-1.0	8.8	20 ft./lb. 18 ft./lb.
8mm-1.25	8.8	19 ft./lb. 18 ft./lb.
10mm-1.25	8.8	38 ft./lb. 36 ft./lb.
10mm-1.5	8.8	37 ft./lb. 35 ft./lb.

METRIC BOLTS

<i>Thread Size</i>	<i>Grade</i>	<i>Plated / Unplated</i>
12mm-1.25	8.8	70 ft./lb. 65 ft./lb.
12mm-1.5	8.8	66 ft./lb. 61 ft./lb.
12mm-1.75	8.8	65 ft./lb. 60 ft./lb.
14mm-2.0	8.8	104 ft./lb. 97 ft./lb.

All illustrations and specifications contained herein are based on the latest information available at the time of publication approval. ROADMASTER, INC. reserves the right to make changes at any time without notice in material, specification and models or to discontinue models.