

# MOUNTING BRACKET KIT

## INSTALLATION INSTRUCTIONS

### PARTS LIST:

- 1- FRONT BRACE (A) - Passenger side
- 1- FRONT BRACE (B) - Driver side
- 1- MAIN BRACE (C) - Passenger side
- 1- MAIN BRACE (D) - Driver side
- 1- CROSS BAR (E)

KIT NO. 3107-1

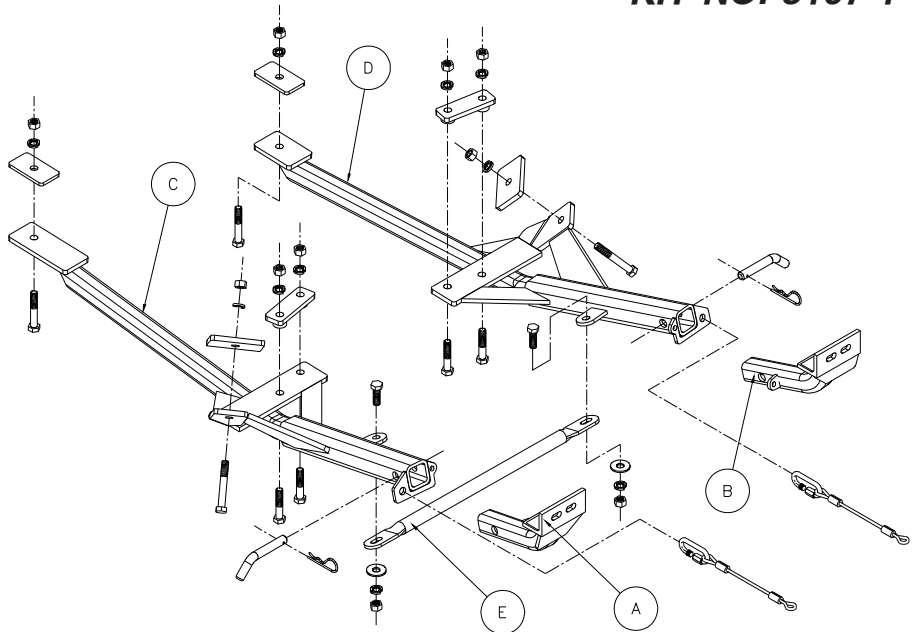

2/8/02

**IMPORTANT:** All brackets *must* be assembled with all the bolts left loose for final adjustment and positioning (before tightening) unless otherwise instructed. All bolts *must* be torqued for proper strength. If more than one bolt is used per fastening point, the diagram may only show one.

- Use flat washers over all slotted holes
- Use lock washers on all fasteners

ROADMASTER Limited Warranty, including One-Year Conditional Warranty Text and Product Registration Card, in Carton.

## WARNING

Failure to follow these instructions can result in property damage, personal injury or even death.

- Installation of most mounting brackets requires moderate mechanical aptitude and skills. We strongly recommend professional installation by an experienced installer.
- The installer must read the instructions and use all bolts and parts supplied. Failure to do so could result in loss of the towed vehicle.
- Use Loctite® Red on all bolts used for mounting this bracket.
- Do not use this document for custom fabrication, as it may not show all parts or structural components. Custom fabrication or an attempt to copy this bracket design could result in loss of the towed vehicle.
- Every 3,000 miles, the owner must inspect the fasteners for proper torque, according to the bolt torque requirements chart on the last page of these instructions. The owner must also inspect all mounts and brackets for cracks or other signs of fatigue every 3,000 miles. Failure to do so could result in loss of the towed vehicle.
- The owner must check the vehicle manufacturer's instructions for the proper procedure(s) to prepare the vehicle for towing. Some vehicles must be equipped with a transmission lube pump, an axle disconnect, driveline disconnect or free-wheeling hubs before they can be towed. Failure to properly equip the vehicle will cause severe damage to the transmission.
- If running changes were made by the vehicle manufacturer after this bracket was designed, some bolts or other fasteners in the hardware pack may no longer be the correct size. It is the installer's responsibility to verify that the bracket is securely fastened to the vehicle and fitted with the correct hardware to account for these changes. Failure to securely fasten the bracket could result in loss of the towed vehicle.
- If the towed vehicle has been in an accident, it must be properly repaired before attaching the bracket. Do not install the bracket if any structural frame damage is found. Failure to repair the damage could result in the loss of the towed vehicle.
- Some motorhome chassis have such a tight turning radius that you can damage your motorhome, towed vehicle, tow bar or bracket while turning sharply. Before getting on the road, test your turning radius in an empty parking lot. Turning too sharply could result in non-warranty damage to towing system, motorhome and/or towed vehicle.
- Do not back up with the towed vehicle attached or non-warranty damage will occur to your towing system, motorhome and/or towed vehicle.
- The safety cables must connect the towing vehicle to the towed vehicle frame to frame, with the cables crossed, with enough slack for sharp turns. Refer to the cable instructions for proper routing. Failure to leave enough slack in the safety cables, or failure to connect the safety cables frame to frame, will result in the loss of the towed vehicle.
- This bracket is designed for use with ROADMASTER tow bars and ROADMASTER adaptors only. Using this bracket with other brands, without an approved ROADMASTER adaptor, may result in non-warranty damage or injury.
- Upon final installation, the installer must inspect the bracket to ensure adequate clearance, particularly around hoses, air conditioner lines, radiators, etc., or non-warranty damage to the towed vehicle will result.
- This bracket is only warranted for the original installation. Installing a used bracket on another vehicle is not recommended and will void the warranty.

# MOUNTING BRACKET KIT INSTALLATION INSTRUCTIONS

**KIT NO. 3107-1**

1. **Important:** please use all supplied bolts and parts and read all instructions carefully before beginning this installation. The majority of questions you may have can be answered within the text, and proper installation will ensure safe and secure travel. Now, begin the installation. This bracket kit consists of two rear main braces, two front braces and a hardware pack. The main receiver braces mount behind and below the front bumper to the front suspension sub frame. Start by laying the kit out according to the illustration. This will give you a visual idea of how the kit installs and also confirm that the kit components are present and accounted for. Start by removing the lower air deflector (five 10mm screws). The deflector will be trimmed later to fit after the bracket kit is fully installed.
2. Working on one side at a time, locate the large reinforced hole in the side of the sub frame adjacent to the front isolation mount. Support or clamp the brace to the bottom of the sub frame with the front side-mounting tab over this large hole. The rear-mounting hole in the receiver brace should line up with an existing hole through the rear of the sub frame.
3. Take a 1/4" x 2" x 3 1/2" backing plate and position on the top of the sub frame over this rear hole. Bolt through the receiver brace, sub frame and backing plate with a 1/2" x 3" bolt, lock washer and nut.
4. Now take the special spacer backing plate and insert it into the square access hole found on the inside of the sub frame. This spacer plate is designed to fit over the existing hole in the bottom of the sub frame and bridge the sub frame opening. Bolt through the receiver brace, sub frame and spacer plate with 1/2" x 2 1/2" bolts, lock washers and nuts.
5. Using the receiver brace as a template, drill through the side of the sub frame with a 17/32" drill bit. Use a backing plate above the sub frame to avoid any damage from the drill bit.
6. Put a 3/8" x 2 1/2" x 4" backing plate above the sub frame and bolt through the receiver brace, sub frame and backing plate with a 1/2" x 3 1/2" bolt, lock washer and nut.
7. Repeat steps 2 through 6 for the remaining receiver brace.
8. Align cross bar with the underside of the mounting tabs and bolt in place with a 1/2" x 1 1/2" bolt, flat washer, lock washer and nut on each side. Leave loose for now.
8. Install the front braces in the receiver braces and pin in place with 5/8" draw pins and 1/8" spring pins.
8. Check alignment then torque all mounting bolts to the specifications below.
9. Trim the lower air dam to fit and reinstall.
10. Install the tow bar according to the manufacturer's instructions and torque all mounting bolts to the specifications below.

**2/8/02**

## BOLT TORQUE REQUIREMENTS

Note: The torque values represented below are intended as general guidelines. Torque requirements for specific applications may vary. Roadmaster does not warrant this information to be accurate for all applications and disclaims all liability for any claims or damages which may result from its use.

STANDARD BOLTS			METRIC BOLTS			METRIC BOLTS		
Thread Size	Grade	Torque	Thread Size	Grade	Plated/Unplated	Thread Size	Grade	Plated/Unplated
5/16	5	13 ft./lb.	8mm-1.0	8.8	20 ft./lb. 18 ft./lb.	12mm-1.25	8.8	70 ft./lb. 65 ft./lb.
3/8	5	23 ft./lb.	8mm-1.25	8.8	19 ft./lb. 18 ft./lb.	12mm-1.5	8.8	66 ft./lb. 61 ft./lb.
7/16	5	37 ft./lb.	10mm-1.25	8.8	38 ft./lb. 36 ft./lb.	12mm-1.75	8.8	65 ft./lb. 60 ft./lb.
1/2	5	56 ft./lb.	10mm-1.5	8.8	37 ft./lb. 35 ft./lb.	14mm-2.0	8.8	104 ft./lb. 97 ft./lb.
5/8	5	150 ft./lb.						

# MOUNTING BRACKET KIT INSTALLATION INSTRUCTIONS

**KIT NO. 3107-1**

**Hardware**

- 4- 1/2" x 2 1/2" bolts
- 2- 1/2" x 3" bolts
- 2- 1/2" x 3 1/2" bolts
- 2- 1/2" x 1 1/2" bolts
- 2- 1/4" x 2"x 3 1/2" backing plates (Rear)
- 2- 3/8" x 1 1/2" x 4 1/2" spacer backing plates (d.s and p.s.)
- 2- 3/8" x 2 1/2" x 4" backing plates (top front)
- 10- 1/2" lock washers
- 10- 1/2" nuts
- 2- 1/2" flat washers
- 2- 5/8" draw pins
- 2- 1/8" spring pins
- 2- Cable connectors
- 2- 8" safety cables

**2/8/02**

### **BOLT TORQUE REQUIREMENTS**

Note: The torque values represented below are intended as general guidelines. Torque requirements for specific applications may vary. Roadmaster does not warrant this information to be accurate for all applications and disclaims all liability for any claims or damages which may result from its use.

STANDARD BOLTS			METRIC BOLTS			METRIC BOLTS		
Thread Size	Grade	Torque	Thread Size	Grade	Plated/Unplated	Thread Size	Grade	Plated/Unplated
5/16	5	13 ft./lb.	8mm-1.0	8.8	20 ft./lb. 18 ft./lb.	12mm-1.25	8.8	70 ft./lb. 65 ft./lb.
3/8	5	23 ft./lb.	8mm-1.25	8.8	19 ft./lb. 18 ft./lb.	12mm-1.5	8.8	66 ft./lb. 61 ft./lb.
7/16	5	37 ft./lb.	10mm-1.25	8.8	38 ft./lb. 36 ft./lb.	12mm-1.75	8.8	65 ft./lb. 60 ft./lb.
1/2	5	56 ft./lb.	10mm-1.5	8.8	37 ft./lb. 35 ft./lb.	14mm-2.0	8.8	104 ft./lb. 97 ft./lb.
5/8	5	150 ft./lb.						

All illustrations and specifications contained herein are based on the latest information available at the time of publication approval. ROADMASTER, INC. reserves the right to make changes at any time without notice in material, specification and models or to discontinue models.