



# MOUNTING BRACKET KIT INSTALLATION INSTRUCTIONS

**KIT# 1912-3**

05/05/08

**Important**  
 Note: this bracket will not accommodate the Guardian rock shield, some models of the Tow Defender, Stowaway or the StowMaster and StowMaster All Terrain tow bars.

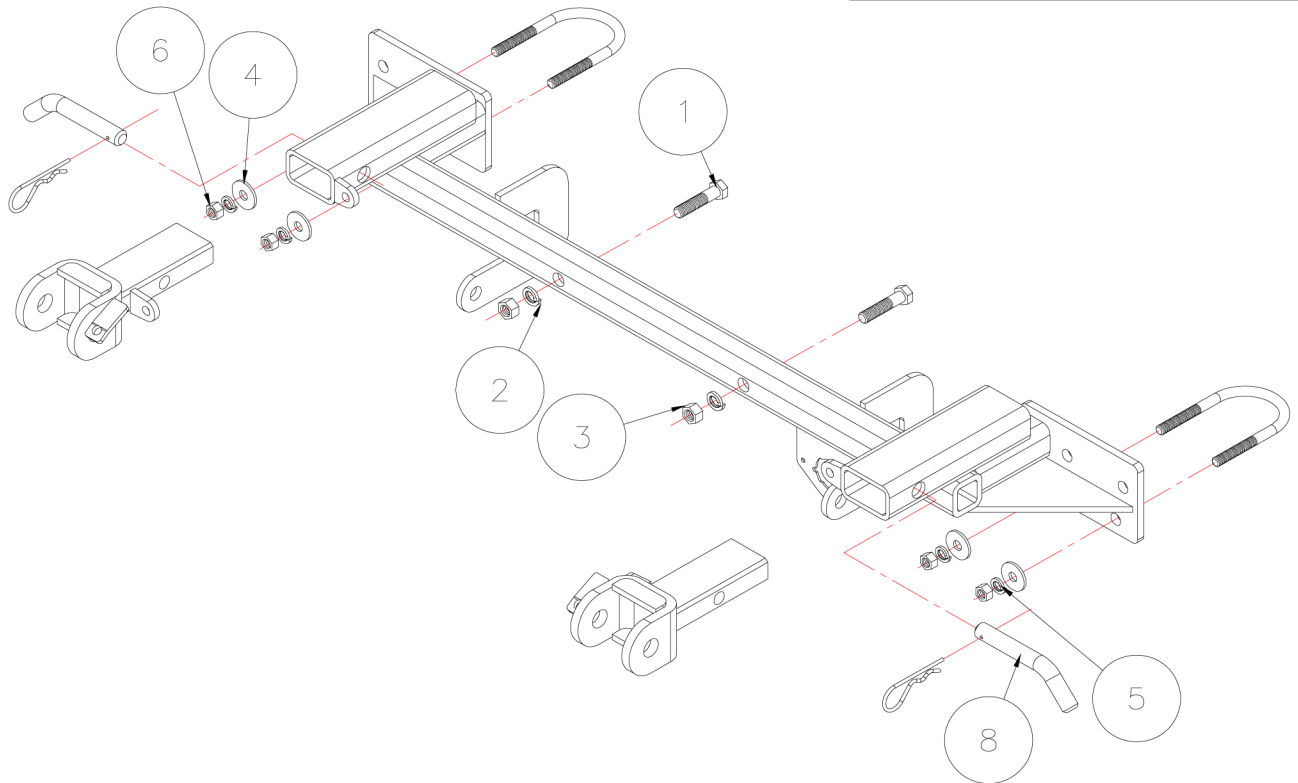

Item	Qty	Length	Width	Hardware	Part No.
1	2	3"	7/16"	BOLT	350080-00
2	2		7/16"	LOCK WASHER	350307-00
3	2		7/16"	NUT	350256-00
4	4		3/8"	FLAT WASHER	350304-50
5	4		3/8"	LOCK WASHER	350305-00
6	4		3/8"	NUT	350254-00
8	2	1/2"		DRAW PIN/SPRING PIN	357038-00



# MOUNTING BRACKET KIT INSTALLATION INSTRUCTIONS

**KIT# 1912-3**

05/05/08

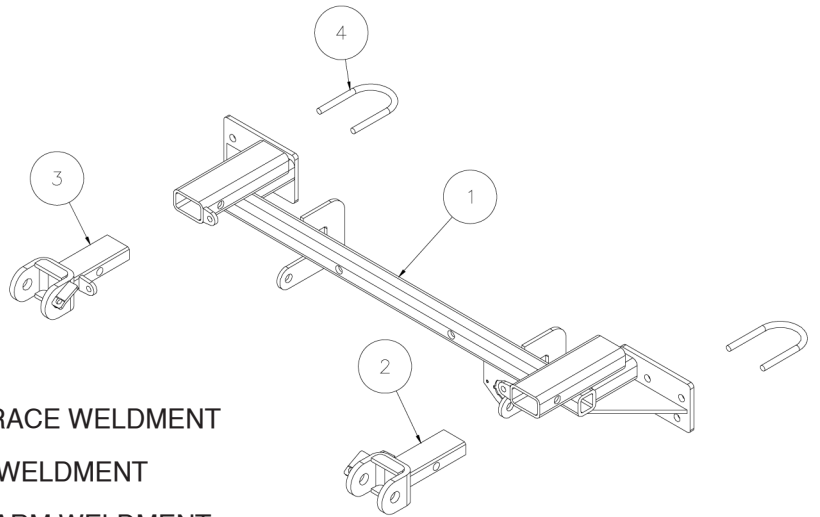

Item	Qty	Part No.	Assembly
1.....	1.....	C-000671.....	MAIN RECEIVER BRACE WELDMENT
2.....	1.....	C-000674.....	DRIVER SIDE ARM WELDMENT
3.....	1.....	C-000675.....	PASSENGER SIDE ARM WELDMENT
4.....	2.....	357361-00.....	U-BOLT

**IMPORTANT:** All brackets **must** be assembled with all the bolts left loose for final adjustment and positioning (before tightening) unless otherwise instructed. All bolts **must** be torqued for proper strength. If more than one bolt is used per fastening point, the diagram may only show one.

- Use flat washers over all slotted holes
- Use lock washers on all fasteners

ROADMASTER Limited Warranty, including One-Year Conditional Warranty Text and Product Registration Card, in Carton.

## WARNING

Failure to follow these instructions can result in property damage, personal injury or even death.

- **Installation of most mounting brackets requires moderate mechanical aptitude and skills.** We strongly recommend professional installation by an experienced installer.
- **The installer must read the instructions and use all bolts and parts supplied.** Failure to do so could result in loss of the towed vehicle.
- **Use Loctite® Red** on all bolts used for mounting this bracket.
- **Every 3,000 miles, the owner must inspect the fasteners** for proper torque, according to the bolt torque requirements chart on the last page of these instructions. **The owner must also inspect all mounts and brackets for cracks or other signs of fatigue every 3,000 miles.** Failure to do so could result in loss of the towed vehicle.
- **The owner must check the vehicle manufacturer's instructions for the proper procedure(s) to prepare the vehicle for towing.** Some vehicles must be equipped with a transmission lube pump, an axle disconnect, driveline disconnect or free-wheeling hubs before they can be towed. Failure to properly equip the vehicle will cause severe damage to the transmission.
- **If running changes were made** by the vehicle manufacturer after this bracket was designed, some bolts or other fasteners in the hardware pack may no longer be the correct size. **It is the installer's responsibility** to verify that the bracket is securely fastened to the vehicle and fitted with the correct hardware to account for these changes. Failure to securely fasten the bracket could result in loss of the towed vehicle.
- If the towed vehicle has been in an accident, it must be properly repaired before attaching the bracket. **Do not install the bracket if any structural frame damage is found.** Failure to repair the damage could result in the loss of the towed vehicle.
- Roadmaster manufactures many styles of brackets. **If your bracket has removable arms, they must be removed before driving the vehicle, unless the arms can be pinned or padlocked in place.** If not secured, the arms could vibrate out, resulting in non-warranty damage or personal injury.
- Some motorhome chassis have such a tight turning radius that you can damage your motorhome, towed vehicle, tow bar or bracket while turning sharply. **Before getting on the road, test your turning radius in an empty parking lot.** Turning too sharply could result in non-warranty damage to towing system, motorhome and/or towed vehicle.
- **Do not back up with the towed vehicle attached** or non-warranty damage will occur to your towing system, motorhome and/or towed vehicle.
- **The safety cables must connect the towing vehicle to the towed vehicle frame to frame, with the cables crossed, with enough slack for sharp turns.** Refer to the cable instructions for proper routing. Failure to leave enough slack in the safety cables, or failure to connect the safety cables frame to frame, will result in the loss of the towed vehicle.
- This bracket is designed for use with ROADMASTER tow bars and ROADMASTER adaptors only. **Using this bracket with other brands, without an approved ROADMASTER adaptor, may result in non-warranty damage or injury.**
- **Do not use this document for custom fabrication,** as it may not show all parts or structural components. Custom fabrication or an attempt to copy this bracket design could result in loss of the towed vehicle.
- Upon final installation, **the installer must inspect the bracket to ensure adequate clearance, particularly around hoses, air conditioner lines, radiators, etc.,** or non-warranty damage to the towed vehicle will result.
- **This bracket is only warranted for the original installation.** Installing a used bracket on another vehicle is not recommended and will void the warranty.



# MOUNTING BRACKET KIT INSTALLATION INSTRUCTIONS

**KIT# 1912-3**

05/05/08

This bracket kit is one of our MX series, which is designed to be partly removable. The kit consists of the main receiver brace, front braces and a hardware pack. The main receiver brace mounts behind the front bumper fascia to the frame and side of the radiator support on each side (Fig.A). The front braces insert into the receivers on each side.

Start by laying the kit out according to the illustration. This will give you a visual idea of how the kit installs and also confirm that the kit components are present and accounted for.

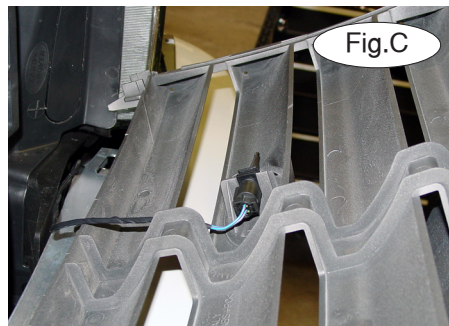

1. **Important:** please use all supplied bolts and parts and read all instructions carefully before beginning this installation. The majority of questions you may have can be answered within the text, and proper installation will ensure safe and secure travel. Now, begin the installation. Start by removing three (8mm head) fasteners in the top of the grille between the headlights (Fig.B). Pull the ambient air sensor from the grille (Fig.C) then pull the grille forward and up to remove.

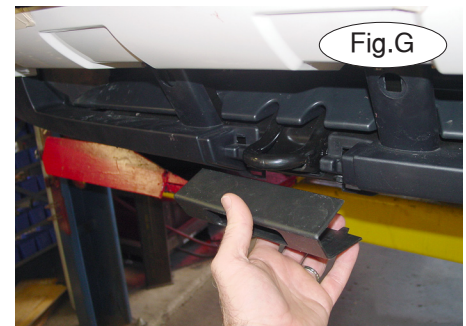

2. Remove four more fasteners from the top of the fascia (Fig.D).
3. Remove one (8mm head) fastener from each side panel (Fig.E).
4. Remove four more large Phillips fasteners from the lower grille area (Fig.F).
5. Remove the plastic tow hook covers (Fig.G).
6. Remove six (10mm head) bolts from the bottom of the fascia (Fig.H).

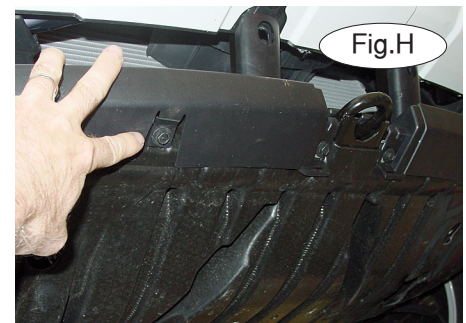



# MOUNTING BRACKET KIT INSTALLATION INSTRUCTIONS

**KIT# 1912-3**

05/05/08

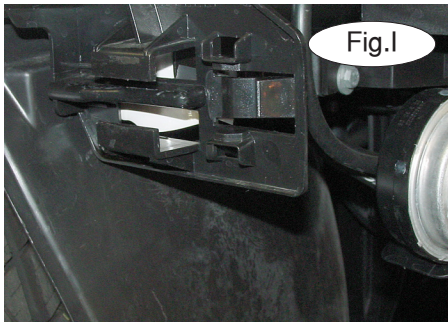

Fig.I



Fig.J

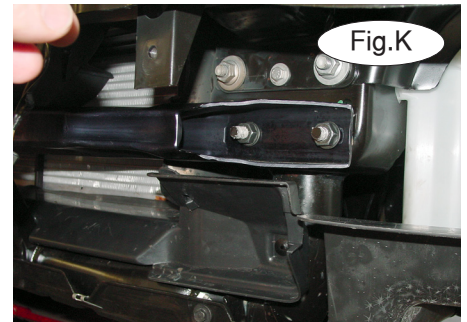

Fig.K

7. Disconnect the fog and marker lights then push in to release the fascia latches on each side and pull the bumper fascia forward to remove (Fig.I,J).

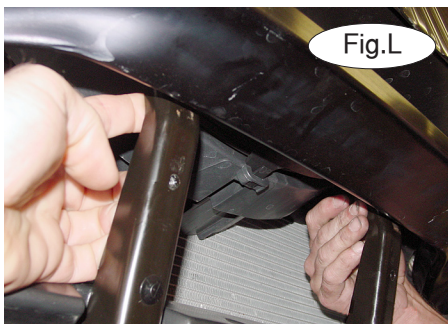

Fig.L



Fig.M

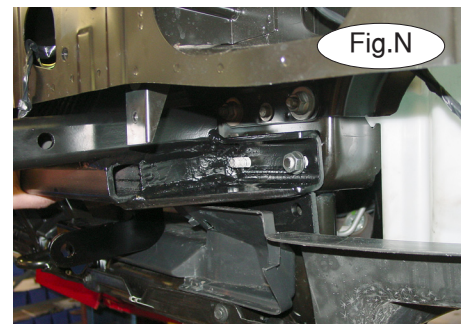

Fig.N

8. Remove the center crossmember (four 16mm nuts) two on each end (Fig.K), then two more bolts (10mm head) behind the bar (Fig.L,M). The main receiver brace will replace this crossmember.

9. Install the main receiver brace on the studs as shown (Fig.N) with the stock nuts removed in the previous step (Fig.O).



Fig.O

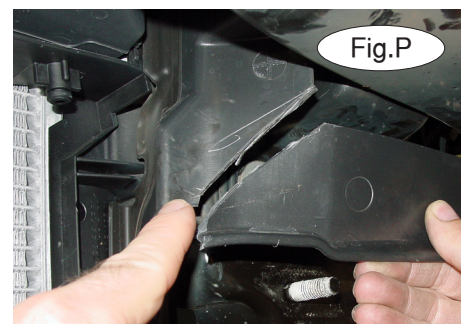

Fig.P

10. Trim the plastic air deflectors on both sides as shown to clear the receiver brace (Fig.P).

11. Bolt through the front brace with 7/16" x 3" bolts, lock washers and nuts (Fig.Q).

12. Install 3/8" bolts as shown (Fig.R,S) with nuts and lock washers.

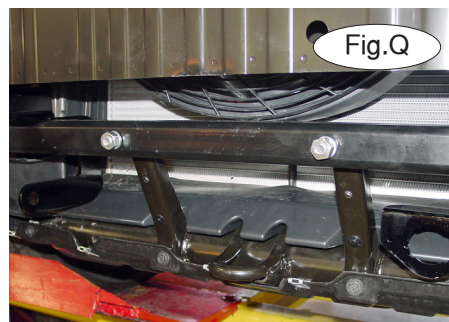

Fig.Q

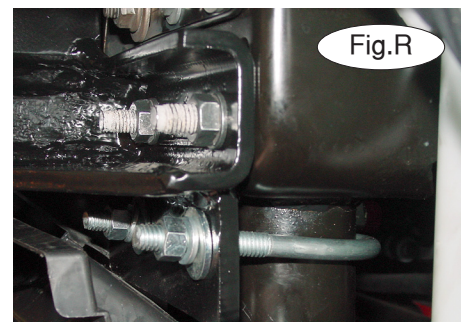

Fig.R



# MOUNTING BRACKET KIT INSTALLATION INSTRUCTIONS

**KIT# 1912-3**

05/05/08



13. Torque all mounting bolts to the torque specifications found at the end of this document.
14. Replace the fascia and grille reversing steps 1 through 7 (Fig.T).
15. Once the fascia and grille are installed, insert the front braces into the receiver braces and pin using 1/2" draw pins and 3/16" spring pins as shown (Fig.T). Mount the tow bar according to the manufacturer's instructions and attach the safety cables to the main receiver brace.

## BOLT TORQUE REQUIREMENTS

Note: The torque values represented below are intended as general guidelines. Torque requirements for specific applications may vary. Roadmaster does not warrant this information to be accurate for all applications and disclaims all liability for any claims or damages which may result from its use.

STANDARD BOLTS			METRIC BOLTS			METRIC BOLTS		
Thread Size	Grade	Torque	Thread Size	Grade	Plated / Unplated	Thread Size	Grade	Plated / Unplated
5/16.....	5.....	13 ft./lb.	8mm-1.0 .....	8.8 .....	20 ft./lb. 18 ft./lb.	12mm-1.25 .....	8.8 .....	70 ft./lb. 65 ft./lb.
3/8.....	5.....	23 ft./lb.	8mm-1.25 .....	8.8 .....	19 ft./lb. 18 ft./lb.	12mm-1.5 .....	8.8 .....	66 ft./lb. 61 ft./lb.
7/16.....	5.....	37 ft./lb.	10mm-1.25 .....	8.8 .....	38 ft./lb. 36 ft./lb.	12mm-1.75 .....	8.8 .....	65 ft./lb. 60 ft./lb.
1/2.....	5.....	56 ft./lb.	10mm-1.5 .....	8.8 .....	37 ft./lb. 35 ft./lb.	14mm-2.0 .....	8.8 .....	104 ft./lb. 97 ft./lb.
5/8.....	5.....	150 ft./lb.						

All illustrations and specifications contained herein are based on the latest information available at the time of publication approval. ROADMASTER, INC. reserves the right to make changes at any time without notice in material, specification and models or to discontinue models.