

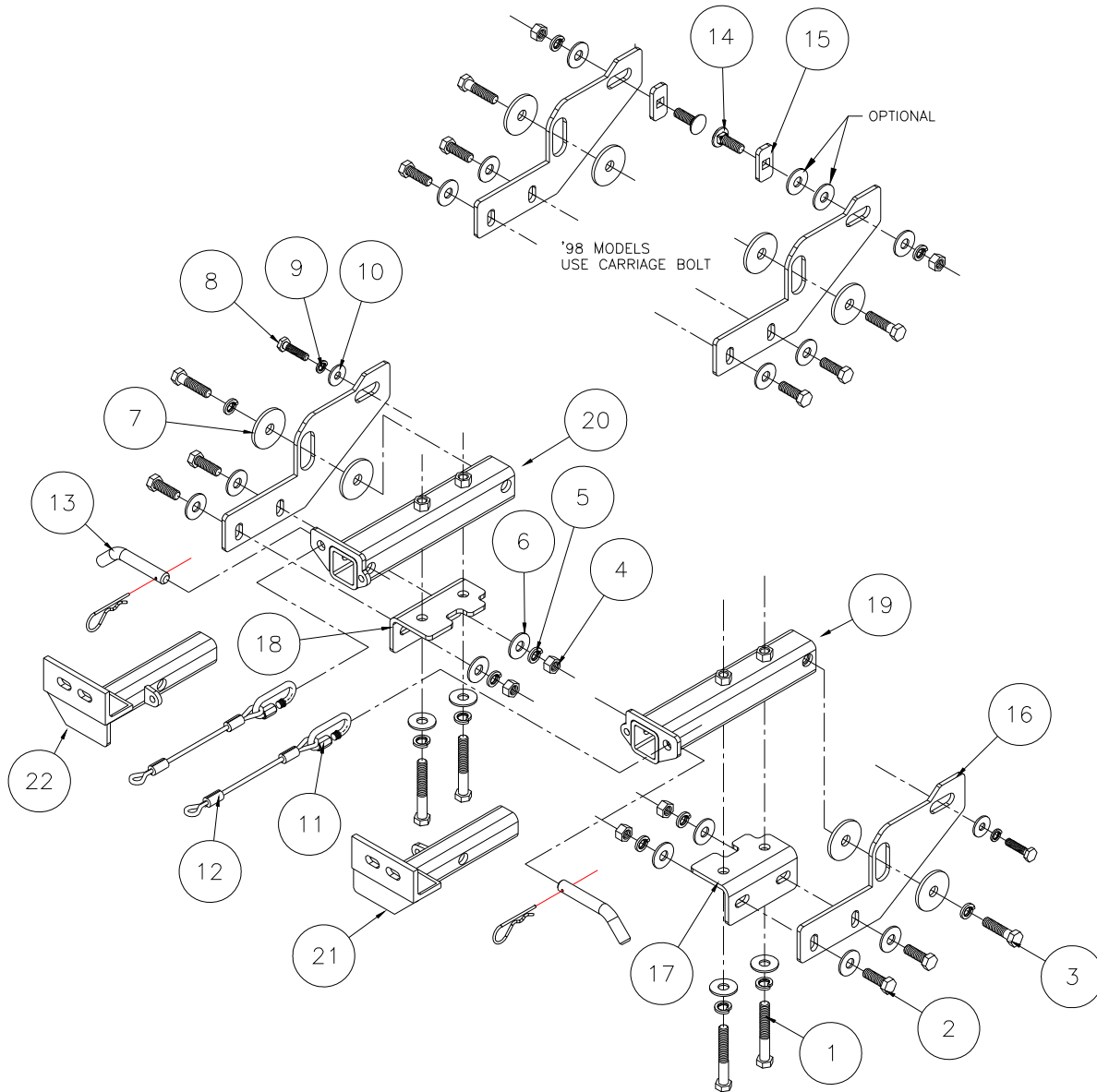

# MOUNTING BRACKET KIT INSTALLATION INSTRUCTIONS

**KIT# 179-2**

09/07/10  
KS



Hardware list on next page



# MOUNTING BRACKET KIT INSTALLATION INSTRUCTIONS

## KIT# 179-2

09/07/10  
KS

### Hardware

ITEM	QTY	NAME	MATERIAL
1	4	1/2" x 3 1/2" BOLT	350103-00
2	4	1/2" x 1 1/2" BOLT	350095-00
3	2	1/2" x 2" BOLT	350097-00
4	6	1/2" HEX NUT	350258-00
5	12	1/2" LOCK WASHER	350309-00
6	16	1/2" FLAT WASHER	350308-00
7	4	1/2" PLATE WASHER	350351-00
8	2	10mm x 1.50 x 40 mm BOLT	356103-00
9	2	10mm LOCK WASHER	355715-00
10	2	10mm FENDER WASHER	355702-00
11	2	QUICK LINK	200008-00
12	2	13" SAFETY CABLES (8000#)	650648-13
13	2	DRAW PIN W/ CLIP	357035-00
14	2	1/2" x 1 1/2" CARRIAGE BOLT	350362-00
15	2	1" x 2" SQ. HOLE BACKING PLATE	A-000040
16	2	MOUNTING PLATE	A-000769
17	1	DRIVER SIDE BRACE	B-000313
18	1	PASSENGER SIDE BRACE	B-000312
19	1	DRIVER SIDE RECEIVER	C-000426
20	1	PASSENGER SIDE RECEIVER	C-000425
21	1	DRIVER SIDE ARM	C-000428
22	1	PASSENGER SIDE ARM	C-000427

**IMPORTANT:** All brackets **must** be assembled with all the bolts left loose for final adjustment and positioning (before tightening) unless otherwise instructed. All bolts **must** be torqued for proper strength. If more than one bolt is used per fastening point, the diagram may only show one.

- Use flat washers over all slotted holes
- Use lock washers on all fasteners

ROADMASTER Limited Warranty, including One-Year Conditional Warranty Text and Product Registration Card, in Carton.



## WARNING

Failure to follow these instructions can result in property damage, personal injury or even death.

- Installation of most mounting brackets requires moderate mechanical aptitude and skills. We strongly recommend professional installation by an experienced installer.
- The installer must read the instructions and use all bolts and parts supplied. Failure to do so could result in loss of the towed vehicle.
- Use Loctite® Red on all bolts used for mounting this bracket.
- Do not use this document for custom fabrication, as it may not show all parts or structural components. Custom fabrication or an attempt to copy this bracket design could result in loss of the towed vehicle.
- Every 3,000 miles, the owner must inspect the fasteners for proper torque, according to the bolt torque requirements chart on the last page of these instructions. The owner must also inspect all mounts and brackets for cracks or other signs of fatigue every 3,000 miles. Failure to do so could result in loss of the towed vehicle.
- The owner must check the vehicle manufacturer's instructions for the proper procedure(s) to prepare the vehicle for towing. Some vehicles must be equipped with a transmission lube pump, an axle disconnect, driveline disconnect or free-wheeling hubs before they can be towed. Failure to properly equip the vehicle will cause severe damage to the transmission.
- If running changes were made by the vehicle manufacturer after this bracket was designed, some bolts or other fasteners in the hardware pack may no longer be the correct size. It is the installer's responsibility to verify that the bracket is securely fastened to the vehicle and fitted with the correct hardware to account for these changes. Failure to securely

fasten the bracket could result in loss of the towed vehicle.

- If the towed vehicle has been in an accident, it must be properly repaired before attaching the bracket. Do not install the bracket if any structural frame damage is found. Failure to repair the damage could result in the loss of the towed vehicle.
- Some motorhome chassis have such a tight turning radius that you can damage your motorhome, towed vehicle, tow bar or bracket while turning sharply. Before getting on the road, test your turning radius in an empty parking lot. Turning too sharply could result in non-warranty damage to towing system, motorhome and/or towed vehicle.
- Do not back up with the towed vehicle attached or non-warranty damage will occur to your towing system, motorhome and/or towed vehicle.
- The safety cables must connect the towing vehicle to the towed vehicle frame to frame, with the cables crossed, with enough slack for sharp turns. Refer to the cable instructions for proper routing. Failure to leave enough slack in the safety cables, or failure to connect the safety cables frame to frame, will result in the loss of the towed vehicle.
- This bracket is designed for use with ROADMASTER tow bars and ROADMASTER adaptors only. Using this bracket with other brands, without an approved ROADMASTER adaptor, may result in non-warranty damage or injury.
- Upon final installation, the installer must inspect the bracket to ensure adequate clearance, particularly around hoses, air conditioner lines, radiators, etc., or non-warranty damage to the towed vehicle will result.
- This bracket is only warranted for the original installation. Installing a used bracket on another vehicle is not recommended and will void the warranty.



# MOUNTING BRACKET KIT INSTALLATION INSTRUCTIONS

**KIT# 179-2**

09/07/10  
KS

1. **Important:** please use all supplied bolts and parts and read all instructions carefully before beginning this installation. The majority of questions you may have can be answered within the text, and proper installation will ensure safe and secure travel. Now, begin the installation. This bracket kit is one of our XL Series, which is designed so that the front braces can be removed from the receiver braces. The kit consists of the main receiver braces, front braces and a hardware pack. The receiver braces utilizes the front tow hook mounts in the frame and the side of the frame as attachment points on each side. Start by laying out the kit as illustrated. This will give you a visual idea of how the kit installs and also confirm that the kit components are present and accounted for. Start by removing the tow hooks and stock bolts on both sides.
2. Enlarge the existing tow hook mount bolt holes slightly to accommodate the larger  $\frac{1}{2}$ " bolts included in the kit hardware.
3. Working on one side at a time, fit the lower brace plate under the frame and under the side of the skidpan. Line up the holes in the lower brace plate with the reamed holes in the frame.
4. Fit a receiver brace through the air dam and into the front of the frame tube. Line up the two bottom holes in the brace with the enlarged holes in the frame and lower brace plate, then check the large slotted side hole in the frame and see if it lines up with the rear side mounting nut on the receiver brace. If it doesn't line up, the frame hole will have to be enlarged.
5. Bolt through the lower brace plate and two enlarged tow hook mounting holes into the inserted receiver brace with the supplied  $\frac{1}{2}$ " x  $3\frac{1}{2}$ " bolts and lock washers.
6. Pull the fender brace away from the frame slightly, hold the side brace to the side of the frame and bolt through the fender brace and side plate with a 10mm x 1.5 x 40mm bolt, lock washer and flat washer. *Note:* from '98 vehicles on, the fender brace has been eliminated and the mounting procedure for the rear side brace mounting bolt has been changed. Using 1" x 2" backing plates and trimmed head  $\frac{1}{2}$ " x  $1\frac{3}{4}$ " carriage bolts, fishwire through the large slot on the outside of the frame and then through the brace. Finish with flat washers, lock washers, and nuts. Some vehicles may require two additional flat washers as spacers between the frame and plate on the driver's side. Repeat this step on the passenger side.
7. Bolt the bottom of the side brace to the bottom brace plate using  $\frac{1}{2}$ " x  $1\frac{1}{2}$ " bolts, flat washers, lock washers and nuts.
8. Now, bolt through the frame side hole with a  $\frac{1}{2}$ " x 2" bolt,  $\frac{1}{2}$ " plate washers and lock washer. Use one of the plate washers as a spacer between the frame and side brace as a spacer.
9. Repeat steps 3 through 8 for the remaining side.
10. Replace skid pan bolts if present.
11. Insert the front braces into the rear receivers and secure in place using the supplied  $\frac{5}{8}$ " draw pins and  $\frac{1}{8}$ " spring pins.
12. Mount the tow bar according to the manufacturer's instructions.
13. Use the supplied safety cables and cable connectors to connect the receiver brace to the tow bar and tow vehicle's safety cables.