

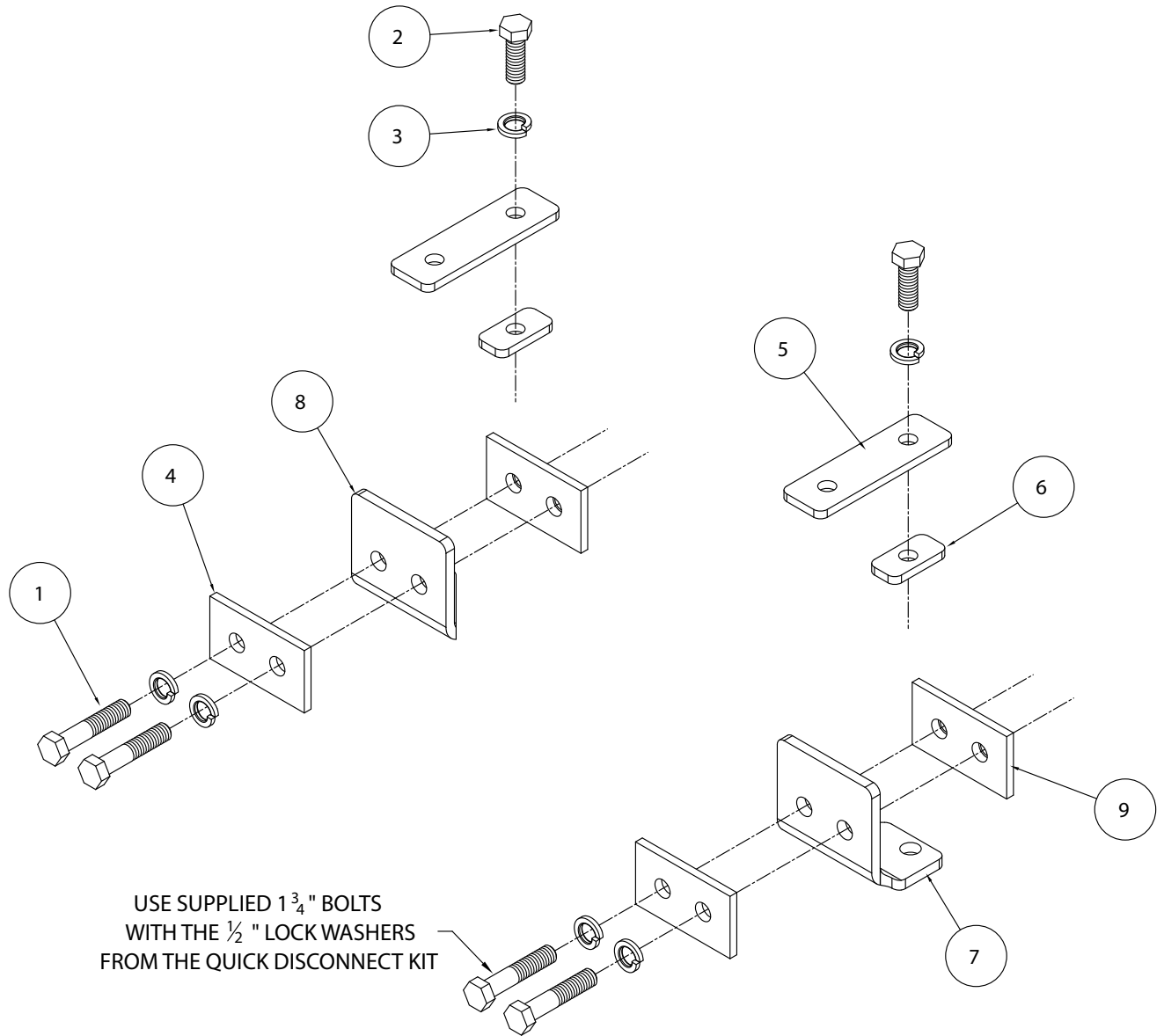

MOUNTING BRACKET KIT INSTALLATION INSTRUCTIONS

KIT# 1409-1

04/16/16



ITEM	QTY	NAME	PART #
1.....	4.....	1/2" x 2 1/2" BOLT.....	350099-00
2.....	2.....	1/2" x 1 1/2" BOLT.....	350095-00
3.....	6.....	1/2" LOCK WASHER.....	350309-00
4.....	2.....	2" x 3 1/2" BACKING PLATE.....	A-000686
5.....	2.....	UPPER BUMPER BRACE.....	A-000841
6.....	2.....	1" x 2" BACKING PLATE.....	A-000842
7.....	1.....	DRIVER SIDE FRONT BRACE.....	B-000333
8.....	1.....	PASSENGER SIDE FRONT BRACE.....	B-000334
9.....	2.....	2" x 3 1/2" THREADED BACKING PLATE.....	C-000467



MOUNTING BRACKET KIT INSTALLATION INSTRUCTIONS

KIT# 1409-1

04/16/16

1. **Important:** please use all supplied bolts and parts and read all instructions carefully before beginning this installation. The majority of questions you may have can be answered within the text, and proper installation will ensure safe and secure travel. Now, begin the installation. This bracket kit is designed as an adaptor to allow mounting a tow bar to the front bumper of a Jeep.



The kit consists of two front braces, two upper braces, two backing plates, two threaded backing plates and hardware kit (Fig. A).

2. Start by laying the kit out as illustrated and making sure all the components are there.
3. Remove the plastic frame cover if present (four 10mm head bolts) (Fig.B).
4. Remove the front channel bumper (four #55 Torx bolts).
5. Put the bumper on a convenient bench or table to work on. Mark or keep track of the bottom of the bumper.

IMPORTANT: All brackets **must** be assembled with all the bolts left loose for final adjustment and positioning (before tightening) unless otherwise instructed. All bolts **must** be torqued for proper strength. If more than one bolt is used per fastening point, the diagram may only show one.

- Use flat washers over all slotted holes
- Use lock washers on all fasteners

ROADMASTER Limited Warranty, including One-Year Conditional Warranty Text and Product Registration Card, in Carton.

WARNING

Failure to follow these instructions can result in property damage, personal injury or even death.

- Installation of most mounting brackets requires moderate mechanical aptitude and skills. We strongly recommend professional installation by an experienced installer.
- The installer must read the instructions and use all bolts and parts supplied. Failure to do so could result in loss of the towed vehicle.
- Use Loctite® Red on all bolts used for mounting this bracket.
- Every 3,000 miles, the owner must inspect the fasteners for proper torque, according to the bolt torque requirements chart on the last page of these instructions. The owner must also inspect all mounts and brackets for cracks or other signs of fatigue every 3,000 miles. Failure to do so could result in loss of the towed vehicle.
- The owner must check the vehicle manufacturer's instructions for the proper procedure(s) to prepare the vehicle for towing. Some vehicles must be equipped with a transmission lube pump, an axle disconnect, driveline disconnect or free-wheeling hubs before they can be towed. Failure to properly equip the vehicle will cause severe damage to the transmission.
- If running changes were made by the vehicle manufacturer after this bracket was designed, some bolts or other fasteners in the hardware pack may no longer be the correct size. It is the installer's responsibility to verify that the bracket is securely fastened to the vehicle and fitted with the correct hardware to account for these changes. Failure to securely fasten the bracket could result in loss of the towed vehicle.
- If the towed vehicle has been in an accident, it must be properly repaired before attaching the bracket. Do not install the bracket if any structural frame damage is found. Failure to repair the damage could result in the loss of the towed vehicle.
- Roadmaster manufactures many styles of brackets. If your bracket has removable arms, they must be removed before driving the vehicle, unless the arms can be pinned or padlocked in place. If not secured, the arms could vibrate out, resulting in non-warranty damage or personal injury.
- Some motorhome chassis have such a tight turning radius that you can damage your motorhome, towed vehicle, tow bar or bracket while turning sharply. Before getting on the road, test your turning radius in an empty parking lot. Turning too sharply could result in non-warranty damage to towing system, motorhome and/or towed vehicle.
- Do not back up with the towed vehicle attached or non-warranty damage will occur to your towing system, motorhome and/or towed vehicle.
- The safety cables must connect the towing vehicle to the towed vehicle frame to frame, with the cables crossed, with enough slack for sharp turns. Refer to the cable instructions for proper routing. Failure to leave enough slack in the safety cables, or failure to connect the safety cables frame to frame, will result in the loss of the towed vehicle.
- This bracket is designed for use with ROADMASTER tow bars and ROADMASTER adaptors only. Using this bracket with other brands, without an approved ROADMASTER adaptor, may result in non-warranty damage or injury.
- Do not use this document for custom fabrication, as it may not show all parts or structural components. Custom fabrication or an attempt to copy this bracket design could result in loss of the towed vehicle.
- Upon final installation, the installer must inspect the bracket to ensure adequate clearance, particularly around hoses, air conditioner lines, radiators, etc., or non-warranty damage to the towed vehicle will result.
- This bracket is only warranted for the original installation. Installing a used bracket on another vehicle is not recommended and will void the warranty.



MOUNTING BRACKET KIT INSTALLATION INSTRUCTIONS

KIT# 1409-1

04/16/16

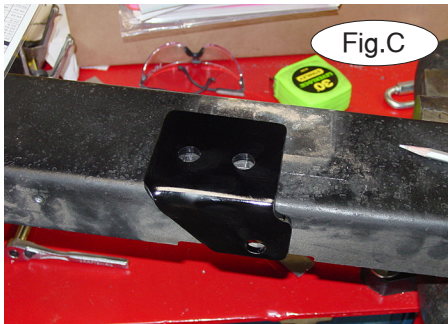

Fig.C

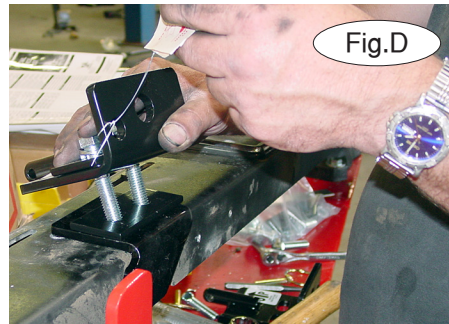

Fig.D

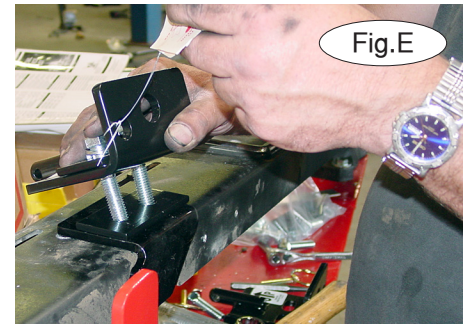

Fig.E

6. Bolt or clamp the front braces to the front and bottom of the bumper over the lower bumper mounting holes. Measure from the hole centers in the front of the braces and adjust if necessary to measure 27" and 30" center to center. Try to center the bottom holes in the braces over the lower mounting holes (Fig.C).

7. Once aligned and clamped, use these braces as drill templates to drill through the front of the bumper with a 17/32" drill bit (Fig.D).

8. Install the Quick Disconnect base plates or the bar adapter on the front of the bumper using either the bolts supplied with the Quick Disconnects or if needed the supplied 1/2" x 2 1/2" bolts. Be sure to use the supplied backing plates between the bumper and the quick-disconnects (Fig.E). If an older bar or base plate adaptor is used, the backing plates may be left out.

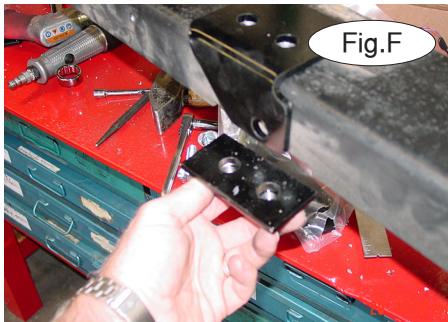

Fig.F



Fig.G

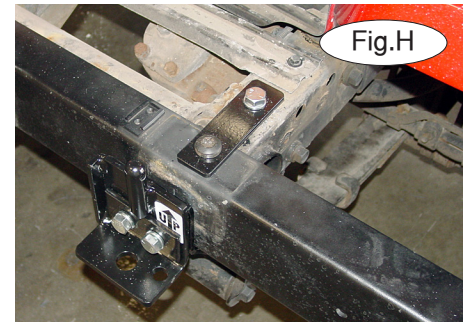

Fig.H

9. Tighten the front assembly bolts on the bumper using the threaded backing plates (Fig.F), then reinstall the bumper on the vehicle using the stock #55 Torx bolts in the bottom mounting holes (Fig.G).

10. Bolt through the upper bumper strap braces on each side with the remaining #55 Torx screws (Fig.H), then bolt through the rear of the strap braces with 1/2" x 1 1/2" bolts, lock washers, and 1/4" spacers under the strap brace (Fig.H).

11. If a quick-disconnect style bar or base is to be mounted, mount the bar or base to align the front quick-disconnect plates, then torque all mounting bolts to the specifications found at the end of this document.

12. Hold the plastic frame cover over the top of the frame and braces and mark where the rear bolt heads protrude. Cut small holes in the cover to allow clearance for the bolt heads then reinstall, reversing step 3 (Fig.I, J).

13. Install the tow bar according to the manufacturer's instructions.



MOUNTING BRACKET KIT INSTALLATION INSTRUCTIONS

KIT# 1409-1

04/16/16

12. Hold the plastic frame cover over the top of the frame and braces and mark where the rear bolt heads protrude. Cut small holes in the cover to allow clearance for the bolt heads then reinstall, reversing step 3 (Fig.I, J).

13. Install the tow bar according to the manufacturer's instructions.

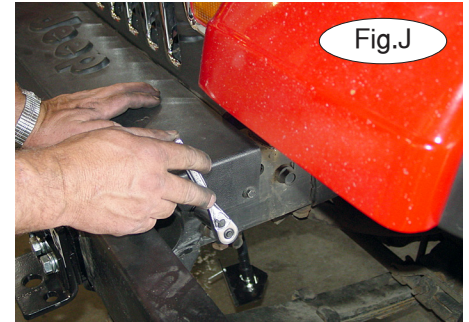
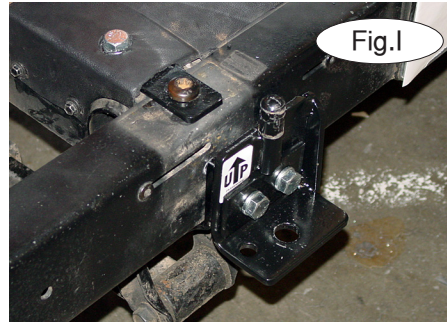

BOLT TORQUE REQUIREMENTS

Note: The torque values represented below are intended as general guidelines. Torque requirements for specific applications may vary. Roadmaster does not warrant this information to be accurate for all applications and disclaims all liability for any claims or damages which may result from its use.

STANDARD BOLTS

Thread Size	Grade	Torque
5/16.....	5.....	13 ft./lb.
3/8.....	5.....	23 ft./lb.
7/16.....	5.....	37 ft./lb.
1/2.....	5.....	56 ft./lb.
5/8.....	5.....	150 ft./lb.

METRIC BOLTS

Thread Size	Grade	Plated / Unplated
8mm-1.0	8.8	20 ft./lb. 18 ft./lb.
8mm-1.25	8.8	19 ft./lb. 18 ft./lb.
10mm-1.25	8.8	38 ft./lb. 36 ft./lb.
10mm-1.5	8.8	37 ft./lb. 35 ft./lb.

METRIC BOLTS

Thread Size	Grade	Plated / Unplated
12mm-1.25	8.8	70 ft./lb. 65 ft./lb.
12mm-1.5	8.8	66 ft./lb. 61 ft./lb.
12mm-1.75	8.8	65 ft./lb. 60 ft./lb.
14mm-2.0	8.8	104 ft./lb. 97 ft./lb.