

Fits most

2"

receiver
hitches

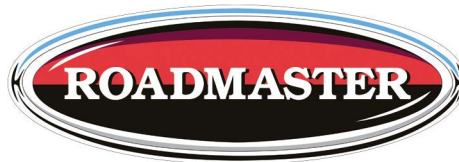

Towing and Suspension Solutions

Quiet Hitch™ stops sway and wander before it begins by eliminating any free play between the receiver and the tow bar (or bike rack, ball mount or whatever you insert) for a solid, seamless connection. Reduces tire wear, as well as wear and tear on the hitch and receiver. Especially effective on towing combinations with multiple hitch extensions; also reduces rattle caused by bike racks or hitch accessories.

- Works on most 2-inch receivers • Bolts on in seconds

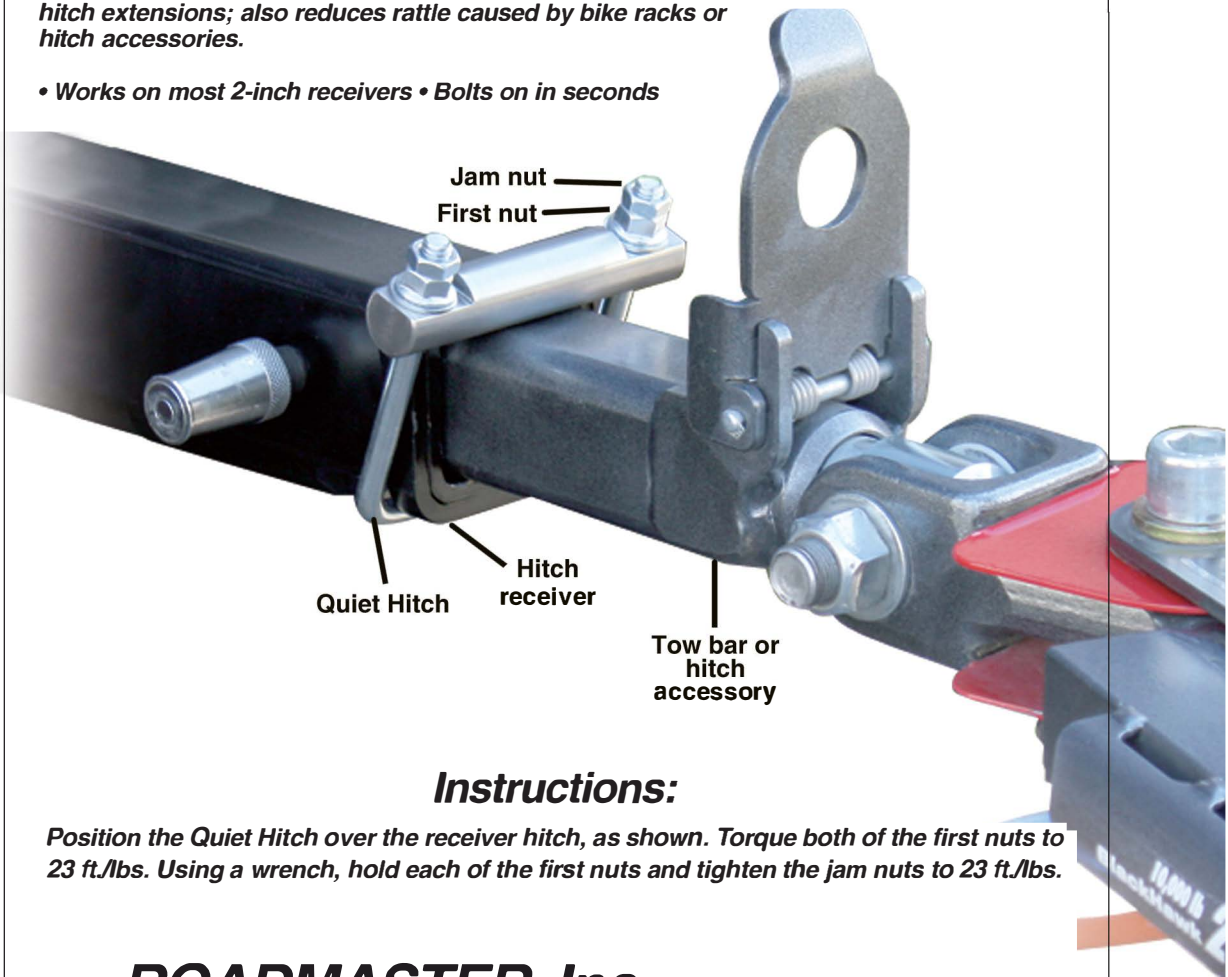

Instructions:

Position the Quiet Hitch over the receiver hitch, as shown. Torque both of the first nuts to 23 ft./lbs. Using a wrench, hold each of the first nuts and tighten the jam nuts to 23 ft./lbs.

ROADMASTER, Inc.