

INSTALL INSTRUCTIONS

Jeep JK Front Bumpers (ALL)

Product : 509R0B, 509R4B, 512R0B, 512R4B

Application : 2007+ Jeep Wrangler JK

(2 Door and 4 Door)

⚠ WARNING

Read the instructions completely before beginning installation. Before tightening bolts, drilling or cutting where required, check to make sure there are no obstructions such as brake, fuel or electrical lines which may be damaged. Also keep in mind this is an after-market product and MAY require minor shimming and/or trimming, reaming, etc. for proper fit. Road Armor is not responsible for any damages to vehicle.

ⓘ IMPORTANT NOTICE

- Be sure to inspect and test fit your product to ensure proper fitment before having it coated, painted, bed lined, etc.
- Road Armor will not be responsible for the cost of coating your unit if any problems with fit or finish are not

SAFETY FIRST!

- FOLLOW ALL INSTRUCTIONS, YOUR SAFETY AND THE SAFETY OF OTHERS IS MOST IMPORTANT.
- WEAR APPROPRIATE EYE PROTECTION AND EXERCISE CAUTION WHEN DRILLING / CUTTING

REQUIRED TOOLS

Metric and SAE Socket Sets and Wrenches

Needle Nose Pliers

5/16 Hex Bit Socket or Allen Wrench

Phillips Screwdriver

Small Pry Bar or Large Flathead Screwdriver

9/16 Drill Bit or Step Bit

INCLUDED HARDWARE

(8) 1/2-in x 1.5-in Stainless Button Head Bolts

(8) 1/2-in Grade 8 Nuts

(8) 1/2-in Grade 8 Lock Washers

(16) 1/2-in Small Grade 8 Washers

(8) 1.25-in Plastic Plugs

(1) Logo Bolt Kit

(1) Stain Steel Road Armor Logo Letters

LIGHTS (not included)

Stubby : 1x 10-in LED Light Bar

Stealth : 1x 20-in Light Bar and 4x Dually LED's

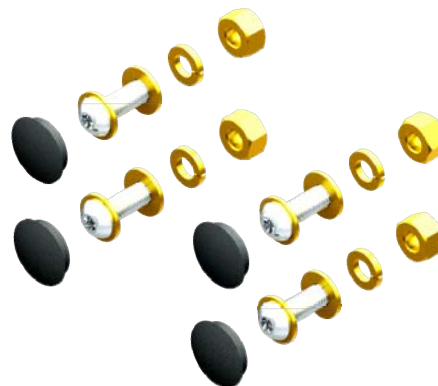

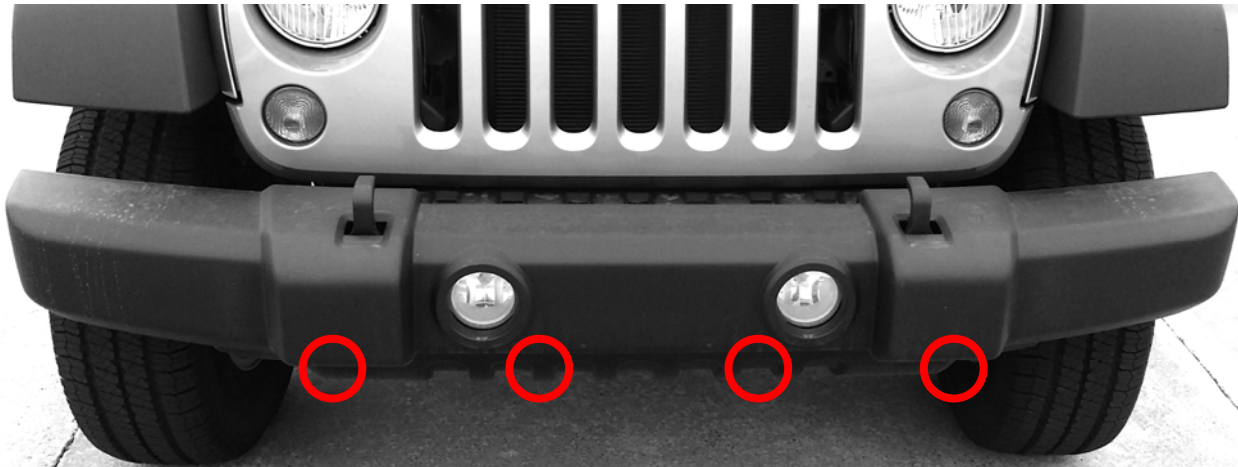

1 Unscrew the four (4) plastic screws in the center of the retainer clips securing the factory air dam to the bottom of the bumper using a phillips screw driver.

TIP If the screws just spin use a flathead screwdriver or small pry bar to pop them out.



2 There two (2) more of these plastic screw type retainers on the backside of the front cross member which must be removed in the same fashion.

3 If your JK is equipped with factory fog lights unplug them.

4 Using a pair of needle nose pliers, pry off all the clips holding the fog light harness loom to bumper.

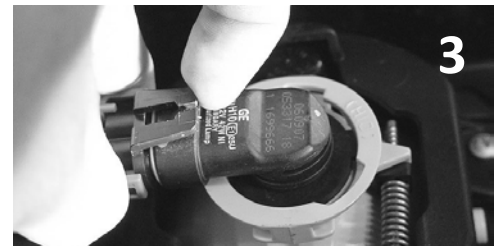

5 Remove the nuts holding the factory bumper on, four (4) on each side using an 18mm socket and socket wrench. Keep the backing plate for installing Road Armor Bumper.

6 Pull off factory bumper and set aside. It is not heavy, about 25lbs.

7 Now remove the plastic top plate using a phillips screwdriver as in Steps 1 and 2. Again if the screw simply spins, employ a flathead screwdriver or small pry bar as shown.

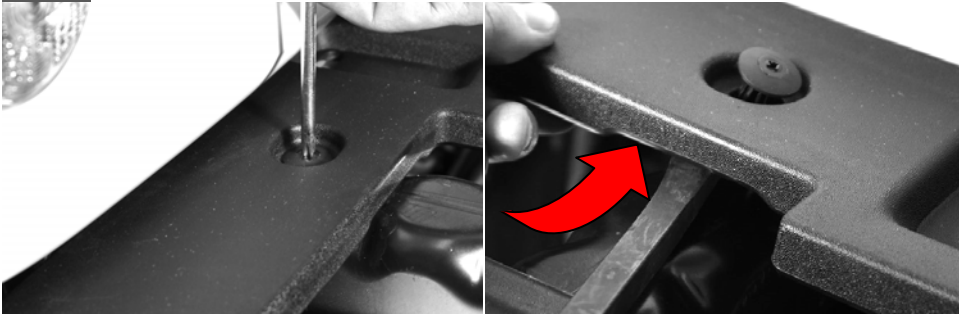

8 Gather a drill, a 9/16-in drill bit or a Step Bit for the next Step.



9 Drill out the two outermost top holes on the frame as circled below to 9/16-in.

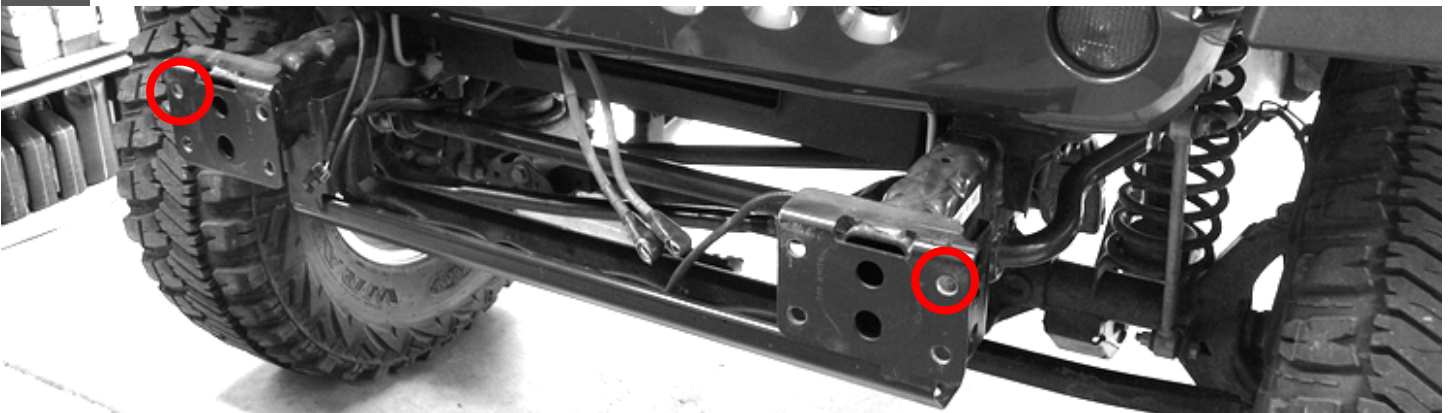

10 Install Road Armor Logo using the Stainless #10 Button Head Bolts and Keps Nuts.

11 Install lights now if you have them. Not required, but is a bit easier with bumper off.



12 Rest the Road Armor bumper on top of the frame, and lift driver side up a little to line up holes and insert one bolt with washer through bumper and frame. Then put the factory spacer which you were instructed to set aside in Step 5, followed by a washer, lock washer and nut on the backside finger tight. Repeat for passenger side, then put all the rest of the bolts in the same way.

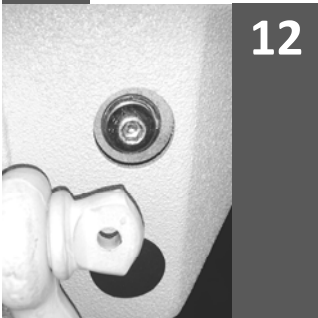

13 Once all the bolts are in, crank them down. It is best to hold the bolt head still and tighten the nut.

14 Insert all the plastic plugs to cover the bolt holes.

15 If you have a winch to mount, do that now. Bolt fairlead onto included winch plate, then bolt the winch to the top of the bumper with the included Fairlead mount in between. If the bolts are too short buy longer ones. Finished!

