



**Part # 11220701**  
**64-72 GM "A" Body Master Series SA Rear [Shock Kit](#)**

**Components:**

2	24179999	7" stroke Master Series SA shock
2	90001684	1.7" tall Master Series eyelet
4	90001994	.625" bearing
8	90001995	Snap ring for bearing
2	90002010	Extended T-bar – Installed in shock body
4	90001980	Snap ring for T-bar
4	90002067	Aluminum bearing spacer - .625" I.D.
2	90002329	Round head cantilever pin
2	90000471	Aluminum spacer

**Hardware:**

4	99371004	3/8" x 1 1/4" USS bolt	Shock to frame
8	99373003	3/8" SAE flat washer	Shock to frame
4	99372002	3/8" USS Nylok nut	Shock to frame

## Installation Instructions



1. Attach the upper T-bar to the frame in the oem location using the supplied 3/8" x 1 1/4" USS bolts, washers and Nylok nuts.

2. The bottom of the shock attaches with the new cantilever pin supplied. See diagram below.

**Note:** The hole in the axle bracket may need to be drilled out to 5/8"



1. Cantilever pin
2. Aluminum bearing spacer
3. .625" bearing
4. Aluminum shock spacer
5. Factory axle bracket
6. 1/2" lock washer
7. 1/2" SAE nut

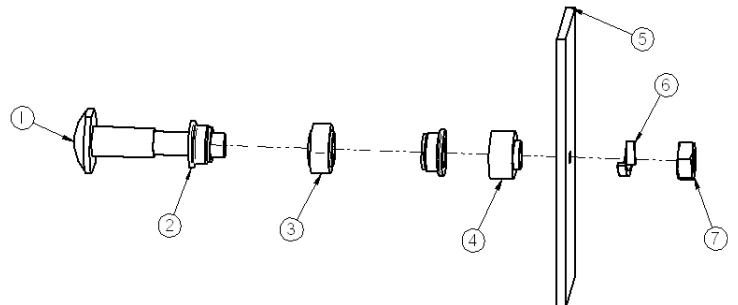

## Rebound Adjuster

The rebound adjustment is made on the shaft end of the shock.

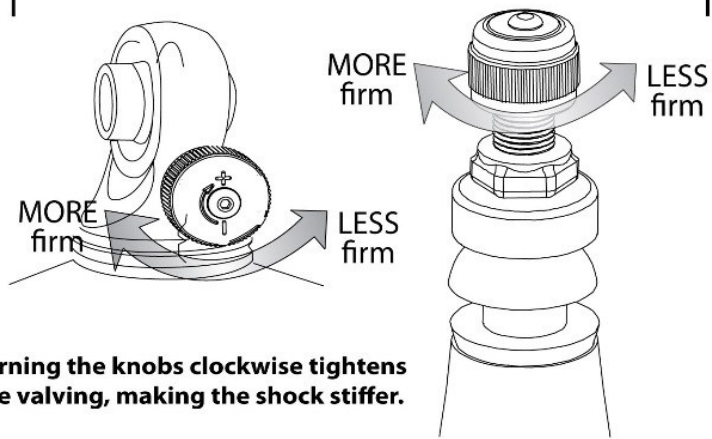

**Turning the knobs clockwise tightens the valving, making the shock stiffer.**

Rebound is the force required to open or "expand" the shock absorber back to its original position.

Adjusters knobs on a ring mount have 30 clicks of adjustment. On a stud top mount there are 20 clicks of adjustment.

Because of the fine adjustment range RideTech recommends adjusting 3-4 clicks minimum when making a shock valve change.

**All RideTech Shocks are shipped from the factory at the FULL SOFT position.**