



Part # 12060298
64-69 Lincoln Air Suspension
System

Front Components:

1	12060999	CoolRide Kit
1	12060601	Single Adjustable Shocks w/ Bolt on shock brackets
1	12061499	Lower StrongArms

Rear Components:

1	12075401	Single Adjustable Rear Shockwaves w/ Lowering Block Kit
---	----------	---



Part # 12060999
61-69 Lincoln Front
CoolRide
For Use w/ Lower StrongArms

Components:

2	90006873	224c Air spring
2	90000694	Upper air spring mount
2	90000683	Upper mounting plate
2	90000682	Upper mounting plate spacer
1	90000684	Driver side brake line tab
1	90000685	Passenger side brake line tab

Hardware:

4	99371006	3/8" x 1 1/2" USS bolt	Upper plate
2	99371005	3/8" x 1 1/4" USS bolt	Upper plate
12	99373003	3/8" SAE flat washer	Upper plate & air spring
8	99373005	3/8" lock washer	Upper plate & air spring
4	99372004	3/8" USS nut	Upper plate
2	99435002	7/16" x 8" stud	Upper air spring mount (Cut off to 6 3/4" long)
2	99433002	7/16" SAE flat washer	Upper air spring mount
2	99432001	7/16" USS Nylok nut	Upper air spring mount
4	99372002	3/8" USS Nylok nut	Air spring to upper mount
2	99371001	3/8" x 3/4" USS bolt	Air spring to lower arm

DO NOT USED PETROLEUM BASED GREASE ON THE POLY BUSHINGS

STRONG ARMS™

by Air Ride Technologies

Installation Instructions for ARF10900-LCA

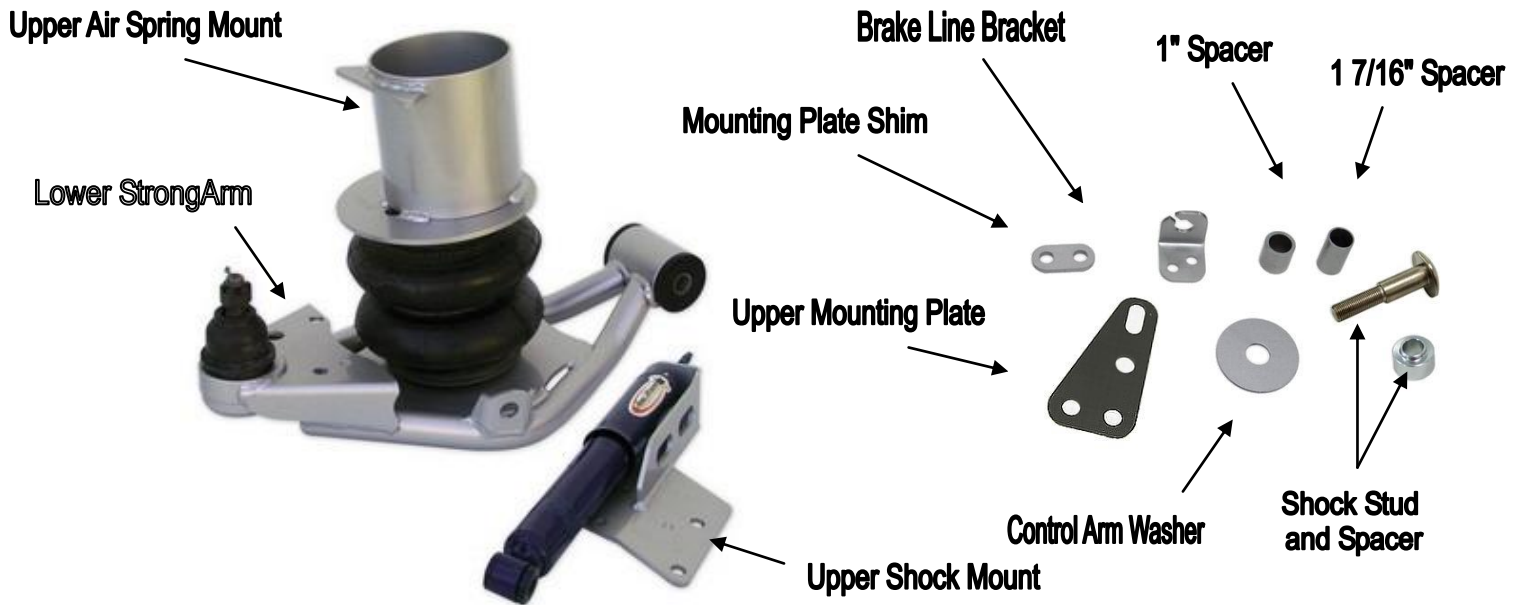

1. Raise the vehicle to a safe and comfortable working height. Support the vehicle by the frame so that the suspension can hang freely.
2. Remove the coil spring, lower control arm and shock absorber. Refer to factory service manual for disassembly procedures.
3. The inner fender well shield next to the upper control arm and the factory brake line frame bracket must also be removed.



4. Remove the factory upper shock mount. The front of it is held in with two rivets that must be ground down and pushed out. In its place install the upper air spring mounting plate & shim. The shim will go under the front side of the plate and is secured with two 3/8" x 1 1/2" bolts, flat washers, nuts and lock washers. The rear side of the plate will be secured with one 3/8" x 1 1/4" bolt flat washer and lock washer.

5. Apply thread sealant to a straight air line fitting and screw it into the top of the air spring. Fasten the air spring to the upper mount using two 3/8" Nylok nuts and flat washers.



6. Thread the 7/16" x 6 3/4" stud into the nut in the bottom of the bracket.
7. Raise the assembly into the coil spring pocket with the stud protruding through the upper plate. The wings on the side of the bracket will rest against the flat side of the coil spring retainer.
8. Secure the assembly with a 7/16" Nylok nut and flat washer. **Note:** The air line must also be routed at this time.



9. Bolt the lower StongArm to the frame using the 3/4" x 8" bolt and the two spacers supplied. Install the 1" spacer to the front side of the bushing and the 1 7/16" spacer to the rear. A large washer will go between the bushing and the spacers.
10. Attach the lower arm to the spindle and strut rod. Two 1/2" x 1 1/2" bolts and lock washers are supplied for the strut rod.
11. Fasten the air spring to the lower arm using a 3/8" x 3/4" bolt, flat washer and lock washer.



12. Raise the lower arm with a jack. Mark the frame where the lower shock tab contacts it. This must be cut out to allow clearance. Grind all edges smooth when finished.
13. Install the new brake line bracket with using the factory bolts and clip.
14. Check air spring clearance through full suspension travel. **Allowing the air spring to rub will result in failure and is not a warrantable situation.**
15. Ride height on this air spring is approximately 5" tall, but will vary to driver preference.



Part # 12061499
61-69 Lincoln Lower
StrongArms
For Use w/ CoolRide

Components:

1	90000690	Driver side arm
1	90000691	Passenger side arm
2	90000923	Ball joint
4	90001084	Poly bushing half
2	90000687	Inner bushing sleeve
4	90000686	Lower control arm washer
2	90000688	Control arm spacer (Front 1")
2	90000689	Control arm spacer (Rear 1 7/16")
2	90001092	Tube of Lithium grease

Hardware:

2	99751001	3/4"-16 x 8" bolt	Lower StrongArm to frame
2	99752001	3/4"-16 Nylok nut	Lower StrongArm to frame
4	99501002	1/2"-13 X 1 1/2" bolt	Strut rod to lower arm
4	99502001	1/2"-13 Nylok nut	Strut rod to lower arm
4	99503002	1/2" lock washer	Strut rod to lower arm

STRONG ARMS™

by Air Ride Technologies

Item #	Description	Qty.
1.	Driver side arm	1
2.	Poly bushing half	2
3.	Inner bushing sleeve	1
4.	Large washer	2
5.	Control arm spacer (Front 1")	1
6.	Control arm spacer (Rear 1 7/16")	1
7.	Ball joint	1
8.	Aluminum bearing spacer	4
9.	3/4"-16 x 8" bolt	1
10.	1/2"-13 Nylok nut	2
11.	1/2" lock washer	2
12.	1/2"-13 X 1 1/2" bolt	2

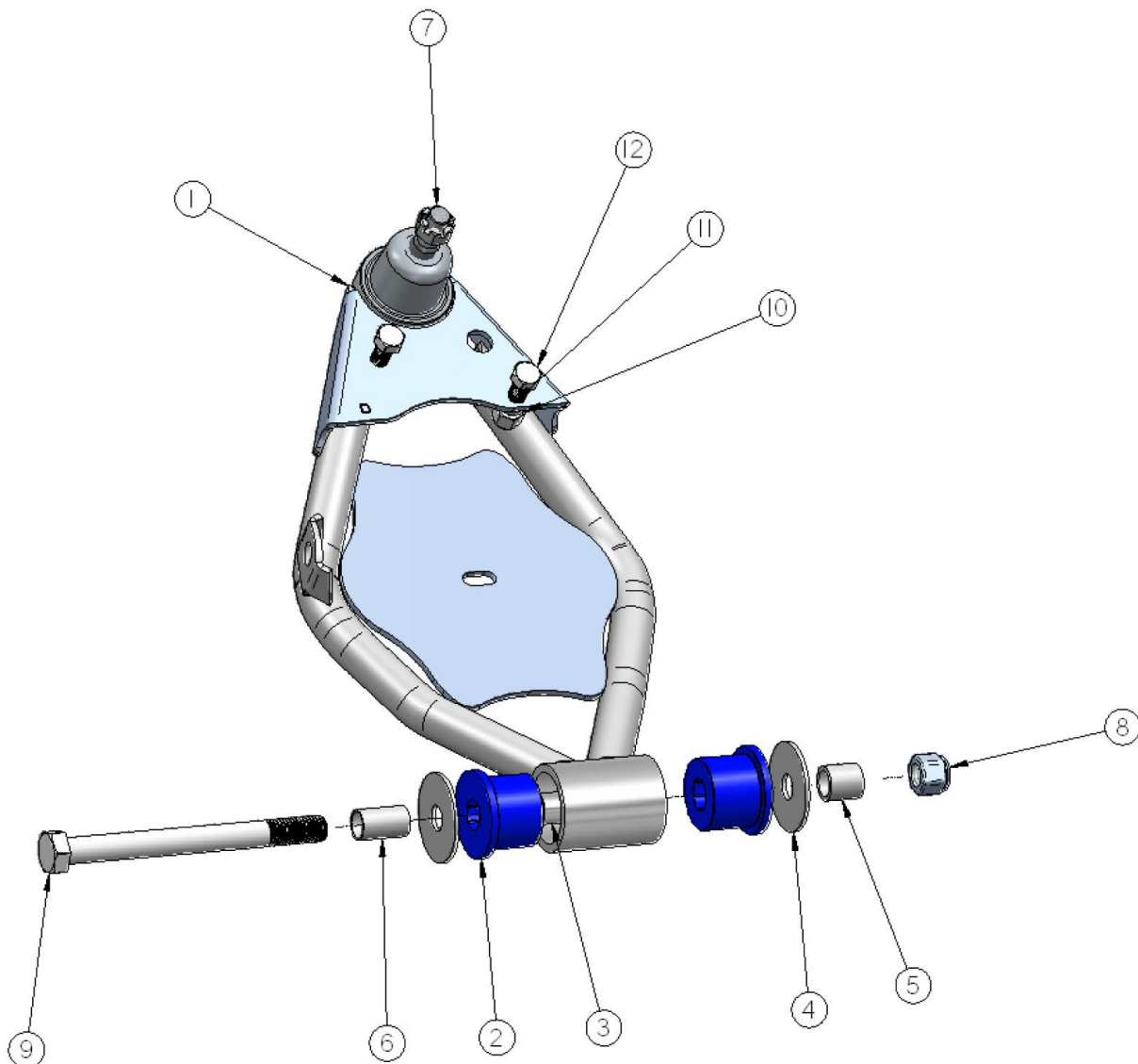



Part # 12060601
61-69 Lincoln Front HQ Series Shock Kit
For Use w/ CoolRide and Lower
StrongArms

Shock:

2	22849999	HQ Smooth Body Shock Cartridge
2	70011138	3/4" ID Shock Bushing
2	90002103	5/8" ID Inner Sleeve

Components:

4	70011140	Stem Bushings
4	70011141	Stem Washers
2	90000471	Aluminum shock spacer
2	90001619	Shock stud
1	90000692	Driver side upper shock mount
1	90000693	Passenger side upper shock mount

Hardware:

8	99373007	3/8" x 1" self-tapping bolt	Upper shock mount
4	99372006	3/8" - 24 Thin Jam Nut	Upper Shock Stud

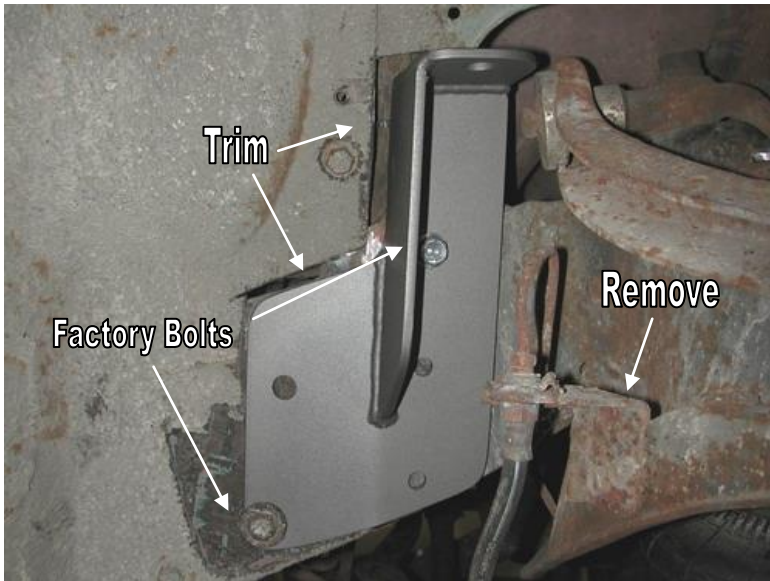

1. Bolt the upper shock mount to the subframe using four 3/8" x 1" self tapping bolts. The bracket will locate off of the factory bolt shown in the picture. Drill the holes with a 5/16" bit.

2. The inner fender well must be trimmed to allow clearance for the shock mount. **Be careful not to cut anything inside engine bay.**

3. Remove the factory brake line bracket.
This picture is of the passenger side.



4. Bolt the top of the shock to the upper mount using the bushings and hardware supplied.

5. Install the round head shock bolt through the lower shock eye. Then install the aluminum spacer with the step facing the arm. Slide the bolt through the arm and fasten with the nut supplied.

This picture is of the driver side.



6. Install the new brake line bracket with using the factory bolts and clip.



Part # 12075401
64-69 Lincoln Rear Shockwave Kit – Master Single Adjustable

Rear Shockwaves (Includes the following)

2	24169999	6" stroke Master Series single adjustable shock
2	24090799	7000 Master Series rolling sleeve assembly
2	90002025	2.7" eyelet
2	90001994	.625" I.D. bearing
4	90001995	Bearing snap ring
4	70009554	Poly bushing kit (Installed in shock body)
2	90000699	(A930) 3/4" x 11/16" bushing sleeve
4	90002043	.500" ID spacer for bearing
2	70008913	Locking Ring
2	90000700	(A931) Upper mounting plate
2	90000701	(A932) Lower U-bolt plate
4	99626001	5/8" x 9 1/2" U-bolts w/ Nuts
2	90000702	(A933) Aluminum lowering block
2	90000697	(A928) 1 1/2" x 11/16" aluminum washer
2	90000698	(A929) 1 1/2" x 1/2" aluminum washer

Hardware kit:

2	99501010	1/2" x 2 1/4" SAE Gr 8 bolt	Upper eyelet to stud adapter
2	99502003	1/2" SAE Nylok nut	Upper eyelet to stud adapter
2	99502002	1/2" SAE Nylok nut	Lower stud
2	99371020	3/8" x 2" SAE Allen bolt	Leaf springs
2	99372005	3/8" SAE Nylok nut	Leaf springs

WARNING: ATTEMPTING TO REMOVE THE AIR FITTING WILL DAMAGE IT AND VOID THE WARRANTY.

Installation Instructions

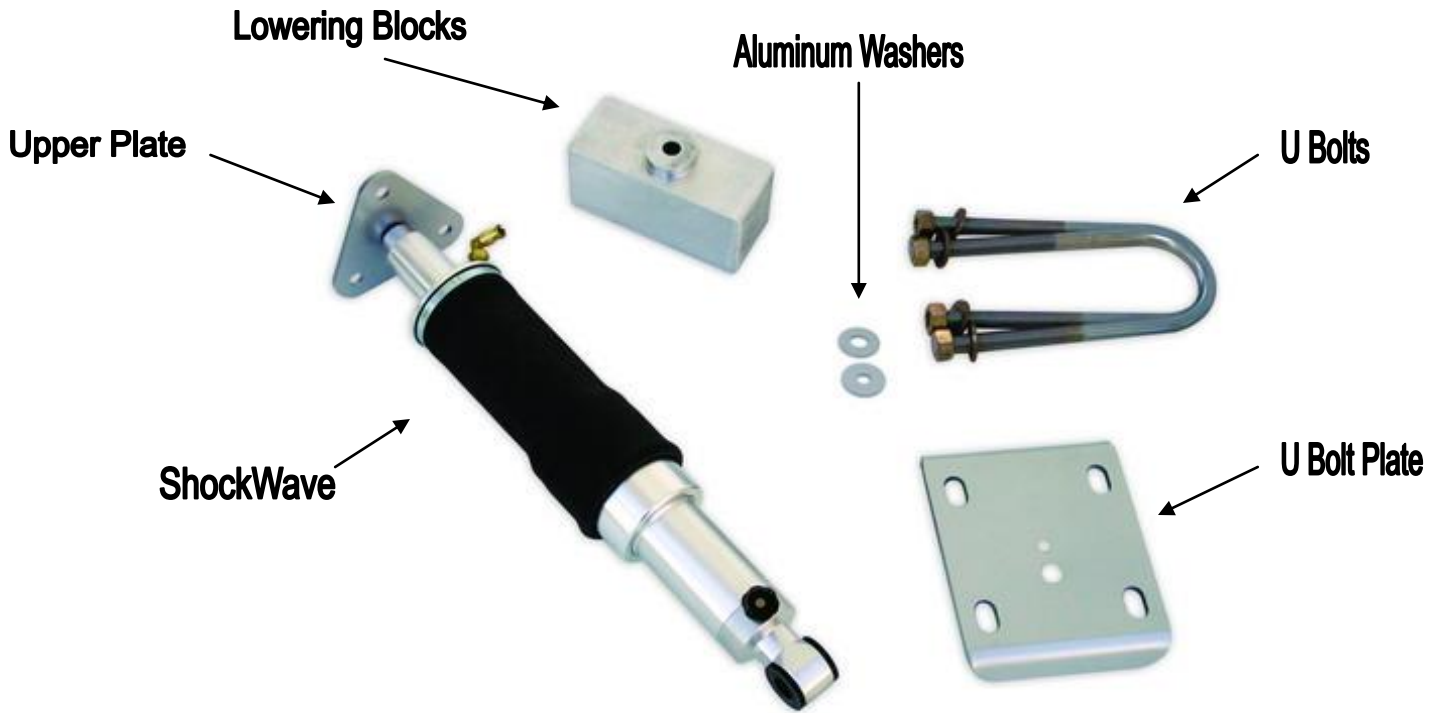

1. Raise the vehicle to a safe and comfortable working height with the suspension hanging free.
2. Remove the factory shock absorbers and upper mounts.



3. To get maximum drop, the two lower leaf springs must be removed from the pack. Raise the U-bolts clamping the axle to the leaf spring pack. Raise the axle out of the way with a floor jack. Secure it with two jack stands.

4. Using two C clamps secure the top 4 springs. Then remove the bolt in the center of the leaf spring and the straps at either end of the pack. Remove the lower two leaves.



5. Secure the pack with a 3/8" x 2" Allen bolt and Nylok nut. The bolt needs to be dropped in from the top of the pack. Reinstall the straps then remove the clamps.

6. Place the Aluminum lowering block on top of the leaf springs. The Allen head will locate the block. Lower the axle down on top of the block; the step on top of the block will slide into the hole in the bottom of the leaf spring pad on the axle.

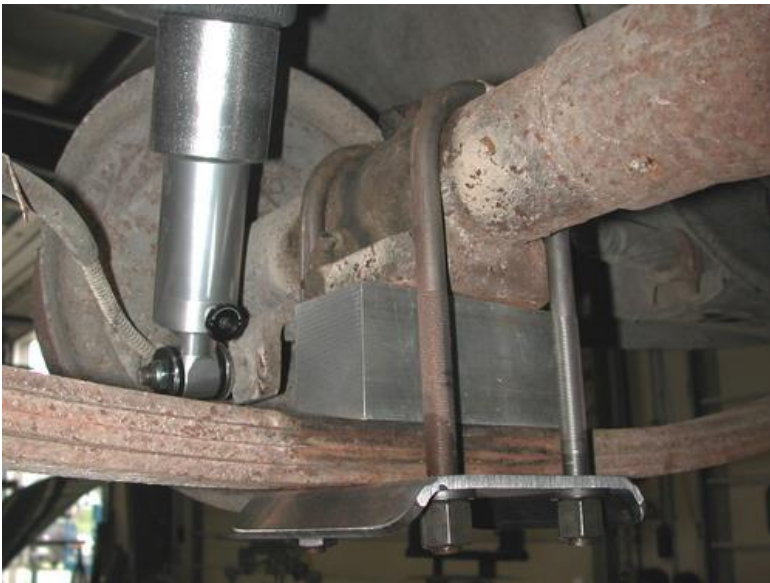

7. Hang the U-bolts over the axle. Position the U-bolt plate under the leaf springs so that the larger hole in the plate aligns with the Allen bolt and nut. Secure the assembly with the four 5/8" nuts and lock washers supplied.

Note: The plate and lowering block will offset the axle to the rear of the vehicle. This will keep the driveshaft from bottoming out and center the tire in the wheel well.



8. The ShockWave must be bolted to the car with the upper mounting bolt running front to rear.



10. Bolt the plate to the factory shock mount holes using the factory bolts.

11. Bolt the Shockwave to the eye to stud adapter using the $\frac{1}{2}$ " x $2\frac{1}{4}$ " bolt and Nylok nut. A .190" thick steel spacer must be installed on either side.

Note: You may need to position the air fitting for clearance. This can be done by holding the bottom of the Shockwave and twisting the bellow.



11. Place the $\frac{1}{8}$ " thick steel washer with the $\frac{11}{16}$ " inside diameter over the factory lower shock stud on the axle. Then slide the Shockwave over the stud.



12. Secure the Shockwave to the stud using the $\frac{1}{8}$ " thick $\frac{1}{2}$ " inside diameter washer and $\frac{1}{2}$ " Nylok nut.

13. Check air spring clearance through full suspension travel. **Allowing the Shockwave to rub will cause failure and is not a warrantable situation.**

14. Ride height on this Shockwave is 17.75". This is determined by measuring from the center eye on the bottom up to the upper plate. 4-5 clicks on the valve adjustment will be a good starting point. These settings may vary to driver preference.