

RHINO-RACK

Rhino Spare Wheel Bike Carrier (RBC025)

Important:

Please read these instructions carefully prior to installation.
Please refer to your fitting instruction to ensure that the roof racks are installed in the correct locations.
Check the contents of kit before commencing fitment and report any discrepancies.
Place these instructions in the vehicle's glove box after installation is complete.

Layout

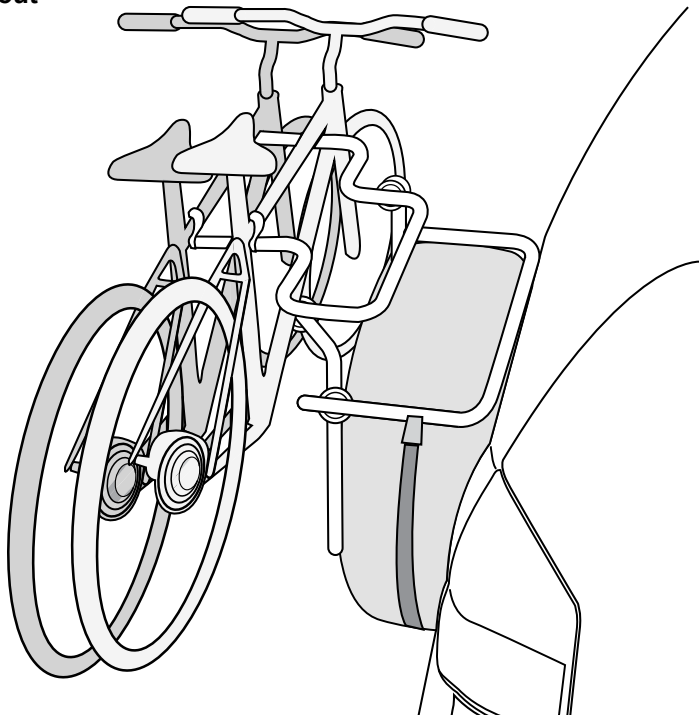

Not suitable for caravan or trailer spare wheels. Must be fitted to the rear of the vehicle only.

Important Information

Maximum carrying capacity: 30kg Total (15kg per bike).

Recommendations:

It is essential that all bolt connections be checked after driving a short distance when you first install your bike rack. Bolt connections should be checked again at regular intervals (probably once a week is enough, depending on road conditions, usage, loads and distances travelled).

Bike Carrier is not suitable for Tandem bikes or E-Bikes.

Sensitivity to cross winds, behaviour in curves and braking.

The handling characteristics of the vehicle, changes when you transport a load. For safety reasons, we recommend you exercise extreme care when transporting wind-resisting loads; special consideration must be taken into account when braking.

Please remove bike rack when putting vehicle through an automatic car wash.

Warning:

Must always use safety strap. Regularly check fitment and strap tension.

Load Ratings:

Maximum permissible load is 2 bikes (15kg per bike). Bike Carrier is NOT recommended for off-road use.



Rhino Spare Wheel Bike Carrier (RBC025)

Parts List

Item	Component	Qty	Part No.
1	Rhino Spare Wheel Bike Carrier	1	RBC025
2	Retaining Strap	1	-
3	Retaining Strap (Buckle)	1	-
4	Velcro Straps	3	-
5	Instructions	1	R039

Tools Required:
Tape Measure.

Carry up to 2 bicycles ONLY
Load capacity up to 30kg ONLY

1 1: Remove wheel cover. 2: Measure the spare wheel width (X).

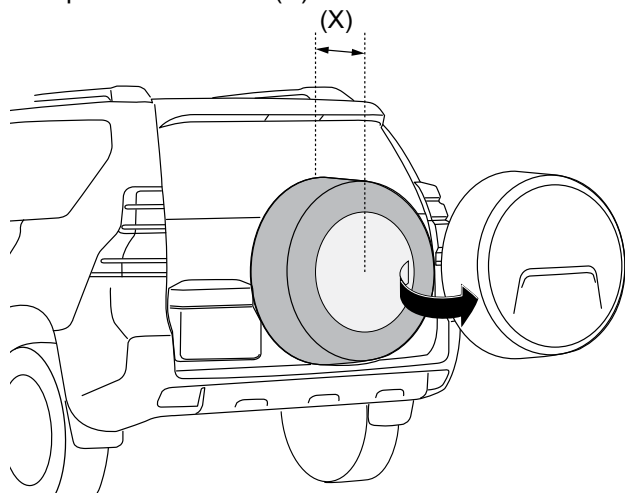

2 Loosen the Carrier Arms by turning the Locking Knobs as shown. Lift the Arms to a **90 degree angle** and tighten in place. Do not over tighten as adjustments may be needed later.

Side View:

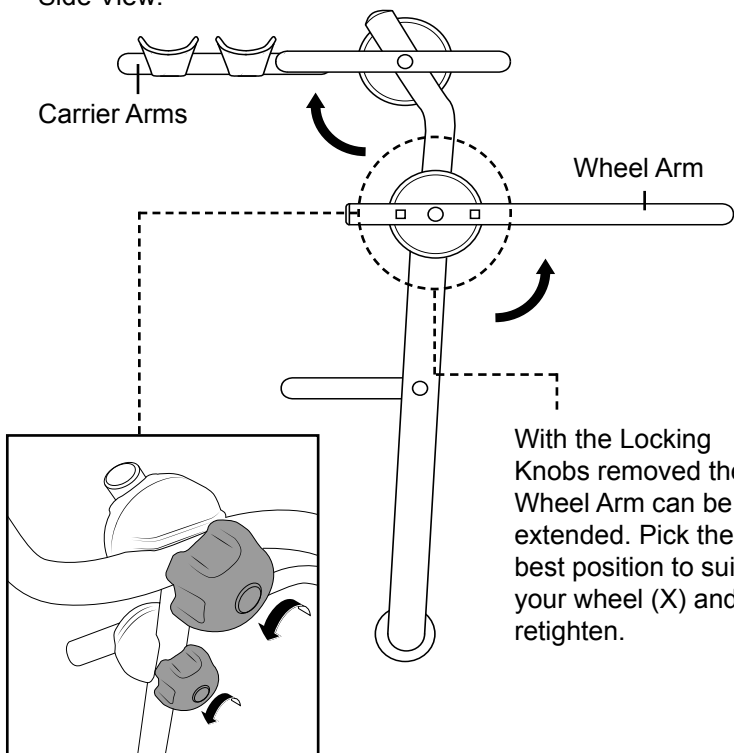

3 Place the Carrier onto the Spare Wheel of the Vehicle. Make any adjustments needed. Tighten locking Knobs.

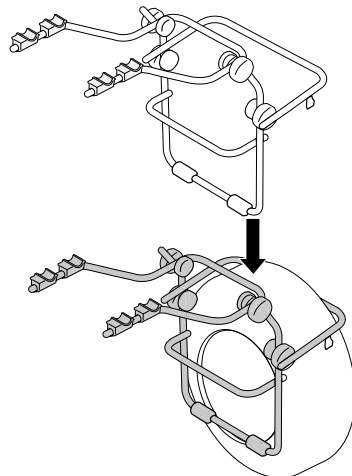

4 Secure the Bike Carrier in place. Use the Retaining Strap to secure the Carrier around the tire as shown.

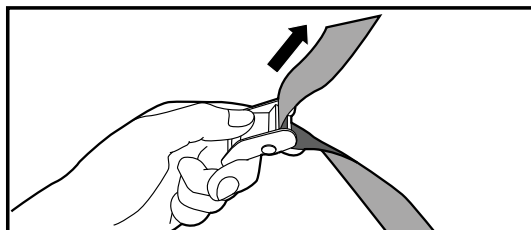
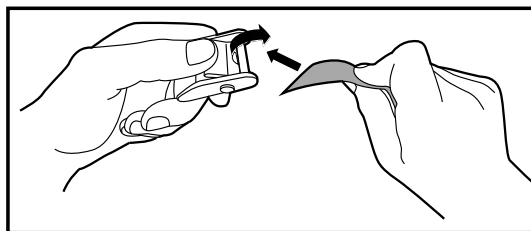
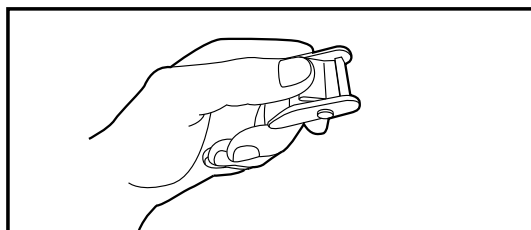
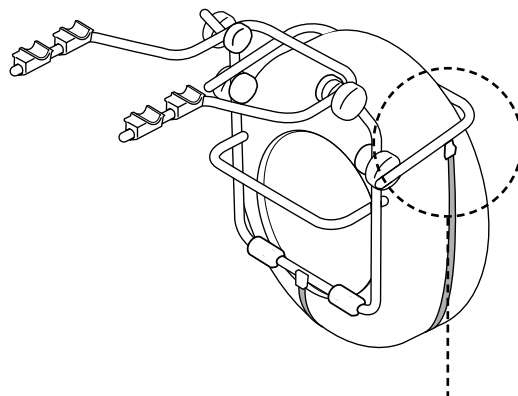



Rhino Spare Wheel Bike Carrier (RBC025)

- 5**
- 1: Loop the Buckle Retaining Strap through itself on the Wheel Arm.
 - 2: Secure the Strap on the front of the Carrier.

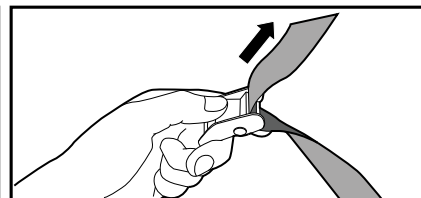
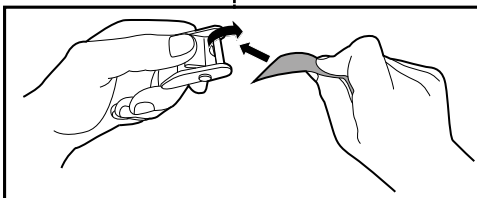
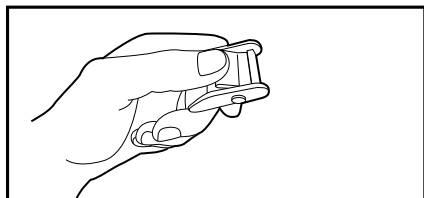
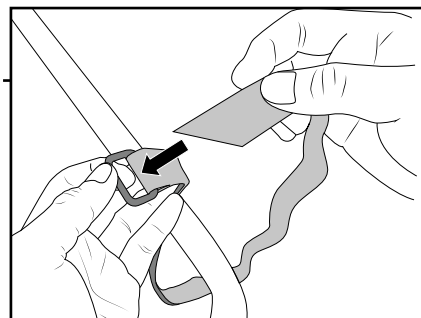
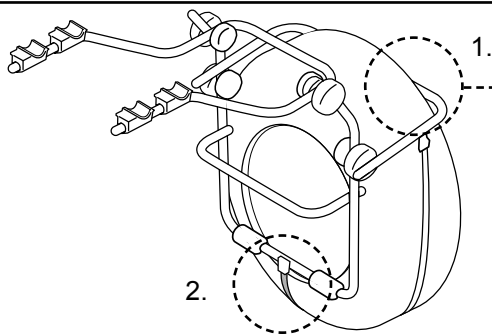

- 6**
- Two bikes can be fitted to the Carrier. The bike in the rear cradles should face the opposing direction to the front bike on the Carrier.

With the bike in place, use the Rubber Straps on the Carrier Arms to secure.

1.

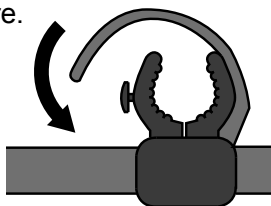

2.

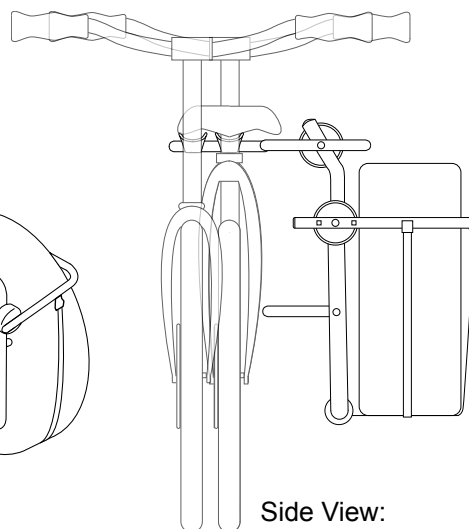
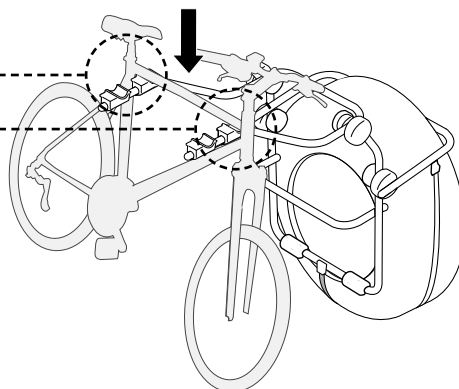
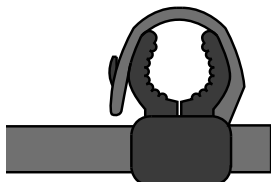

Side View:

- 7**
- 1: Use the Velcro Straps to secure the bikes front wheel to the frames. This will minimise movement during travel.

- 2: It is recommended to fix the bikes in place using a safety strap as shown (RTD35P/C sold as separate). Wrap the strap through both wheels of the bike and down to a tow point on the vehicle (tow ball or hitch point). This will stop the bikes swinging back against the vehicle.

Note: Check all fixtures are secure before use.

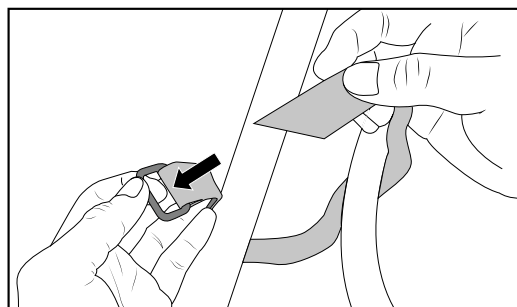

(RTD35P/C)

