



**CONTROLLED**

# RHINO-RACK

## Toyota Tundra Track System RTS533 Crew Max/ RTS534 Double Cab

**Important:** Please read these instructions carefully prior to installation. Please refer to your fitting instruction to ensure that the Canopy Rack System is installed in the correct location. Check the contents of kit before commencing fitment and report any discrepancies. Place these instructions in the vehicle's glove box after installation is complete.

### Layout

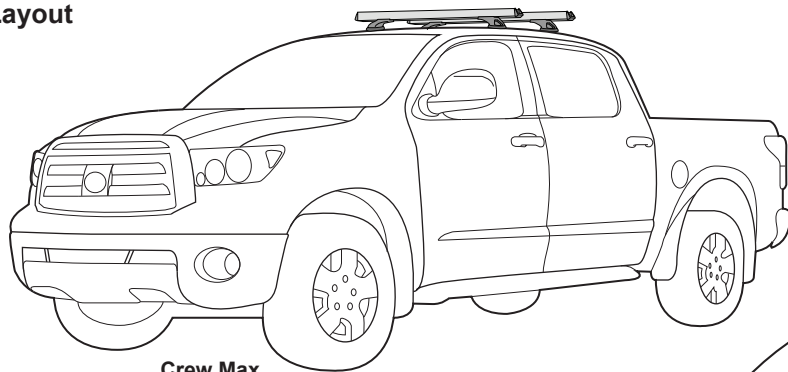

Crew Max

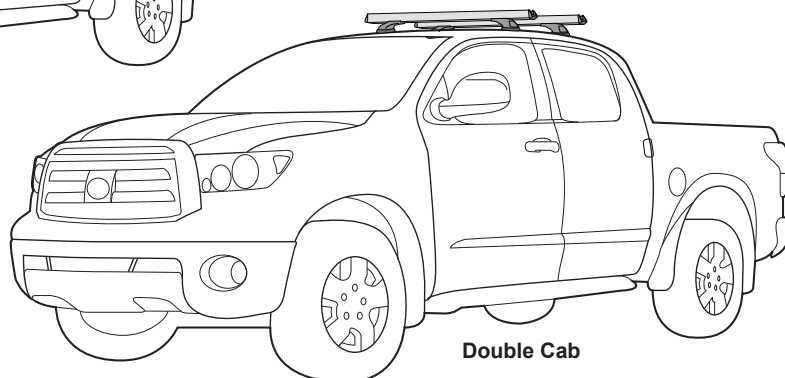

Double Cab

**Maximum load carrying capacity: 100kg / 220lbs**

### Important Information

1.  Check Part No./Kit is correct
2.  Read through instruction before installing
3.  Fit roof rack accessory
4.  Check and recheck all fasteners are secure

**Maximum carrying capacity:** 100kg (220lbs) including the weight of the rack system 5kg (11lbs).

Please refer to your vehicle manufacturers handbook for maximum carrying capacity. Always use the lower of the two figures. Load must be evenly distributed over the entire basket.

**Warning:** Do not attempt to fit the track rack system to your vehicle unless you fully understand these fitting instructions. Please direct any questions regarding fitting to the dealer from where the roof racks were purchased.

**Use only non-stretch fastening ropes or straps.**

**Recommendations:** It is essential that all bolt connections be checked after driving a short distance when you first install your roof racks. Bolt connections should be checked again at regular intervals (once a week is enough, depending on road conditions, usage, loads and distances travelled). You should also check the roof racks each time they are re-fitted. Always make sure to fasten your load securely. Please also ensure that all loads are evenly distributed and that the centre of gravity is kept as low as possible and must be entirely contained within the extents of the roof racks.

**Rack System must be removed when putting vehicle through an automatic car wash.**

**Caution:** The handling characteristics of the vehicle changes when you transport a load on the roof. For safety reasons we recommend you exercise extreme care when transporting wind-resistant loads. Special consideration must be taken into account when cornering and braking.

#### Off-road use:

The track Rack System may be used in off road applications, however a safety factor of 1.5 is enforced. That is, maximum permissible off road load is **67kg (148lbs)**. Although the crossbars are tested and approved to AS1235-2000/ 15011154, off-road conditions can be much more rigorous. Increasing the number of crossbars does not increase the vehicles maximum permissible roof loading.

#### Note for Dealers and Fitters:

It is your responsibility to ensure these fitting instructions are given to the end user or client.

Rhino-Rack 3 Pike Street, Rydalmere,

NSW 2116, Australia.

(Ph) (02) 9638 4744

(Fax) (02) 9638 4822

Document No: R400

Prepared By: Kayle Everett

Authorised By: Chris Murty

Fitment time: 45min

Issue No: 01

Issue Date: 01/06/2015

These instructions remain the property of Rhino-Rack Australia Pty. Ltd. and may not be used or changed for any other purpose than intended.



# Toyota Tundra Track System RTS533 Crew Max/ RTS534

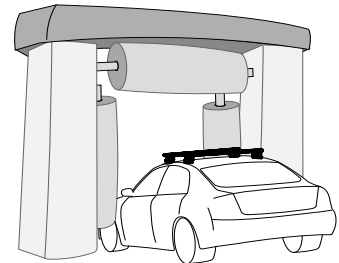
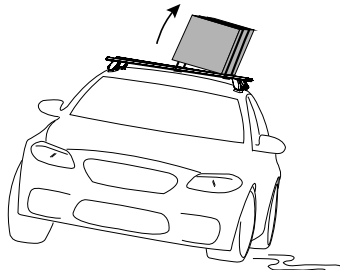
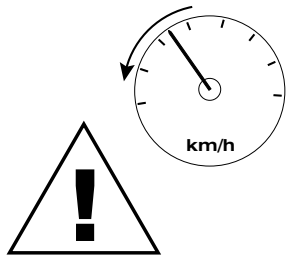
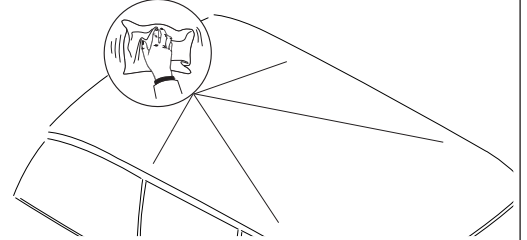
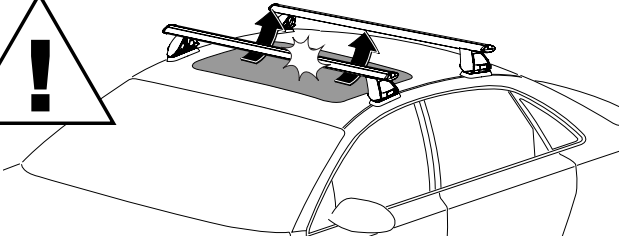
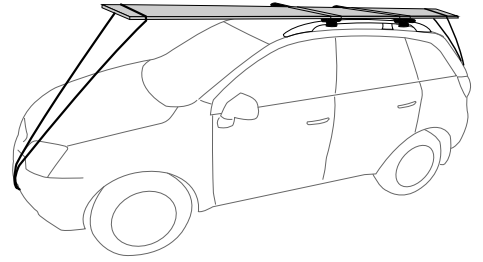
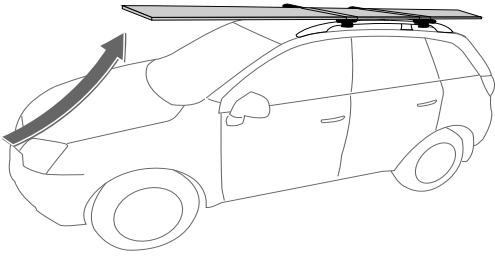

**NOT Recommended**

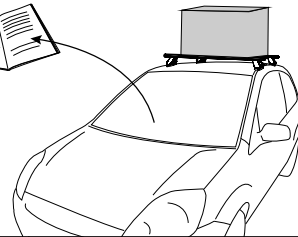
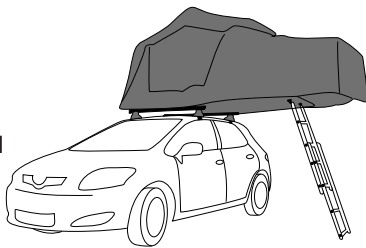

? kg

When these roof racks are to be used on a vehicle that is driven off sealed roads, the maximum roof rack load rating should be **divided by 1.5**. Do not forget to subtract 5kg from your maximum carrying capacity due to the weight of the crossbars and legs.

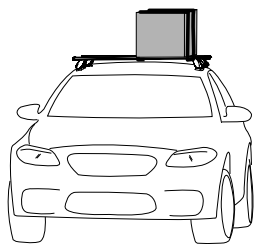

**100kg load rating** = **67kg load rating**  
(Urban road) = (Off road - 100kg / 1.5)

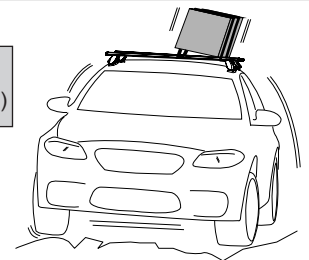

## WARNING! Important Load Carrying Instructions

With utility vehicles, the cabin and the canopy move independently. Roof racks and vehicle can be damaged if the item transported is rigidly fixed at points on both the cabin and canopy. Instead, rigidly fix to either the cabin roof racks or the canopy roof racks.

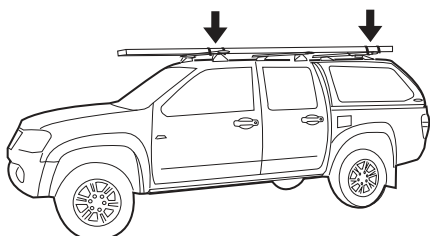

**X NO**

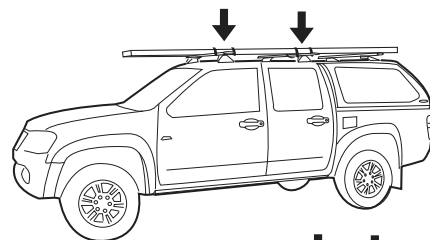

**✓ YES**

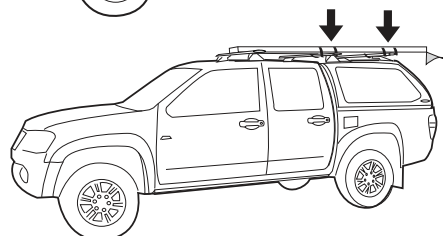

**✓ YES**



# Toyota Tundra Track System RTS533 Crew Max/ RTS534

## Parts List

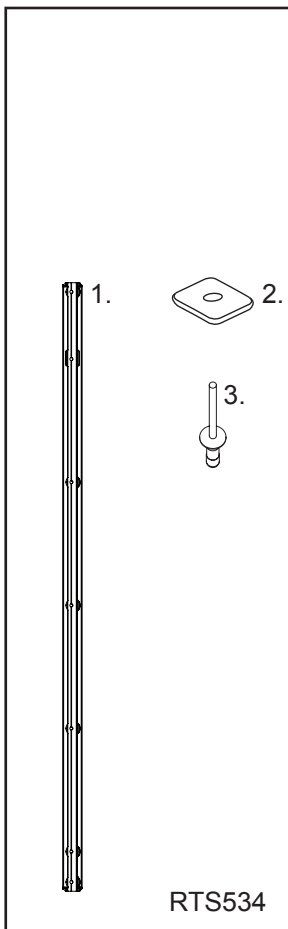
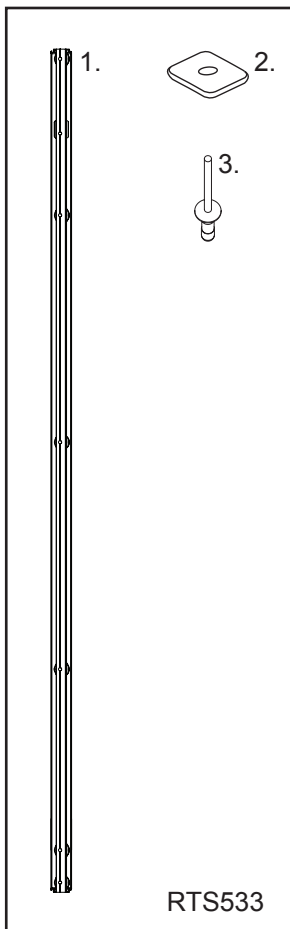

Item	RTS533 Crew Max Kit	Qty	Part No.
1	Tundra Crew Max Track 1300mm	2	A628
2	Butyl Patch 20x20	15	CA1397
3	Rivet	15	H008
4	Instructions	1	R400
Item	RLT534 Double Cab Kit	Qty	Part No.
1	Tundra Double Cab Track 996mm	2	A693
2	Butyl Patch 20x20	15	CA1397
3	Rivet	15	H008
4	Instructions	1	R400

Required kits:  
 RLT600 (sold as separate).  
 VA150 (Sold as separate). (1500mm/ 59")

### Tools Required:

1. Socket Wrench
2. Cold Galvanising Paint
3. Drill
4. 5mm Drill Stop

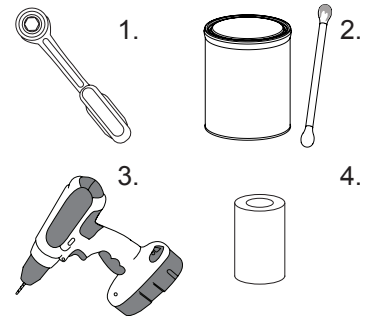

## Instructions

**Note:** For the purposes of this instruction, all images illustrate installation onto the Tundra Crew Max. Double Cab models will follow the same procedure and measurements.

**1** Remove the rubber covering the roof ditch.

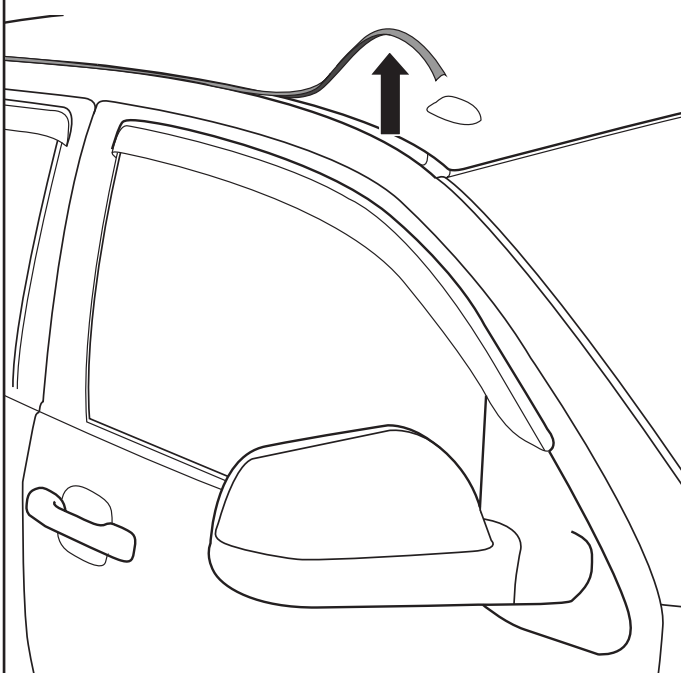

**2** Place track into roof ditch.

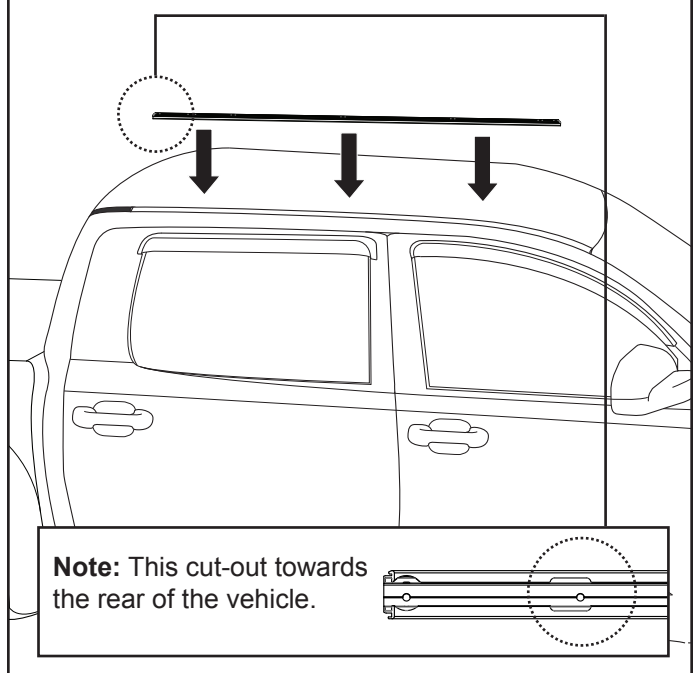



## Toyota Tundra Track System RTS533 Crew Max/ RTS534

- 3** Align the tracks 3mm (1/8") from the fixed rubber at the REAR of the roof ditch.

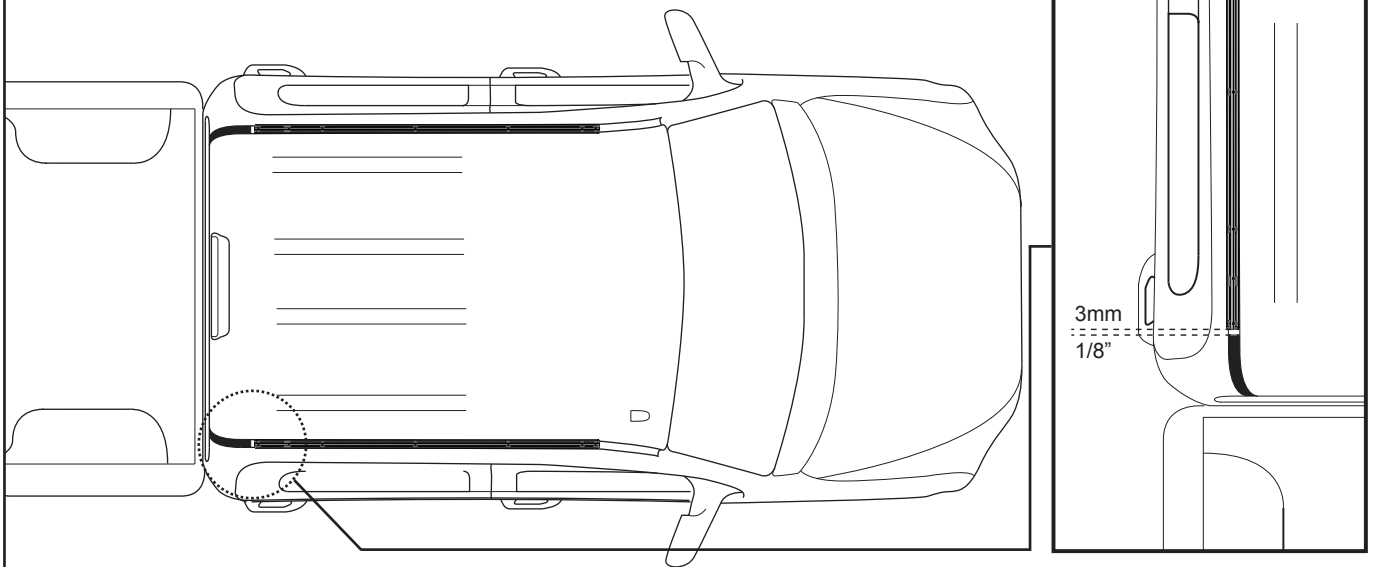

Note: RTS533 pictured. RTS534 uses a shorter track. Installation will follow the same process.

### Top View:

- 4** With the track in place, spot mark all rivet hole in the track mount. There are seven in total. Note: A628 tack shown.

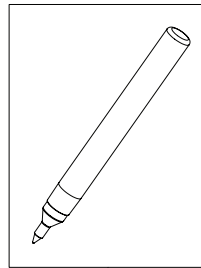

- 5** Using a 5mm/ 3/16" Drill Bit, drill out all 7 rivet holes. Make sure the drill bit passes through the roof skin but does not pierce the roof lining below. **Note:** The second rivet hole from the front sits above the vehicles side airbags. **A 5mm drill stop must be used to ensure this is not damaged during drilling.**

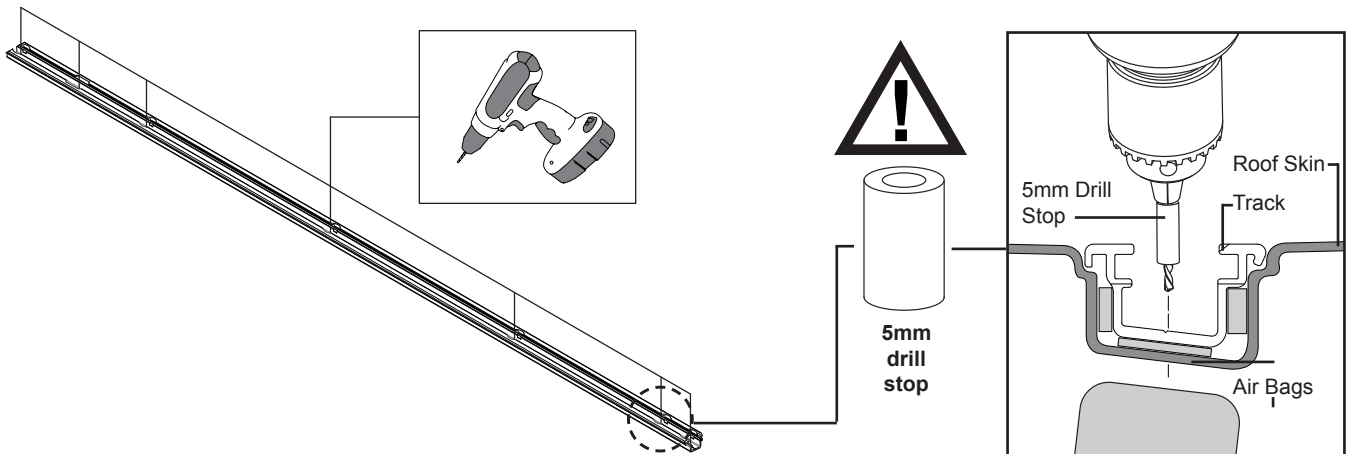



## Toyota Tundra Track System RTS533 Crew Max/ RTS534

- 6** Use cold galvanising paint on all drilled holes. Use a cotton bud or paint brush. Allow to dry.

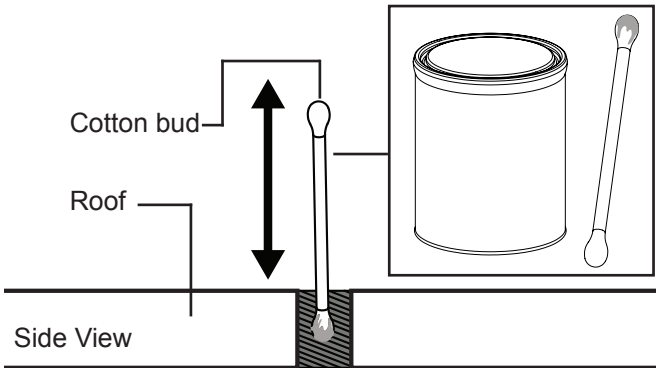

- 7** 1: Remove the backing tape from the Butyl Patches. 2: Place over holes drilled. Once in place remove the rest of the protective tape from the top of the patches.

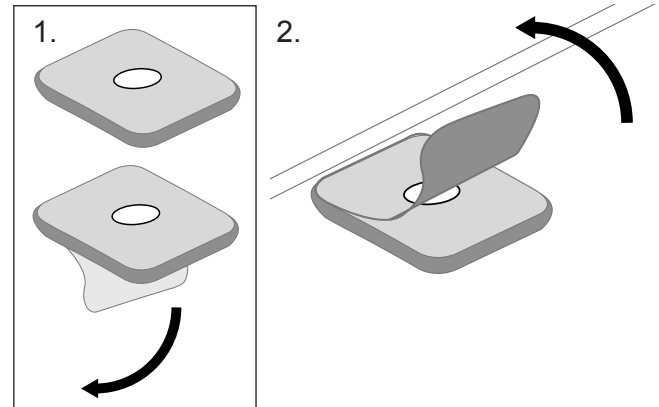

- 8** Remove the tape from the backing strips on the track. Holding the track in place and using a riveting gun, fix the track to the roof as shown. Note: The small hand riveting guns are not recommended as they do not apply enough clamping pressure on this type of rivet.

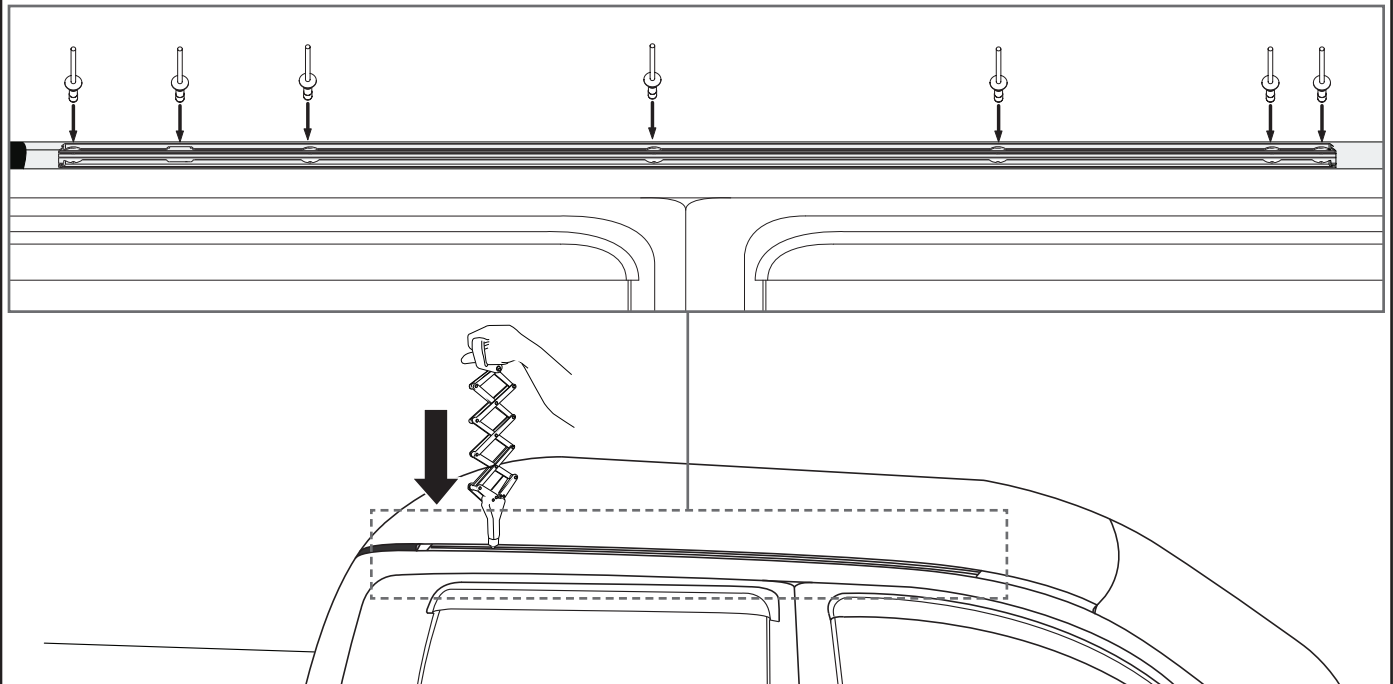

- 9** Measure the distance (x) along the roof ditch from the windshield to the front of the track.

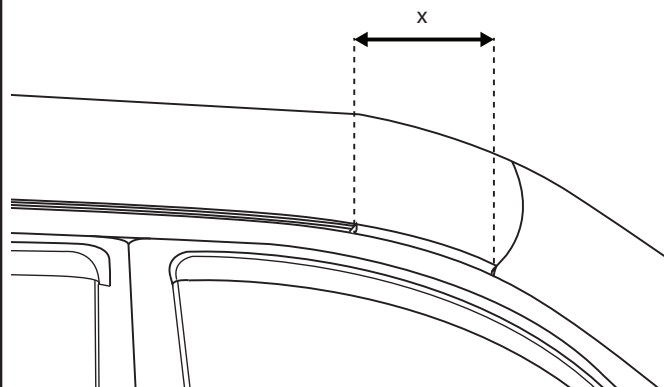

- 10** Using the measurement obtained in the last step (x). Cut the ditch rubber to size and replace back onto the vehicle. It will slip under the end tabs as shown.

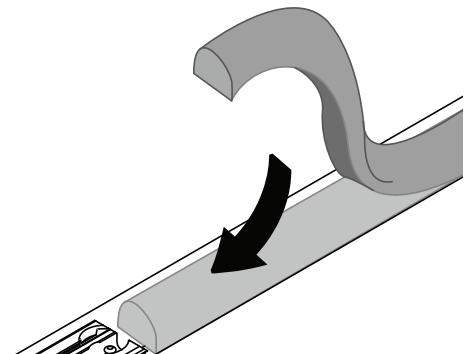

**Now: Follow instructions for fitting legs and bars to tracks.**