



# RHINO-RACK

## QMHD05

Item	Component Name	Qty	Part No.
1	M6 Channel Nut	2	N002
2	Quick Mount Leg HD Bar Spacer	2	M709
3	M6x30 Socket HD Cap Screw	2	B047
4	Instructions	1	R569

**\*Note:**

RLT600 Parts as separate.  
Fix the Quick Mount Spacer to the Leg using the hardware in the leg kit. The bolts found in the spacer kit will replace the original in the leg kit.

**Tools Required:**  
5mm Allen Key

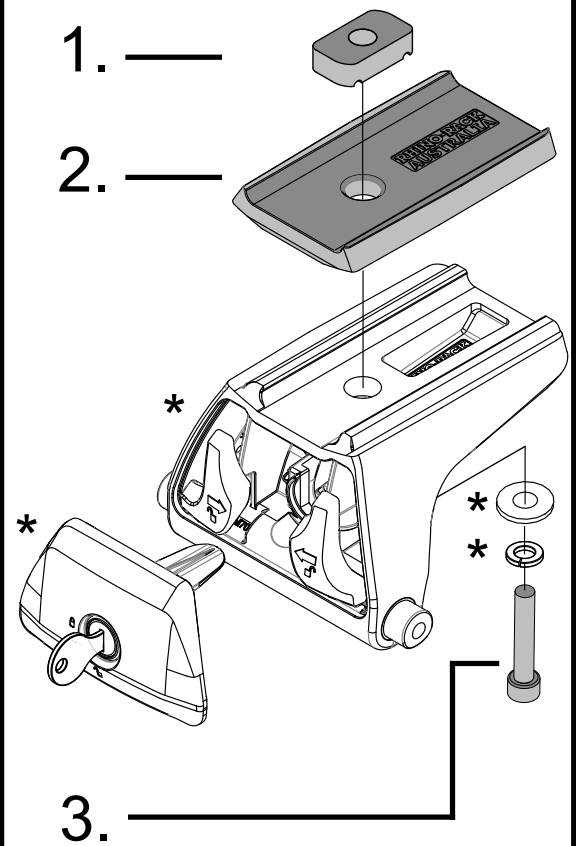

Note: Max Spacer height  
30mm



# RHINO-RACK

## Jeep JK 2dr Backbone - RJKB2

Fit Time: 1.5 Hours

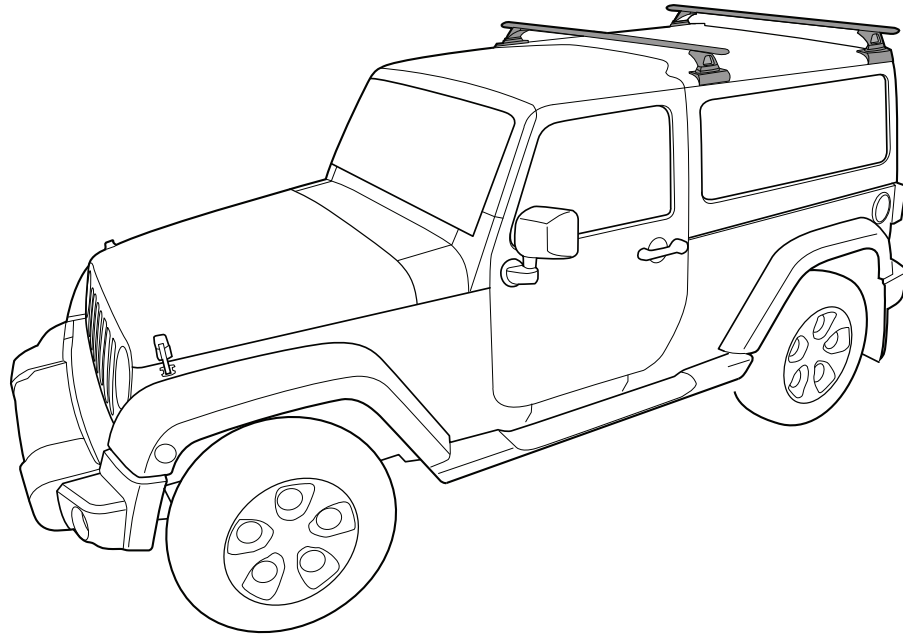

### IMPORTANT INFORMATION

**Maximum carrying capacity:**

On Road Cargo Allowance	Off Road Cargo Allowance	Static Allowance	Roof Allowance	Rack Weight
95kg / 209lbs	63kg / 138lbs	240kg / 530lbs	100kg/ 220lbs	5kg / 11lbs

- Off Road:** Any driven path taken that is not on sealed (tarred / bitumen) and maintained
  - Roof Allowance:** Total permissible weight attached to the roof of the car. This is inclusive of the weight of the roof rack system
  - Cargo Allowance:** Total permissible weight allowed on top, and attached to roof racks whilst the vehicle is in motion
  - Static Allowance:** Total permissible weight allowed on top, and attached to roof racks whilst the vehicle is stationary
- Please refer to your vehicle manufacturers handbook for maximum carrying capacity. Always use the lower of the two figures. Load must be evenly distributed over the entire Pioneer. Weight of roof rack accessories is to be included in cargo allowance.

**Torque settings**

Unless stated otherwise in these instructions, all fasteners should be set to the following torque settings - M6: 4-5Nm (3-4lbs/ft), M8: 8-10Nm (6-7.5lbs/ft) and M10: 16-18Nm (12-13lbs/ft).

**Warning:**

- Check Part No. and/ or Kit is correct for use with your vehicle
- Do not attempt to fit the rack system to your vehicle unless you fully understand these fitting instructions. Please direct any questions regarding fitting to the dealer from where the roof racks were purchased.
- **Use only non-stretch fastening ropes or straps.**
- The handling characteristics of the vehicle changes when you transport a load on the roof. For safety reasons we recommend you exercise extreme care when transporting wind-resistant loads. Special consideration must be taken into account when cornering and braking.
- Although the system is tested and approved to AS1235-2000 / ISO 11154, off-road conditions can be much more rigorous. Extreme care must be taken in off road conditions

**Recommendations:**

It is essential that all bolt connections be checked after driving a short distance when you first install your roof racks. Bolt connections should be checked again at regular intervals (once a week is enough, depending on road conditions, usage, loads and distances travelled). You should also check the roof racks each time they are re-fitted. Always make sure to fasten your load securely. Please also ensure that all loads are evenly distributed and that the centre of gravity is kept as low as possible and must be entirely contained within the extents of the roof racks.

**Note for Dealers and Fitters:**

It is your responsibility to ensure these fitting instructions are given to the end user or client

# Jeep JK 2dr Backbone - RJKB2

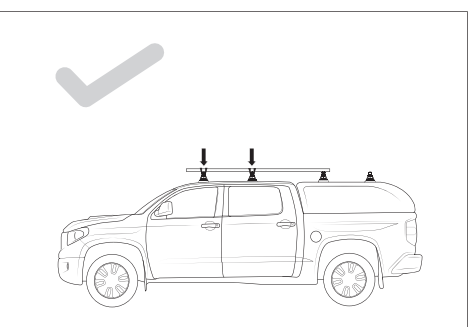
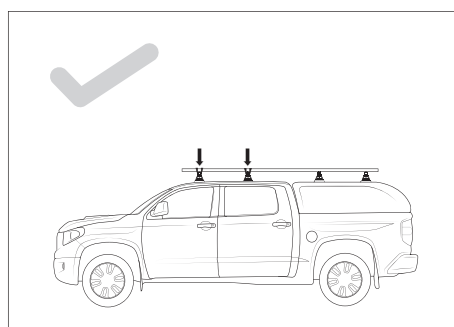
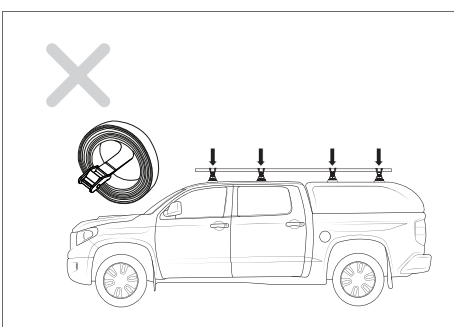
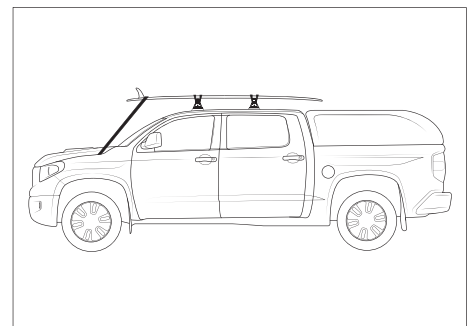
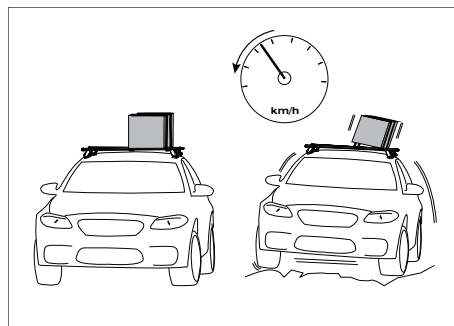
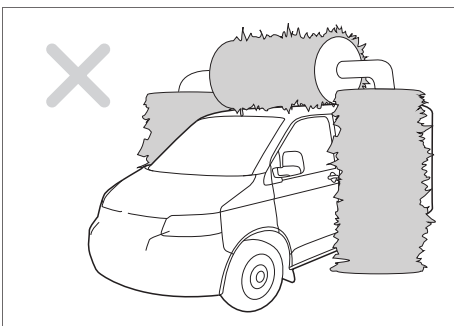
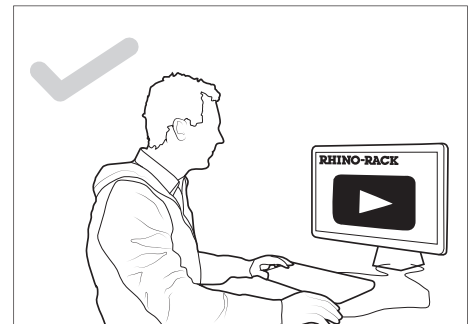
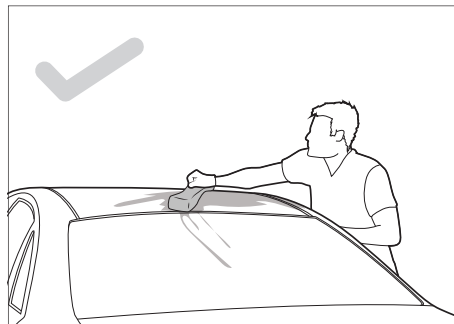
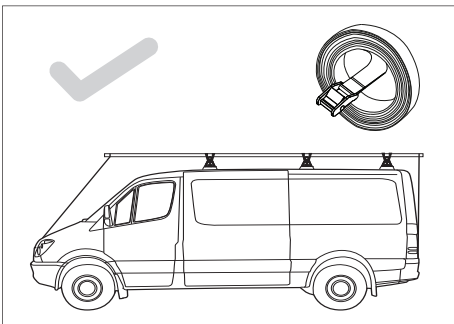
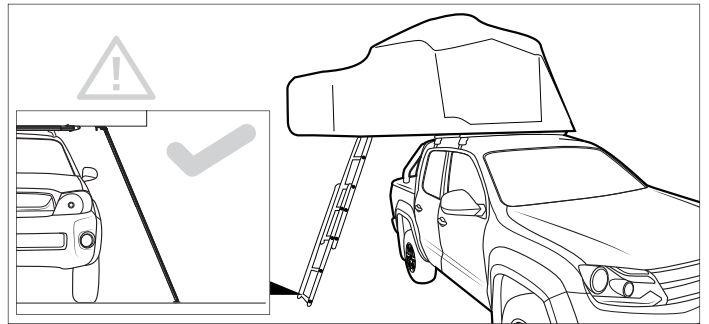
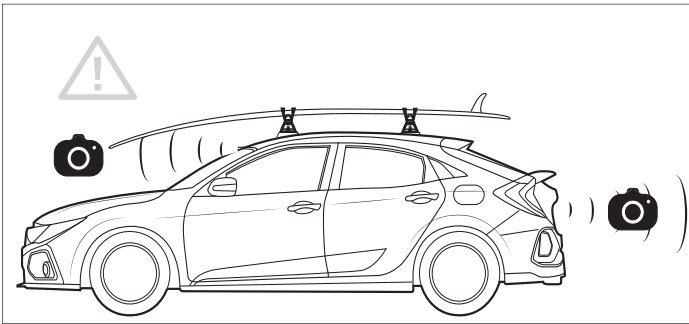
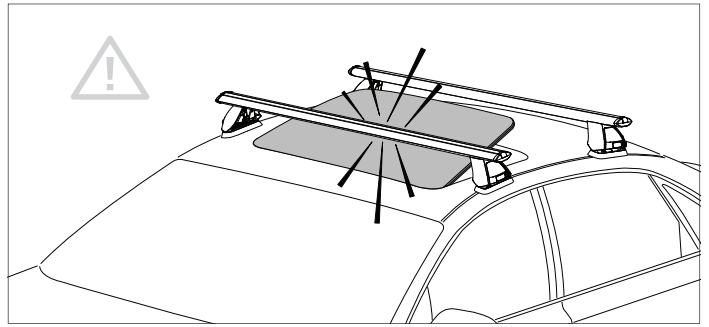
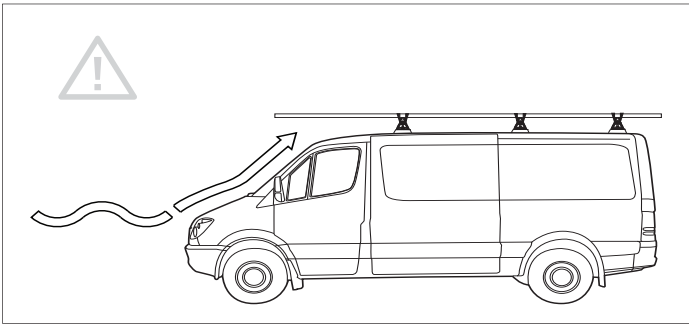

# Jeep JK 2dr Backbone - RJKB2

## Parts List

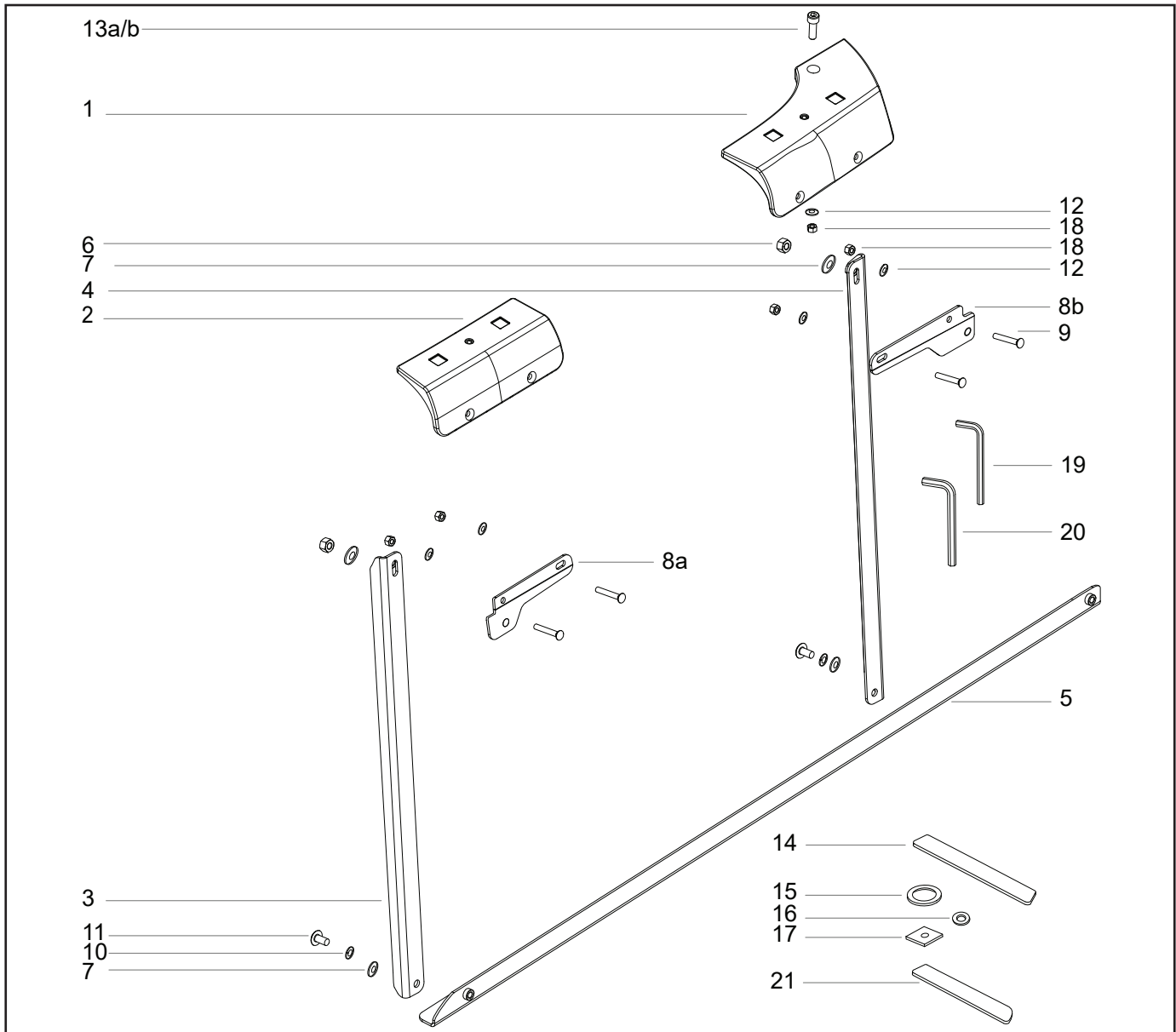

Item	Component Name	Qty R	Qty L	Part No.
1	Rear Bracket	1	1	CA1274
2	Middle Bracket		2	CA1275
3	Internal Support Vertical Front		2	CA1358
4	Internal Support Vertical Rear		2	CA1280
5	Internal Support Base	1	1	CA1324

### Tools Required:

- 10mm Spanner
- 13mm Spanner
- Tape Measure
- Marker Pen
- 4mm Allen Key (supplied)
- 5mm Allen Key (supplied)
- Support Stands
- Drill
- 3.0mm Drill Bit
- 6.5mm Drill Bit

Item	Component Name	Qty	Part No.
6	M8 Nyloc Nut Black	4	N043
7	M8 Flat Washer Black	8	CA1068
8a	Bracket Fixture Plate Front	2	CA1325
8b	Bracket Fixture Plate Rear	2	CA1282
9	M6 x 30 Socket HD Bolt Black	8	B211
10	M8 Spring Washer Black	4	W019-Blk
11	M8x20 Hex Setscrew Black	4	B020-Blk
12	M6 Flat Washer Black	10	W054-Blk
13a	M6 x 30 Socket HD	2	B210
13b	O-ring	2	C347
14	Middle Bracket Foam	2	CA1284
15	Bracket O Foam L	2	CA1285
16	Bracket O Foam S	4	CA1286
17	Bracket Foam Square	2	CA1287
18	M6 Nyloc Nut Blk	10	N069
19	4mm Allen Key	1	H001
20	5mm Allen Key	1	H002
21	End Bracket Rear Foam	2	-
22	Instructions	1	R438

# Jeep JK 2dr Backbone - RJKB2

**1** Remove the Hard Top (as per manufacturer's instruction) and place onto a stable, safe working area.

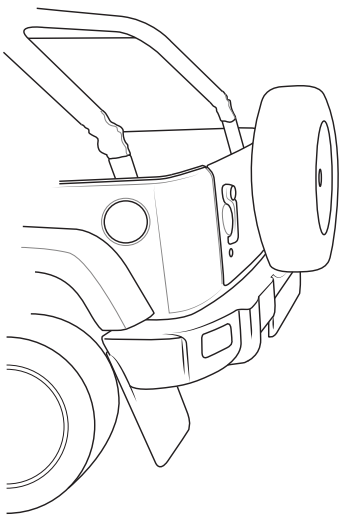

Hardware will have to be removed from inside Hard Top.

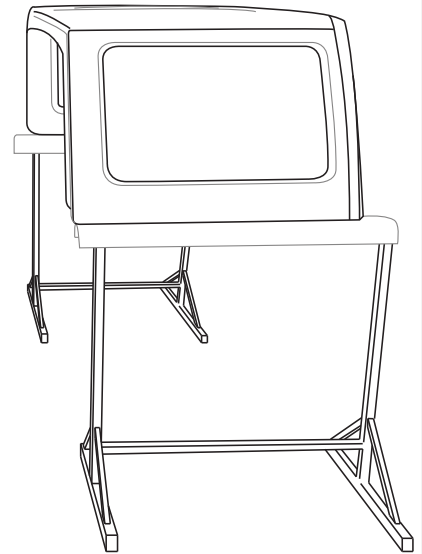
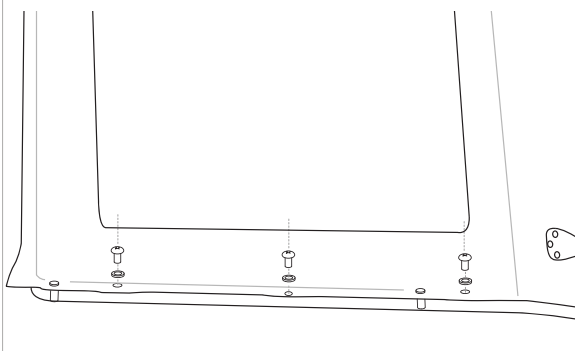

**2a** Assemble the Support Struts as shown. Finger tighten. Check part ID to make left and right side supports.

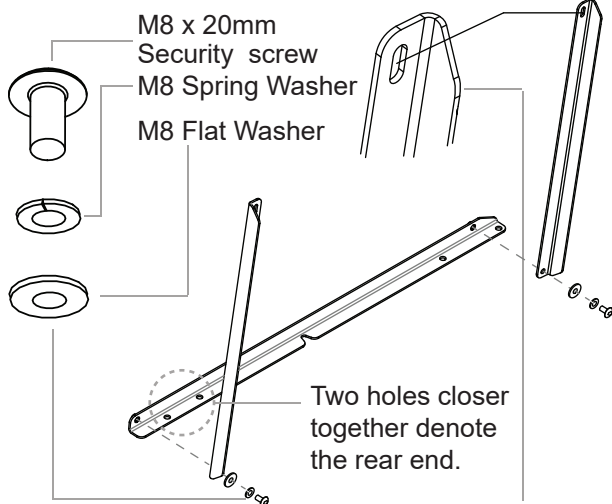

Front end strut has a shorter flange to fit behind roll bar.

**2b** Attach item 8a,b to the arms as shown, using an M8 washer and M8 an Nyloc nut. Finger tighten.

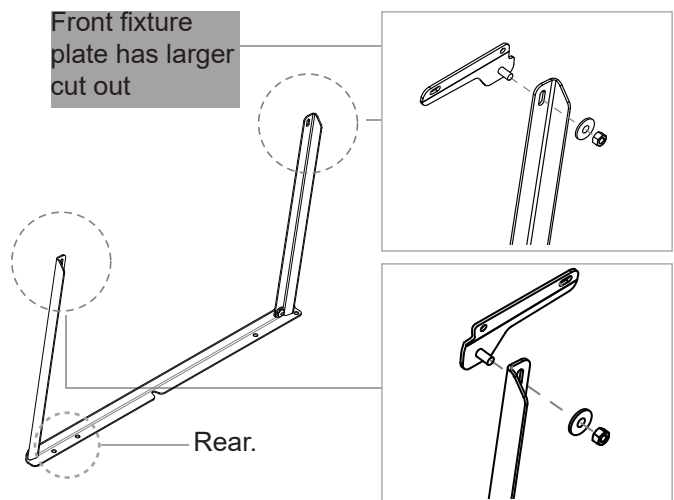

**3** Repeat the process for for the opposing support strut.

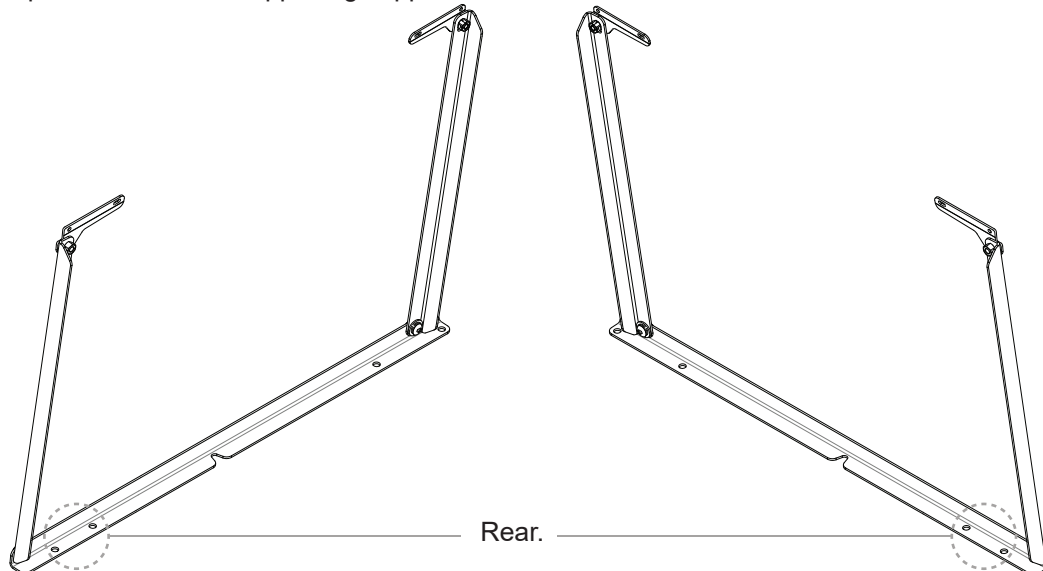

## Jeep JK 2dr Backbone - RJKB2

- 4** Align the REAR bracket with the REAR of the Hard Top. Line the bracket flush with the contour of the Hard Top as show.

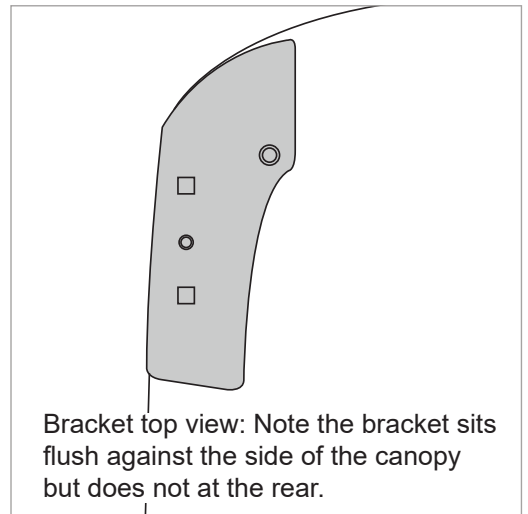
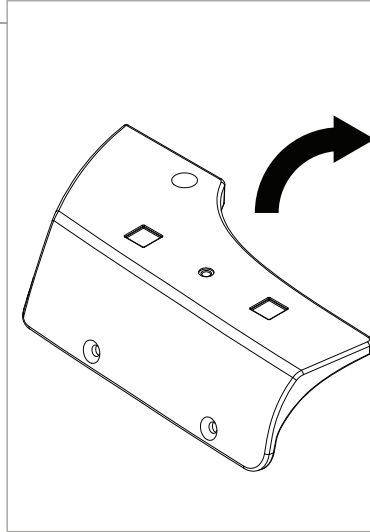
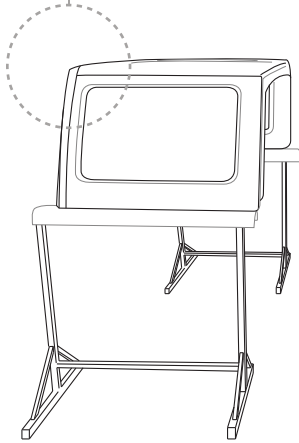

- 5** With bracket aligned, spot mark the bracket position as shown. It is important to be accurate when marking. Always mark the centre of the hole.

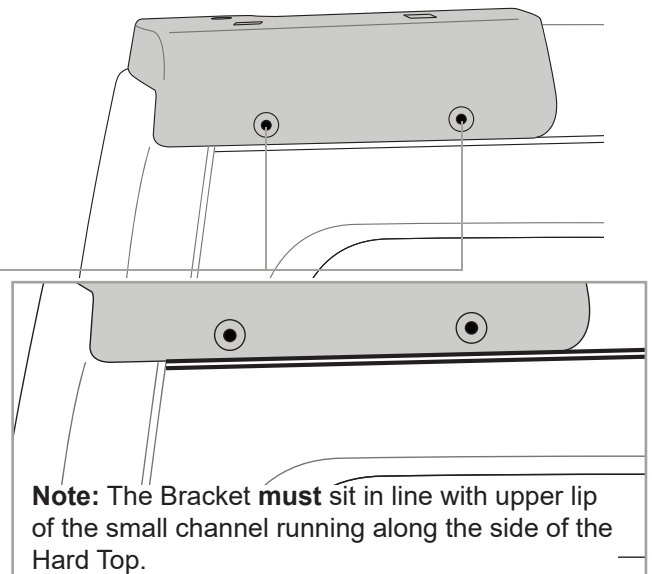
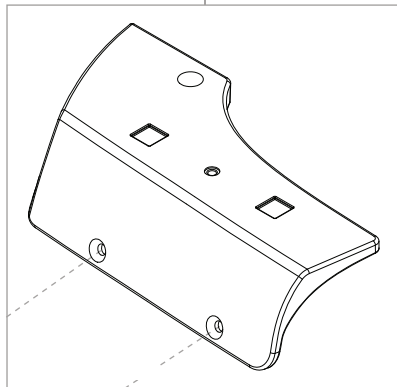
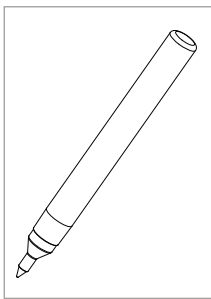

- 6** Align the FRONT Bracket **35mm** back from where the hard top meets the rubber seal at the front of the canopy.

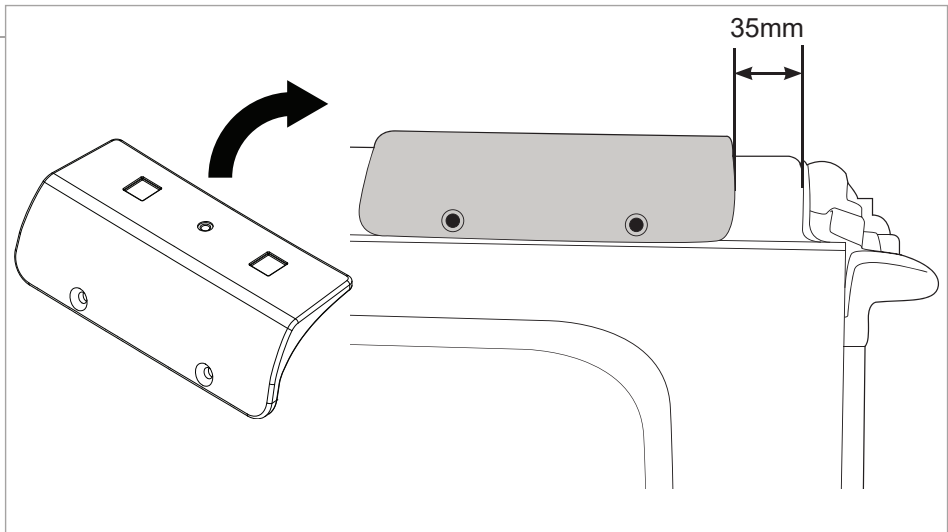
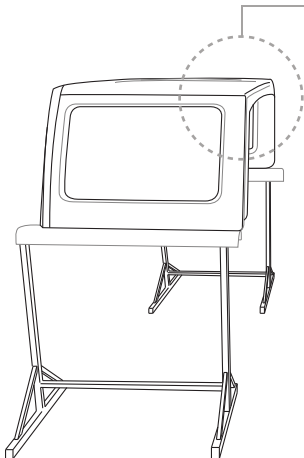

## Jeep JK 2dr Backbone - RJKB2

**7** With the FRONT Bracket aligned, spot mark the bracket position as shown.

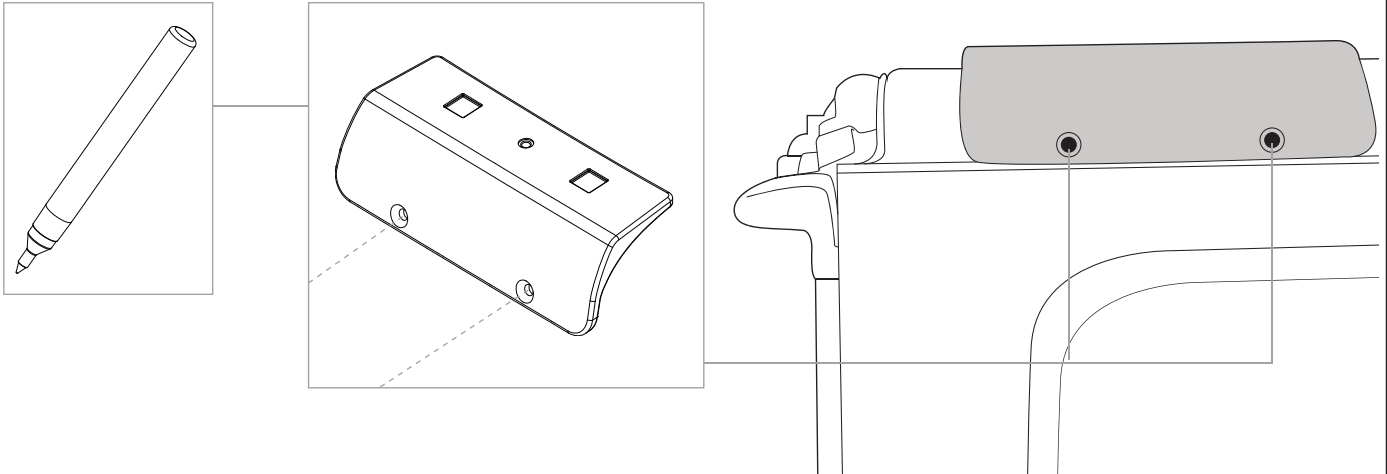

**8** Using a 6.5mm drill bit, drill **ALL** holes. Angle drill when completing so that it is perpendicular to the roof.

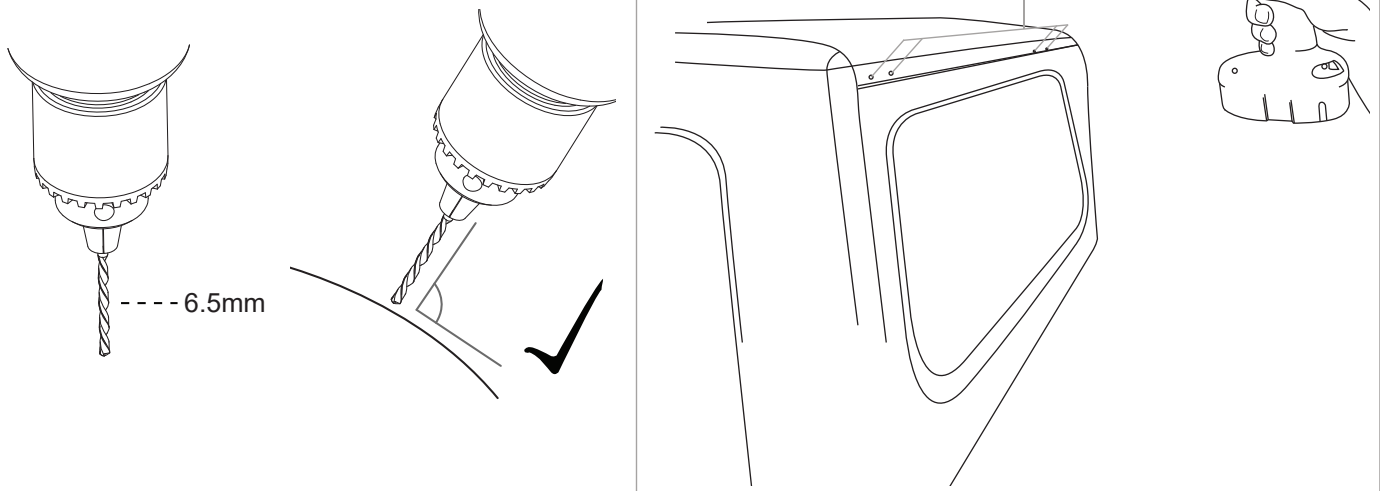

**9** With relation to the FRONT Bracket, take corresponding foam pads and remove the protective strip as shown. Fit to bracket.

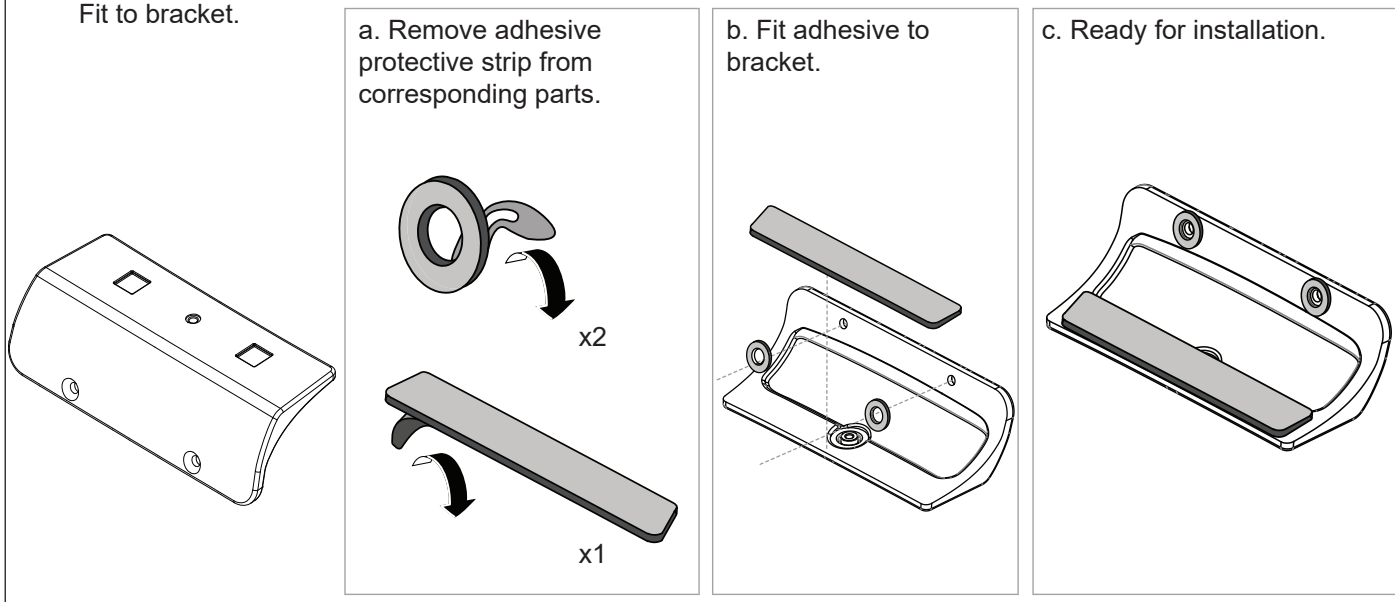



## Jeep JK 2dr Backbone - RJKB2

- 10** With relation to the Rear Bracket, take corresponding foam pads and remove the protective strip as shown. Fit to bracket.

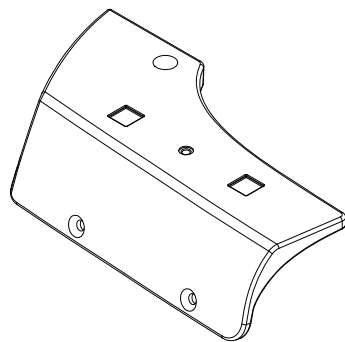

a. Remove adhesive protective strip from corresponding parts.

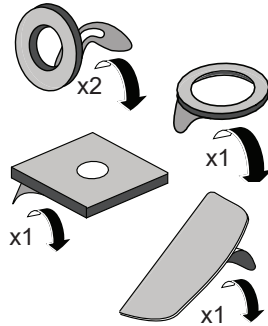

b. Fit adhesive to bracket.

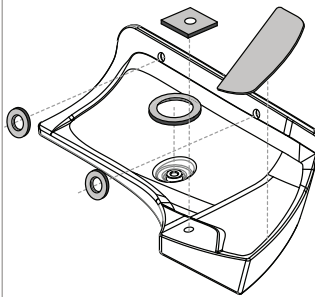

c. Ready for installation.

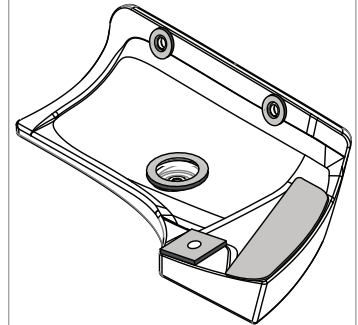

**Note: Repeat the previous steps 4 to 10, for the opposing side of the Hard Top**

- 11** With assistance to hold the Support Strut in place, set the assembly on the inside of the Hard Top as shown.

Front.

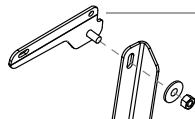

Front fixture plate has larger cut out

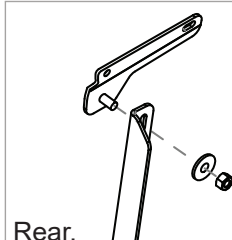

Rear.

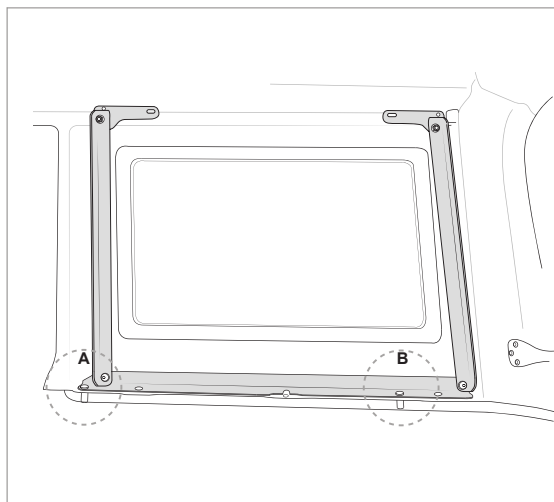

A. The Support Strut will slot onto the Hard Top studs as shown.

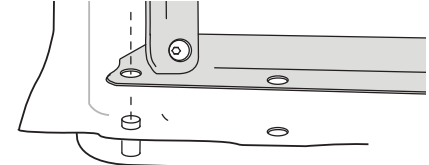

B. The Support Strut will slot onto the Hard Top studs as shown.

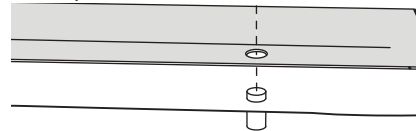

- 12** With assistance to hold the Support Strut in place, move to the outside of the Hard Top. Place the REAR Bracket in place. Insert M6 counter sunk screws, fastening from the inside with M6 black flat washers and M6 Nyloc nuts. Hold the nyloc nuts in place with a 10mm spanner. Tighten from the outside with a 4mm allen key. Repeat this process for the FRONT Bracket.

1. Assemble as shown. Finger tighten to fix in place.

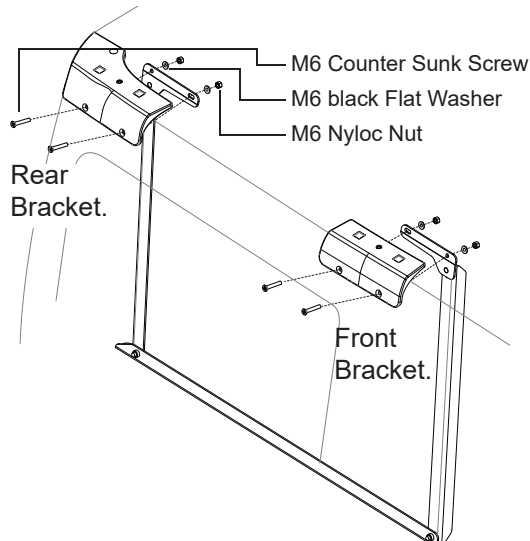

2. Hold Nyloc Nut with a spanner, allowing the bracket to be tightened from the outside.

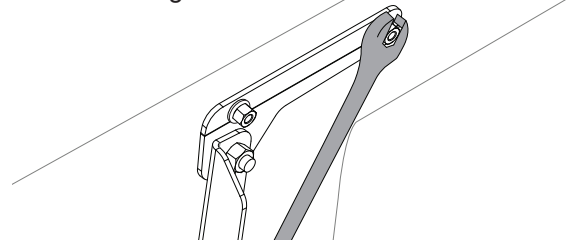

3. Fix with a 4mm Allen Key.

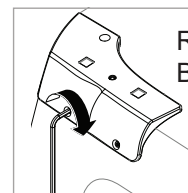

Rear Bracket.

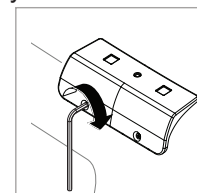

Front Bracket.



## Jeep JK 2dr Backbone - RJKB2

- 13** With Rear Bracket now secure, drill out the top fixture point with a 6.5mm (1/4") bit. Use an M6 socket HD bolt with O'ring, an M6 flat washer and an M6 nyloc nut to fix the bracket.

Drill out fixture point.

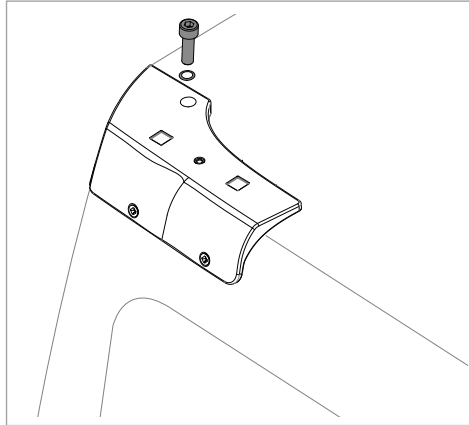
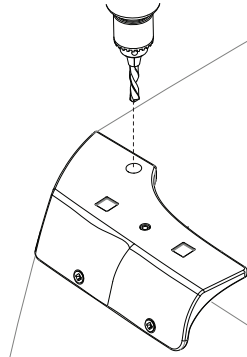

View from inside Hard Top

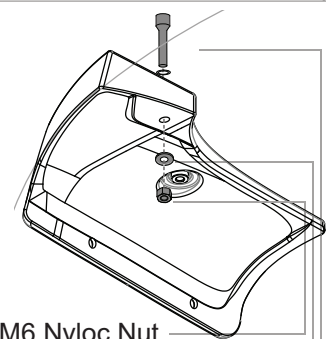

M6 Nyloc Nut  
M6 Flat Washer  
M6 socket Hd Bolt

- 14** Tighten supports with a 5mm allen key. Top of supports will require a 13mm spanner.

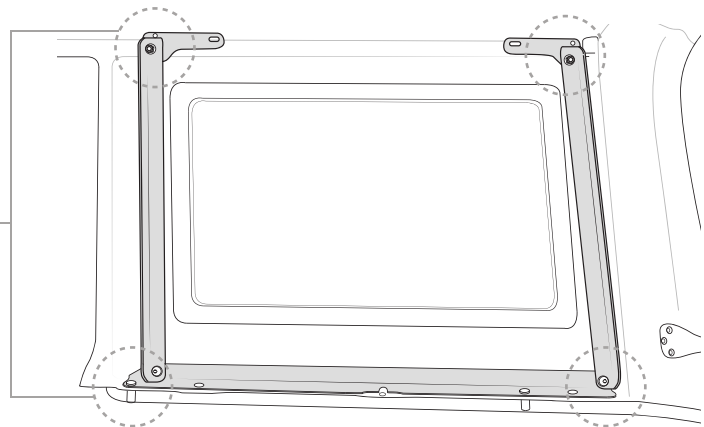
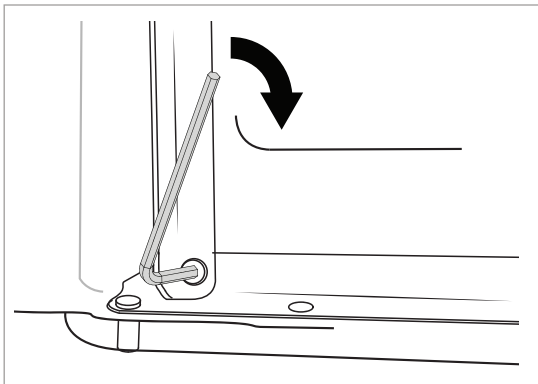

**Note: Repeat previous steps 11-14 for the opposing side of the Hard Top**

- 15** Place the Hard Top back onto the Jeep (refer to manufacturers instructions). Replace the hardware removed in step 1 on both sides of the inner Hard Top.

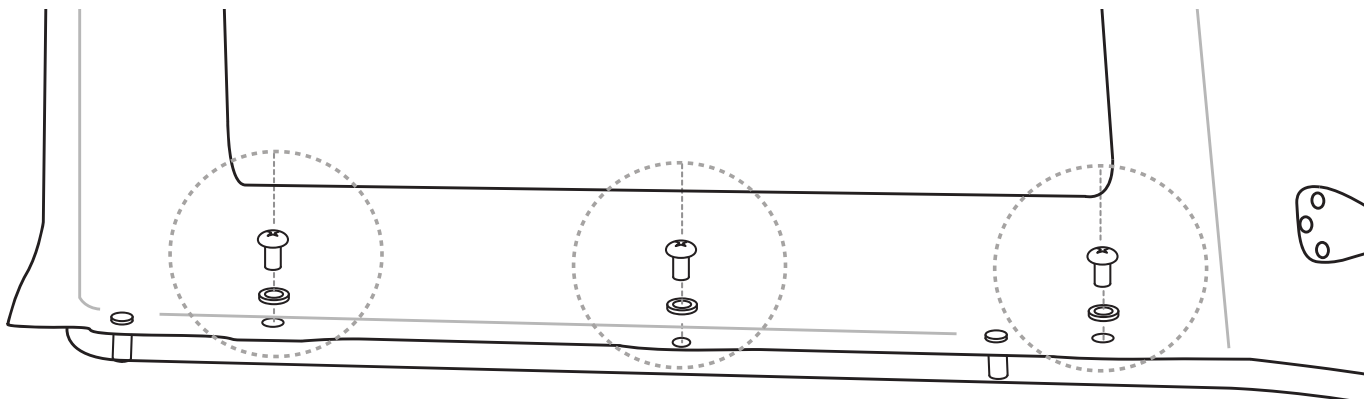

# Jeep JK 2dr Backbone - RJKB2

## 16 Attach Vortex Crossbars

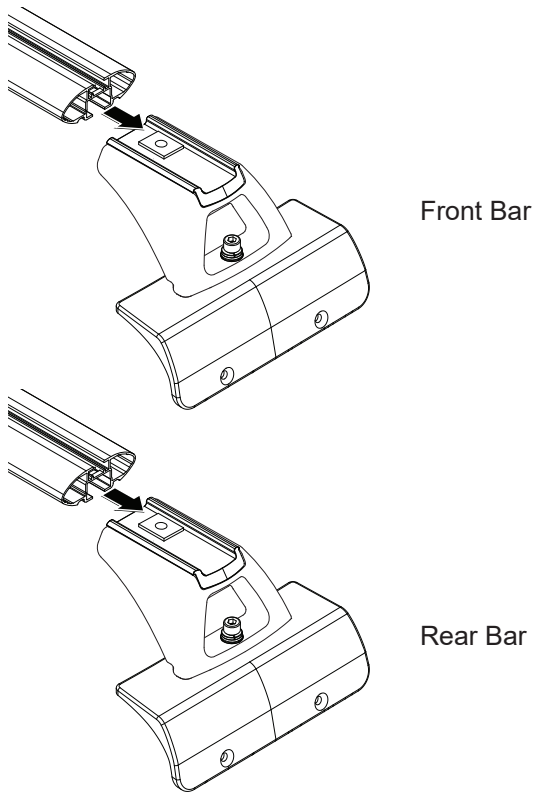

## Heavy Duty Crossbars

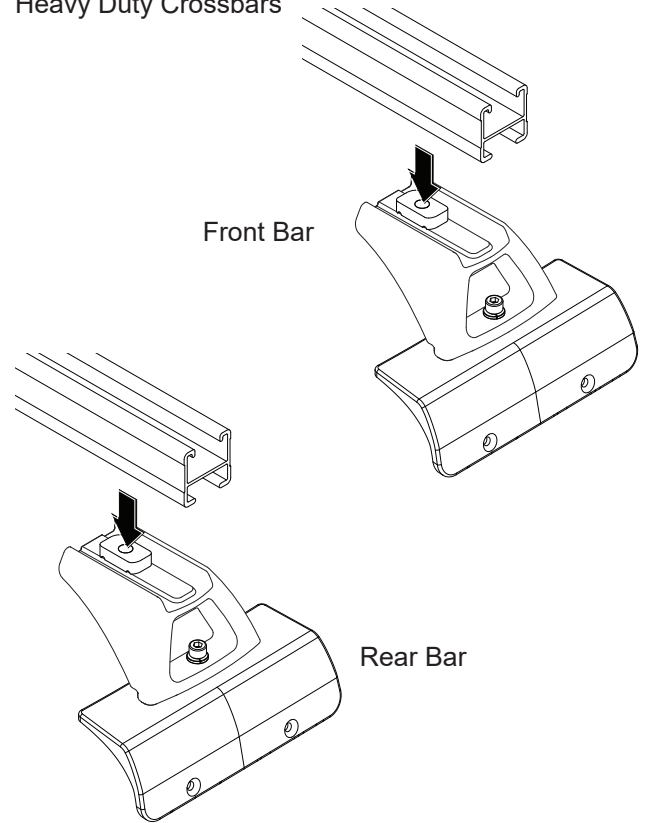

## 17 Adjust crossbar overhang to be equal on both sides. Tighten M6 crossbar bolts to 3-4Nm/ 2-3lb/ft. Tighten M6 security screws to 3-4Nm/ 2-3lb/ft.

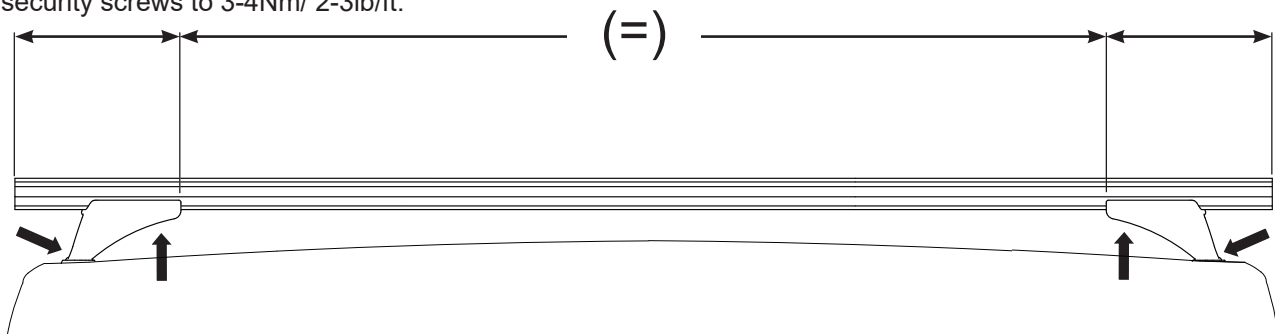

## 18 Insert vortex rubber and end caps into all crossbars.

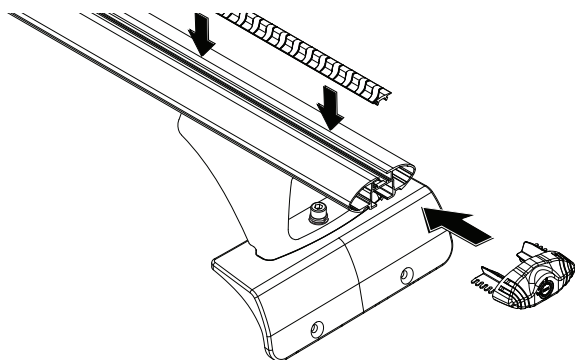

## 19 Measure the under bar slot length each side of the leg. Cut under bar strips to fill the gaps.

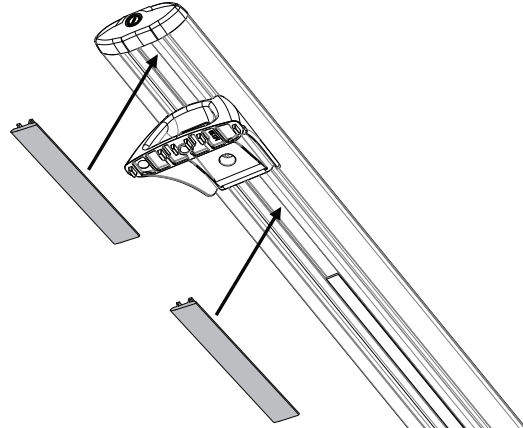

**Note: RE-CHECK ALL FASTENERS ARE SECURE.**



# RHINO-RACK

## Leg Kit - Jeep JK Pioneer Fit Kit

### Parts List

Parts List		4dr JK	2dr JK	Part No.
1	Low Leg Kit (x4 legs)	0	1	RCL4
2	Low Leg kit (x6 legs)	1	0	RCL6
3	Pioneer 10mm Spacer Kit	2	2	QMPS10
4	20mm Spacer Kit	1	0	QMHD20
5	Jeep Hardware Fit Kit	1	1	SUB0800
6	Instructions	1	1	R1813

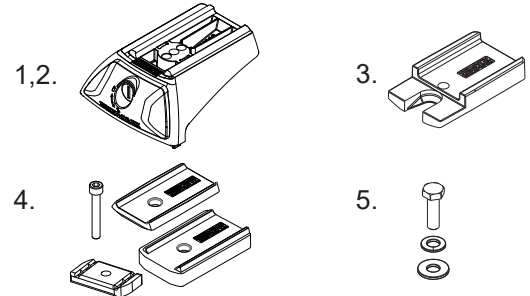

**Note:** The following instructions provide information relating to the RLCP38/RLCP39 fitting a Pioneer Platform, Tray or Tradie Tray to the Jeep JK Backbone. **These kits are sold separately.**

**Tools Required:** 1 - 10mm Socket Wrench. 2 - Pliers.

### Instructions

- 1** The legs of the system must have their locator tabs removed before installing them to the vehicle. Using pliers, grip and twist off the two tabs on the underside of the legs. File down any additional material as required.

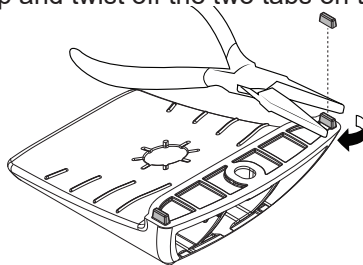

The underside of the leg should be flat. File down any material still present after cutting.

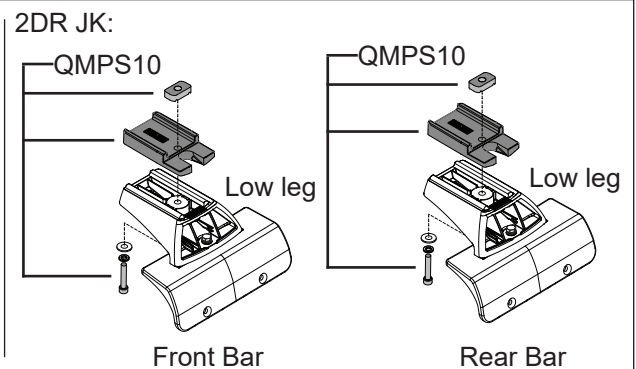
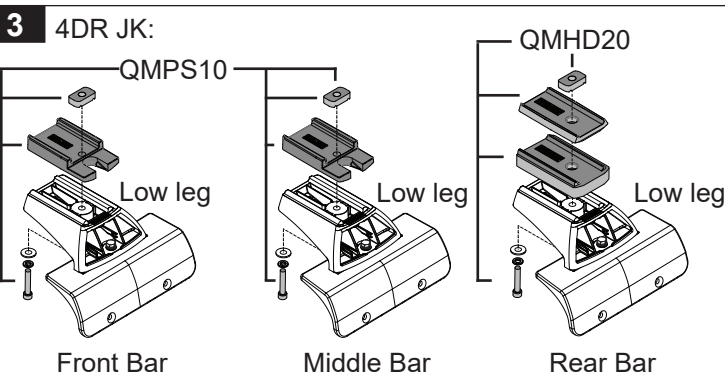
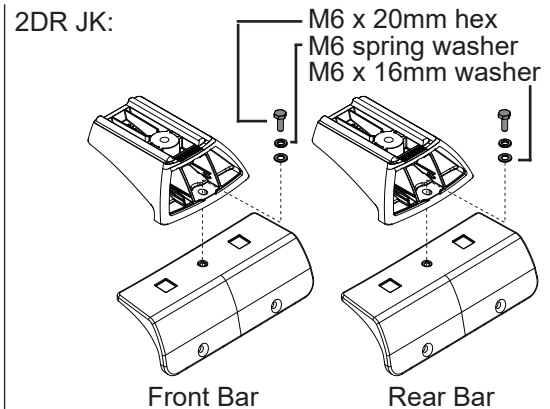
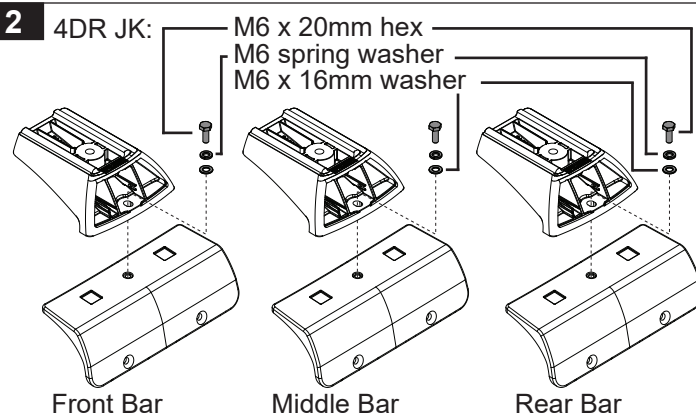
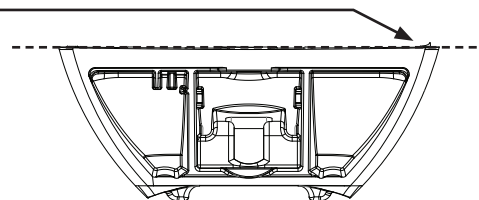



# RHINO-RACK

## RCL, RCH 2,4,6 Kits

**Important:** Please read these instructions carefully prior to installation. Please refer to your fitting instruction to ensure that the Roof Rack System is installed in the correct location. Check the contents of kit before commencing fitment and report any discrepancies. Place these instructions in the vehicle's glove box after installation is complete.

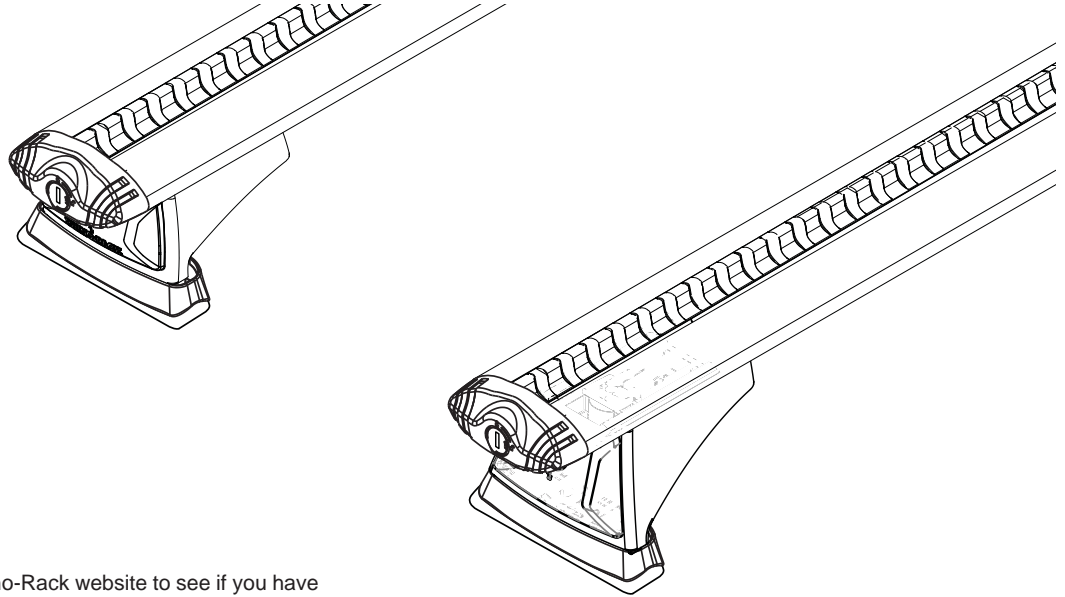

**Note:** Be sure to check Rhino-Rack website to see if you have the latest version of instructions before beginning installation.

**Maximum load carrying capacity: 100kg / 220lbs**

### Important Information

1.  Check Part No./Kit is correct
2.  Read through instruction before installing
3.  Fit roof rack accessory
4.  Check and recheck all fasteners are secure

**Maximum carrying capacity: Up to 100kg (220lbs)** including the weight of the rack system.

Please refer to your vehicle manufacturers handbook for maximum carrying capacity. Always use the lower of the two figures. Load must be evenly distributed over the entire basket.

**Warning:** Do not attempt to fit the rack system to your vehicle unless you fully understand these fitting instructions. Please direct any questions regarding fitting to the dealer from where the roof racks were purchased.

**Use only non-stretch fastening ropes or straps.**

**Recommendations:** It is essential that all bolt connections be checked after driving a short distance when you first install your roof racks. Bolt connections should be checked again at regular intervals (once a week is enough, depending on road conditions, usage, loads and distances travelled). You should also check the roof racks each time they are re-fitted. Always make sure to fasten your load securely. Please also ensure that all loads are evenly distributed and that the centre of gravity is kept as low as possible and must be entirely contained within the extents of the roof racks. **Rack System must be removed when putting vehicle through an automatic car wash.**

**Caution:** The handling characteristics of the vehicle changes when you transport a load on the roof. For safety reasons we recommend you exercise extreme care when transporting wind-resistant loads. Special consideration must be taken into account when cornering and braking.

**Off-road use:**

The Roof Rack System may be used in off road applications, however a safety factor of 1.5 is enforced. That is, maximum permissible off road load is **66kg (145lbs)**. Although the crossbars are tested and approved to AS1235-2000/ 15011154, off-road conditions can be much more rigorous. Extreme care must be taken in off road conditions

**Note for Dealers and Fitters:**

It is your responsibility to ensure these fitting instructions are given to the end user or client.



# RCL, RCH 2,4,6 Kits

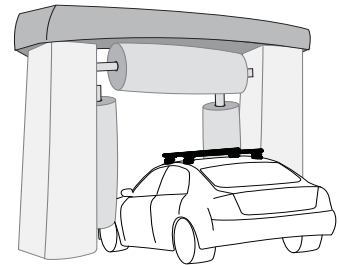
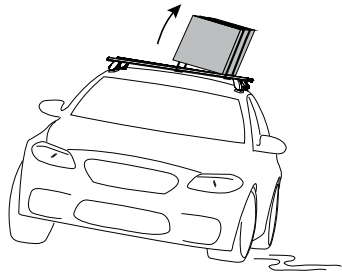
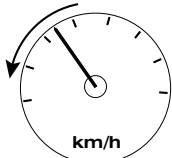
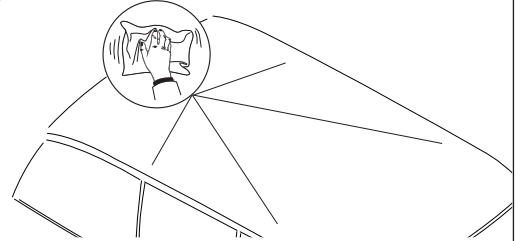
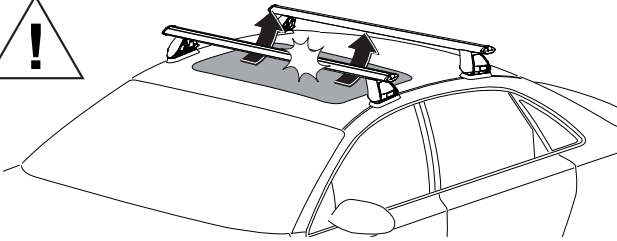
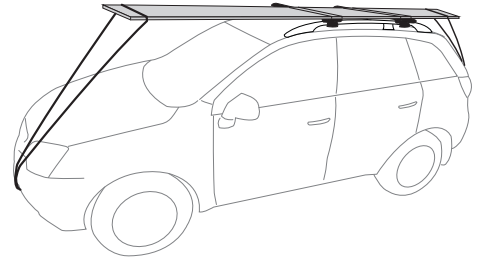
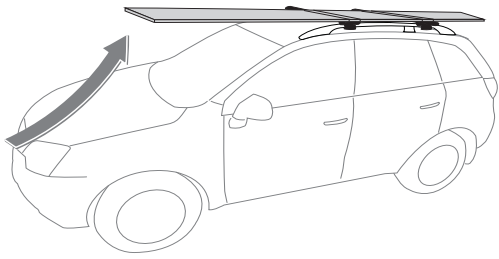

**Ensure Ladder is well supported on the ground to help support tent. Take extreme caution when climbing heights above 1.2m/4ft.**

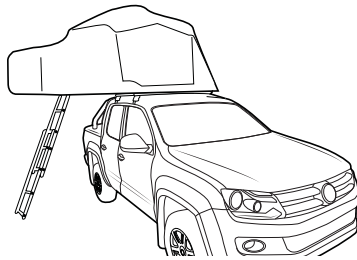

**It is required for Clam Shell Roof Top Tents to use a 3 Crossbar System.**

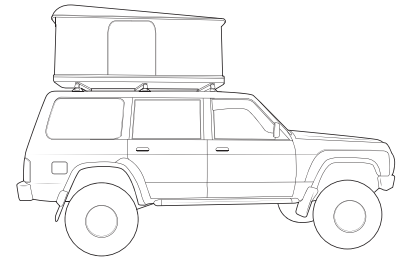

When these roof racks are to be used on a vehicle that is driven off sealed roads, the manufacturer maximum roof load rating (to be found in the vehicles User Manual) should be **divided by 1.5**. Do not forget to subtract the complete crossbar system weight from your maximum carrying capacity.

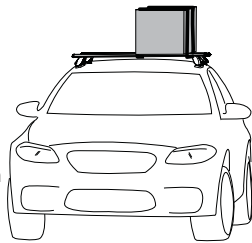

100kg/220lbs  
(Urban Road)



66kg/145lbs  
(Off Road)

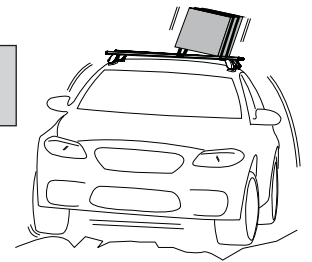

## WARNING! Important Load Carrying Instructions

With utility vehicles, the cabin and the canopy move independently. Roof racks and vehicle can be damaged if the item transported is rigidly fixed at points on both the cabin and canopy. Instead, rigidly fix to either the cabin roof racks or the canopy roof racks.

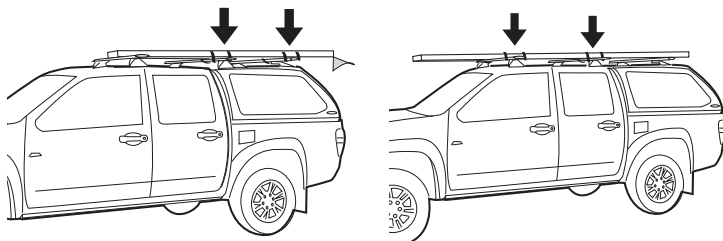

Paddle/ Surfboards should be fixed to the front of the vehicle.

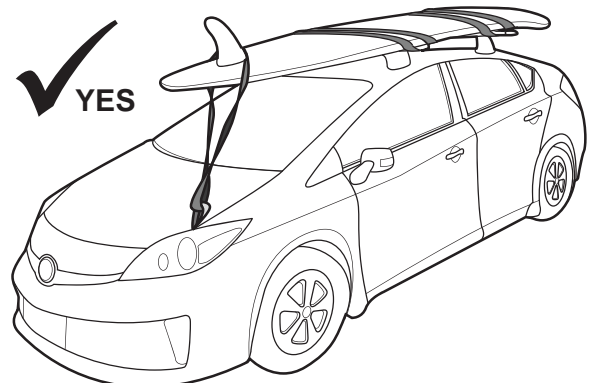



# RCL, RCH 2,4,6 Kits

## Parts List

Item	RCL	2 Kit Qty	4 Kit Qty	6 Kit Qty	Part No.
1	Locking Leg Cover (37mm)	2	4	6	M810
2	Locking Leg Base (37mm)	2	4	6	M813
3	Key Barrel	2	4	6	CA1339
4	Key	1	2	2	-
5	Allen Key	1	1	1	H034
6	M6 x 20mm Socket Head Screw	2	4	6	B054
7	M6 Spring Washer	2	4	6	W004
8	M6 x 16mm Flat Washer	2	4	6	W031
9	M6 Nut 30mm x 25mm	2	4	6	N035A
10	Instructions	1	1	1	R1182
Item	RCH	2 Kit Qty	4 Kit Qty	6 Kit Qty	Part No.
10	Locking Leg Cover (52mm)	2	4	6	M812
11	Locking Leg (52mm)	2	4	6	M811
3	Key Barrel	2	4	6	CA1339
4	Key	1	2	2	-
5	Allen Key	1	1	1	H021
6	M6 x 20mm Socket Head Screw	2	4	6	B054
7	M6 Spring Washer	2	4	6	W004
8	M6 x 16mm Flat Washer	2	4	6	W031
9	M6 Nut 30mm x 25mm	2	4	6	N035A
10	Instructions	1	1	1	R1182

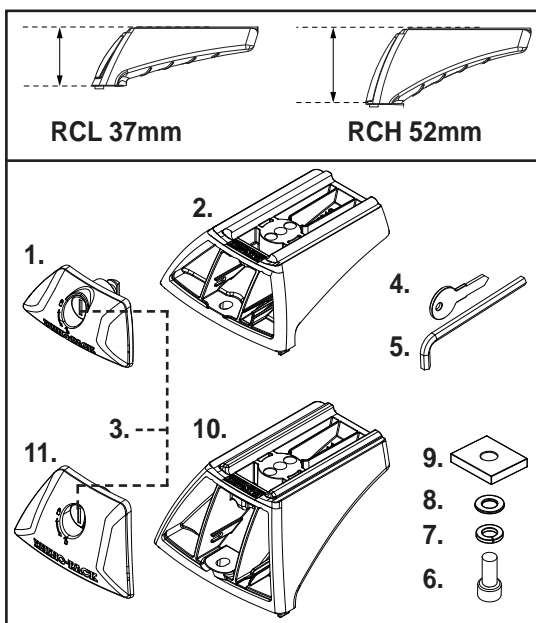

### Tools Required:

Allen Key (provided).  
Metal Key (provided).

### Notes:

Crossbars and Fit Kits are sold as separate and are required for individual vehicle fits.  
Heavy Duty Bars will require a QMHD05 kit.

## Instructions

- 1** Use the Metal Key provided to unlock the Cover Plate and remove. Remove the Allen Key from its storage position.

**Note: Low Leg used throughout instructions.**

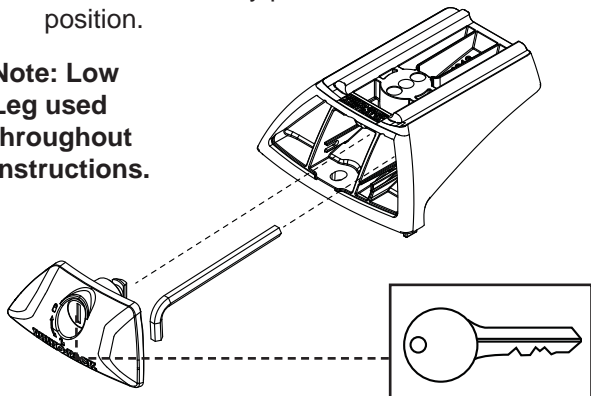

Front View:

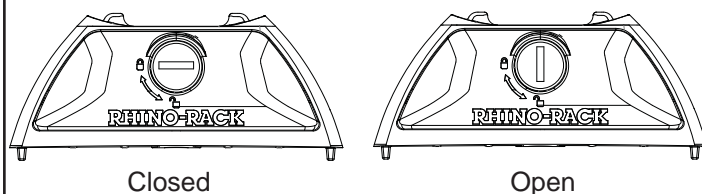

- 2** Insert the M6 hardware as shown. Finger tighten only at this stage.

M6 Nut 30mm x 25mm

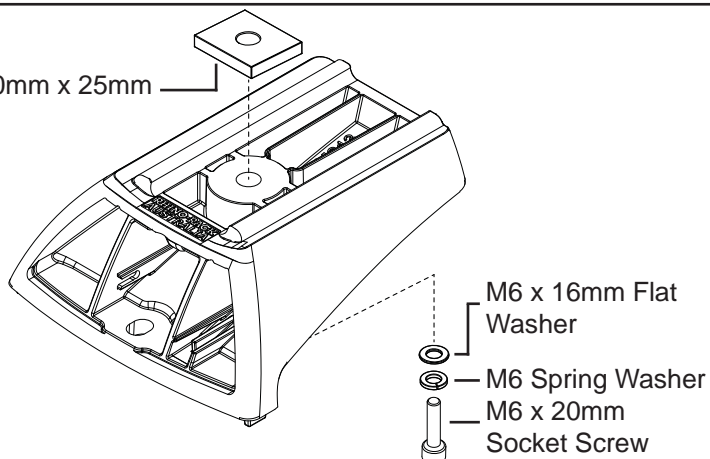





## RCL, RCH 2,4,6 Kits

- 3** Slide the Assembled legs into the Crossbars as shown. Insert Vortex Rubber, cut to length as required.

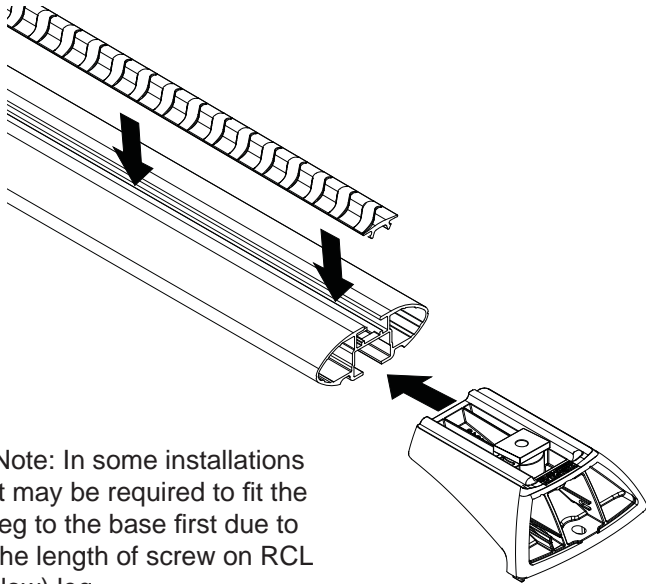

Note: In some installations it may be required to fit the leg to the base first due to the length of screw on RCL (low) leg.

- 4** Fix the Crossbars to the vehicle specific Base Kit that has been purchased, using the Allen Key provided.

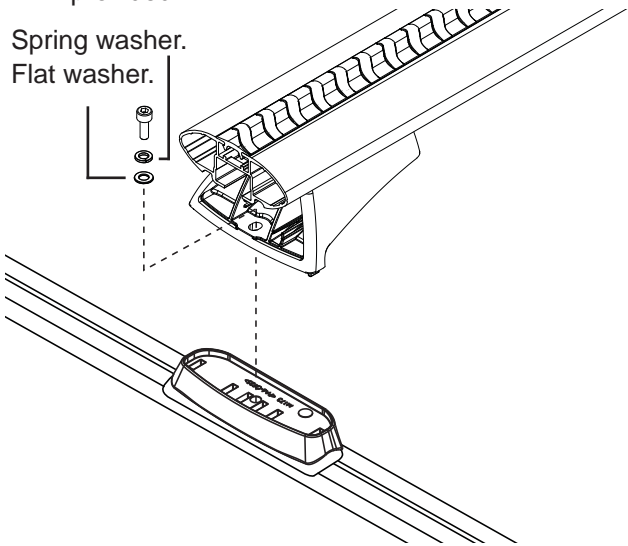

Note: Images are example only. RCL/RCH legs can be fit to either tracks or pads. Pads and track fit kits are sold as separate.

- 5** Ensure the Crossbars have an equal overhang. Tighten the M6 Leg Hardware with the Allen Key provided.

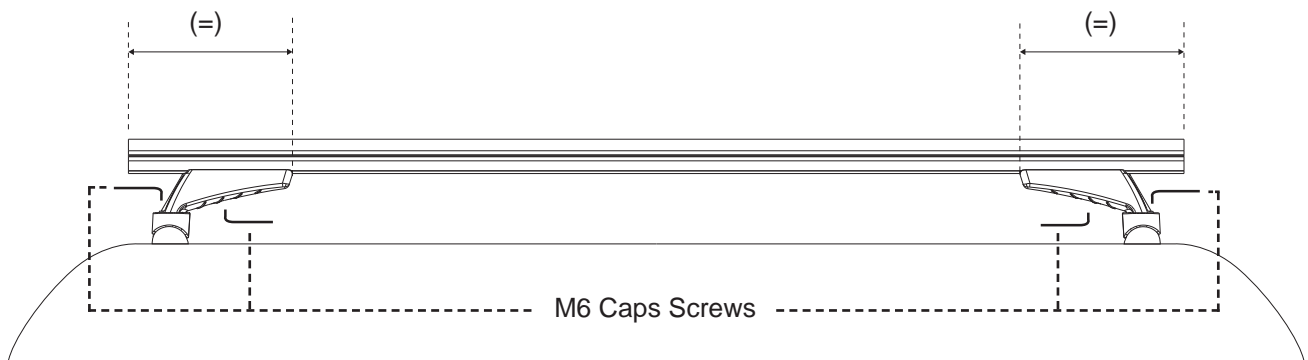

- 6** Insert the Underbar Strips into the slots either side of the installed Leg. Cut to length as required.

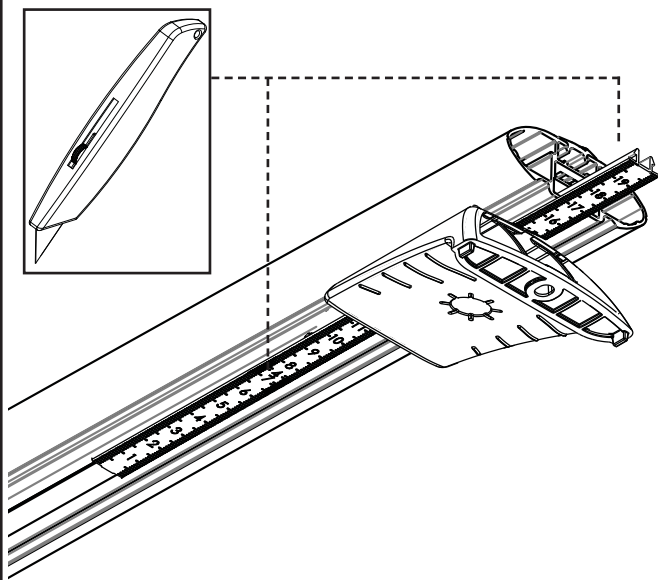

- 7** Insert the Crossbar End Caps and lock in place. Replace the Allen Key and Leg Cover. Lock the Leg Cover Plate with the key provided. Be sure all fixtures are secure before use.

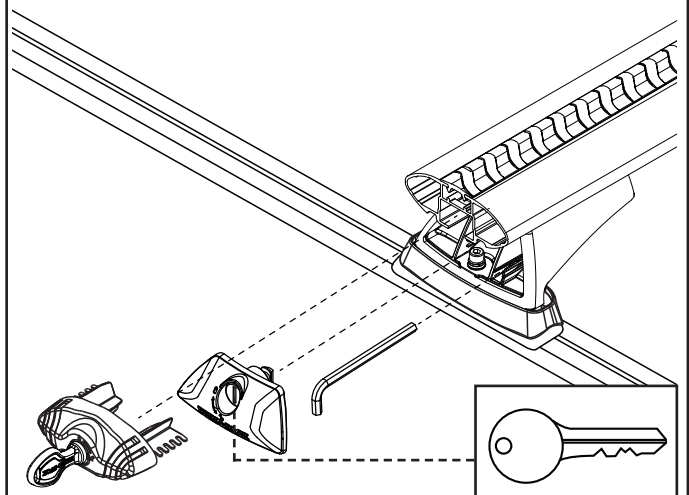





# RCL, RCH 2,4,6 Kits

**Note** To fit Legs to Heavy Duty Crossbars, Pioneer Trays and Platforms Pioneer QMHD05 must be purchased as separate. Install the Spacer Kit then the HD Crossbars.

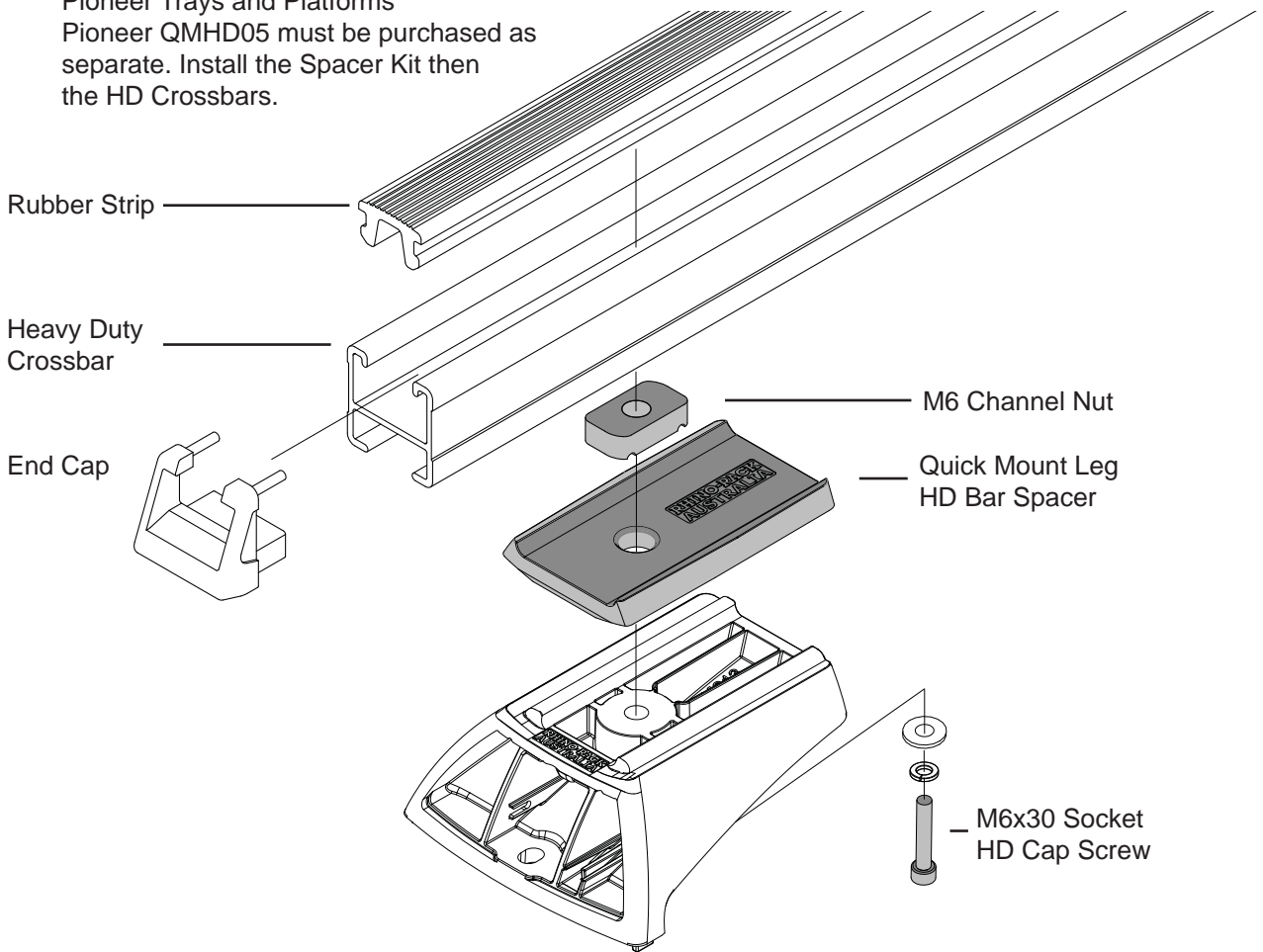

To fit Legs to Pioneer Trays/ Platforms, positioned wide on vehicle, QMPS10 must be purchased as separate. Install the Spacer Kit then the Tray/ Platform.

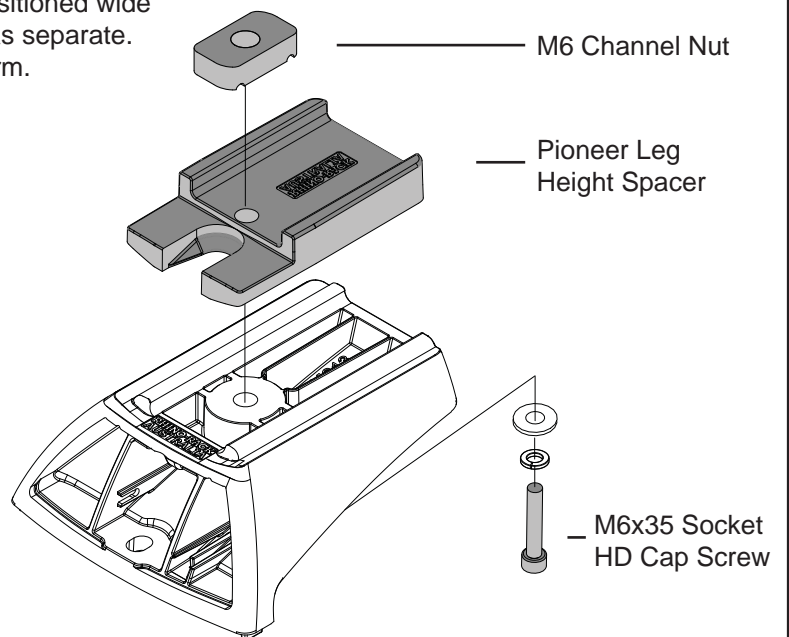

Check all fixtures are secure before use.

