



RHINO-RACK

RTS547 Toyota Tacoma

Place these instructions in the vehicle's [glove box](#) after installation is complete.

Important: Please read these instructions carefully prior to installation. Please refer to your fitting instruction to ensure that the roof racks are installed in the correct locations. Check the contents of kit before commencing fitment and report any discrepancies.

Layout

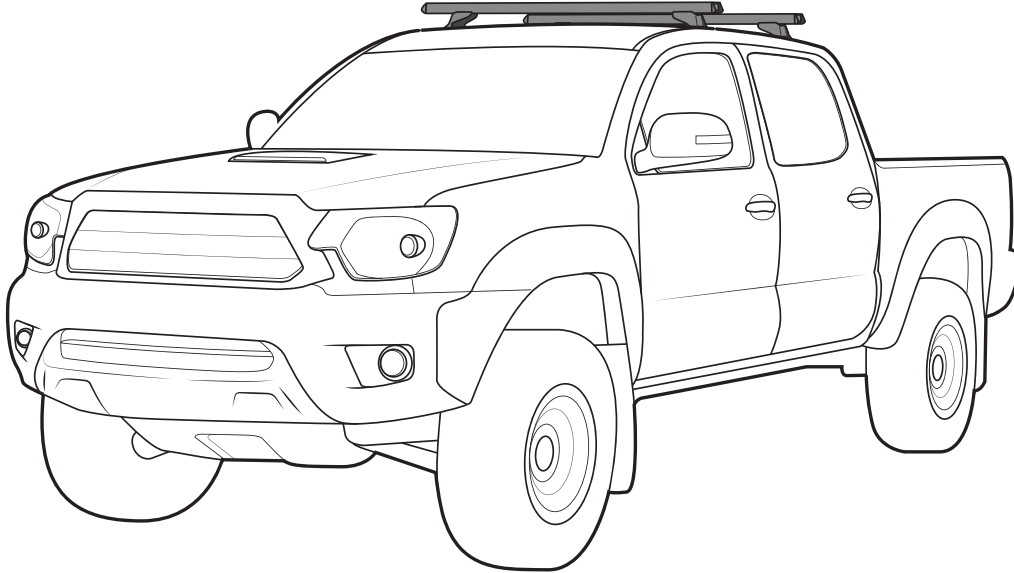

Important Information.

- Check Part No./Kit is correct
- Read through instruction before installing
- Fit roof rack accessory
- Check and recheck all fasteners are secure

Maximum carrying capacity: 100kg (220lbs) evenly distributed over the two crossbars.

Recommendations:

It is essential that all bolt connections be checked after driving a short distance when you first install your cross bars. Bolt connections should be checked again at regular intervals (probably once a week is enough, depending on road conditions, usage, loads and distances travelled). You should also check the cross bars each time they are refitted.

Be sure to fasten load securely. Please ensure that all loads are evenly distributed and that the centre of gravity is kept as low as possible. **Use only non-stretch fastening ropes or straps.**

Sensitivity to cross winds, behaviour in curves and braking.

The handling characteristics of the vehicle changes when you transport a load on the roof. For safety reasons, we recommend you exercise extreme care when transporting wind-resisting loads; special consideration must be taken into account when braking. **Please remove cross bars when putting vehicle through an automatic car wash.**

Load rating.

Maximum permissible load is 100kg (220lbs) per pair of cross bars (include the weight of the roof racks, 5kg). When crossbars are to be used in off-road conditions, please build a safety factor of 1.5 into this load limit. (66kg/145lbs for off-road use). Although the roof racks are tested and approved to AS1235-2000/ 15011154, road conditions can be much more rigorous. However, increasing the number of cross bars does not increase the vehicles maximum permissible roof loading.

Note for Dealers and Fitters.

It is your responsibility to ensure instructions are given to the end user or client.



RTS547 Toyota Tacoma

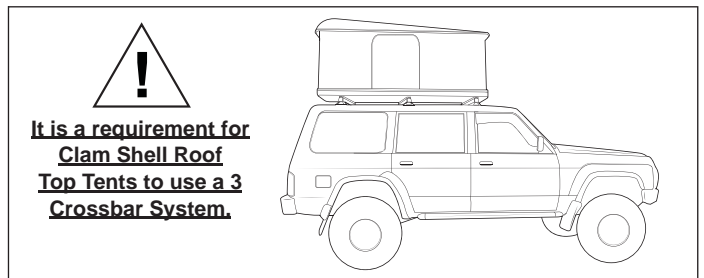
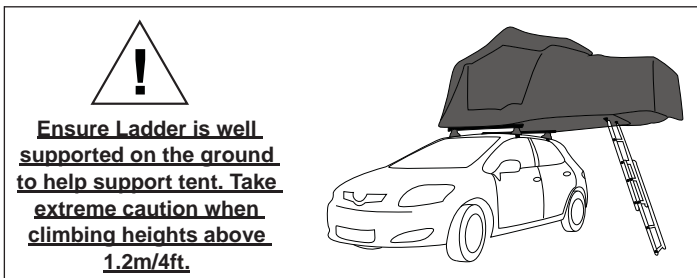
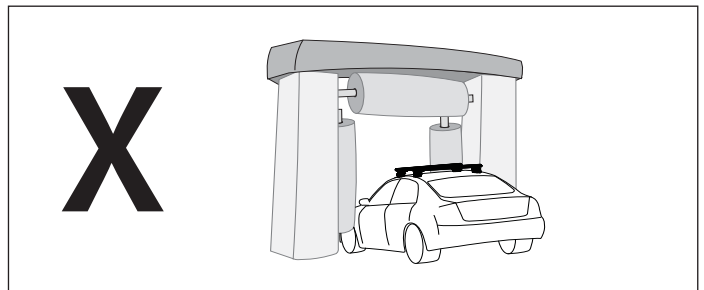
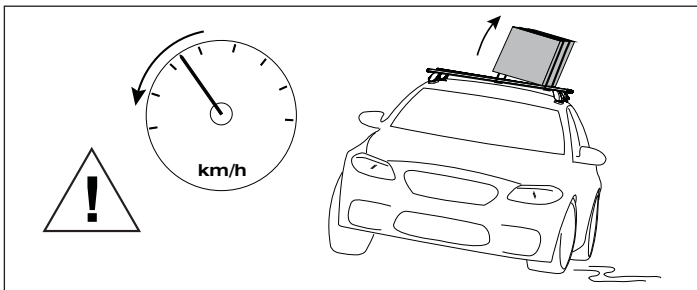
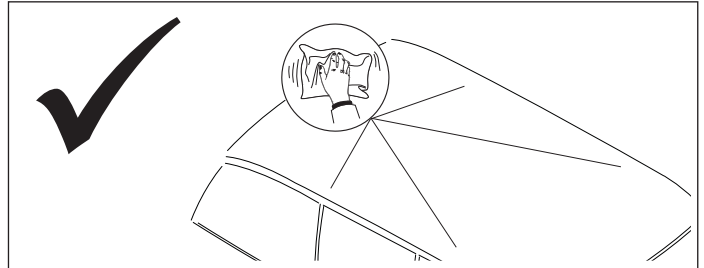
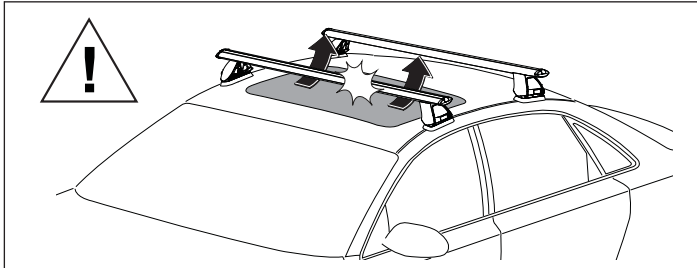
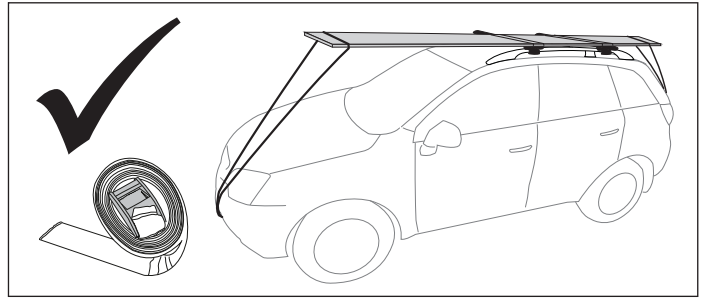
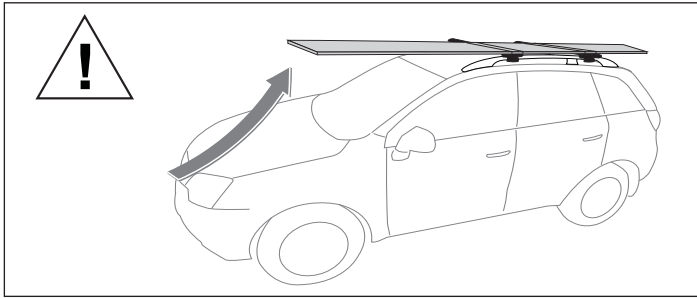

When these roof racks are to be used on a vehicle that is driven off sealed roads, the manufacturer maximum roof load rating (to be found in the vehicles User Manual) should be **divided by 1.5**. Do not forget to subtract the complete crossbar system weight from your maximum carrying capacity.

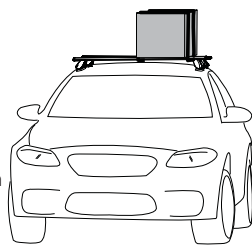

$$2 \text{ bars } 100\text{kg} \text{ (220lbs) load rating (Urban road)} = 2 \text{ bars } 66\text{kg} \text{ (145lbs) load rating (Off road)}$$

Load rating not taking into account crossbar weight - 5kg

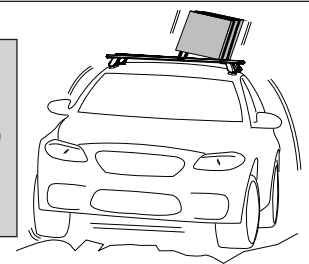

WARNING! Important Load Carrying Instructions

With utility vehicles, the cabin and the canopy move independently. Roof racks and vehicle can be damaged if the item transported is rigidly fixed at points on both the cabin and canopy. Instead, rigidly fix to either the cabin roof racks or the canopy roof racks.

NO

YES

YES

Paddle/ Surfboards should be fixed to the front of the vehicle.



RTS547 Toyota Tacoma

Parts List

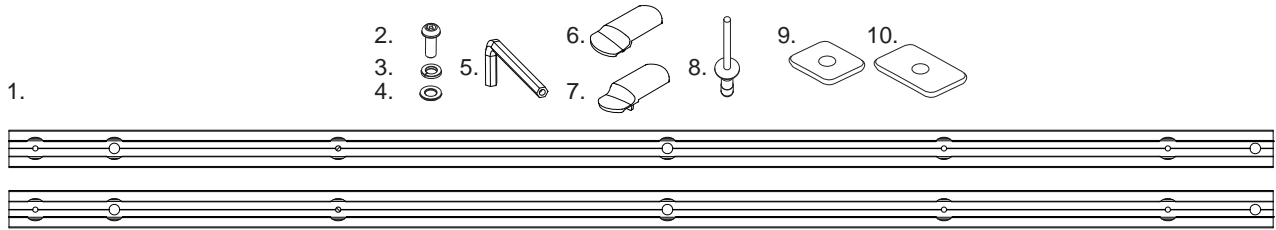

Item	RTS543 Kit	Qty	Part No.	6	End Cap FR, RR	2	M214
1	Tacoma Track Left and Right	2	A788	7	End Cap FL, RR	2	M215
2	M6 x 20mm Button Screw	6	B062	8	Rivet	8	H008
3	M6 Spring Washer	6	W004	9	Butyl Patch 4.5mm Hole	8	CA1397
4	M6 x 16mm Flat Washer	6	W031	10	Butyl Patch 5mm Hole	6	CA1266
5	5mm Allen Key	1	H021	11	Instructions	1	R1037

Tools Required:

1. Measuring Tape
2. Drill
3. 5mm Drill Bit
4. Drill Stop
5. Cold Galvanising Paint
6. Cotton Buds
7. Screwdriver
8. Clean Cloth
9. Marker
10. Vacuum Cleaner
11. File
12. Cutters

Note:

Crossbar and Leg Kits are sold as separate.

Preparing Vehicle

- 1** Move to the roof of the vehicle. Carefully pry out the Ditch Mould with a finger near the windshield. Lift the Mould out, releasing it from the retention clip in the front.

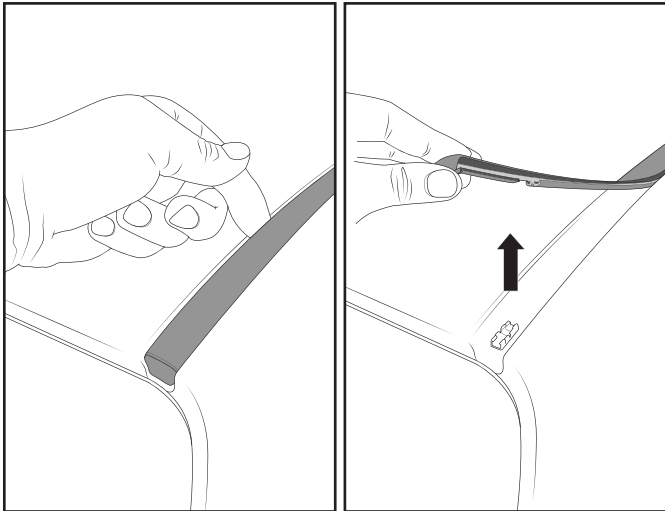

- 2** Release the Ditch Mould at the rear of the vehicle partially from the retention clip. Do not pull the Ditch Mould out past the Tooling Mark.

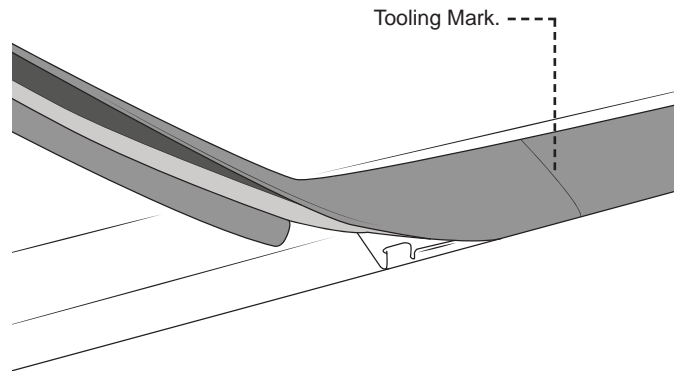

- 2** Locate the two Factory Seals from the front, middle and rear. Carefully remove the rear of the two seals as shown below.

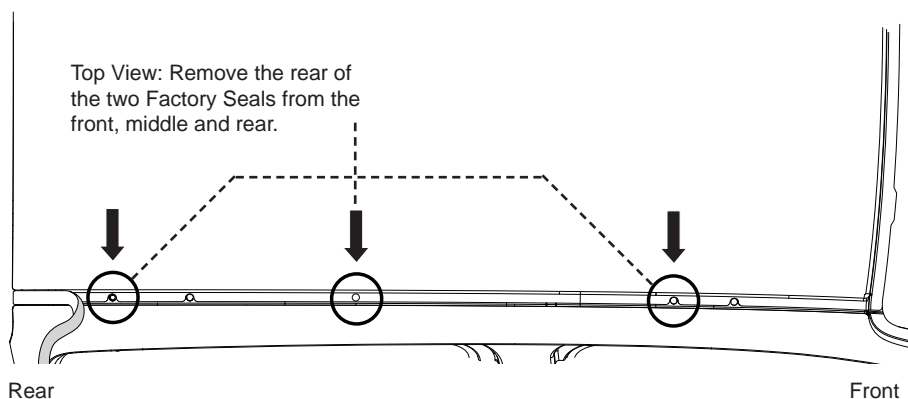

Peel the Seals away from the roof. A screwdriver can be used to pierce the Seal first. Careful not to mark the paintwork.

File the overlapping roof panel if shape of hole isn't round (due to varying build tolerances)

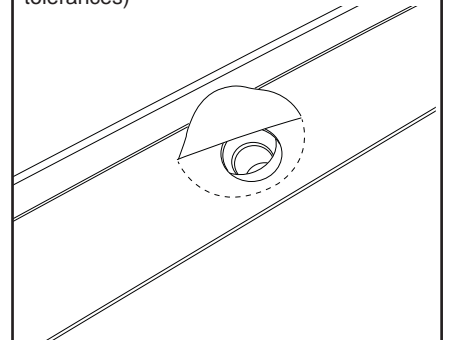



RTS547 Toyota Tacoma

3 Place the Tracks into the Roof Ditch. Be sure to use correct orientation.

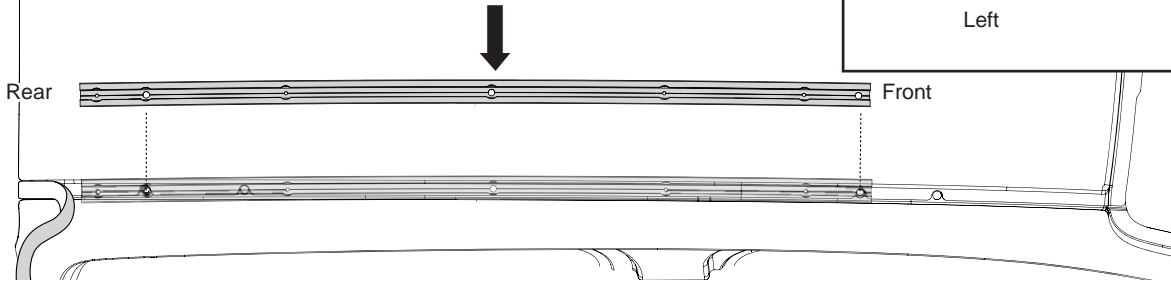
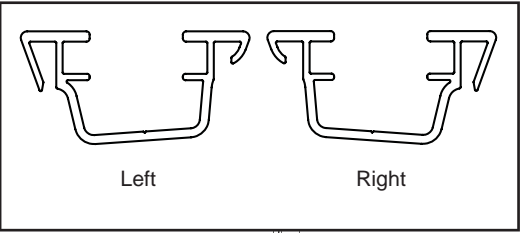

4 Place an M6 Button Screw with an M6 Spring and Flat Washer in the positions shown, front, middle and rear. Finger tighten at this stage.

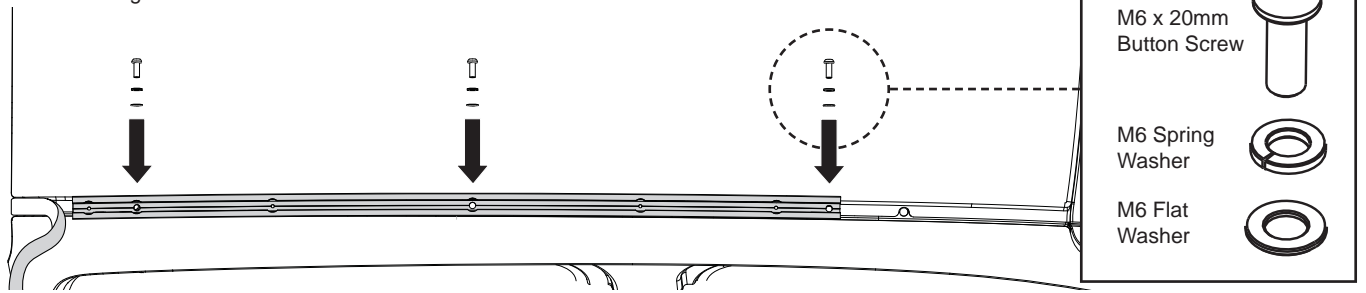

5 Using a 5mm (3/16") Drill Bit, spot mark each of the Rivet Holes in the Track onto the roof. Do not drill completely through the roof skin.

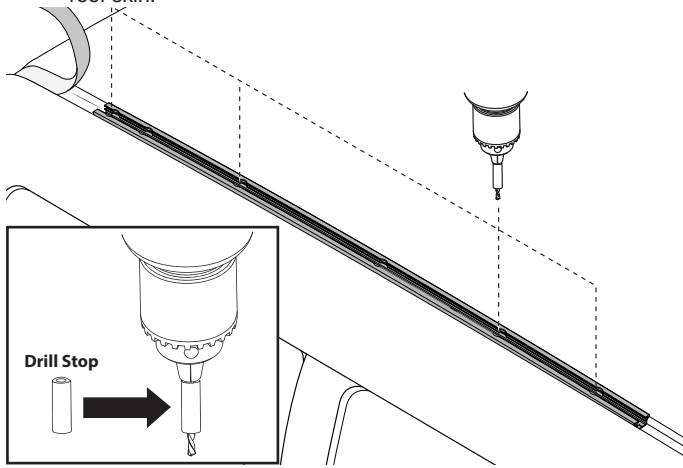

6 Remove the Track from the Roof. Drill out all spot marks with a 5mm (3/16") Drill Bit. Use a Drill Stop set to 5mm (3/16").

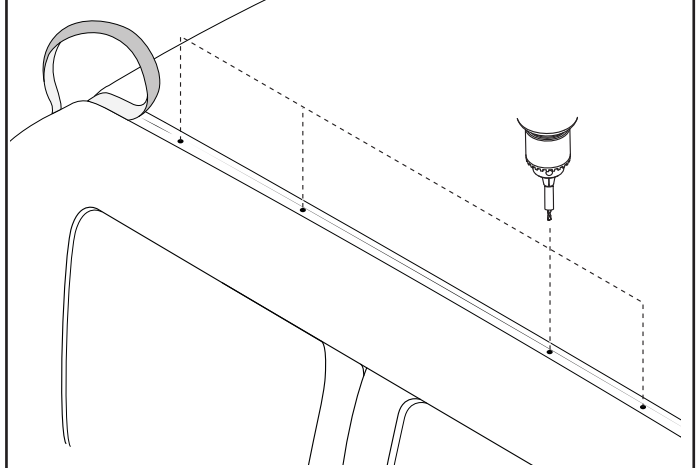

7 Vacuum any swarf from the roof.

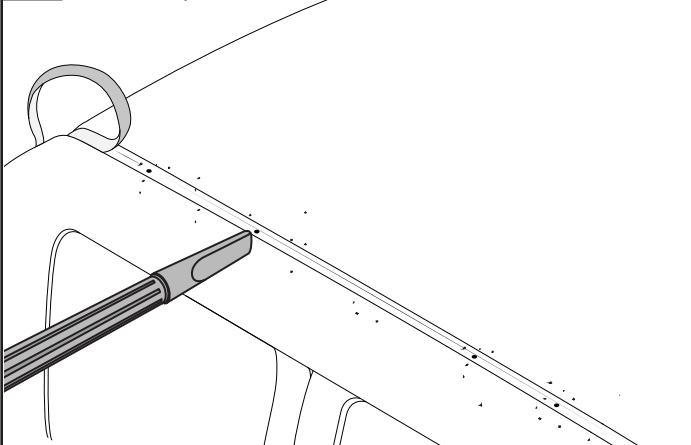

8 Use Cold Galvanising Paint on all holes drilled and any exposed body work.

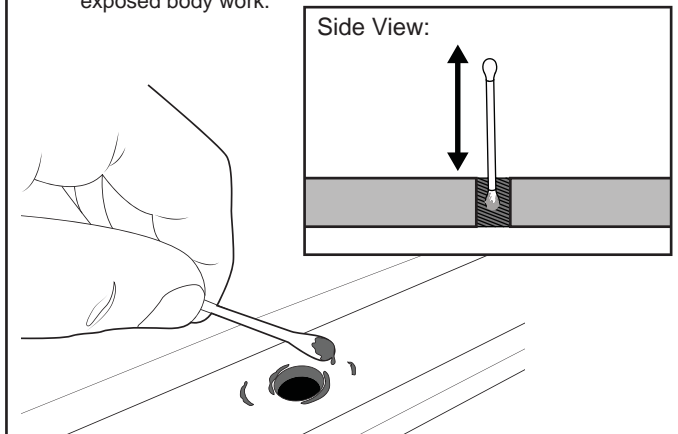



RTS547 Toyota Tacoma

9 Peel off the one side of backing tape on the Butyl Patches provided. Place these carefully over all holes drilled. Remove the top layer of backing tape as shown. **Item 9 over all drilled holes. Item 10 over exposed M6 threads.**

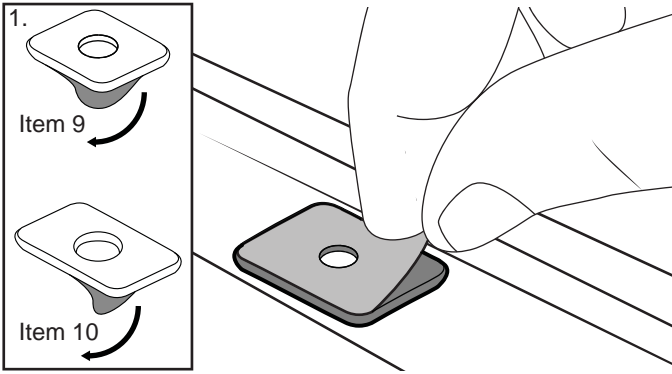

10 Remove backing tape from the Tracks.

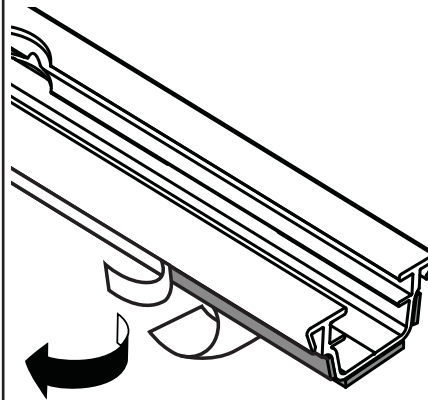

11 Place an M6 Button Screw with an M6 Spring and Flat Washer in the positions shown, front, middle and rear. Tighten with the Allen Key supplied.

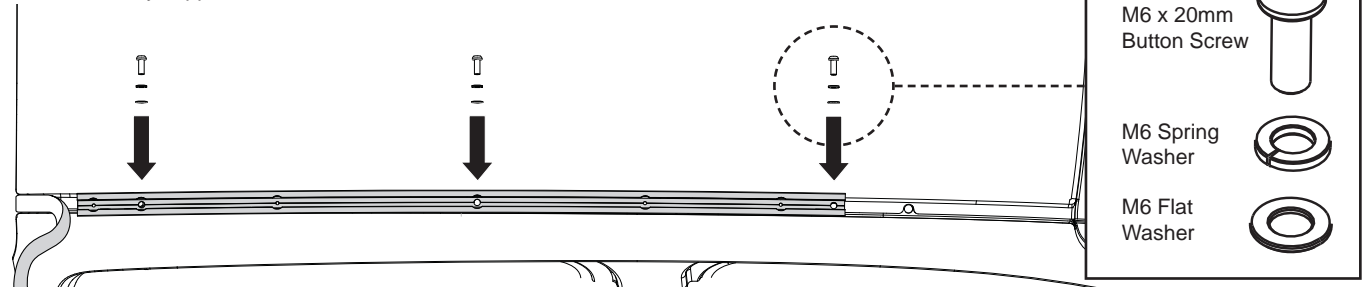

12 Rivet the Track in place. Be sure Rivets are seated correctly before depressing the Tool.

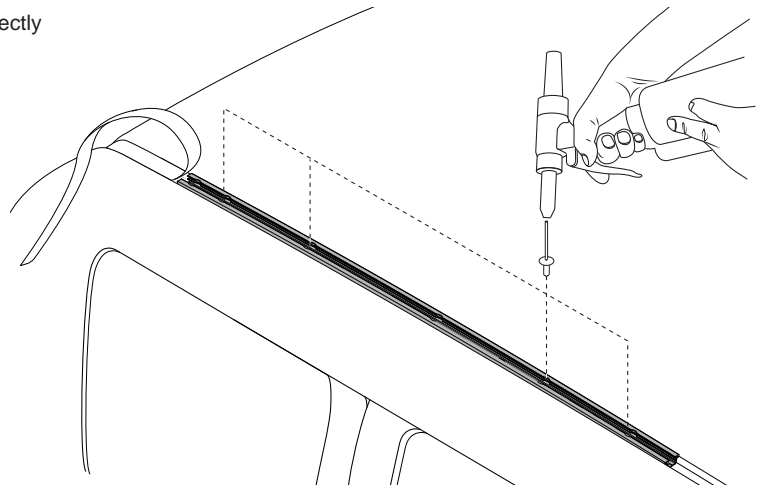

13 Measure and cut the Rubber at the front and rear of the Track 5mm (3/16") out as shown.

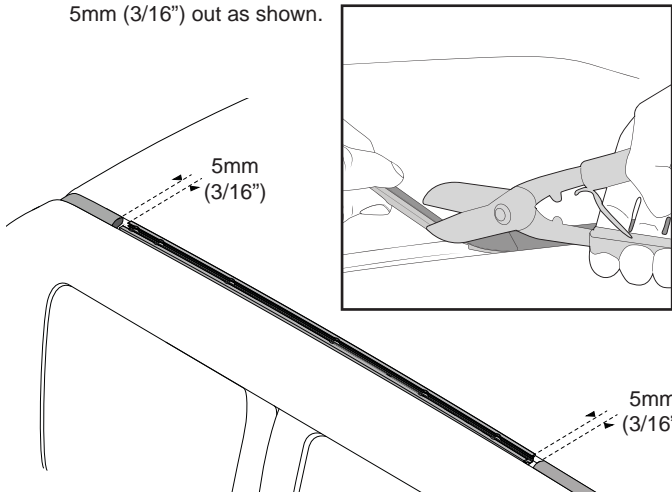

14 Insert the End Caps front an rear of the Track.

