



# RHINO-RACK

Aerodynamic & Heavy Duty Roof Rack Systems

## RLTF & RLTP Rhino Heavy Duty - Track Mount

Your Rhino-Rack is designed and manufactured in Australia to meet the requirements of Australian Standard AS1235-2000. Only use Rhino-Rack approved accessories.

Place these instructions in the vehicle's glove box after installation is complete.

**Important:** Please read these instructions carefully prior to installation. Please refer to your fitting instruction to ensure that the roof racks are installed in the correct locations. Check the contents of kit before commencing fitment and report any discrepancies.

### Parts List

Item	Component Name	Qty.	Part No.
1	Heavy Duty Rubber Buffer	2	-
2	Heavy Duty Crossbar	2	-
3	Heavy Duty Bar End Cap	4	M002
4	M10 Channel Nut	2	N024
5	M10 x 38mm x 2.5mm Flat Washer	2	W022
6	M10 Internal Shakeproof Washer	2	W021
7	M10 x 25mm Hex Bolt	2	B071
8	Track End Cap	4	M006
9	M6 x 35mm Button Head Security Screw	4	B092
10	M6 Spring Washer	4	W004
11	M6 x 12.5mm Flat Washer	4	W003
12	Track Mount Leg RLTF (M010) & RLTP (M057)	2	-
13	Wedges	4	M148
14	M6 x 21.43mm x 4.4mm Brass Hex Nut	4	N009
15	Track	2	-
16	M5 Security Allen Key & Handle	1	H011 & H013
17	Fitting Instruction	1	RR04

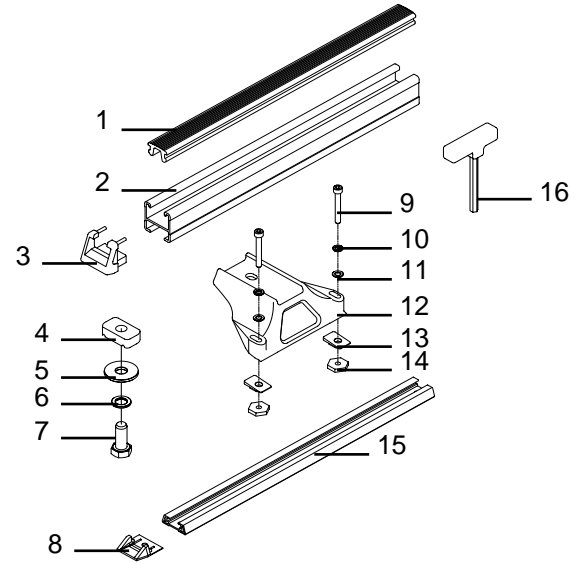

### Layout

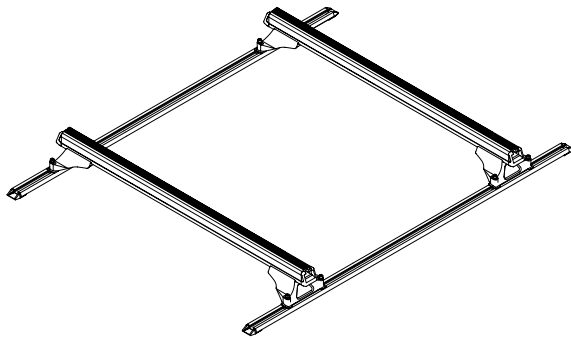

### Tools Required

Allen key, provided in kit  
Tape measure  
Marking pen  
5mm drill bit  
Drill  
Drill stop  
Vacuum cleaner  
Masking tape  
Rivet gun  
Galvanised paint  
Selleys Butyl Mastic  
Carton knife  
13mm socket

### Care Instructions

Before fitting the Heavy Duty Track Mount Wash and clean vehicle roof prior to installation.

Install crossbar onto legs. Push the leg hex bolt up and turn the bolt so that the channel nut is fully located across the crossbar.

1

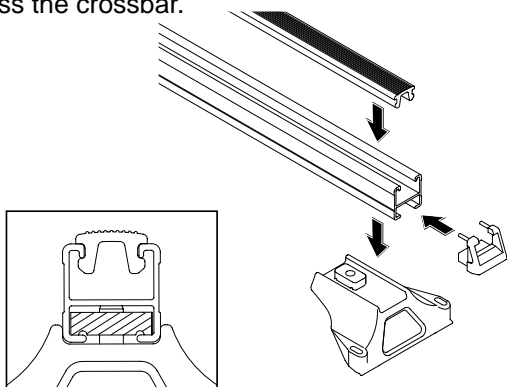

2

Assemble rack as shown, attaching the legs to the tracks. Finger tighten hex bolt as the legs will require adjustment when placed onto the vehicle.

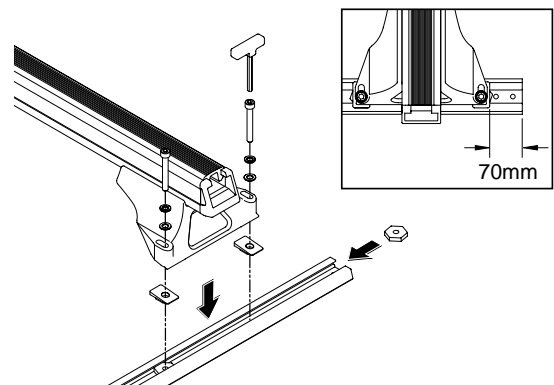

Locate masking tape where tracks are to be positioned. The tracks must be fitted as far apart as possible on the outer edge of the vehicle roof. The track must have full contact with the vehicle roof. Place the crossbar and leg assembly onto the roof. Once location has been decided check on underside of roof for clearance. Ensure crossbars are located as shown.

**3**

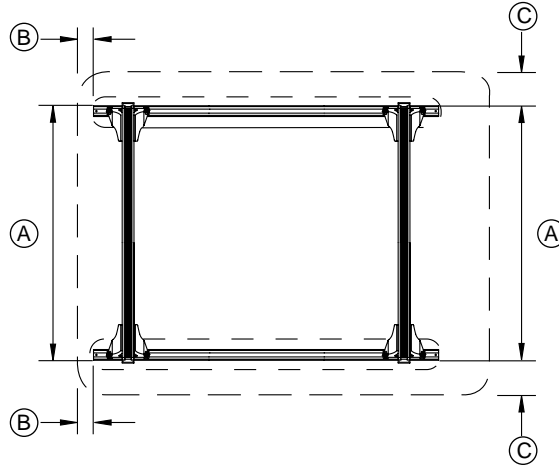

Mark track holes.

**4**

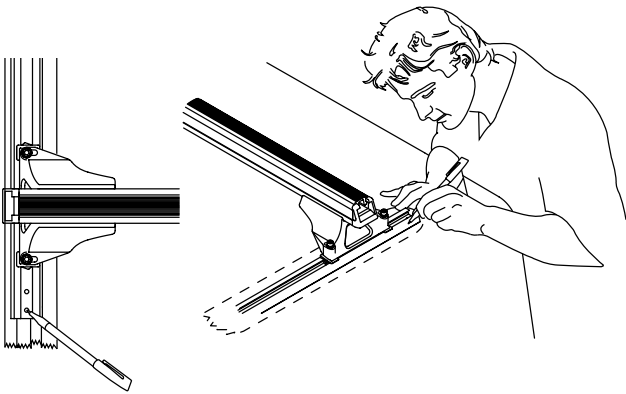

Remove rack from vehicle and crossbars from tracks. Drill holes using a 5mm drill bit. A drill stop is recommended to prevent drilling through roof lining. Vacuum vehicle roof to remove metal filings. Remove masking tape.

**5**

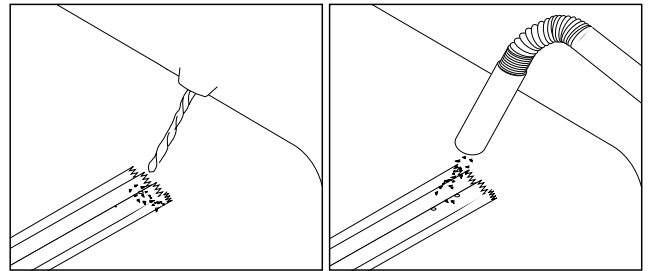

Apply galvanised paint then Selleys Butyl Mastic around holes. Remove paper gasket from foam tape on underside of track. Locate track end caps, place tracks onto vehicle roof and rivet as shown.

**6**

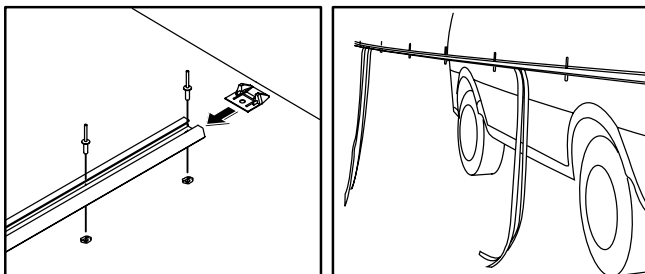

Re-attach crossbars to tracks as shown. Tighten security bolt to 3-4Nm. Tighten hex bolt to 4-5Nm.

**7**

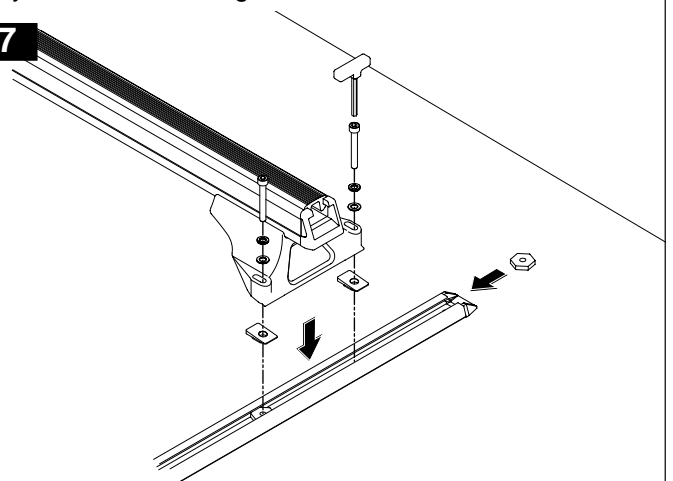

## Important Information

### **RECOMMENDATIONS**

Please refer to your vehicle manufacturers operating manual for maximum roof load rating.

It is essential that all bolt connections be checked after driving a short distance when you first install your Rhino-Rails Crossbars.

Bolt connections should be checked again at regular intervals (probably once a week is enough, depending on road conditions, usage, loads and distances travelled). You should also check the roof bars each time they are refitted.

Crossbars and accessories should be cleaned and all screw threads should be lubricated at regular intervals.

Rhino-Rack offers a 3 year warranty to the original purchaser of the Rhino-Rack rails roof rack system and Accessories.

Rhino-Rack cannot be held responsible for incorrect mounting of the roof rack system or for usage that exceeds vehicle and production tolerances.

Make sure to fasten your load securely.

Please ensure that all loads are evenly distributed and that the centre of gravity is kept as low as possible.

### **USE ONLY NON-STRETCH FASTENING ROPES OR STRAPS.**

### **SENSITIVITY TO CROSSWINDS, BEHAVIOUR IN CURVES AND BRAKING**

The handling characteristics of the vehicle change when you transport a load on the roof. For safety reasons, we recommend you exercise extreme care when transporting wind-resisting loads; special consideration must be taken into account when braking.

### **PLEASE REMOVE CROSSBARS WHEN PUTTING VEHICLE THROUGH AN AUTOMATIC CAR WASH**

### **LOAD RATINGS**

The vehicle manufactures recommended load rating is the maximum permissible load per pair of roof racks (include the weight of the roof rack, 5kg). When roof bars are to be used in extreme off-road conditions please build a safety factor of 1.5 into this maximum load limit. Although roof bars are tested and approved to AS1235-2000, Australian road conditions can be much more rigorous.

### **NOTE FOR FITTERS AND DEALERS**

It is your responsibility to ensure instructions are given to the end user or client.



# RHINO-RACK

## RTV Track Kit

**Important:** Please refer to your fitting instruction to ensure that the roof racks are installed in the correct locations. Check the contents of kit before commencing fitment and report any discrepancies. Place these instructions in the vehicle's glove box after installation is complete.

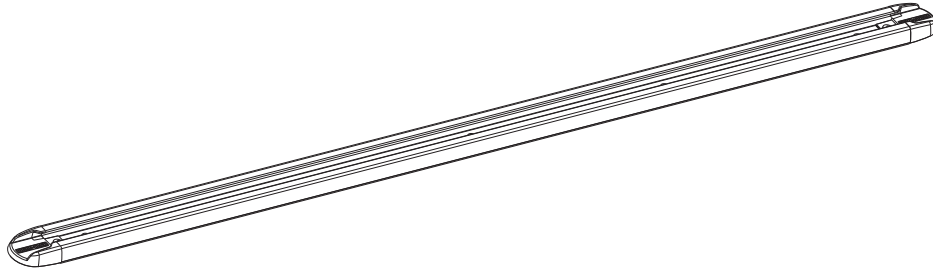

### Download your Vehicle Fitment Sheet

Individual fitment sheets exist for most vehicles available, they provide specific fitment information that is relevant to each individual vehicle. Fitment sheets can be downloaded from the Rhino-Rack Website under 'Fit My Car'.

Simply select the make and model of the vehicle, select the Pioneer tray of choice and click on instructions.

**Be sure to check the website to see you have latest version of your instructions before attempting the fitment.**

### Important Information

1.  Check Part No./Kit is correct
2.  Read through instruction before installing
3.  Fit roof rack accessory
4.  Check and recheck all fasteners are secure

**Maximum carrying capacity for the track system is 100kg (220lbs).**

**Please refer to your vehicle manufacturers handbook for the maximum roof loading of your vehicle, also check Rhino-Rack website 'fit my car' section for the latest rating . Always use lower of the two figures. Note: Be sure to check the Rhino-Rack website to see if you have the latest version of instructions before beginning installation.**

#### Recommendations:

It is essential that all bolt connections be checked after driving a short distance when you first install your crossbars. Bolt connections should be checked & lubricated at regular intervals (probably once a week is enough, depending on road conditions, usage, loads and distances travelled). You should also check the crossbars each time they are refitted. Make sure to fasten your load securely. Please ensure that all loads are evenly distributed and that the centre of gravity is kept as low as possible.

**Crossbars must be removed when putting vehicle through an automatic car wash.**

**Use only non-stretch fastening ropes or straps.**

**Caution:** The handling characteristics of the vehicle changes when you transport a load on the roof. For safety reasons we recommend you exercise extreme care when transporting wind-resistant loads. Special consideration must be taken into account when cornering and braking.

#### Load Ratings:

Maximum permissible load is 100kg (220lbs) for two crossbars including the weight of the crossbars, 5kg (11lbs). When crossbars are to be used in off-road conditions, please build a safety factor of 1.5 into this load limit for off-road use, two crossbars = 66kg (145lbs). Although the crossbars are tested and approved to AS1235-2000, Off-road conditions can be much more rigorous. However, increasing the number of crossbars does not increase the vehicles maximum permissible roof loading.

#### Note for Dealers and Fitters:

It is your responsibility to ensure instructions are given to the end user or client.



# RTV Track Kit

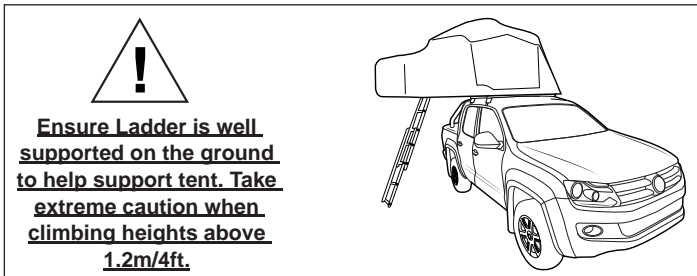
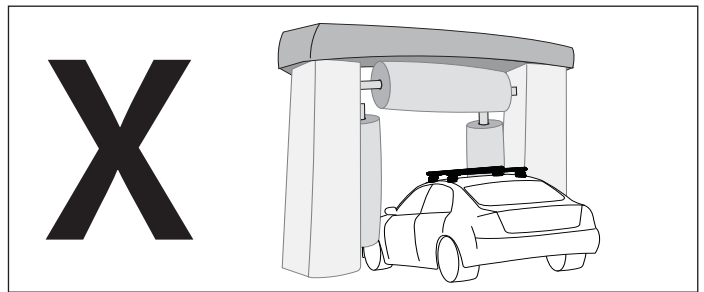
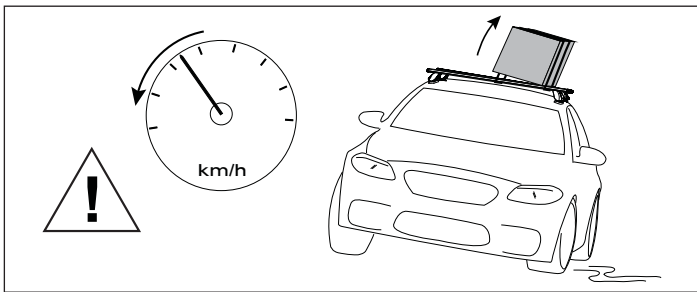
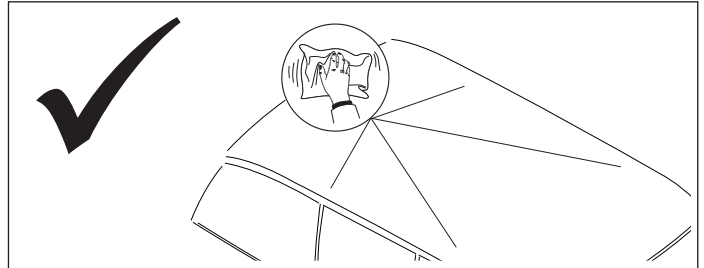
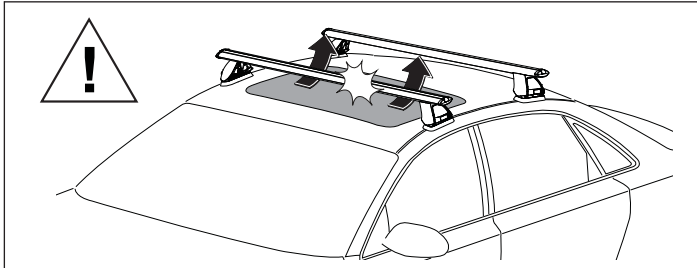
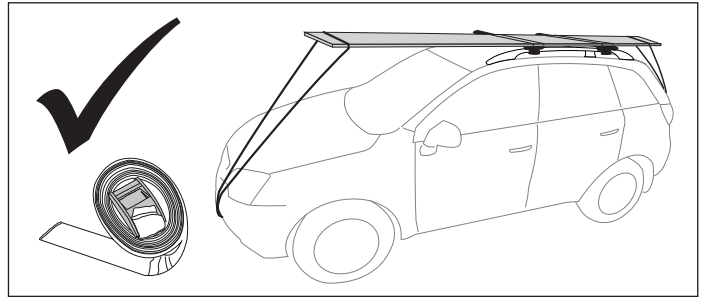
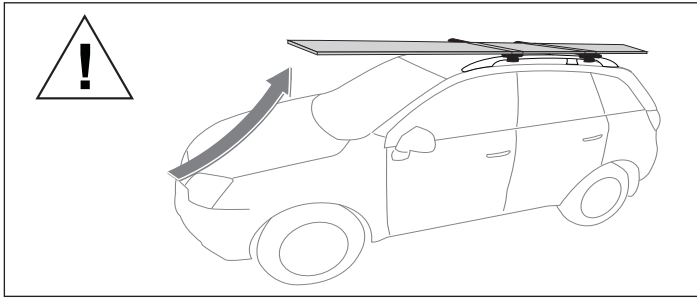

**Ensure Ladder is well supported on the ground to help support tent. Take extreme caution when climbing heights above 1.2m/4ft.**

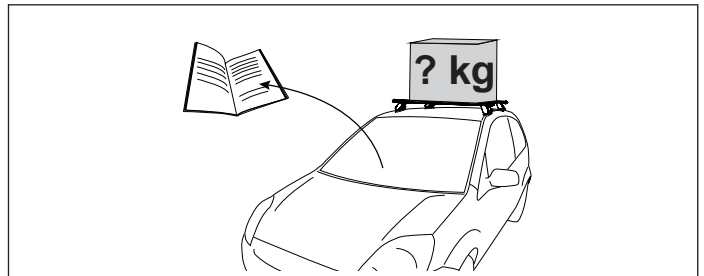

When these roof racks are to be used on a vehicle that is driven off sealed roads, the manufacturer maximum roof load rating (to be found in the vehicles User Manual) should be **divided by 1.5**. Do not forget to subtract the complete crossbar system weight from your maximum carrying capacity.

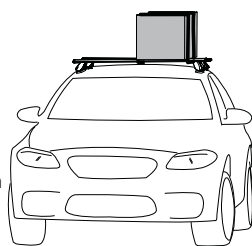

**100kg/220lbs**  
(Urban Road)

=

**67kg/147lbs**  
(Off Road)

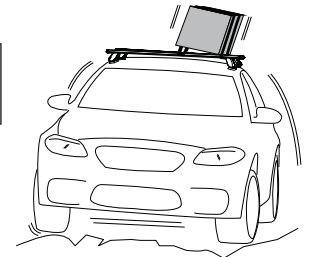

## WARNING! Important Load Carrying Instructions

With utility vehicles, the cabin and the canopy move independently. Roof racks and vehicle can be damaged if the item transported is rigidly fixed at points on both the cabin and canopy. Instead, rigidly fix to either the cabin roof racks or the canopy roof racks.

**X**  
NO

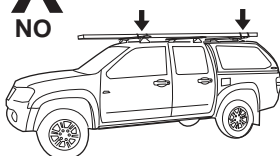

**✓**  
YES

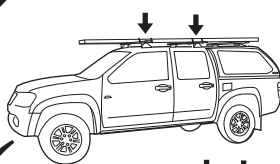

**✓**  
YES

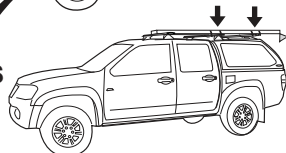

Paddle/ Surfboards should be fixed to the front of the vehicle.

**✓**  
YES

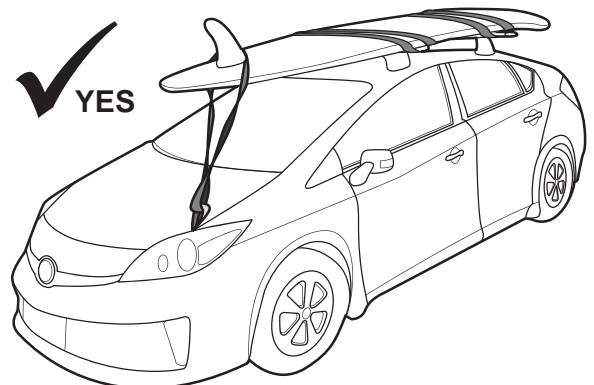



# RTV Track Kit

## Parts List

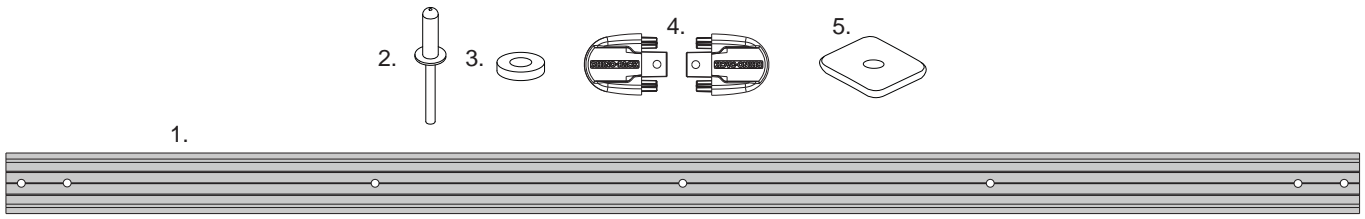

Item	RTV Kit	Qty	Part No.
1	RTV Track (various sizes, vehicle dependant)	2	A727-A736
2	Rivet	14-30	H004
3	Rivet Spacer	1	CA1555
4	End Cap	4	M768
5	Butyl Patch	14-30	CA1397
6	Instructions	1	R865

### Tools Required:

1. Measuring Tape
2. Drill
3. 5mm Drill Bit
4. Drill Stop
5. Masking Tape

6. Rivet Gun
7. Cold Galvanising Paint
8. Cotton Buds
9. Clean Cloth
10. Marker
11. Vacuum Cleaner

### Note:

**Crossbar and Leg Kits are sold as separate.** Leg Spacer kits may be required for more than two crossbars.

## Preparing Vehicle

- 1** Move to the roof of the vehicle. Use a clean cloth and remove any dirt and debris from the roof ditch in the approximate working area. **Apply masking tape in this area.**

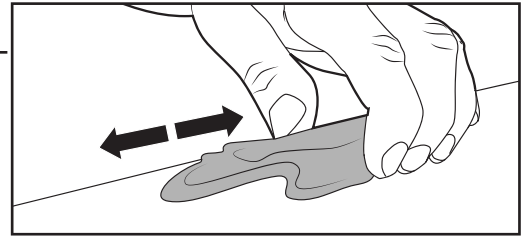
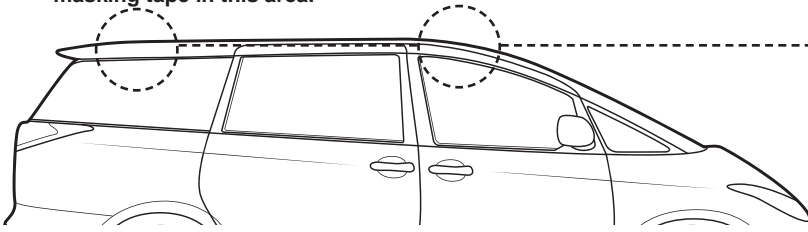

- 2** Tape up the approximate working area on the roof. Sit the Track Assembly onto the Tape (assistance may be required). The Tracks must be fitted as far apart as possible on the outer edge of the vehicle roof, adjust tape as required. The track must have full contact with the vehicle roof. Ensure the Assembly sits evenly spaced on the roof. Once location has been decided check on underside of roof for clearance. Check the Rhino-Rack website for any existing fitment positions.

Top View: **For reference only** - Actually points used to align the Track Assembly will vary from vehicle to vehicle.

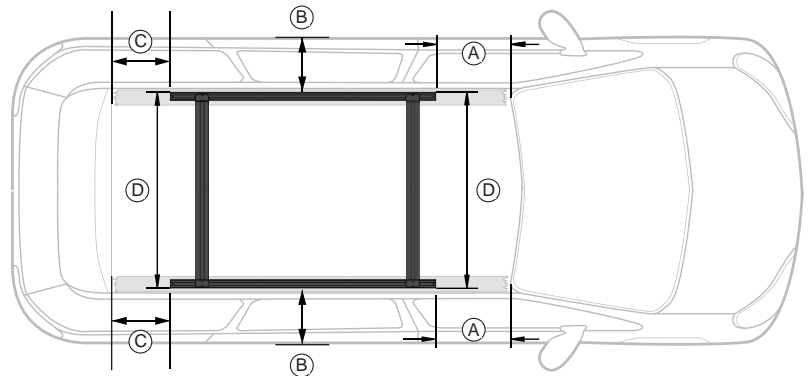

- 3** Use a Marker and create a reference point on the Masking Tape at all Rivet holes in the Track. Remove the Track and drill through the roof at these points as shown.

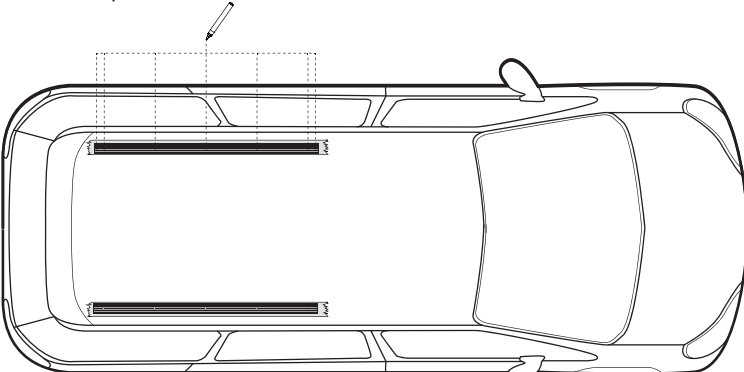

Use a 5mm Drill Bit, with a Drill Stop set to 5-7mm.

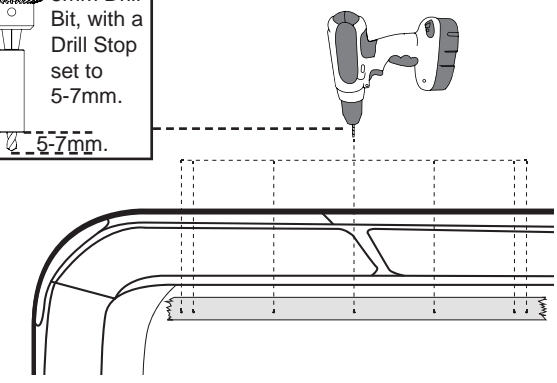



# RTV Track Kit

**4** Vacuum any swarf from the area.

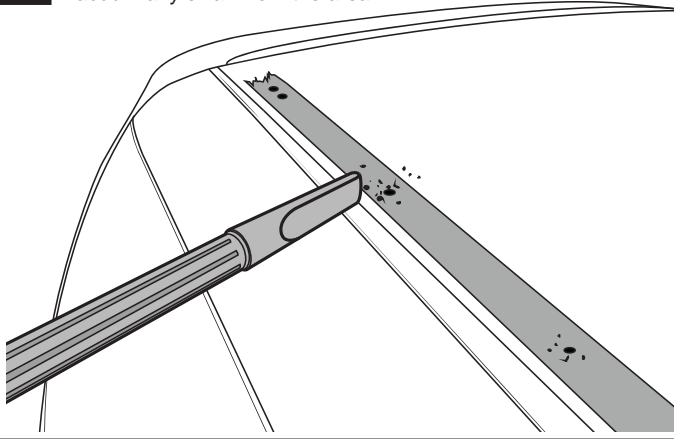

**5** Remove the Masking Tape. Using Cold Galvanising Paint, cover all drilled areas and any exposed body work.

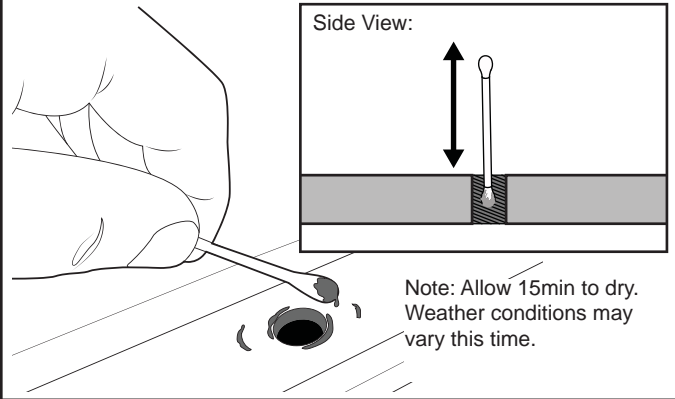

**6** Peel off the one side of backing tape on the Butyl Patches provided. Place these carefully over all holes drilled. Remove the top layer of backing tape as shown.

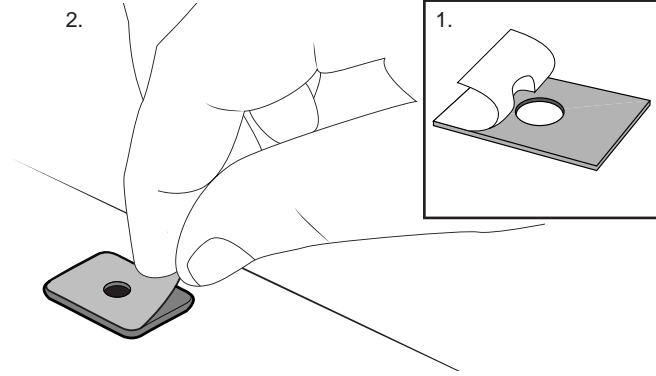

**7** Insert the End Caps and hold in place with Rivets. Place a Rivet in each of the holes along the Track.

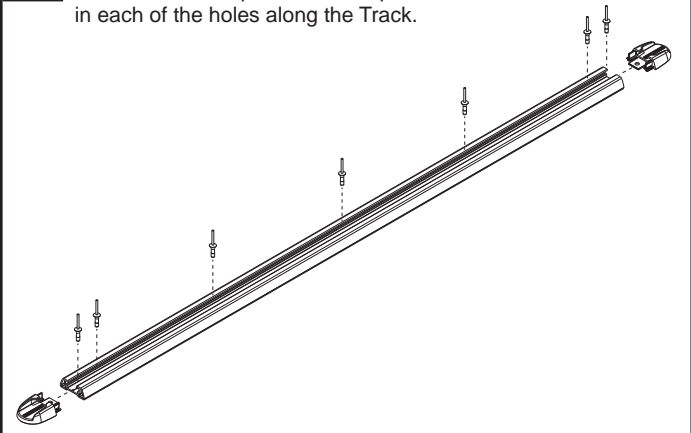

**8** Using either a Pneumatic or Concertina type Rivet Gun (not a small hand gun), rivet the Track into place. Make sure all Rivets are seated firmly onto the base of the Track, place the Rivet Gun onto the Rivet with a Rivet Spacer and gently tap on the back ensures the rivet is seated before compressing. **Check Track alignment carefully before starting. Start at the front and move towards the rear.**

**Note:** The Track will stand high at the rear when installing from the front. Minor force will be needed to flex the Track down while riveting.

Place the Rivet Gun Spacer over the Rivet before fixing in place. This will prevent the Rivet Gun scratching the Tracks.

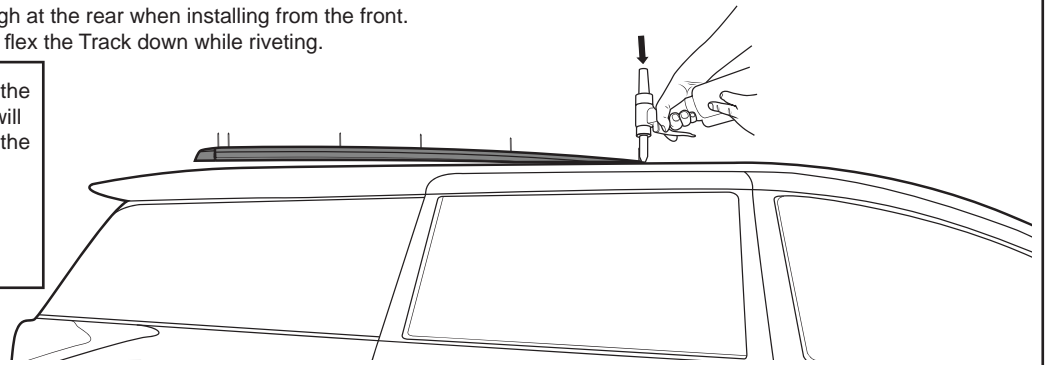
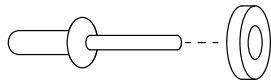

## Install Crossbars as per instructions

**Note** It is recommended to space crossbars 600mm-700mm apart.

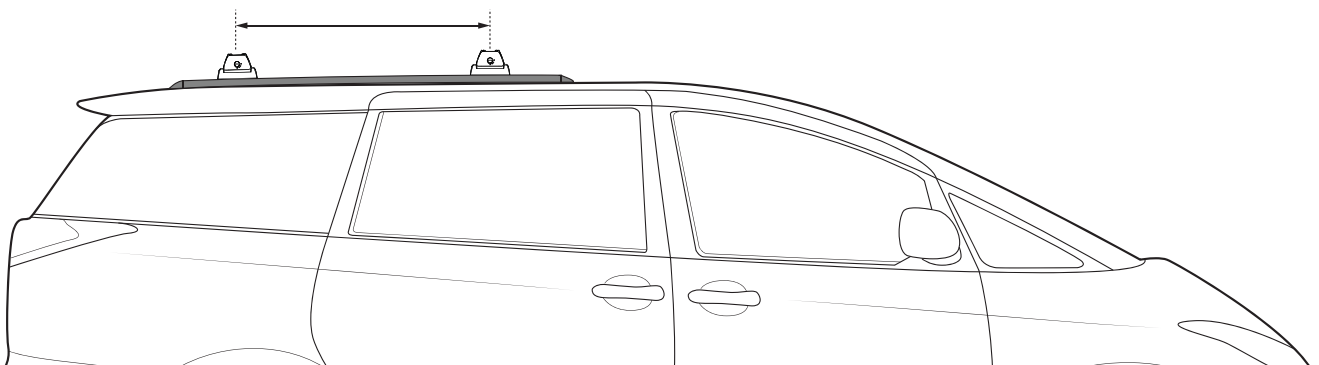



# RHINO-RACK

## VA-FK1

Item	Component Name	Qty	Part No.
1	M6 Nut 30x25mmx5mm	2	N035A
2	Adapter Block	2	M154
3	RCP Leg 3000 32x 3 Square Washer Mech	2	W037
4	M6 Spring Washer	2	W004
5	M6x35 Hex Setscrew	2	B203

**\*Note:**

RL Kit parts are sold separately.

**Tools Required:**

10mm Wrench

