

WARNING: Under no circumstances do we recommend exceeding the towing vehicle manufacturers recommended vehicle towing capacity.

READ ALL INSTRUCTIONS BEFORE STARTING THE INSTALLATION

REESE® Custom Quick Install mounting brackets only include the hardware to attach the custom brackets to the frame.

10 BOLT INSTALLATION

Equipment Required:

Fastener Kit: 56007F

Wrenches: 3/4", 15/16"

Drill Bits: 1/8", 9/16"

Other Tools: Center Punch, Measuring Tape, 3/8" Allen Head Socket

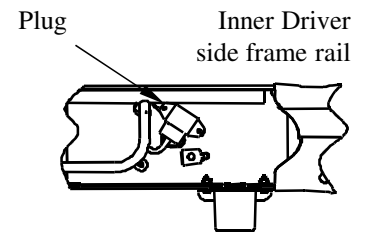
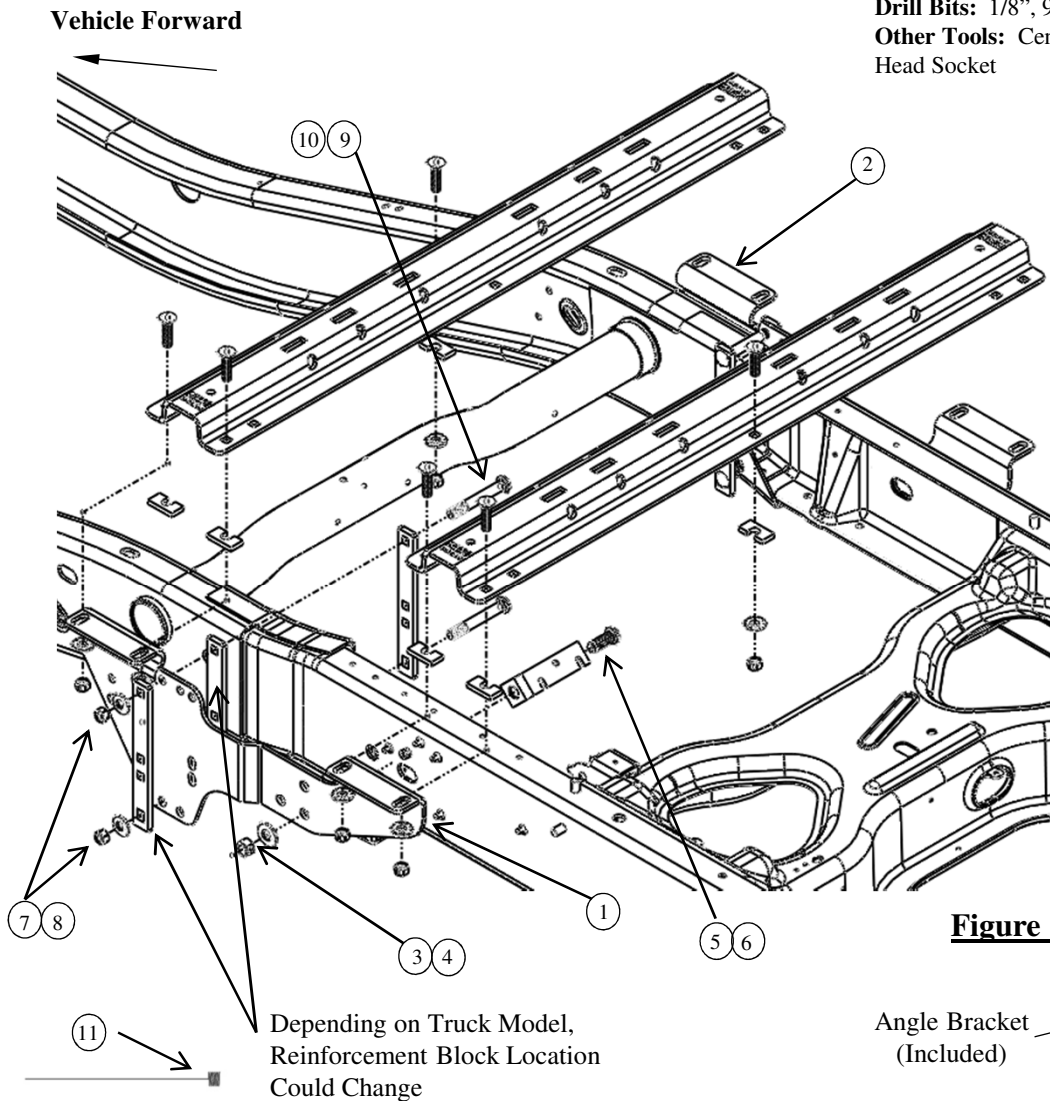

Figure 2a

Inside driver side frame rail

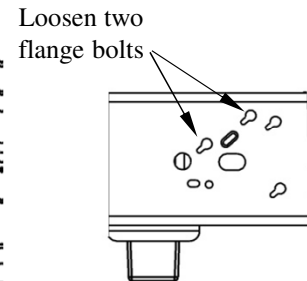

Figure 2b

Outside driver side frame rail

Figure 1

Angle Bracket
(Included)

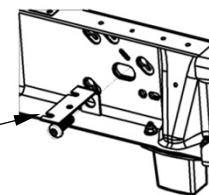

Figure 2c

| # | Description | QTY | # | Description | QTY |
|---|-------------------------------------|-----|----|------------------------------------|-----|
| 1 | Driver Side Mounting Bracket | 1 | 7 | 1/2"-13 Hex Nut | 4 |
| 2 | Passenger Side Mounting Bracket | 1 | 8 | 1/2" Conical Washer | 4 |
| 3 | 5/8"-11 Hex Nut | 2 | 9 | 1/2"-13 X 5.5" Gr. 8 Carriage Bolt | 4 |
| 4 | 5/8" Conical Washer | 2 | 10 | Reinforcement Block | 4 |
| 5 | Angle Bracket | 1 | 11 | 5/8" Pull Wire | 2 |
| 6 | 5/8"-11 Gr. 8 Button Head Cap Screw | 2 | 12 | 5/8" Flat Washer | 2 |

Any hardware shown in Figure 1, but not described in table below were supplied with 30153 kit.

- **Do not install mounting rails over plastic bed liners. Plastic bed liners must be cut out of the way to provide metal to metal contact. Mounting rails may be installed on spray in liners.**
- **Use only bolts, nuts, and washers supplied to install this kit. All bolts and nuts are Grade 8 unless otherwise specified.**
- **These instructions are guidelines only, actual installation is the responsibility of the installer and the owner. Always measure truck and trailer before installing hitch to be sure that there is clearance at the cab and at the bumper to allow for turns.**
- **Do not install this product on or attempt to tow with a truck with a 5-1/2' bed unless a sidewinder pinbox coupler has been installed on the trailer.**

Warning!!

When installing to Figure 1 & 6, during drilling protect the fuel tank and filler tubes, brake lines and wire harness by placing a piece of metal between the box floor and potential components at risk on the driver's side. This will prevent drilling into these items.

Installation Instructions

1. Lower and remove spare tire. Remove exhaust heat shield from the underneath the passenger side of the vehicle.
2. **On Pickups with OE Trailer Brake Controller:** Relocate the electrical plug that is located on the inside of the driver's side frame rail over the rear wheel (Figure 2a). The plug may be removed from the frame by loosening the two bolts on the outside of the frame and pushing the bolt heads through the key hole slots, as shown in Figure 2b. Attach the plug to the angle bracket supplied with the mounting kit. The bracket will be attached to the inside of the frame with a 5/8" bolt at a later installation step.
3. Place one mounting rail in the bed of the vehicle. Center the rail on the floor of the truck bed and use your tape measure to locate the proper distance from the rail to the rear edge of the truck box as illustrated.
4. Use a center punch to mark the holes in the rail per the illustration. Move the rail out of the way and drill each position with a 1/8" drill bit. **Note: When drilling holes through the bed be sure what is below the truck bed in those locations.**
5. Temporarily position the frame brackets on the sides of the frame and check that the 1/8" drilled holes align with the slots in the frame brackets. Remove the frame brackets from the vehicle.
6. Enlarge the 1/8" drilled holes to 9/16".
7. Fasten the frame brackets to the vehicle frame rails as shown in Figure 1. Pass the cap head bolt (6) through the 5/8" conical washer (4) and then the rearward slot interior of the truck frame. Place the mounting bracket (1), 5/8" conical washer (4), and the 5/8" nut (3) on and hand tighten. On Pickups with OE Brake Controller, refer to installation step 2 to relocate the plug with the angle bracket. Use the cap head bolt (6) to attach the angle bracket to the inside of the frame (see Figure 2c), the angle bracket will go between the flat washer and the frame
8. Passing the 1/2" carriage bolts (9) through the top and bottom slots in the reinforcement block (10) will create a clamping strap that will go inside the frame rail and connect to the mounting bracket. There are two different sets of holes in the mounting bracket that allow for the best clamping surface to the truck frame. Changing the mounting bracket holes will allow the clamping strap to move truck forward or rearward. Once the strap bolts have been passed through the best mounting holes thread the reinforcement block (10), 1/2" conical washer (8), and the 1/2" nut on to the bolts and hand tighten.
9. On some model years of trucks there could be a large gap between the truck frame and the inside face of the mounting bracket. If that is true for your truck, remove the nuts and washers from the previous step, remove the reinforcement block from the outside of the bracket and thread it on the strap bolts on the inside of the mounting bracket. Pass 1/2" bolts through the correct holes, thread washers and nuts back into place and re-hand tighten.
10. Reposition the mounting rail over the holes in the bed and fasten the mounting rail to the frame brackets using the hardware supplied with the rail kit. Use the U-shaped blocks between the frame bracket or mounting rails and the truck bed to ensure metal to metal contact. Install center bolt and hand tighten.
11. Place the unassembled 5th wheel support arches/slider/goose into the already installed mounting rail. Position the rearward mounting rail with the support arches/slider/goose by inserting the tabs into the mounting rail and pushing the mounting rail tight towards the other mounting rail. Ensure that the mounting rail is centered on the bed of the vehicle. This will position the rail in the correct location and ensure that the 5th wheel will have a snug fit to the truck. **Note:** If more than one hitch product will be used with the mounting rails then both types should be used at the same time to align the rearward mounting rail. This will ensure that one product does not compromise the fit of the other.
12. Repeat installation steps 4, 6 and 10 for the remaining rail.
13. Starting with the hardware that fasten the mounting brackets to the bed rails and torque all the nuts. Torque the 1/2" fasteners to 110ft-lbS (149N*M), and the 5/8" bolts to 212 ft-lbs (287N*M).
14. Re-install spare tire.

Installation Instructions

REESE® CUSTOM QUICK INSTALL MOUNTING KIT

FOR 30153 REESE® RAILS ONLY

1999-2007 "Classic" -1500/2500 Light Duty GM Pickups

Part Number:

56007

WARNING: Under no circumstances do we recommend exceeding the towing vehicle manufacturers recommended vehicle towing capacity.

READ ALL INSTRUCTIONS BEFORE STARTING THE INSTALLATION

REESE® Custom Quick Install mounting brackets only include the hardware to attach the custom brackets to the frame.

10 BOLT INSTALLATION

Equipment Required:

Fastener Kit: 56007F

Wrenches: 15/16"

Drill Bits: 1/8", 9/16"

Other Tools: Center Punch, Measuring Tape, 3/8" Allen Head Socket

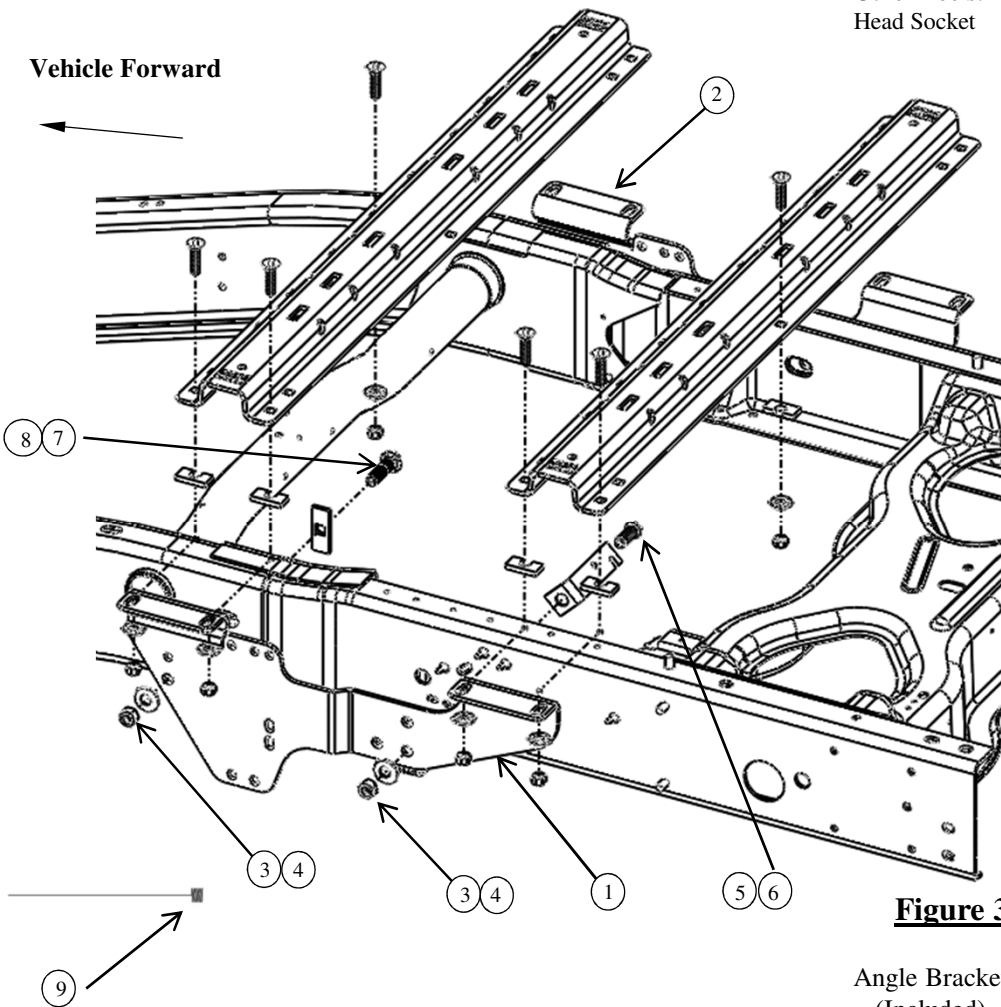

Figure 3

Angle Bracket
(Included)

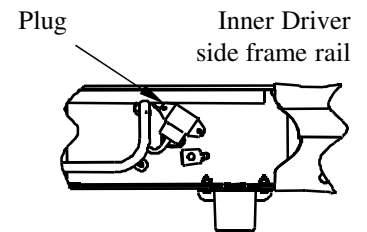

Figure 4a

Inside driver side frame rail

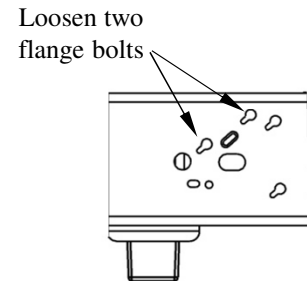

Figure 4b

Outside driver side frame rail

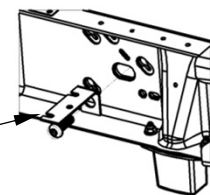

Figure 4c

Any hardware shown in Figure 1, but not described in table below were supplied with 30153 kit.

| # | Description | QTY | # | Description | QTY |
|---|--------------------------------|-----|----|-------------------------------------|-----|
| 1 | Driver Side Mounting Bracket | 1 | 6 | 5/8"-11 Gr. 8 Button Head Cap Screw | 2 |
| 2 | Passenger Side Mouting Bracket | 1 | 7 | 5/8"-11X2.5 Gr. 8 Carriage Bolt | 2 |
| 3 | 5/8"-11 Hex Nut | 4 | 8 | Carriage Block | 2 |
| 4 | 5/8" Concial Washer | 4 | 9 | 5/8" Pull Wire | 4 |
| 5 | Angle Bracket | 1 | 10 | 5/8" Flat Washer | 2 |

- **Do not install mounting rails over plastic bed liners. Plastic bed liners must be cut out of the way to provide metal to metal contact. Mounting rails may be installed on spray in liners.**
- **Use only bolts, nuts, and washers supplied to install this kit. All bolts are Grade 8 unless otherwise specified.**
- **These instructions are guidelines only, actual installation is the responsibility of the installer and the owner. Always measure truck and trailer before installing hitch to be sure that there is clearance at the cab and at the bumper to allow for turns.**
- **Do not install this product on or attempt to tow with a truck with a 5-1/2' bed unless a sidewinder pinbox coupler has been installed on the trailer.**

Warning!!

When installing to Figure 3 & 6, during drilling protect the fuel tank and filler tubes, brake lines and wire harness by placing a piece of metal between the box floor and potential components at risk on the driver's side. This will prevent drilling into these items.

Installation Instructions

1. Lower and remove spare tire. Remove exhaust heat shield from the underneath the passenger side of the vehicle.
2. **On Pickups with OE Trailer Brake Controller:** Relocate the electrical plug that is located on the inside of the driver's side frame rail over the rear wheel (Figure 4a). The plug may be removed from the frame by loosening the two bolts on the outside of the frame and pushing the bolt heads through the key hole slots, as shown in Figure 4b. Attach the plug to the angle bracket supplied with the mounting kit. The bracket will be attached to the inside of the frame with a 5/8" bolt at a later installation step.
3. Place one mounting rail in the bed of the vehicle. Center the rail on the floor of the truck bed and use your tape measure to locate the proper distance from the rail to the rear edge of the truck box as illustrated on page 7.
4. Use a center punch to mark the holes in the rail per the illustration. Move the rail out of the way and drill each position with a 1/8" drill bit. **Note: When drilling holes through the bed be sure what is below the truck bed in those locations.**
5. Temporarily position the frame brackets on the sides of the frame and check that the 1/8" drilled holes align with the slots in the frame brackets. Remove the frame brackets from the vehicle.
6. Enlarge the 1/8" drilled holes to 9/16".
7. Fasten the frame brackets to the vehicle frame rails as shown in Figure 3. Pass the cap head bolt (6) through the conical washer (4) and then the rearward slot interior of the truck frame. Place the mounting bracket (1), conical washer (4), and the nut (3) on and hand tighten. On Pickups with OE Brake Controller, refer to installation step 2 to relocate the plug with the angle bracket. Use the cap head bolt (6) to attach the angle bracket to the inside of the frame (see Figure 4c), the angle bracket will go between the flat washer and the frame.
8. The forward slot of the truck frame will require using the supplied wire pull (9) to install the carriage bolt to the interior of the truck frame. Pass the wound end of the wire through the exterior of the frame, pulling it enough to thread the rectangular carriage block (8) and the 5/8" carriage bolt (7) on to the wire pull. Pulling the wire pull back through the frame will allow the installation of the mounting bracket, conical washer (4) and the nut (3). Hand tighten the nut in place.
9. Reposition the mounting rail over the holes in the bed and fasten the mounting rail to the frame brackets using the hardware supplied with the rail kit. Use the U-shaped blocks between the frame bracket or mounting rails and the truck bed to ensure metal to metal contact. Install center bolt and hand tighten.
10. Place the unassembled 5th wheel support arches/slider/goose into the already installed mounting rail. Position the truck forward mounting rail with the support arches/slider/goose by inserting the tabs into the mounting rail and pushing the mounting rail tight towards the other mounting rail. Ensure that the mounting rail is centered on the bed of the vehicle. This will position the rail in the correct location and ensure that the 5th wheel will have a snug fit to the truck. **Note:** If more than one hitch product will be used with the mounting rails then both types should be used at the same time to align the rearward mounting rail. This will ensure that one product does not compromise the fit of the other.
11. Repeat installation steps 4, 6 and 9 for the forward rail.
12. Starting with the hardware that fasten the mounting brackets to the bed rails and torque all the nuts. Torque the 1/2" fasteners to 110ft-lbS (149N*M), and the 5/8" bolts to 212 ft-lbs (287N*M).
13. Re-install spare tire.

Installation Instructions

REESE® CUSTOM QUICK INSTALL MOUNTING KIT

FOR 30153 REESE® RAILS ONLY

2007 & Up “New Body Style” 1500 GMC Pickups

Part Number:
56007

WARNING: Under no circumstances do we recommend exceeding the towing vehicle manufacturers recommended vehicle towing capacity.

READ ALL INSTRUCTIONS BEFORE STARTING THE INSTALLATION

REESE® Custom Quick Install mounting brackets only include the hardware to attach the custom brackets to the frame.

10 BOLT INSTALLATION

Equipment Required:

Fastener Kit: 56007F

Wrenches: 3/4", 15/16"

Drill Bits: 1/8", 9/16"

Other Tools: Center Punch, Measuring Tape, 3/8" Allen Head Socket

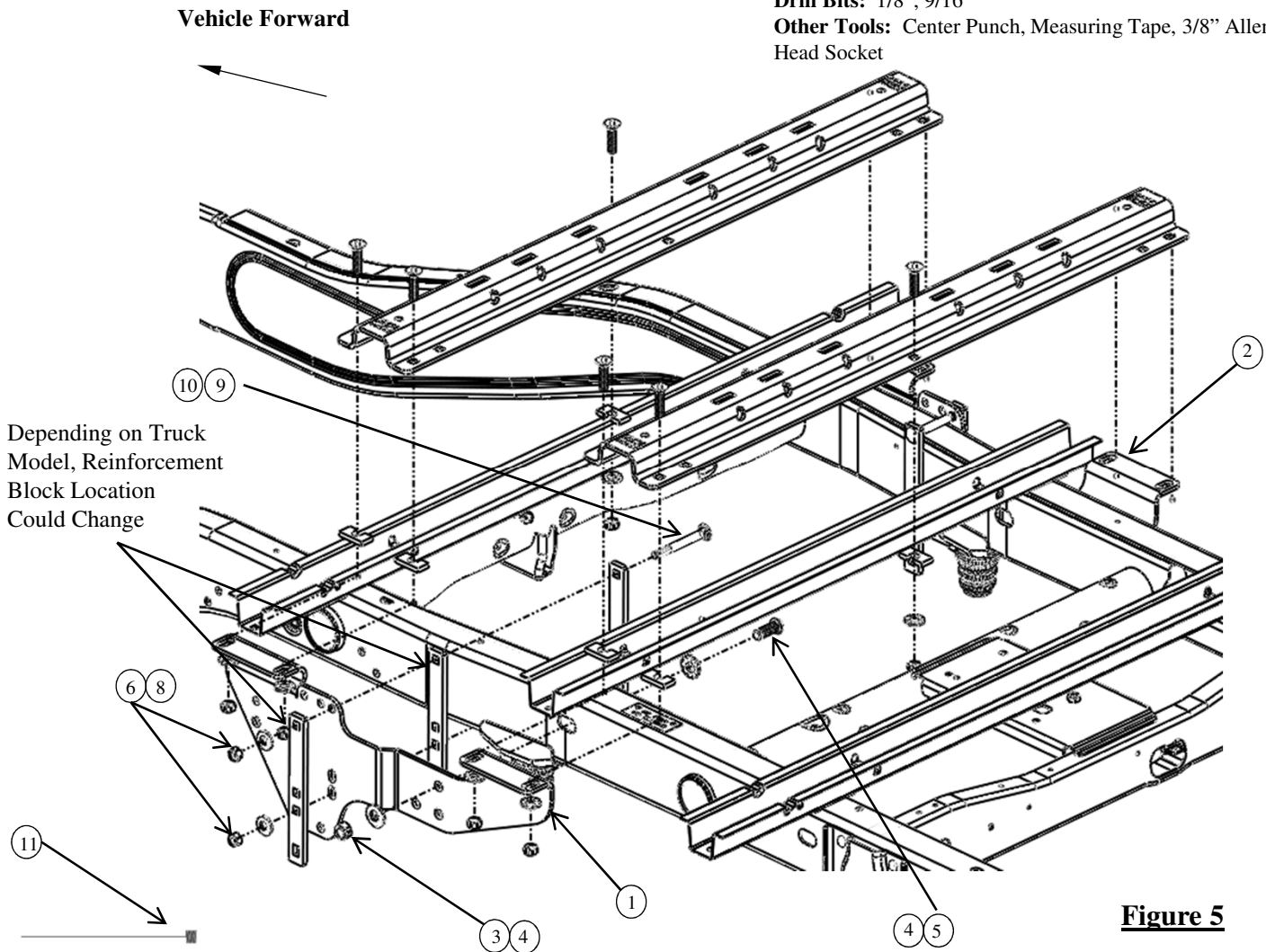

Figure 5

| # | Description | QTY | # | Description | QTY |
|---|-------------------------------------|-----|----|------------------------------------|-----|
| 1 | Driver Side Mounting Bracket | 1 | 7 | 1/2"-13 Hex Nut | 4 |
| 2 | Passenger Side Mounting Bracket | 1 | 8 | 1/2" Concial Washer | 4 |
| 3 | 5/8"-11 Hex Nut | 2 | 9 | 1/2"-13 X 5.5" Gr. 8 Carriage Bolt | 4 |
| 4 | 5/8" Concial Washer | 2 | 10 | Reinforcement Block | 4 |
| 5 | Angle Bracket | 1 | 11 | 5/8" Pull Wire | 2 |
| 6 | 5/8"-11 Gr. 8 Button Head Cap Screw | 2 | | | |

Any hardware shown in Figure 1, but not described in table below were supplied with 30153 kit.

- **Do not install mounting rails over plastic bed liners. Plastic bed liners must be cut out of the way to provide metal to metal contact. Mounting rails may be installed on spray in liners.**
- **Use only bolts, nuts, and washers supplied to install this kit. All bolts and nuts are Grade 8 unless otherwise specified.**
- **These instructions are guidelines only, actual installation is the responsibility of the installer and the owner. Always measure truck and trailer before installing hitch to be sure that there is clearance at the cab and at the bumper to allow for turns.**
- **Do not install this product on or attempt to tow with a truck with a 5-1/2' bed unless a sidewinder pinbox coupler has been installed on the trailer.**

Warning!!

When installing to Figure 5 & 6, during drilling protect the fuel tank and filler tubes, brake lines and wire harness by placing a piece of metal between the box floor and potential components at risk on the driver's side. This will prevent drilling into these items.

Installation Instructions

1. Lower and remove spare tire. Remove exhaust heat shield from the underneath the passenger side of the vehicle.
2. Place one mounting rail in the bed of the vehicle. Center the rail on the floor of the truck bed and use your tape measure to locate the proper distance from the rail to the rear edge of the truck box as illustrated on page 7.
3. Use a center punch to mark the holes in the rail per the illustration. Move the rail out of the way and drill each position with a 1/8" drill bit. **Note: When drilling holes through the bed be sure what is below the truck bed in those locations.**
4. Temporarily position the frame brackets on the sides of the frame and check that the 1/8" drilled holes align with the slots in the frame brackets. Remove the frame brackets from the vehicle.
5. Enlarge the 1/8" drilled holes to 9/16".
6. Fasten the frame brackets to the vehicle frame rails as shown in Figure 5. Using the pull wire (11) thread the button head cap screw (6) and the conical washer (4) through the rearward slot, on the interior of the truck frame. Place the mounting bracket (1), conical washer (4), and the 5/8" nut(3) on and hand tighten.
7. Passing the 1/2" carriage bolts (9) through the top and middle slots in the reinforcement block (10) will create a clamping strap that will go inside the frame rail and connect to the mounting bracket (1). There are two different holes in the mounting bracket that allow for the best clamping surface to the truck frame. Changing the mounting bracket hole will allow the clamping strap to adjust to different height truck frames. Once the strap bolt have been passed through the best mounting hole thread the reinforcement block (10), 1/2" conical washer (8), and the 1/2" nut (7) on to the bolts and hand tighten.
8. On some model years of trucks there could be a large gap between the truck frame and the inside face of the mounting bracket. If that is true for your truck, remove the nuts and washers from the previous step, remove the reinforcement block from the outside of the bracket and thread it on the strap bolts on the inside of the mounting bracket. Pass 1/2" bolts through the correct hole, thread washers and nuts back into place and re-hand tighten.
9. Reposition the mounting rail over the holes in the bed and fasten the mounting rail to the frame brackets using the hardware supplied with the rail kit. Use the U-shaped blocks between the frame bracket or mounting rails and the truck bed to ensure metal to metal contact. Install center bolt and hand tighten.
10. Place the unassembled 5th wheel support arches/slider/goose into the already installed mounting rail. Position the rearward mounting rail with the support arches/slider/goose by inserting the tabs into the mounting rail and pushing the mounting rail tight towards the other mounting rail. Ensure that the mounting rail is centered on the bed of the vehicle. This will position the rail in the correct location and ensure that the 5th wheel will have a snug fit to the truck. **Note:** If more than one hitch product will be used with the mounting rails then both types should be used at the same time to align the rearward mounting rail. This will ensure that one product does not compromise the fit of the other.
11. Repeat installation steps 4, 6 and 9.
12. Starting with the hardware that fasten the mounting brackets to the bed rails and torque all the nuts. Torque the 1/2" fasteners to 110ft-lbS (149N*M), and the 5/8" bolts to 212 ft-lbs (287N*M).
13. Re-install spare tire.

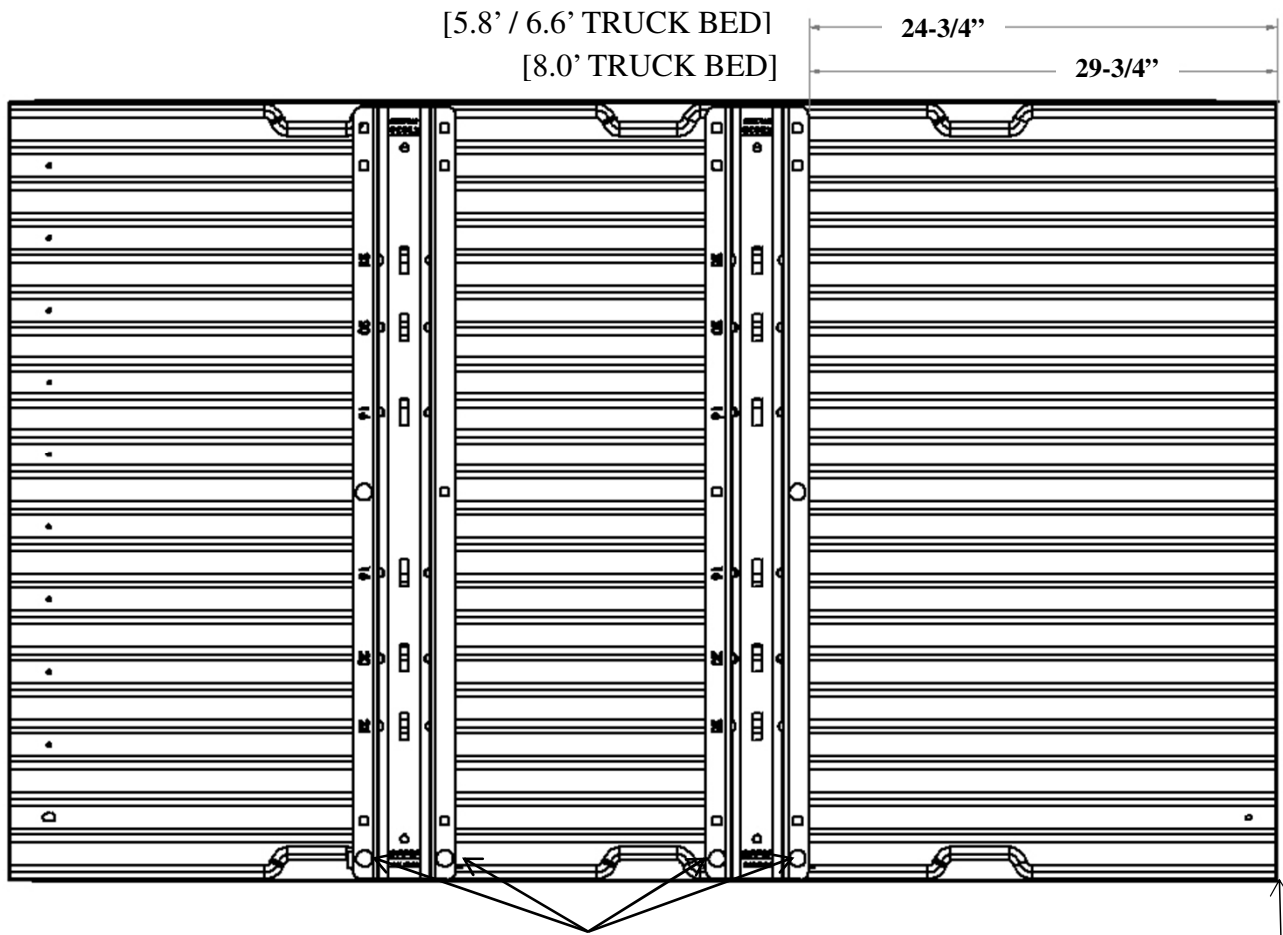

Figure 6

**Bolt Locations
Typical of Both Sides**

Back Edge of Truck Bed