

5th Airborne Sidewinder Service Kit Instructions 94316



Equipment Required:

Wrenches: 15/16", Torque Wrench, Rubber Mallet

Included Service Kit Items:

1	Qty. (1)	Wear Plate
2	Qty. (1)	Wear Bushing
3	Qty. (1)	Wear Disc
4	Qty. (4)	5/8-11x2 GRD8 Bolt
5	Qty. (4)	5/8 Conical Washer
6	Qty. (2)	5/8-11x1.75 GRD5 Bolt
7	Qty. (2)	5/8 HS Conical Washer
8	Qty. (1)	Teflon Lube
9	Qty. (1)	Instructions

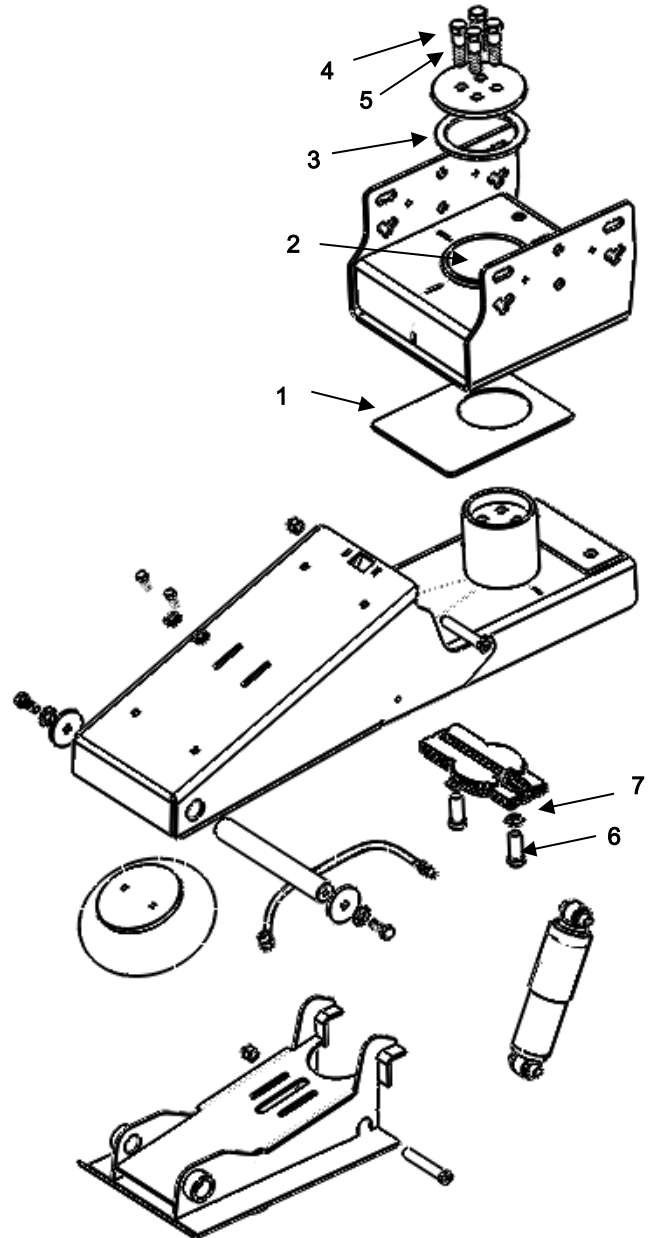

Figure 1

WARNING:
 Failure to follow all of these instructions may result in death or serious injury!

5th Airborne Sidewinder

Service Kit Instructions

1. Remove the Sidewinder and Turret from the trailer. Make note of the bolt locations into the trailer wings.
2. Place unit on a bench and remove the Turret and all old hardware that is going to be replaced. A rubber mallet and a screwdriver may be needed to remove the old pivot bushing from the turret.
3. Apply lube to the inside of the turret, and to the inside of the pivot bushing, and install the new pivot bushing (Figure 2).
4. Place new wear plate onto Sidewinder Arm, making sure the chamfer side faces down (Figure 3).
5. Apply Lube on the wear plate (Figure 4).

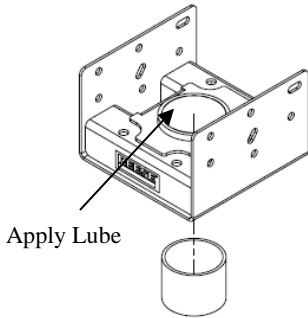
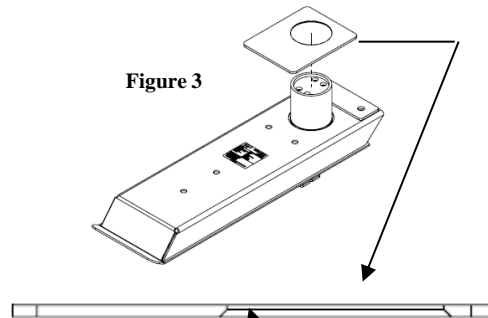

Figure 2



The chamfer on the wear plate Must face down as shown

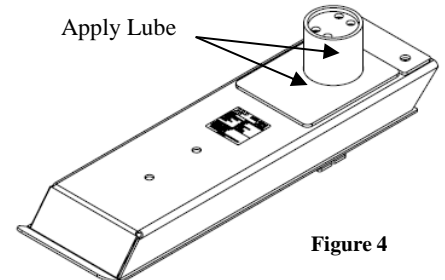

Figure 4

6. Install turret onto Sidewinder™ arm over the wear plate.
7. Install the upper wear disc and outer cap. Install (4) 5/8" Cap bolts & 5/8" conical washers, do not fully tighten these bolts at this time (figure 5).

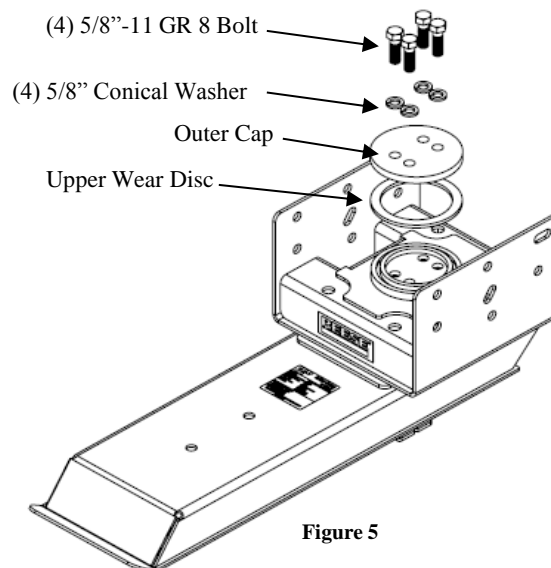

Figure 5

8. Before attempting to fully tighten the (4) 5/8-11 cap bolts, it is necessary to check that the upper wear disc is properly positioned. Refer to the figures below (figure 6).

5th Airborne Sidewinder

Service Kit Instructions

ASSEMBLY INSTRUCTIONS – CON'T

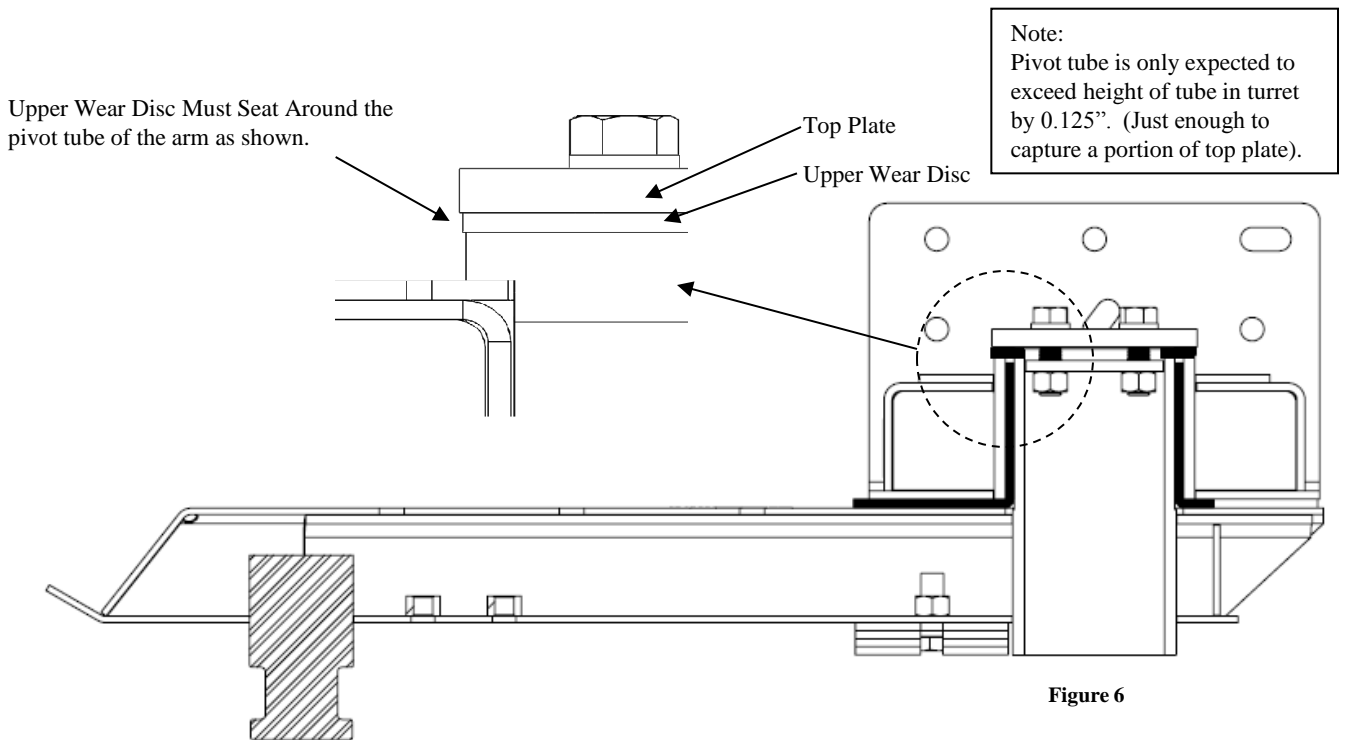

9. Tighten (4) 5/8-11 cap bolts as shown, repeat pattern 2-3 times.

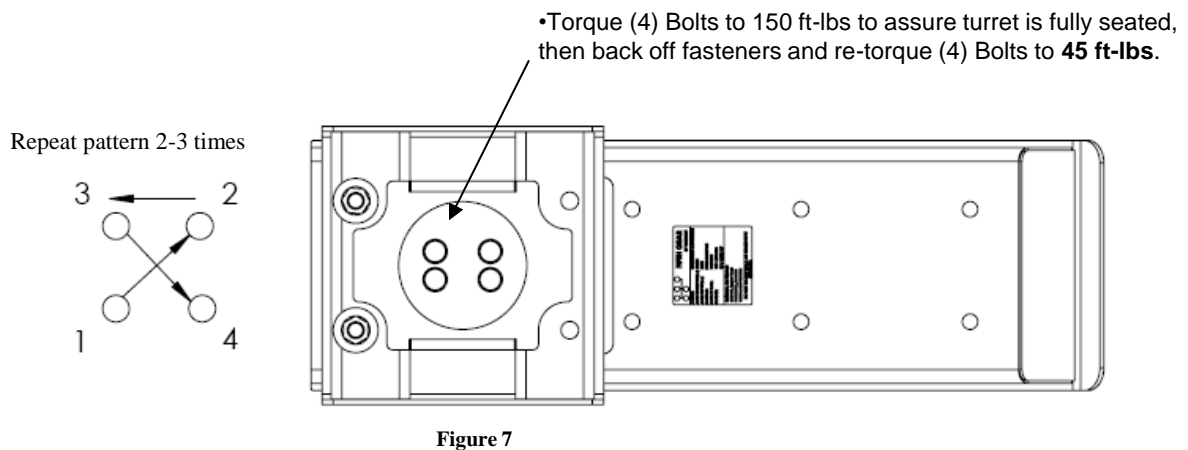

5th Airborne Sidewinder

Service Kit Instructions

ASSEMBLY INSTRUCTIONS – CON'T

10. Install the Sidewinder™ inside the mounting wings (Figure 8). Cequent Performance Products recommends replacing the mounting bolts, nuts, and lock washers with the same size & grade as the bolts removed from the original pin box. Torque all bolts to the proper value listed in table 1.

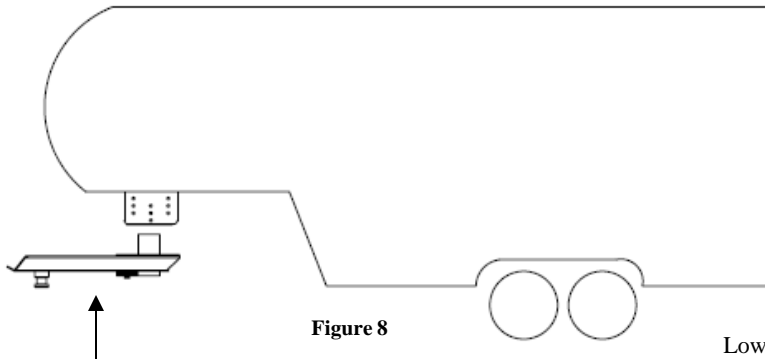

Figure 8

Bolt Diameter	Torque
1/2" Bolts GR5	90 ft-lbs
5/8" Bolts GR5	150 ft-lbs
3/4" Bolts GR5	275 ft-lbs

Table 1

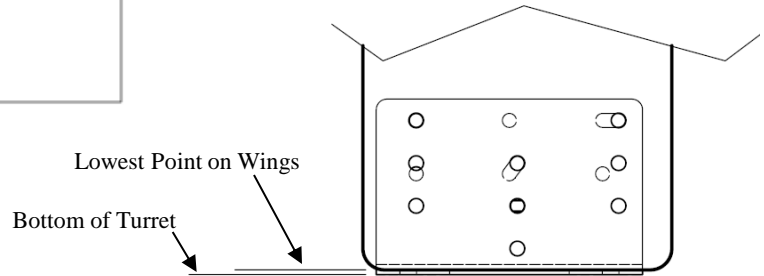

Figure 9

CAUTION: The bottom of the turret must extend below the lowest point on the wings to allow the arm to clear during pivot. (Figure 9)

BEFORE EACH TRIP:

1. CHECK YOUR EQUIPMENT: Check the condition of all of your towing equipment and keep it in top condition.
2. Check that the torque of the (4) cap bolts is 45 ft-lbs, refer to figure 7 in this manual.
3. Check to see that all bolts are properly tightened.
4. Check wedge engagement in the fifth wheel jaw, refer to wedge adjustment portion of this manual.

MAINTENANCE:

1. For ease of hookup: frequently lubricate the wedge surfaces, around the king pin, and the skid plate surface, apply a lithium grease to the bearing surfaces as described in the assembly section of this manual. (Note: Resistance is typical in the Sidewinder™ arm)
2. Keep pin-box hitch painted to prevent rust and maintain a good appearance. (Do Not paint over labels)
3. At least once per season, disassemble unit to clean, inspect, lubricate and re-torque fasteners.

⚠DANGER: Do Not install a wedge without removing the Lock-Out Bolts. Never operate without a wedge if the Lock-Out bolts are not installed. Doing this will create a double pivot and could result in death or serious injury and/or damage to the tow vehicle and trailer.

5th Airborne Sidewinder

Service Kit Instructions

Installing the Wedge:

1. Remove (2) 3/4" Lock-Out bolts and hardware from the rear of the pin-box (figure 10).
2. Remove the universal wedge from it's storage location by removing (2) 5/8-11 X 1 3/4" bolts and conical washers.

Note: The universal wedge is supplied with the unit and provides a lockout for many different fifth wheel hitches. Cequent Performance Products offers custom wedges designed for specific fifth wheel hitches, check with your RV dealer or call CPP customer service to see if we offer a custom wedge for your hitch application for purchase. If a custom wedge is available for your hitch application, CPP recommends replacing the universal wedge with a custom wedge to provide the best fit for your hitch. The universal wedge should remain with the unit as it may be necessary if breakdown occurs to fit a tow vehicle other than your own.

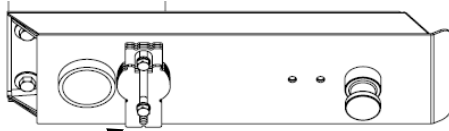

Figure 10

Wedge In Storage Location

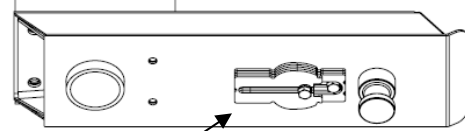

Figure 11

Wedge In Position for Sidewinder™
Feature Activation

Universal Wedge Orientation:

Before installing the universal wedge in position it is necessary to decide the best orientation for your hitch application. This can be done by referencing the diagrams below.

Orientation for Reese/Draw-Tite/Hidden Hitch Select Series, Pro Series, Husky & similar style fifth wheel heads.

Orientation for Reese/Draw-Tite/Hidden Hitch Signature Series, Elite Series, & Select Plus, Reese Titan 16K & 20K, B&W and similar style fifth wheels.

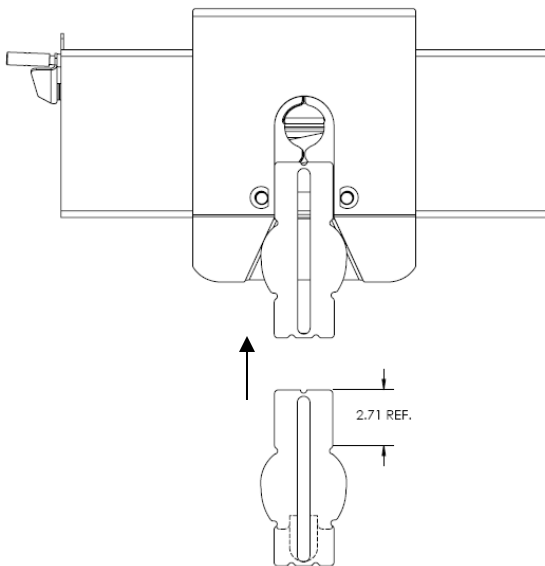

Figure 12

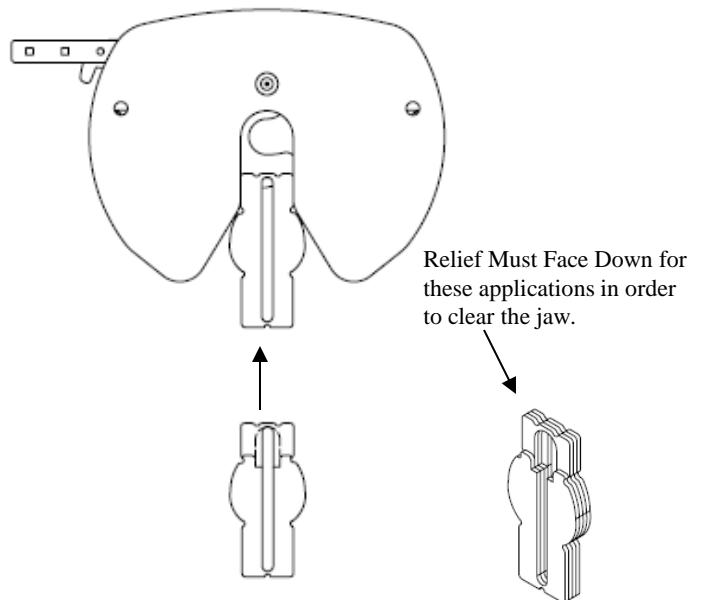

Figure 13

5th Airborne Sidewinder

Service Kit Instructions

Activating the Sidewinder™ Feature Cont.:

3. Install the universal wedge into the position for Sidewinder™ feature activation (figure 11) , in the proper orientation for your fifth wheel. The bolts will not be fully tightened at this time. Only tighten the (2) 5/8-11 X 1 3/4" wedge bolts until the conical washers begin to engage. The wedge should be allowed to slide with the rap of a hammer or mallet.
4. Apply grease to the surface on both sides of the wedge, around the kingpin, and the skid plate surface as shown in figure 14. **For all Fifth Wheel Heads, lubricate the area where the jaw passes under the wedge.*

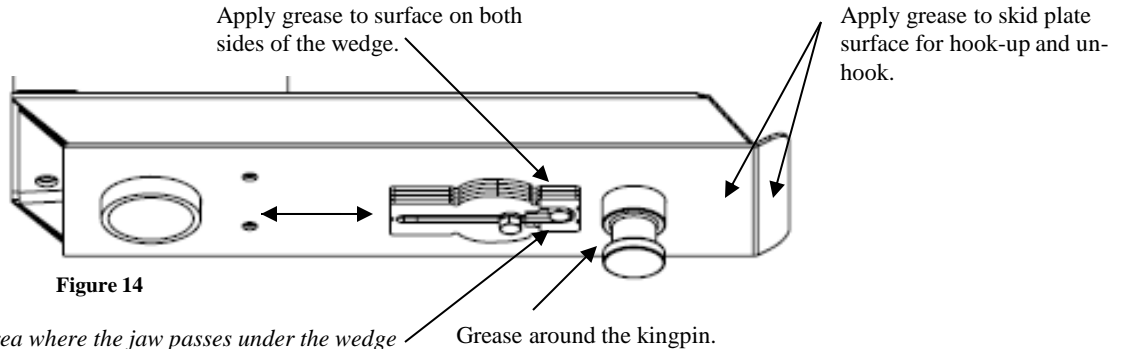

**Lubricate the area where the jaw passes under the wedge*

Grease around the kingpin.

5. Hook-up to the fifth wheel trailer following the hitching procedure in this manual, for proper latching of the fifth wheel hitch refer to the owners manual for your fifth wheel hitch.
6. Raise the trailer landing gear and drive the truck and trailer forward a few feet so that the truck and trailer are in a straight line.
7. Put the vehicle in park and apply the emergency brake. Block the trailer wheels and lower the trailer landing gear so the landing gear is resting firmly on the ground and supporting the trailer weight. Tap the wedge firmly forward until it will no longer travel.
8. Attempt to tighten both wedge bolts. Both bolts may not be accessible while the unit is hitched, in these cases tighten the most accessible bolt (usually the rear); these bolts will later be tightened to the proper torque value.
9. Unhitch the trailer from the tow vehicle following the unhitching procedure in this manual.
10. Torque (2) 5/8" Wedge Bolts to 150 ft-lbs (figure 15). A thin walled socket may be necessary.
11. The wedge adjustment should be adjusted or checked for proper adjustment before each trip. If a different fifth wheel hitch is used after this adjustment, it is necessary to readjust the wedge for the specific fifth wheel hitch.

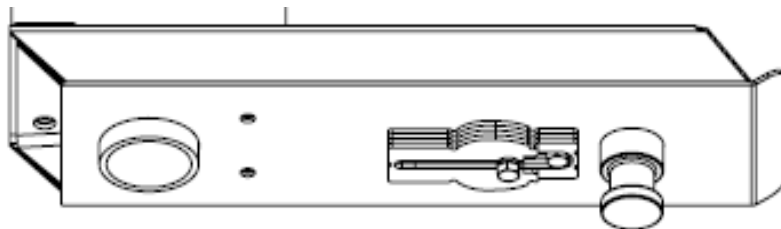

Torque (2) 5/8" Wedge Bolts to 150 ft-lbs.

LIMITED LIFETIME WARRANTY

- 1. Limited Lifetime Warranty (“Warranty”).** Cequent Performance Products, Inc. (“We” or “Us”) warrants to the original consumer purchaser only (“You”) that the product will be free from material defects in both material and workmanship for a period of lifetime of ownership, ordinary wear and tear excepted; provided that installation and use of the product is in accordance with product instructions. There are no other warranties, express or implied, including the warranty of merchantability or fitness for a particular purpose. This warranty is not transferable.
- 2. Limitations on the Warranty.** This Warranty does not cover: (a) normal wear and tear; (b) damage through abuse, neglect, misuse, or as a result of any accident or in any other manner; (c) damage from misapplication, overloading, or improper installation; (d) improper maintenance and repair; and (e) product alteration in any manner by anyone other than Us, with the sole exception of alterations made pursuant to product instructions and in a workmanlike manner.
- 3. Obligations of Purchaser.** To make a Warranty claim, contact Us identify the product by model number, and follow the claim instructions that will be provided. Any returned product that is replaced by Us becomes our property. You will be responsible for return shipping costs. Please retain your purchase receipt to verify date of purchase and that You are the original consumer purchaser. The product and the purchase receipt must be provided to Us in order to process Your warranty claim.
- 4. Remedy Limits.** Product replacement is Your sole remedy under this Warranty. We shall not be liable for service or labor charges incurred in removing or replacing a product or any incidental or consequential damages of any kind.
- 5. Assumption of Risk.** You acknowledge and agree that any use of the product for any purpose other than the specified use(s) stated in the product instructions is at Your own risk.
- 6. Governing Law.** This Warranty gives You specific legal rights, and You also may have other rights which vary from state to state. This Warranty is governed by the laws of the State of Michigan, without regard to rules pertaining to conflicts of law. The state courts located in Oakland County, Michigan shall have exclusive jurisdiction for any disputes relating to this Warranty.