

WARNING: FAILURE TO FOLLOW INSTALLATION AND HITCH-UP INSTRUCTIONS MAY CAUSE PROPERTY LOSS, SERIOUS INJURY, OR DEATH!

CAUTION: Under no circumstances do we recommend exceeding the towing vehicle manufacturers recommended vehicle towing capacity.

READ ALL INSTRUCTIONS BEFORE STARTING THE INSTALLATION OR USE

Equipment Required:

- Wrenches: M24
- Pliers
- Torque wrench

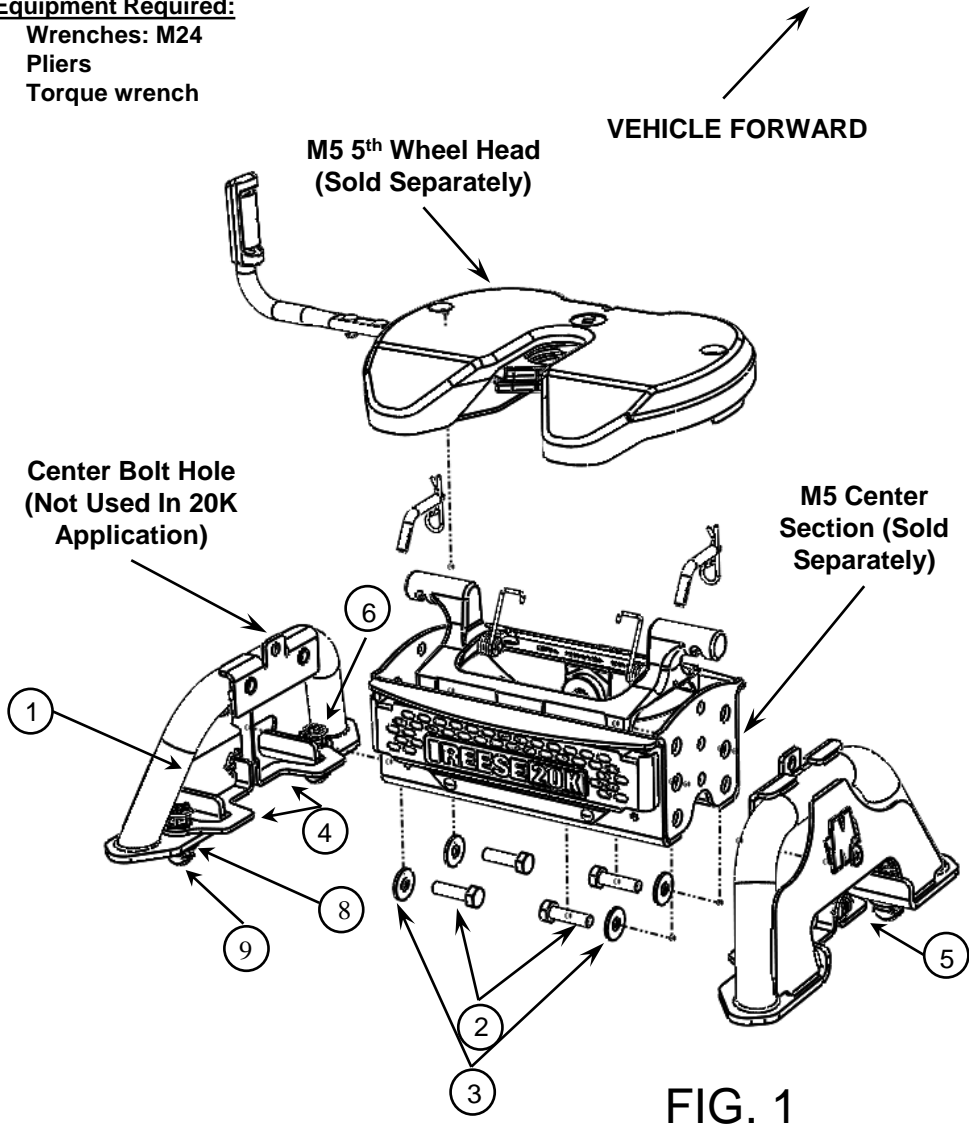

#	Description	QTY
1	M5 GM Leg (30937)	1
2	Bolt-M16 x 2 x 40mm CL10.9	4
3	Washer – 5/8” Conical	4
4	Handle, T-Pin Locking	4
5	Lynch Pin, Handle Lock	6
6	Castle Nut, M5 Ford	4
7	T-Pin, Ford M5	4
8	T-Bushing, Ford M5	4

FIG. 1

Table of Contents

1. Installation -----	p 1	3. Maintenance -----	p 6
2. Assembly and Installation -----	p 2 - 4	4. Warranty -----	p 7

ASSEMBLY AND INSTALLATION

1. The M5 MY20 GM Leg comes pre-assembled, adjusted, and ready to install.

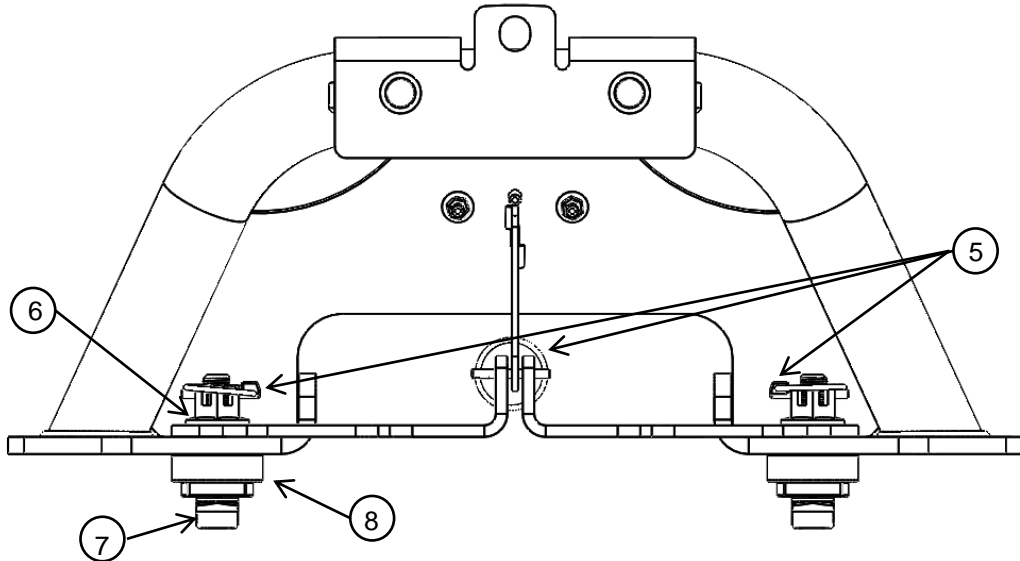

2. Determine which center section mounting holes to use to ensure a minimum of 6" clearance between the truck bed rail and the bottom of the trailer. (For more detail, please refer to the **GUIDELINES FOR MATCHING HITCH, TRUCK, AND TRAILER** section located in the head and center section instruction sheet.) Legs should be attached at same height on both sides of unit. This unit has 4" of vertical adjustment.
3. Using the (4) M16x2x40 mm Hex Head Bolts, attach the legs to the center section structure, threading the bolts from the inside of the center section into the threaded portion of the legs. Finger tighten bolts initially until final adjustments are made.

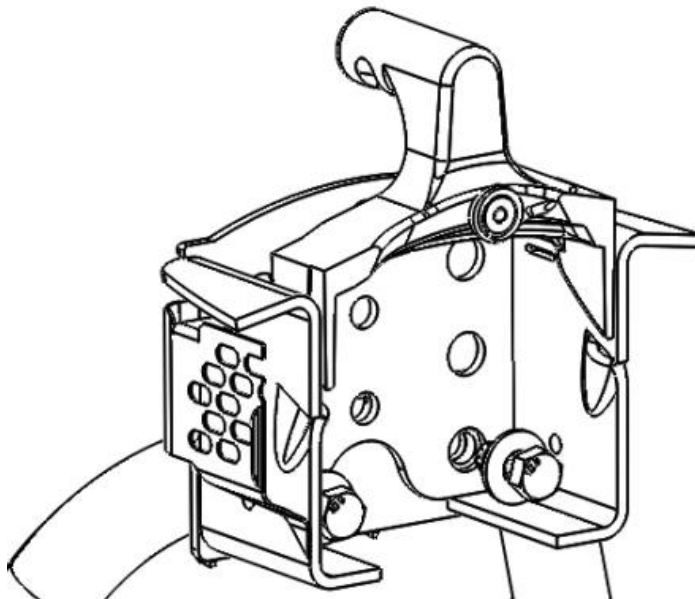

4. **NOTE:** During assembly of M5 MY20 GM Leg to Center Section, make sure that the collars on the leg (**A**) are completely seated in the corresponding holes in the center section (**B**).

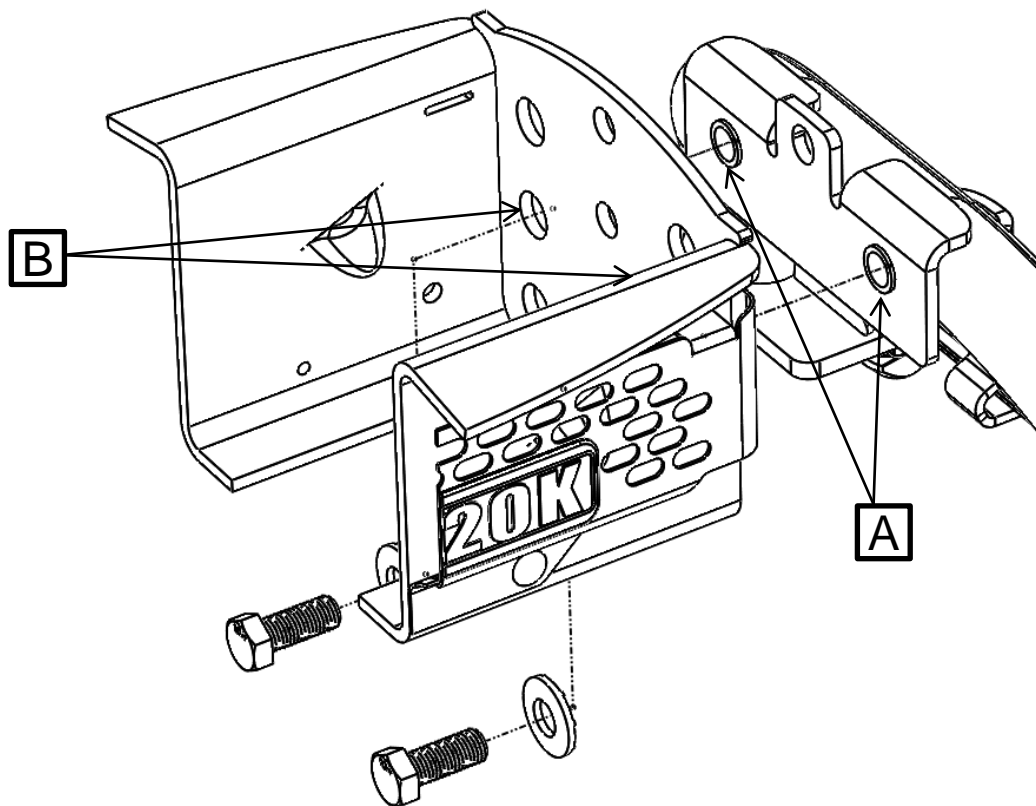

5. Remove the (2) lynch pins and position legs over pucks in the truck bed with handles in **OPEN** position as shown.

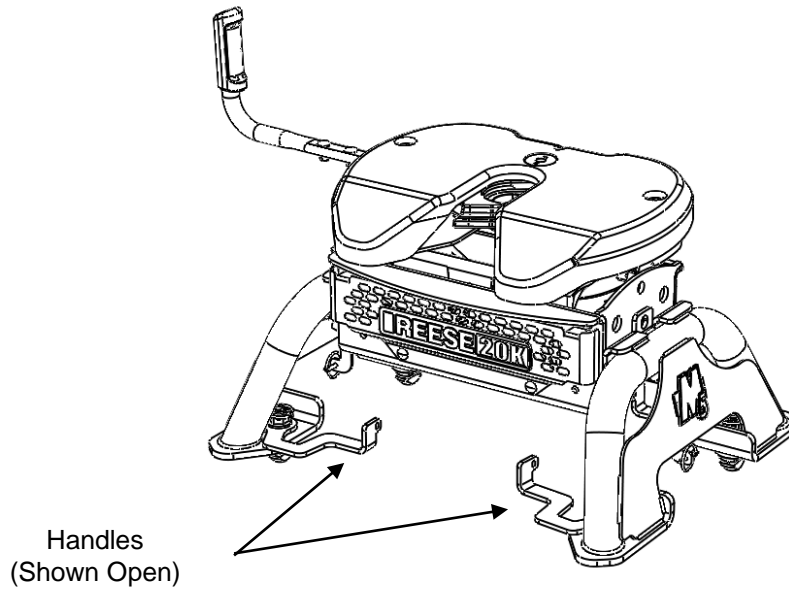

6. Once unit has been placed in pucks, rotate handles back to **CLOSED** position and insert the lynch pins back into the leg to prevent handles from opening during operation.

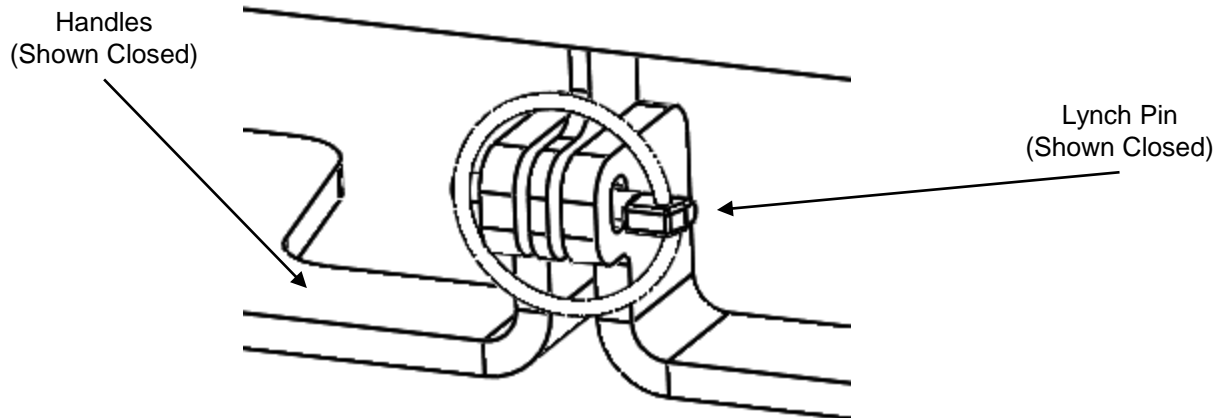

- Due to variations in truck underbeds, it is normal for some handles to be loose and other handles to be too tight to lock. If a handle appears too loose and rattles or cannot be closed fully, remove the lynch pin and adjust castle nut by hand to a position where handle does not rattle or is able to close.

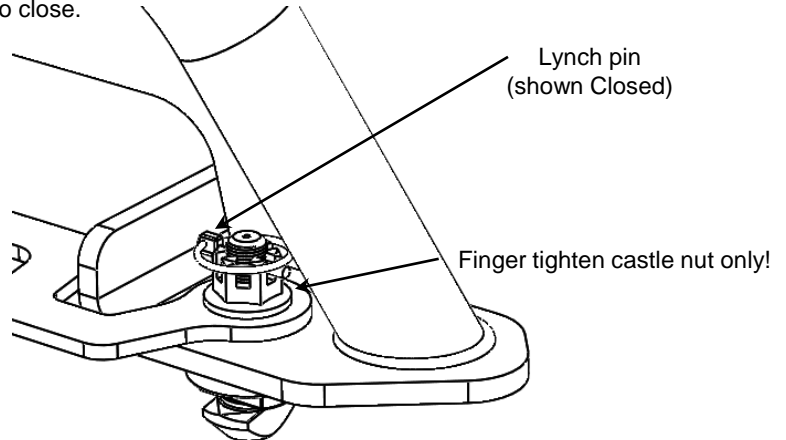

- Once handle adjustment is satisfactory, re-insert lynch pin and close properly.
- With Leg T-Pin handles locked and T-Pins securely held in underbed structure, tighten each M16 hex-head bolt to 220 ft-lb of torque.
- Verify that hitch is tight to truck bed by lifting each side of the hitch.
- Assemble head to center section per instructions included with M5 Center Section and Head.

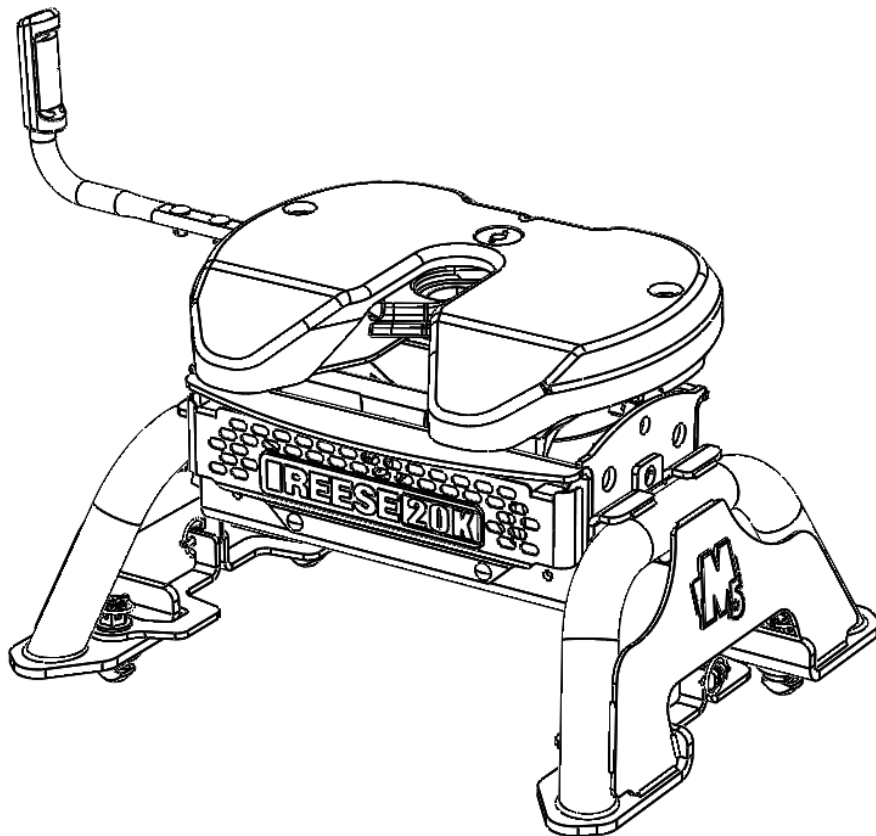

MAINTENANCE

In order to maintain performance over the life of the product:

1. Before any trip, verify that all lynch pins, foot bracket and castle nut are undamaged and securely locked, with little to no vertical play. The image below shows the proper orientation of the lynch pin in relation to the foot.
2. Every 1,000 miles, check the M16 hex bolts that connect center section to legs to insure that they are still torqued to 220 ft-lb of torque.
3. For general maintenance of the entire 5th wheel hitch assembly, please refer to the M5 head and center section instruction sheet.

