

Installation Instructions Volkswagen Jetta

Part Numbers:

24926

60364

77312

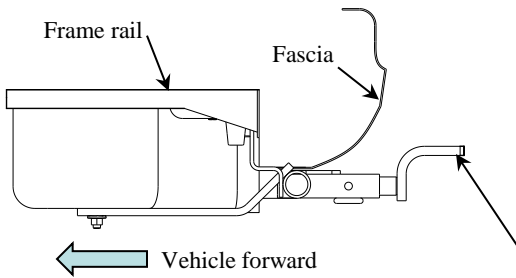

(Sold separately)

Drawbar Kit:

3593

Drawbar must be used in the **RISE** position only.

**Do Not Exceed Lower of Towing Vehicle
Manufacturer's Rating or**

2000 LB (908 Kg) Max Gross Trailer Weight

200 LB (90.8 Kg) Max Tongue Weight

Hitch Shown In Proper Position

Equipment Required: 7/16" Pull wire (Provided)
& Sealant

Fastener Kit: 24926F

Wrenches: Torx® 25, 10mm, 13mm,
17mm, 19mm, 11/16, & 3/4"

Drill Bits: None

Seal the hole in the trunk pan to prevent intrusion of exhaust fumes and water.

Wiring Access Location: PC3, 4

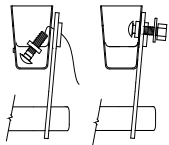
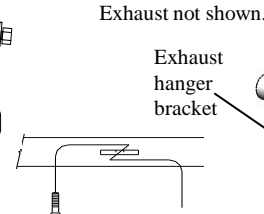

Figure 2.



Kink Pull wire to keep spacer independent of bolt

Figure 3.

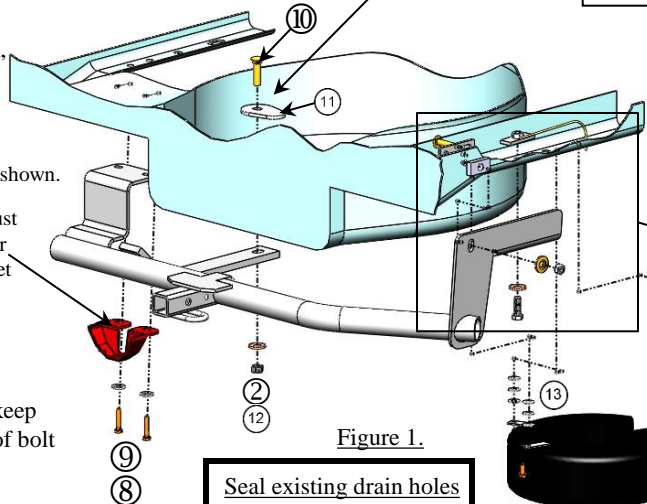
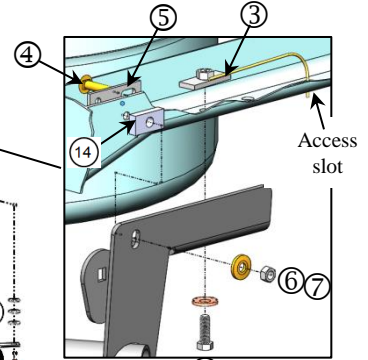
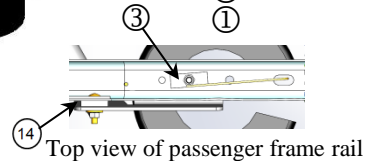

Figure 1.



Seal existing drain holes in trunk pan to prevent intrusion of exhaust fumes and water.

Fuel vapor canister



Note: sort hardware prior to hitch installation to confirm conical washer are kept with coordinated with bolts

①	Qty. (1)	Hex Bolt M12X1.25X30 CL8.8
②	Qty. (1)	Conical washer 1/2" *Not in Fastener Kit
③	Qty. (1)	Handle nut M12
④	Qty. (1)	Carriage bolt 7/16-14X2.00 GR5
⑤	Qty. (1)	Spacer .250X1.00X3.00
⑥	Qty. (1)	Conical Washer 7/16"
⑦	Qty. (1)	Hex nut 7/16-14
⑧	Qty. (2)	Hex bolt M8X1.25X30 CL8.8
⑨	Qty. (2)	Conical washer 3/8"
⑩	Qty. (1)	Carriage bolt 1/2-13X2.00 GR5 * Not in Fastener Kit
⑪	Qty. (1)	Spacer (egg shape) *Not in Fastener Kit
⑫	Qty. (1)	Hex nut 1/2" *Not in Fastener Kit
⑬	Qty. (9)	Flat washer 5/16"
⑭	Qty. (1)	Spacer, .437 X 1.0 X 2.0

- Remove the spare tire from the spare tire carrier inside of the trunk. Remove the vehicle forward rubber isolator from the trunk pan and install the fasteners (Item 10 & 11) through the trunk pan. Return plug to vehicle owner.
- Remove plastic fascia covering from underneath the passenger side of the vehicle by removing the (3) Torx 25 screws and (2) plastic hex nuts. Return plastic fascia covering to vehicle owner.
- Lower the exhaust by removing (2) bolts from the exhaust hanger bracket and the rubber exhaust isolator ahead of the axle. Support as required. Return bolts to owner.
- Lower the Fuel vapor canister on the passenger side (if present).
- Using the pull wire, feed the 7/16 carriage bolt and spacer (item 4 & 5), through the access slot in the frame rail on the passenger side leave the pull wire attached. See Figure 3. Bend the handle nut and insert into passenger side frame rail over center hole location.
- Raise hitch into position. Push the 7/16 carriage bolt (only) with pull wire attached into the frame rail. Attach spacer (item 14) to the wire and pull the wire through passenger side bracket and raise passenger side into position. See Figure 2. Pull 7/16 carriage bolt through spacer and side bracket and install fasteners loosely. Install M12 bolt into handle nut loosely. See Figure 1.
- Rotate the exhaust bracket forward out of the way and raise the hitch into place on drivers' side. Pull the exhaust bracket back into place and install the M8 X 1.25 X 30 bolt and 3/8" conical washer through the slots on the exhaust hanger bracket.
- Install 1/2-13 hex nut and spacer onto item 10 & 11 already installed in trunk pan as shown. Use a sealant (not provided) to prevent exhaust and water from entering. Seal the hole inside the trunk pan to prevent intrusion of exhaust fumes and water.
- Tighten all fasteners to specification.
- Reinstall the Fuel vapor canister if lowered in step 4. Use (3) 5/16" flat washers to space the canister down, re-use the original M6 bolts.
- Reinstall the exhaust at the forward isolator, removed in step 1.
- Reinstall spare tire, removed in steps 1.

Tighten all M8 CL8.8 fasteners with torque wrench to 20 Lb.-Ft. (27N*M) Tighten all M12 CL8.8 fasteners with torque wrench to 70 Lb.-Ft. (95N*M)
Tighten all 7/16-17 GR5 fasteners with torque wrench to 50 Lb.-Ft. (68 N*M) Tighten all 1/2-13 GR5 fasteners with torque wrench to 75 Lb.-Ft. (102 N*M)

Note: check hitch frequently, making sure all fasteners and ball are properly tightened. If hitch is removed, plug all holes in trunk pan or other body panels to prevent entry of water and exhaust fumes. A hitch or ball which has been damaged should be removed and replaced. Observe safety precautions when working beneath a vehicle and wear eye protection. Do not cut access or attachment holes with a torch.

This product complies with safety specifications and requirements for connecting devices and towing systems of the state of New York, V.E.S.C. Regulation V-5 and SAE J684.