

Installation Instructions

Honda CR-V

Part Numbers:

24790

60907

77164

(Sold separately)

Drawbar Kit:

3591

Drawbar must be used in the **RISE** position only.

**Do Not Exceed Lower of Towing Vehicle
Manufacturer's Rating or**

2000 LB (908 Kg) Max Gross Trailer Weight

200 LB (90.8 Kg) Max Tongue Weight

Equipment Required:

Fastener Kit: 24790F

Wrenches: 3/4"

Drill Bits: none

Wiring Access Location: SUV3

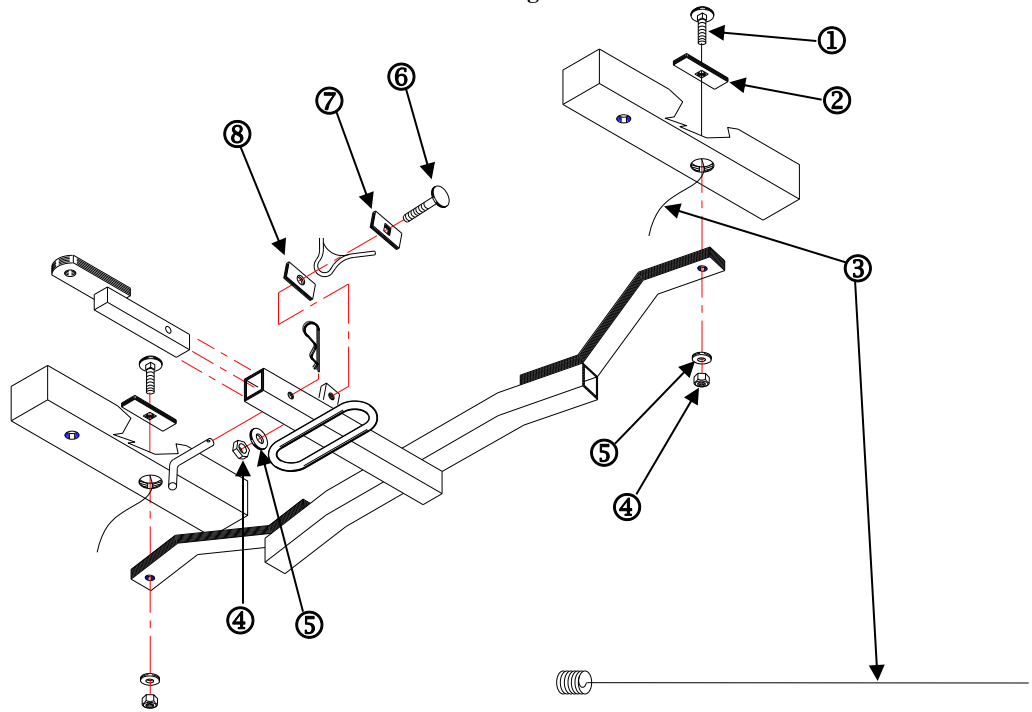

①	Qty. (2)	BOLT – CARRIAGE 1/2"-13 X 1 3/4" GR 5	⑤	Qty. (3)	WASHER – CONICAL TOOTHED
②	Qty. (2)	REINFORCEMENT PLATE 1" X 3" X 1/4"	⑥	Qty. (1)	BOLT – CARRIAGE 1/2"-13 X 2" GR 5
③	Qty. (2)	BOLT LEADER	⑦	Qty. (1)	SPACER 1" X 2" X 1/4" (SQUARE HOLE)
④	Qty. (3)	NUT 1/2"-13	⑧	Qty. (1)	SPACER 1" X 2" X 1/4" (ROUND HOLE)

1. Thread bolt leader (3) onto 1 3/4" carriage bolt (1) and insert bolt leader through hole in reinforcing plate (2).
2. Insert carriage bolt, headfirst, followed by reinforcing plate through hole in hole in bottom of frame (refer to "Access to Enclosed Frame" on last page of instruction sheet) and carefully pull on bolt leader until bolt and reinforcing plate assembly is in position. Repeat for other side
3. Install hitch loosely onto vehicle, being careful not to push bolt assemblies back into frame channels. Remove bolt leaders and install conical washers (5) and nuts (4). Install 2" carriage bolt (6), along with square hole spacer (7), round hole spacer (8), conical washer (5) & nut (4) through vehicle's tie down hook and hitch's mounting tab in order as shown in illustration.
4. Tighten all bolts, referring to torque table on instruction sheet.

Tighten all 1/2" fasteners with torque wrench to 75 Lb.-Ft. (102 n*m)

Note: check hitch frequently, making sure all fasteners and ball are properly tightened. If hitch is removed, plug all holes in trunk pan or other body panels to prevent entry of water and exhaust fumes. A hitch or ball which has been damaged should be removed and replaced. Observe safety precautions when working beneath a vehicle and wear eye protection. Do not cut access or attachment holes with a torch.

This product complies with safety specifications and requirements for connecting devices and towing systems of the state of New York, V.E.S.C. Regulation V-5 and SAE J684.