



Installation Instructions

PART NUMBERS: 45509, 45709,

CQT45509

⚠ WARNING

To prevent **SERIOUS INJURY, DEATH or PROPERTY DAMAGE:**

- **ALWAYS read, understand and follow warnings and instructions for your hitch BEFORE installation. Keep for future reference.**
- **DO NOT cut, weld or modify this receiver.**
- **CHECK all fasteners are tight and your hitch is securely mounted to your vehicle periodically.**
- **ALWAYS read, understand and follow all warnings and instructions for your vehicle and for other accessories you will use with your hitch BEFORE use.**
- **LOAD the trailer heavier in front.**
- **DO NOT exceed lower of towing vehicle manufacturer's rating or:**

Hitch Type	Max Gross Trailer Weight	Max Tongue Weight
Weight Carrying	18,000lb.(8172 kg)	2,000lb. (908 kg)
Weight Distributing	18,000lb.(8172 kg)	2,500lb. (1135 kg)

- **ALWAYS wear your seatbelt.**
- **SLOW DOWN when towing, NEVER exceed any posted speed limit.**
- **If EXCESS SWAY occurs, take your foot off the gas pedal and hold the steering wheel as steady as possible. DO NOT apply your brakes and DO NOT speed up.**

LIMITED LIFETIME WARRANTY

1. **Limited Lifetime Warranty (“Warranty”).** Cequent Performance Products, Inc. (“We”, “Us” or “Our”) warrants to the original consumer purchaser only (“You” or “Your”) that the product will be free from material defects in both material and workmanship, ordinary wear and tear excepted. The Warranty is valid only if (a) the products are returned to Us for inspection and testing; (b) Our inspection discloses to Our satisfaction that any alleged nonconformance are material and have not been caused by misuse, neglect, wear and tear, improper installation, unsuitable storage, improper repair, alteration, or accident; and (c) the products were installed, maintained and used in accordance with Our instructions. **THE WARRANTY IS MADE IN LIEU OF ALL OTHER WARRANTIES, EXPRESS OR IMPLIED (OTHER THAN THE WARRANTY OF TITLE AS PROVIDED BY THE UNIFORM COMMERCIAL CODE IN EFFECT IN MICHIGAN), INCLUDING WITHOUT LIMITATION, ANY WARRANTIES OF MERCHANTABILITY OR FITNESS FOR A PARTICULAR PURPOSE, SAID WARRANTIES BEING EXPRESSLY DISCLAIMED.**
2. **Obligations of Purchaser.** Any returned product that is replaced by Us becomes our property. You may be responsible for return shipping costs. Please retain your purchase receipt to verify date of purchase and that You are the original consumer purchaser. The product and the purchase receipt must be provided to Us in order to process Your Warranty claim.
3. **Exclusive Remedy.** Product replacement is Your sole and exclusive remedy under this Warranty. We shall not be liable for service or labor charges incurred in removing or replacing a product. **IN NO EVENT WILL WE BE RESPONSIBLE FOR ANY INDIRECT, SPECIAL, CONSEQUENTIAL OR PUNITIVE DAMAGES.**
4. **Assumption of Risk.** You acknowledge and agree that any use of the product for any purpose other than the specified use(s) stated in the product instructions is at Your own risk.
5. **Governing Law.** This Warranty gives You specific legal rights, and You also may have other rights which vary from state to state. This Warranty is governed by the laws of the State of Michigan, without regard to rules pertaining to conflicts of law. The state courts located in Oakland County, Michigan shall have exclusive jurisdiction for any disputes relating to this Warranty.



Applications:

Years	Make	Models
03-16	Dodge	Ram 2500
03-16	Dodge	Ram 3500

*Visit our website for the most up to date information regarding application years and trim levels.

Installation Time: **95 min**

The time listed above is the average time for professional installers. If you do not feel comfortable performing this installation on your own or are in need of assistance, please contact a professional installer.

Equipment Required:



DO NOT EXCEED LOWER OF TOWING VEHICLE MANUFACTURER'S RATING OR:

Hitch Type	Max Gross Trailer Weight	Max Tongue Weight
Weight Carrying	18,000 lb.(8172 kg)	2,000 lb. (908 kg)
Weight Distributing	18,000 lb.(8172 kg)	2,500 lb. (1135 kg)



Representative Vehicle Photo

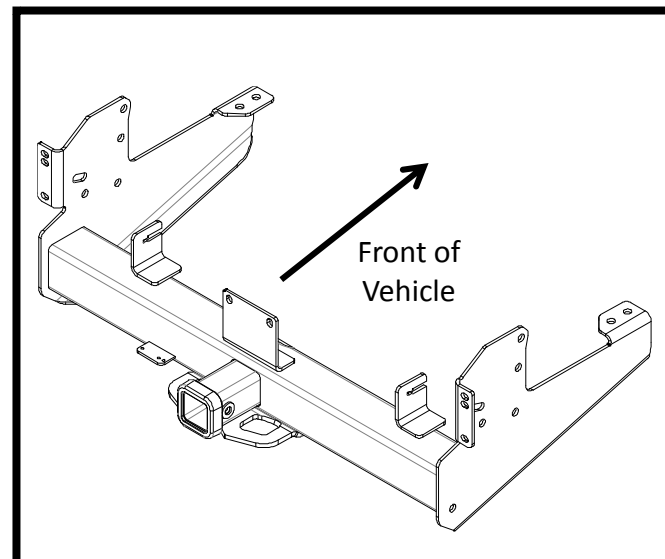

Hitch Illustration



Always wear SAFETY GLASSES
when installing hitch

Installation Instructions

PART NUMBERS: 45509, 45709, CQT45509

NOTE;
WITH THIS HITCH INSTALLED
THE STEP BUMPER IS NO LONGER ABLE
TO BE USED AS A TOWING POINT.

Must have pick-up chassis
Spring mount (as shown
above the frame).

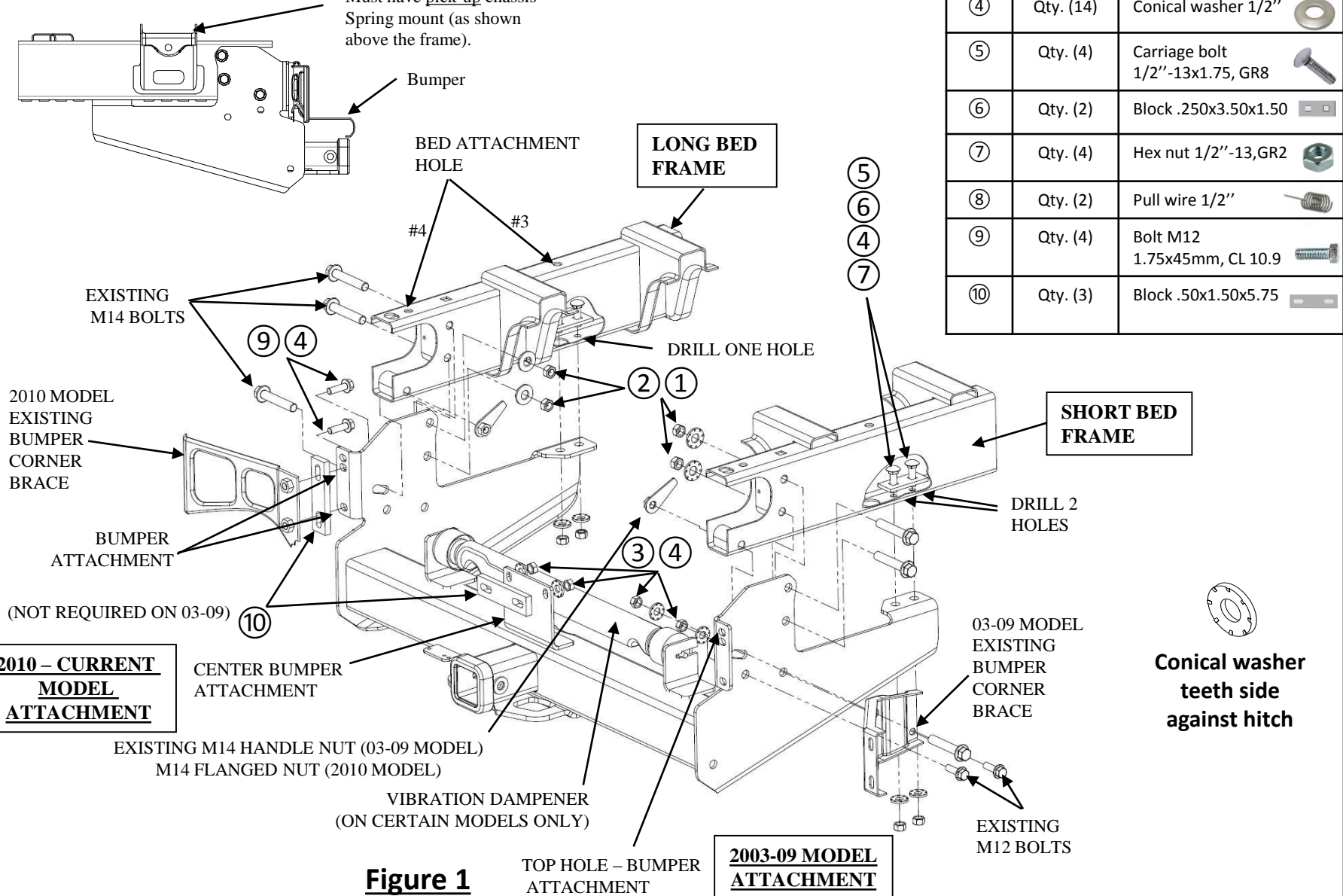

Fastener Kit: 45509F

①	Qty. (4)	Hex nut M14x2.00	
②	Qty. (4)	Conical washer 5/8"	
③	Qty. (6)	Hex nut M12x1.75	
④	Qty. (14)	Conical washer 1/2"	
⑤	Qty. (4)	Carriage bolt 1/2"-13x1.75, GR8	
⑥	Qty. (2)	Block .250x3.50x1.50	
⑦	Qty. (4)	Hex nut 1/2"-13,GR2	
⑧	Qty. (2)	Pull wire 1/2"	
⑨	Qty. (4)	Bolt M12 1.75x45mm, CL 10.9	
⑩	Qty. (3)	Block .50x1.50x5.75	



Conical washer
teeth side
against hitch

2010 - CURRENT
MODEL
ATTACHMENT

2003-09 MODEL
ATTACHMENT

Figure 1



Always wear SAFETY GLASSES
when installing hitch

Installation Instructions

PART NUMBERS: 45509, 45709, CQT45509

- Lower spare tire for ease of installation. (18 INCH SPARE TIRE WILL REQUIRE REMOVAL OF THE TIRE LOCATOR BRACKET (SEE FIGURE 3) AND 20 INCH SPARE TIRE MUST BE RELOCATED FROM UNDER THE BED)
- Remove 6 of the rear most bed attachment bolts. These can be accessed thru large holes in bottom of frame or suspension mounts. Leave the two forward most bed bolts tight. (Total of eight bed bolts)
- Raise back of bed up and place a 2" thick wooden block between frame and #3 bed attachment location.
- Remove license plate to access two bolts for next step.
- Protect and then remove the bumper by removing 6 to 12 bolts (depending on model year).
 - (03-09) Two M12 bolts and one M14 bolt from the inner bumper corner brace to the bumper / hitch attachment - per side.
 - (03-09) One M12 bolt from the frame rail bumper attachment to the bumper - per side.
 - (2010) Two M12 bolt from the frame rail bumper attachment to the bumper - per side.
 - (all years) Two M12 bolt at the license plate area - uncovered in step 4.
- Set bumper aside for re-installation later.
- Remove the bumper / hitch structure.
 - (03-09) Remove the last two M14 bolts at the frame rail.
 - (2010) Remove three M14 bolts at the frame rail.
 - The structure will need to be rotated up and pulled back to clear boss and tab / slot engagements. See figure 2.
- Lower bed and reinstall the bed bolts.
- Raise hitch into position and use two forward most M14 bolt (2 per side) to hold it in place.
- Using the hitch as a template, mark and drill 9/16" holes in bottom of frame.
- Fish wire the 1/2" carriage bolts and block into place thru the end of the frame. Attach 1/2" washers and nuts finger tight.
- If equipped, remove the vibration dampener from OEM unit and install on this unit (as shown in figure 1).
- To ease the installation of the bumper, loosen the two bolts per side at the inner and outer corner brace (03-09 model only).
- Raise bumper into position and attach with bolts from step 5.
- Install the remaining fasteners per figure 1.
- Measure the gap between bumper and tail gate and adjust for even gap. Tighten fasteners.
- Raise spare tire.
- Give the OEM bumper / hitch structure to customer in case hitch is removed.

Note: check hitch frequently, making sure all fasteners and ball are properly tightened. If hitch is removed, plug all holes in trunk pan or other body panels to prevent entry of water and exhaust fumes. A hitch or ball which has been damaged should be removed and replaced. Observe safety precautions when working beneath a vehicle and wear eye protection. Do not cut access or attachment holes with a torch.

This product complies with safety specifications and requirements for connecting devices and towing systems of the state of New York, V.E.S.C. Regulation V-5 and SAE J684.

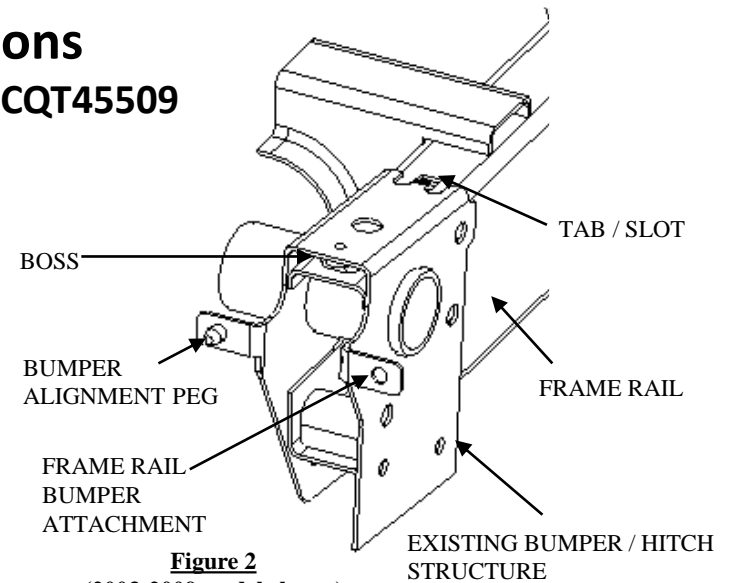

Figure 2
(2003-2009 model shown)

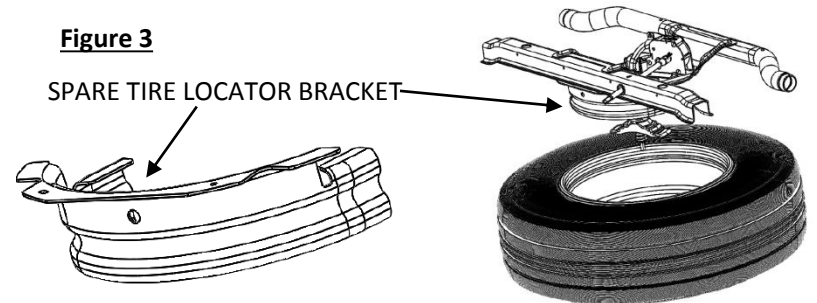

Figure 3

Tighten M12 hitch fasteners with torque wrench to 75 Lb.-Ft. (102 N*M)

Tighten M14 and 1/2" fasteners with torque wrench to 100 Lb.-Ft. (136 N*M)

Tighten M12 bed fasteners with torque wrench to 85 Lb.-Ft. (115 N*M)

Tighten all M10 fasteners with torque wrench to 42 Lb.-Ft. (57 N*M)

⚠ Proper torque is needed to keep the hitch secure to the vehicle when towing.