



Installation Instructions

PART NUMBERS: 75227, 87009, 44779

⚠ WARNING

To prevent SERIOUS INJURY, DEATH or PROPERTY DAMAGE:

- **ALWAYS read, understand and follow warnings and instructions for your hitch BEFORE installation. Keep for future reference.**
- **DO NOT cut, weld or modify this receiver.**
- **CHECK all fasteners are tight and your hitch is securely mounted to your vehicle periodically.**
- **ALWAYS read, understand and follow all warnings and instructions for your vehicle and for other accessories you will use with your hitch BEFORE use.**
- **LOAD the trailer heavier in front.**
- **DO NOT exceed lower of towing vehicle manufacturer's rating or:**

Hitch Type	Max Gross Trailer Weight	Max Tongue Weight
Weight Carrying	4500 lb. (2041 kg)	675 lb. (306 kg)
Weight Distributing	X	X

- **ALWAYS wear your seatbelt.**
- **SLOW DOWN when towing, NEVER exceed any posted speed limit.**
- **If EXCESS SWAY occurs, take your foot off the gas pedal and hold the steering wheel as steady as possible. DO NOT apply your brakes and DO NOT speed up.**

LIMITED LIFETIME WARRANTY

1. **Limited Lifetime Warranty (“Warranty”).** Cequent Performance Products, Inc. (“We”, “Us” or “Our”) warrants to the original consumer purchaser only (“You” or “Your”) that the product will be free from material defects in both material and workmanship, ordinary wear and tear excepted. The Warranty is valid only if (a) the products are returned to Us for inspection and testing; (b) Our inspection discloses to Our satisfaction that any alleged nonconformance are material and have not been caused by misuse, neglect, wear and tear, improper installation, unsuitable storage, improper repair, alteration, or accident; and (c) the products were installed, maintained and used in accordance with Our instructions. **THE WARRANTY IS MADE IN LIEU OF ALL OTHER WARRANTIES, EXPRESS OR IMPLIED (OTHER THAN THE WARRANTY OF TITLE AS PROVIDED BY THE UNIFORM COMMERCIAL CODE IN EFFECT IN MICHIGAN), INCLUDING WITHOUT LIMITATION, ANY WARRANTIES OF MERCHANTABILITY OR FITNESS FOR A PARTICULAR PURPOSE, SAID WARRANTIES BEING EXPRESSLY DISCLAIMED.**
2. **Obligations of Purchaser.** Any returned product that is replaced by Us becomes our property. You may be responsible for return shipping costs. Please retain your purchase receipt to verify date of purchase and that You are the original consumer purchaser. The product and the purchase receipt must be provided to Us in order to process Your Warranty claim.
3. **Exclusive Remedy.** Product replacement is Your sole and exclusive remedy under this Warranty. We shall not be liable for service or labor charges incurred in removing or replacing a product. **IN NO EVENT WILL WE BE RESPONSIBLE FOR ANY INDIRECT, SPECIAL, CONSEQUENTIAL OR PUNITIVE DAMAGES.**
4. **Assumption of Risk.** You acknowledge and agree that any use of the product for any purpose other than the specified use(s) stated in the product instructions is at Your own risk.
5. **Governing Law.** This Warranty gives You specific legal rights, and You also may have other rights which vary from state to state. This Warranty is governed by the laws of the State of Michigan, without regard to rules pertaining to conflicts of law. The state courts located in Oakland County, Michigan shall have exclusive jurisdiction for any disputes relating to this Warranty.

Rev 9/2014



Installation Instructions

PART NUMBERS: 75227, 87009, 44779

Applications:

Years	Make	Models
2012 – Current	Range Rover	Evoque

*Visit our website for the most up to date information regarding application years and trim levels.

Installation Time: 45 min

The time listed above is the average time for professional installers. If you do not feel comfortable performing this installation on your own or are in need of assistance, please contact a professional installer.



Representative Vehicle Photo

Equipment Required:

Safety Glasses	Ratchet	10 mm, 19 mm, 22 mm, 3/4\"/>	Torque Wrench	Tin Snips
Flat Head Screw Driver	Marker	Tape Measure	Utility Knife	

DO NOT EXCEED LOWER OF TOWING VEHICLE MANUFACTURER'S RATING OR:

Hitch Type	Max Gross Trailer Weight	Max Tongue Weight
Weight Carrying	4500 lb. (2041 kg)	675 lb. (306 kg)
Weight Distributing	X	X

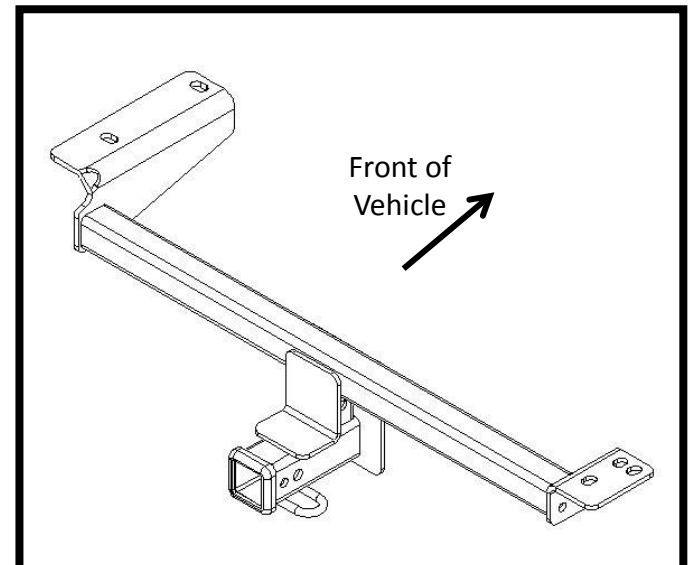

Hitch Illustration

Always wear SAFETY GLASSES when installing hitch

Installation Instructions

PART NUMBERS: 75227, 87009, 44779

Teeth side
against hitch



Figure 1

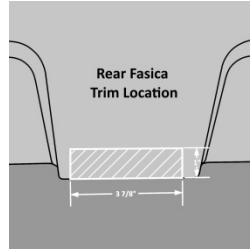
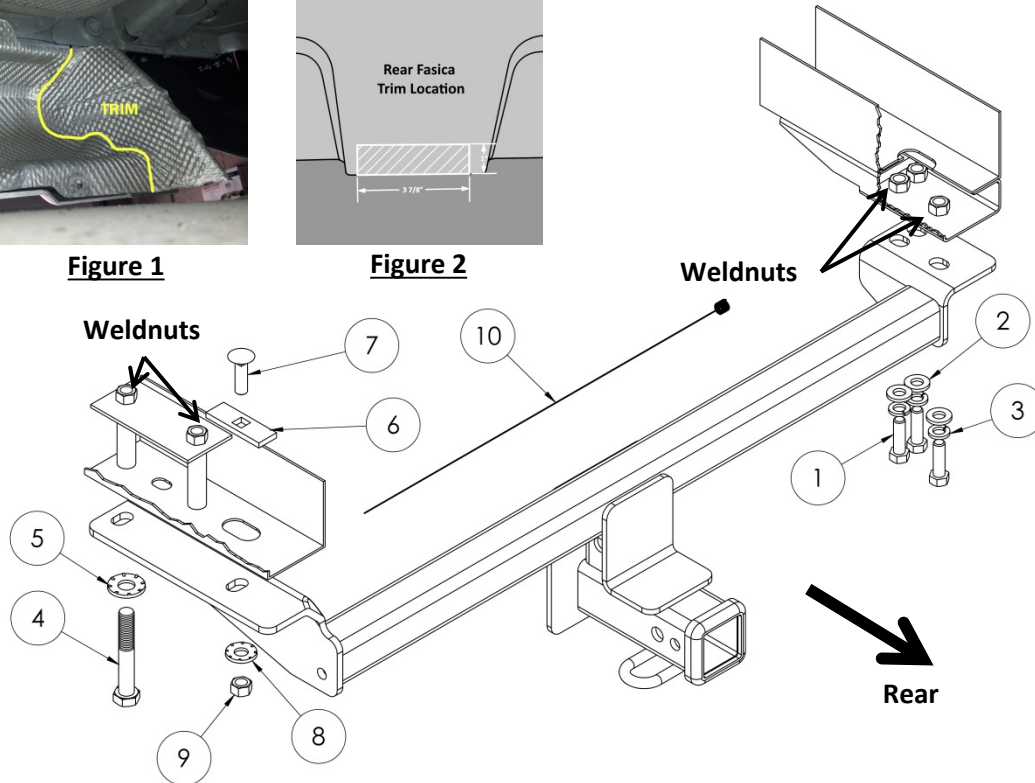
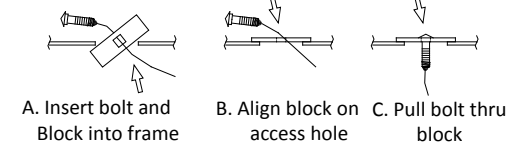

Figure 2



Fastener Kit: 75227F			
1	Qty. (3)	Bolt M12 1.75 x 40, CL8.8	
2	Qty. (3)	Flat Washer 12MM	
3	Qty. (3)	Lock Washer 1/2"	
4	Qty. (1)	Bolt M14 2.00 x 100, CL8.8	
5	Qty. (1)	Conical Washer 5/8"	
6	Qty. (1)	Block 1/4" x 1" x 3"	
7	Qty. (1)	Bolt Carriage 1/2" - 13 x 1.75" GR 5	
8	Qty. (1)	Conical Washer 1/2"	
9	Qty. (1)	Nut, Hex 1/2" - 13 GR 5	
10	Qty. (1)	Fishwire 1/2" - 13	

Reverse Fishwire Technique



- Lower Exhaust
 - Detach 3 rubber isolators from exhaust; 1 on the driver side, 2 on the passenger side. Use a spray lubricant to assist in detaching. Lower exhaust slowly and help support it to prevent damage.
- Temporarily Remove Rear Heat Shield
 - Using a permanent marker, trace on the heat shield where it touches the inside fascia near both exhaust pipes; shown in Figure 1.
 - Remove Rear Heat Shield by removing 4 – 10mm hex bolts and 8 screws. Set Heat Shield aside, trimming will be required later.
- Adding Block and Bolt to Access Hole
 - Using the reverse fishwire technique, fish the 1/2" Carriage Bolt (Item 7) and Block (Item 6) through the rearward access hole on the driver side frame rail. For ease of hitch installation, leave the fishwire temporarily attached to lead bolt through hitch slot.
- Trim Fascia and Heat Shield
 - Using a utility knife and tin snips, trim the fascia and heat shield respectively as shown in Figure 2; approximately 3 7/8" wide by 1" high from bottom of fascia.
 - Using the permanent marker lines as a guide, trim the corners of Rear Heat Shield; shown in Figure 1. Reinstall the Heat Shield.
- Installing Hitch
 - Raise the hitch into position. Thread the fishwire through the appropriate slot to prevent bolt and block to be pushed into the frame.
 - Install fasteners as shown. **Torque the 1/2" fastener to 75 ft-lbs (102N-m), torque the M14 fastener to 100 ft-lbs (136 N-m), and torque the M12 fasteners to 68 ft-lbs (92 N-m).**
- Raise Exhaust
 - Lift the exhaust back into position and reattach the 3 rubber isolators.

⚠ Proper torque is needed to keep the hitch secure to the vehicle when towing.

Note: check hitch frequently, making sure all fasteners and ball are properly tightened. If hitch is removed, plug all holes in trunk pan or other body panels to prevent entry of water and exhaust fumes. A hitch or ball which has been damaged should be removed and replaced. Observe safety precautions when working beneath a vehicle and wear eye protection. Do not cut access or attachment holes with a torch.

This product complies with safety specifications and requirements for connecting devices and towing systems of the state of New York, V.E.S.C. Regulation V-5 and SAE J684.

1. Lower Exhaust – Detach 3 rubber isolators from exhaust; 1 on the driver side, 2 on the passenger side. Use a spray lubricant to assist in detaching. Lower exhaust slowly and help support it to prevent damage.

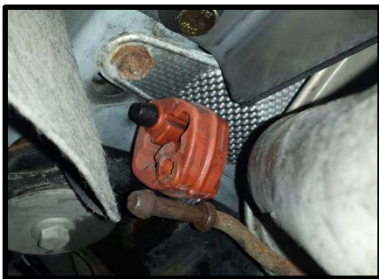

2. Temporarily Remove Rear Heat Shield – Using a permanent marker, trace on the heat shield where it touches the inside fascia near both exhaust pipes. Remove Rear Heat Shield by removing 4 – 10mm hex bolts and 8 screws. Set Heat Shield aside, trimming will be required later.



3. Adding Block and Bolt to Access Hole – Using the reverse fishwire technique, fish the 1/2" Carriage Bolt (Item 7) and Block (Item 6) through the rearward access hole on the driver side frame rail. For ease of hitch installation, leave the fishwire temporarily attached to lead bolt through hitch slot.



4. Trim Fascia and Heat Shield – Using a utility knife and tin snips, trim the fascia and heat shield respectively; approximately 3 7/8" wide by 1" high from bottom of fascia. Using the permanent marker lines as a guide, trim the corners of Rear Heat Shield. Reinstall the Heat Shield.

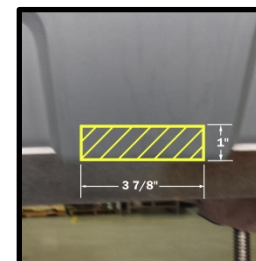

5. Installing Hitch – Raise the hitch into position. Thread the fishwire through the appropriate slot to prevent bolt and block to be pushed into the frame. Install fasteners as shown. **Torque the 1/2" fastener to 75 ft-lbs (102N-m), torque the M14 fastener to 100 ft-lbs (136 N-m), and torque the M12 fasteners to 68 ft-lbs (92 N-m).**

⚠ Proper torque is needed to keep the hitch secure to the vehicle when towing.



6. Raise Exhaust – Lift the exhaust back into position and reattach the 3 rubber isolators.

