

Installation Instructions

Part Numbers:

Infiniti FX35
Infiniti FX37
Infiniti FX50
Infiniti QX70

75778
44692
87639

**Do Not Exceed Lower of Towing Vehicle
 Manufacturer's Rating or**

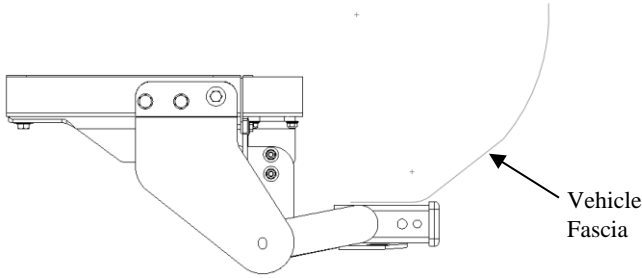

Hitch Shown In Proper Position

Equipment Required: Round file, tape, Short Phillips head Screwdriver, Flat-blade Screwdriver
Fastener Kit: 75778F

Wrenches: 10mm, 12mm, 13mm, 14mm, 17mm, 19mm , 9/16"
Drill Bits: 7/16"

Hitch type	Max Gross Trailer WT (LB)	Max Tongue WT (LB)
Weight Distributing	Do Not Use With Spring Bars	
Weight Carrying Ball Mount	4000 (1816 Kg)	400 (182 Kg)

Wiring Access Location: SUV3, SUV4

Accessory Rating	C
------------------	----------

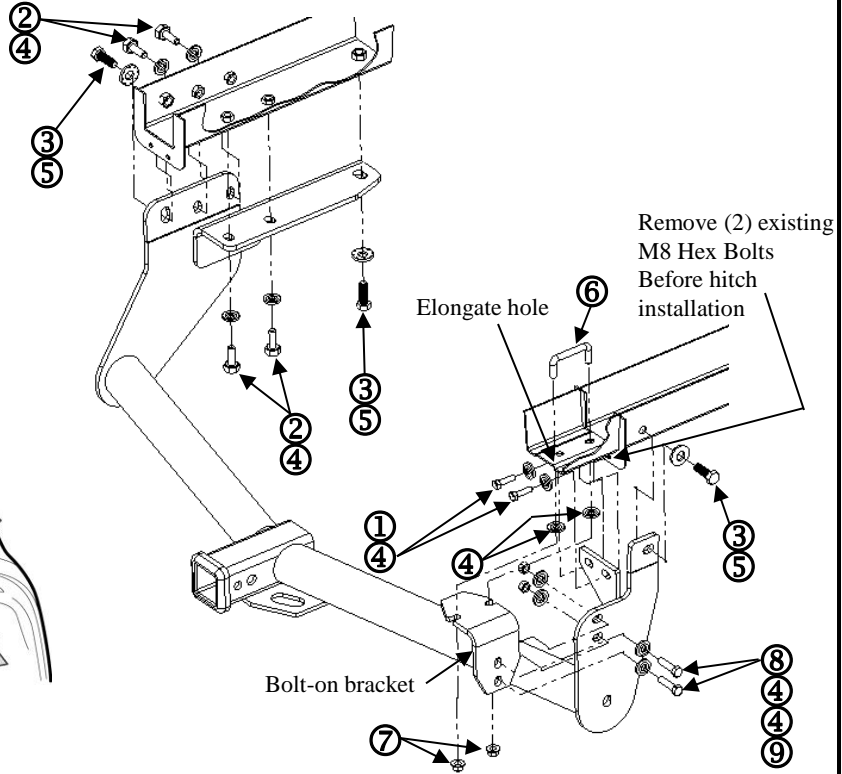
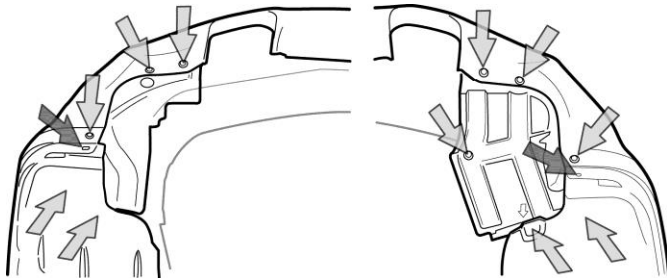
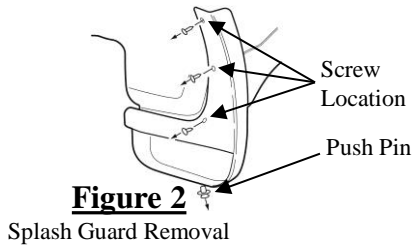

①	Qty. (2)	Hex Bolt M8 x 1.25 x 30mm CL10.9	⑥	Qty. (1)	U Bolt 3/8"-16 GR 5
②	Qty. (4)	Hex Bolt M10 x 1.25 x 30mm CL8.8	⑦	Qty. (2)	Flanged lock nuts – 3/8-16
③	Qty. (3)	Hex Bolt M12 x 1.25 x 35mm CL8.8	⑧	Qty. (2)	Hex Bolt 3/8 – 16 x 1-1/4" GR 8
④	Qty. (12)	Conical Toothed Washer 3/8"	⑨	Qty. (2)	Hex nuts 3/8 – 16 GR 5
⑤	Qty. (3)	Conical Toothed Washer 1/2"	⑩		

Note: check hitch frequently, making sure all fasteners and ball are properly tightened. If hitch is removed, plug all holes in trunk pan or other body panels to prevent entry of water and exhaust fumes. A hitch or ball which has been damaged should be removed and replaced. Observe safety precautions when working beneath a vehicle and wear eye protection. Do not cut access or attachment holes with a torch.

This product complies with safety specifications and requirements for connecting devices and towing systems of the state of New York, V.E.S.C. Regulation V-5 and SAE J684.

Installation Instructions

Part Numbers:

Infiniti FX35
Infiniti FX37
Infiniti FX50
Infiniti QX70

75778
44692
87639

**Do Not Exceed Lower of Towing Vehicle
 Manufacturer's Rating or**

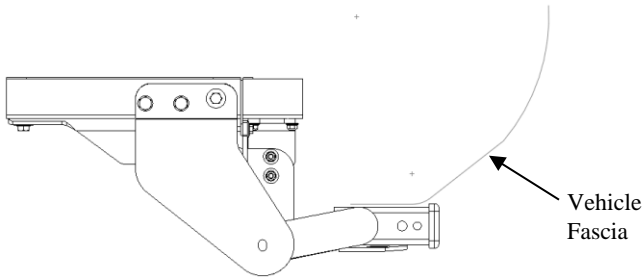

Hitch Shown In Proper Position

Equipment Required: Round file, tape, Short Phillips head Screwdriver, Flat-blade Screwdriver
Fastener Kit: 75778F

Wrenches: 10mm, 12mm, 13mm, 14mm, 17mm, 19mm, 9/16"

Drill Bits: 7/16

Hitch type	Max Gross Trailer WT (LB)	Max Tongue WT (LB)
Weight Distributing	Do Not Use With Spring Bars	
Weight Carrying Ball Mount	4000 (1816 Kg)	400 (182 Kg)

Wiring Access Location: SUV3, SUV4

Accessory Rating **C**

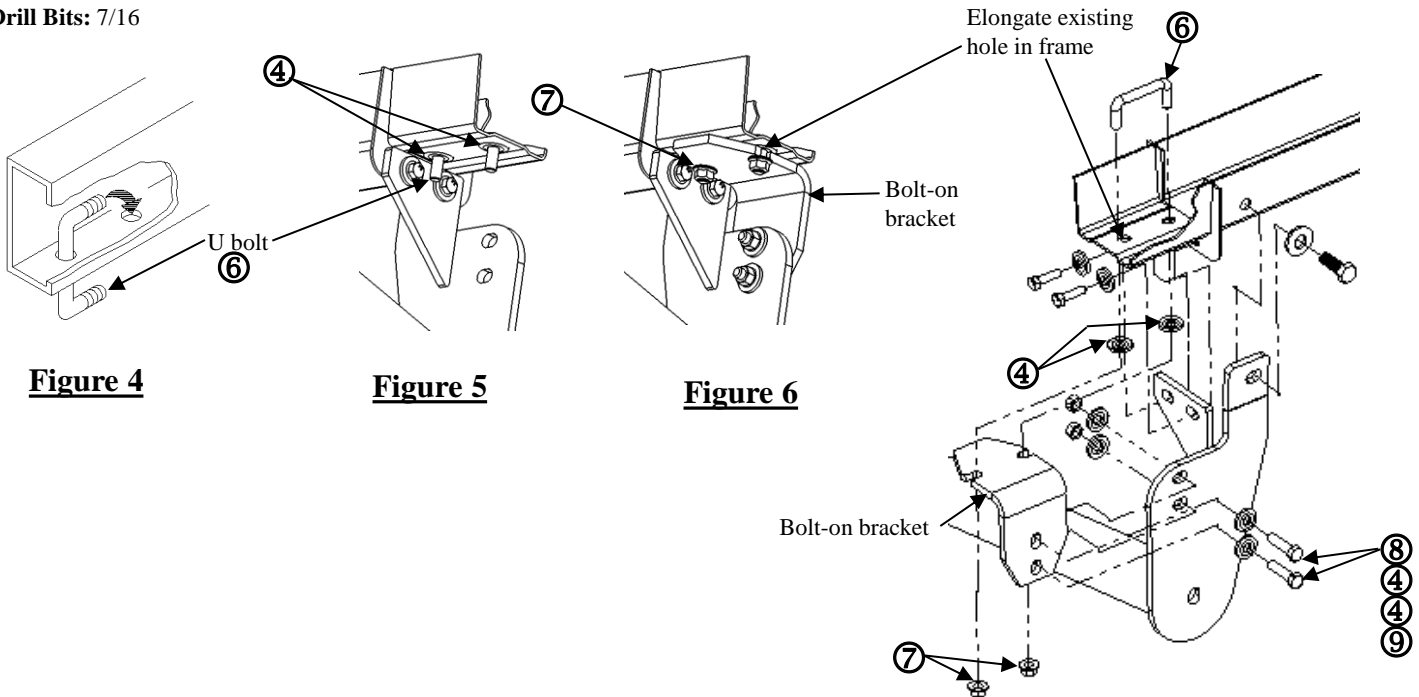

Figure 4

Figure 5

Figure 6

- Remove splash guards from both driver's side and passenger's side wheel wells by removing (3) Phillips head screws and one push pin, each side, as shown in **figure 2**. Retain splash guards and fasteners for reinstallation.
- Remove appearance panels from each side by removing push pins and M6 bolts as shown in **figure 3**, to access vehicle frame rails. Return panels and fasteners to vehicle owner.
- Remove tow hook from driver's side frame rail by removing (4) M10 fasteners. Return tow hook and fasteners to vehicle owner.
- Remove suspension damper on driver's side to allow wrench clearance for forward most fastener.
- On passenger's side, remove (2) M8 hex bolts from bottom flange at end of frame rail (located just rearward of exhaust hanger bracket) as shown and discard.
- Raise hitch into position and install fasteners as shown into existing weldnuts, except for bolt on bracket.
- With a torque wrench tighten all M8 x 1.25 CL10.9 fasteners to 25 Lb.-Ft. (34 N*M) ; M10 x 1.25 CL8.8 fasteners to 42 Lb.-Ft. (57 N*M); and all M12 x 1.25 CL8.8 fasteners to 76 Lb.-Ft. (103 N.M)**
- With hitch installed attached, elongate rear most hole in passenger side frame with drill or file. Approx. 1/8". Paint bare metal.
- Install U bolt as shown in **figure 4** and slide conical washers over the bolt to act as a spacers. Tape them in place until the bracket is installed see **figure 5**.
- Install bolt on bracket as shown in **figure 6** with the remaining fasteners noted in the figures.
- With a torque wrench tighten U bolt lock nuts to 35 Lb.-Ft. (47 N*M) and 3/8-16 grade 8 fasteners to 45 Lb.-Ft. (61 N*M).**
- Reinstall suspension damper removed in step 4.
- Reinstall splash guards removed in step 1.

Note: check hitch frequently, making sure all fasteners and ball are properly tightened. If hitch is removed, plug all holes in trunk pan or other body panels to prevent entry of water and exhaust fumes. A hitch or ball which has been damaged should be removed and replaced. Observe safety precautions when working beneath a vehicle and wear eye protection. Do not cut access or attachment holes with a torch.

This product complies with safety specifications and requirements for connecting devices and towing systems of the state of New York, V.E.S.C. Regulation V-5 and SAE J684.

Find more Reese Towpower products on our website.

Accept no compromises, choose only quality trailer hitches and towing.