

Installation Instructions

Lexus ES350

Excluding Hybrid Models

(Sold separately)
Drawbar Kit:
 36071

Part Numbers:

36530

90227

06154

36921 U-Haul

**Do Not Exceed Lower of Towing Vehicle
 Manufacturer's Rating or**

3500 LB (1589 Kg) Max Gross Trailer Weight

300 LB (136 Kg) Max Tongue Weight

Hitch Shown In Proper Position

Drawbar must be used in the **RISE** position only.

Equipment Required: Pull wires (provided), Tin snips, lubricant or soapy water

Fastener Kit: 36530F

Wrenches: 10mm, 12mm, 13mm, 14mm, 17mm, 11-1/16", 3/4", and small screwdriver

Drill Bits: 1/4" & 1" drill

Wiring Access Location: PC3, 4

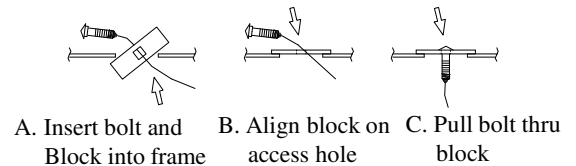
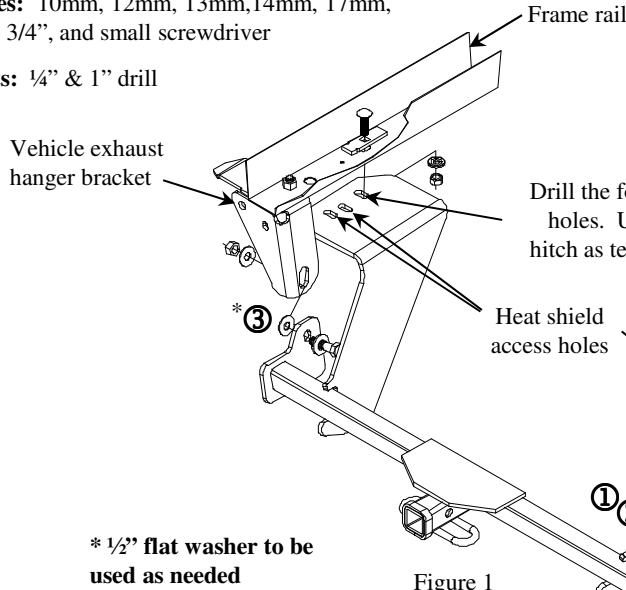
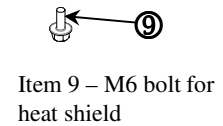

Figure 2

Pull wire Procedure



①	Qty. (2)	Hex bolt 1/2-13 X 1.75 GR5	⑥	Qty. (2)	Spacer
②	Qty. (2)	Conical washer 1/2"	⑦	Qty. (2)	Conical washer 7/16"
③	Qty. (4)	Flat washer 1/2" * (2) optional	⑧	Qty. (2)	Hex nut 7/16-14
④	Qty. (2)	Hex nut 1/2"	⑨	Qty. (2)	Hex bolt M6 X 1.00 X 16mm
⑤	Qty. (2)	Carriage bolt 7/16-14 X 1.50 GR5			

- Lower exhaust system at the rubber isolator (4 places). Spraying a lubricant on the metal hanger rod and the rubber isolator helps with removal. Be sure to **Support the exhaust system**. Lower the exhaust further by removing the hanger behind the passenger side muffler and the next hanger using a 12mm socket.
- Loosen the vehicles exhaust, at the hanger brackets, using a 14mm socket (3 places) each side.
- Remove the heat shield/shields.
- Temporarily raise the hitch into position, over the exhaust, and loosely install the 1/2" fasteners to the vehicle hanger brackets. Use the additional 1/2 flat washer (*3) as needed due to vehicle variance. Push the forward brackets into place, against the bottom of vehicle frame. If forward hole (both sides) do not align with an existing vehicle frame hole then mark and center punch the hole location to be drilled using the hitch as a template.
- Lower hitch and drill 1/4" pilot hole and 1" access hole as needed (caution wires, fuel lines, etc...). Mark and drill the heat shield for the 7/16 carriage bolt.
- Feed (items 5 & 6) into the frame rail using the reverse pull wire procedure. Figure 2. Leave pull wires attach.
- Raise hitch back into position and loosely install the 1/2 fasteners to the vehicle hanger brackets, feed the pull wires through the bracket and install remaining fasteners.
- Reinstall the heat shield.
- Tighten all fasteners to the required torque specification.

Tighten all 7/16 GR 5 fasteners with torque wrench to 50 Lb.-Ft. (68 N*M)
 Tighten all 1/2 GR5 fasteners with torque wrench to 75 Lb.-Ft. (102 N*M)

Note: check hitch frequently, making sure all fasteners and ball are properly tightened. If hitch is removed, plug all holes in trunk pan or other body panels to prevent entry of water and exhaust fumes. A hitch or ball which has been damaged should be removed and replaced. Observe safety precautions when working beneath a vehicle and wear eye protection. Do not cut access or attachment holes with a torch.

This product complies with safety specifications and requirements for connecting devices and towing systems of the state of New York, V.E.S.C. Regulation V-5 and SAE J684.