

RANCH HAND

INSTALLATION INSTRUCTIONS

GRILL GUARD for:

1994-01 DODGE 1500 & 1994-02 DODGE 2500 / 3500 PART # GGD941BL1

Note: These products will not fit on the 1998-'02 Sport Series!

1. There is a driver's side and passenger's side top mounting bracket. Hold bracket against the side of the bumper bracket. Cut out part of the original bumper cover (as per drawing). Repeat for other side.
2. Use a 1/2" bolt to mount each bracket. When mounting, leave at least 1/4" clearance between the bumper and mounting brackets.
3. Remove the license plate and the license plate bracket. Bolt the license plate to the bumper.
4. Remove the two front bolts from each side of the frame.
5. If your truck has an air dam, remove the Torx screws that hold it up.
6. Place two - 1/2" x 1 1/2" bolts in the bottom holes of the grill guard. Mount the grill guard using two - 1/2" x 1 1/2" bolts and nuts in the top holes.
7. Center the grill guard from left to right.
8. There is a driver and passenger bottom mounting bracket. Mount the brackets by using the bolts, which were removed earlier. Add a flat washer and lock washer to each bolt. (Bolt the bottom mounting bracket (D) below the upright bottom bracket.)
9. Tighten the bottom bolts first then the top bolts. Adjust the grill guard by loosening the front two bumper bolts from each side; open hood to check for clearance. Tighten bolts with an air impact wrench if possible.
10. Re-attach the air dam to bumper. You may want to notch the air dam around the bottom for a better fit.
11. **MAKE SURE ALL NUTS AND BOLTS ARE TIGHTENED.**

WARNING

Special care should be exercised in the handling, storage and installation of Kaspar Ranch Hand equipment.

The actual weight of each piece of equipment will vary depending on style and model. The weight of the equipment is sufficient in volume to warrant special care, assistance, and in some instances, the use of mechanical equipment during the transfer and installation of the equipment.

Do not assume a position directly under the equipment during installation. Be sure the equipment has been connected and stabilized during installation to prevent falling or shifting of positions.

Periodically check tightness of bolts to make sure they are tight, and unlikely to fail.

DWG. NO.

GGD94 | BL 1

BILL OF MATERIALS

LETTER	QTY	DESCRIPTION
A	1	GRILL - GGD-94 BL 1
B	1	DRIVER'S SIDE TOP MOUNTING BRACKET
C	1	PASSENGER'S SIDE TOP MOUNTING BRACKET
D	1	DRIVER BOTTOM MOUNTING BRACKET
E	1	PASSENGER BOTTOM MOUNTING BRACKET
F	6	#5 - 1/2"-13 X 1 1/2" HEX HEAD BOLT
G	6	#5 - 1/2" L.W. (NOT SHOWN)
H	12	#5 - 1/2" x 1 3/8" O.D. F.W. (NOT SHOWN)
I	6	#5 - 1/2"-13 NUT (NOT SHOWN)

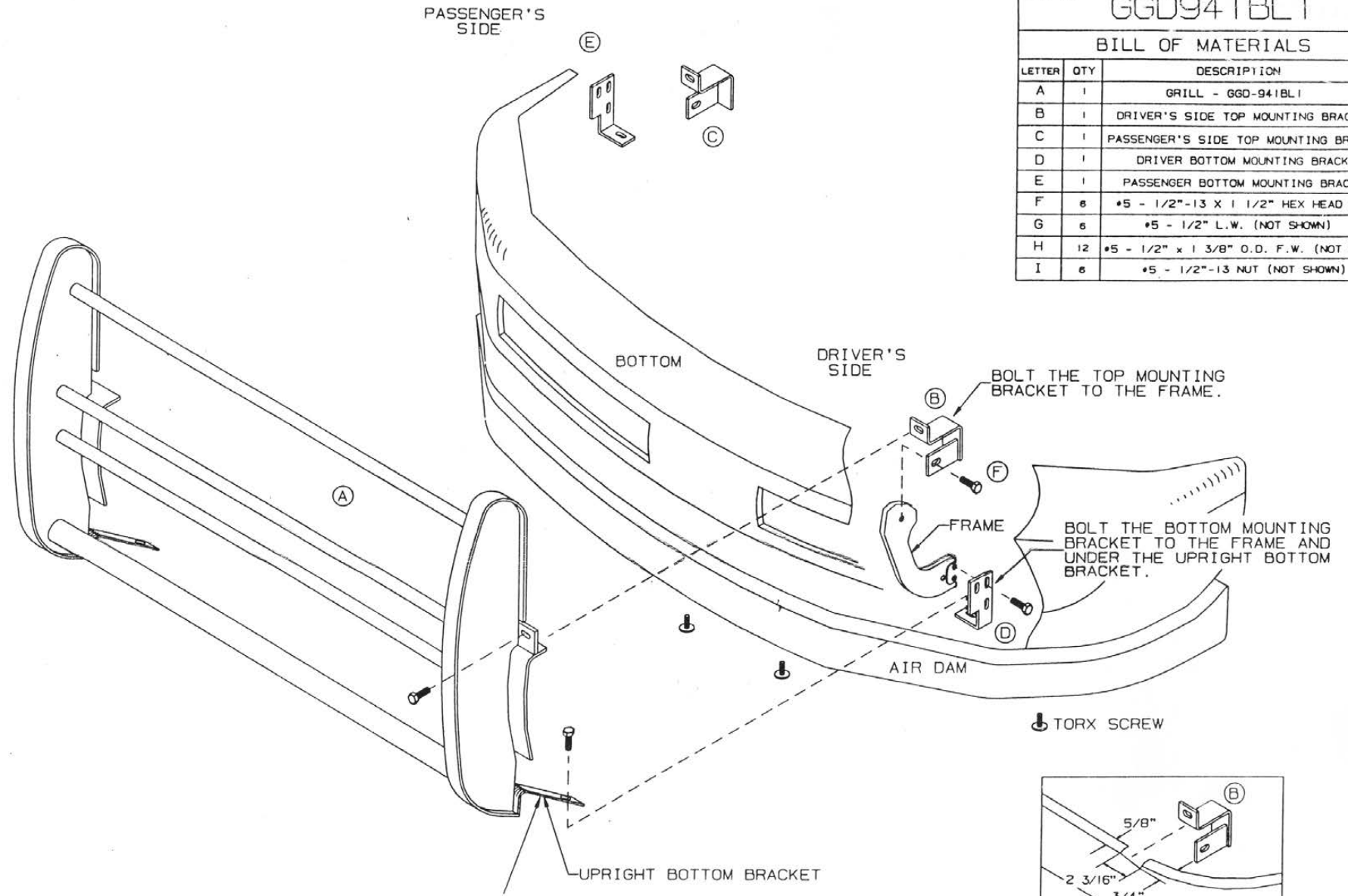

TORX SCREW

THE UPRIGHT BOTTOM BRACKET FITS BETWEEN THE BUMPER & THE AIR DAM.

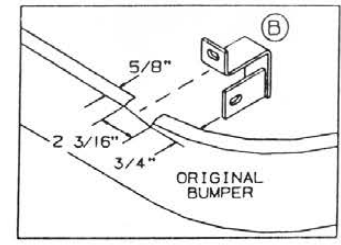

DO NOT SCALE PRINT

F						DR. TRP 8-15-00	KASPAR WIRE WORKS, INC.
E						C.K.D.	
D						SCALE: NTS	
C						APPROVED	
B	ADDED FACTORY BUMPER AND AIR DAM	CAB	3-1-01	KRH			
A	LICENSE PLATE HOLDER DELETED	TRP	10-24-00	GGD94BL 1			
LET.	REVISIONS		DATE	USED ON	REQ.	SUPERSEDES:	NAME: 94 DODGE GRILL GUARD MOUNTING INSTRUCTIONS
							MATL:
							DIMENSIONAL TOLERANCES : FRACTION ±.010; DECIMAL ±.005 UNLESS OTHERWISE SPECIFIED